

PLAYGROUND SPIELPLATZ

PLAC ZABAW AIRE DE JEUX

(396 x 285 x h272cm)

003_03580_25012022

ACTIVER

INSTALLATION INSTRUCTIONS
MONTAGEANLEITUNG

INSTRUKCJA MONTAŻU
GUIDE D'INSTALLATION

Warranty period - 2 years from purchase date

Garantiezeit - 2 Jahre ab Kaufdatum

Okres gwarancji - 2 lata od momentu zakupu towaru

Période de garantie - 2 ans à compter de l'achat



CE
EN - 71

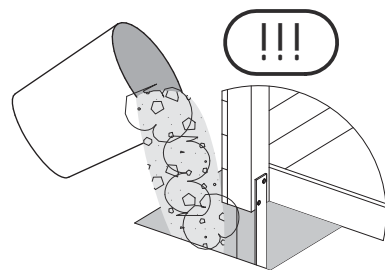
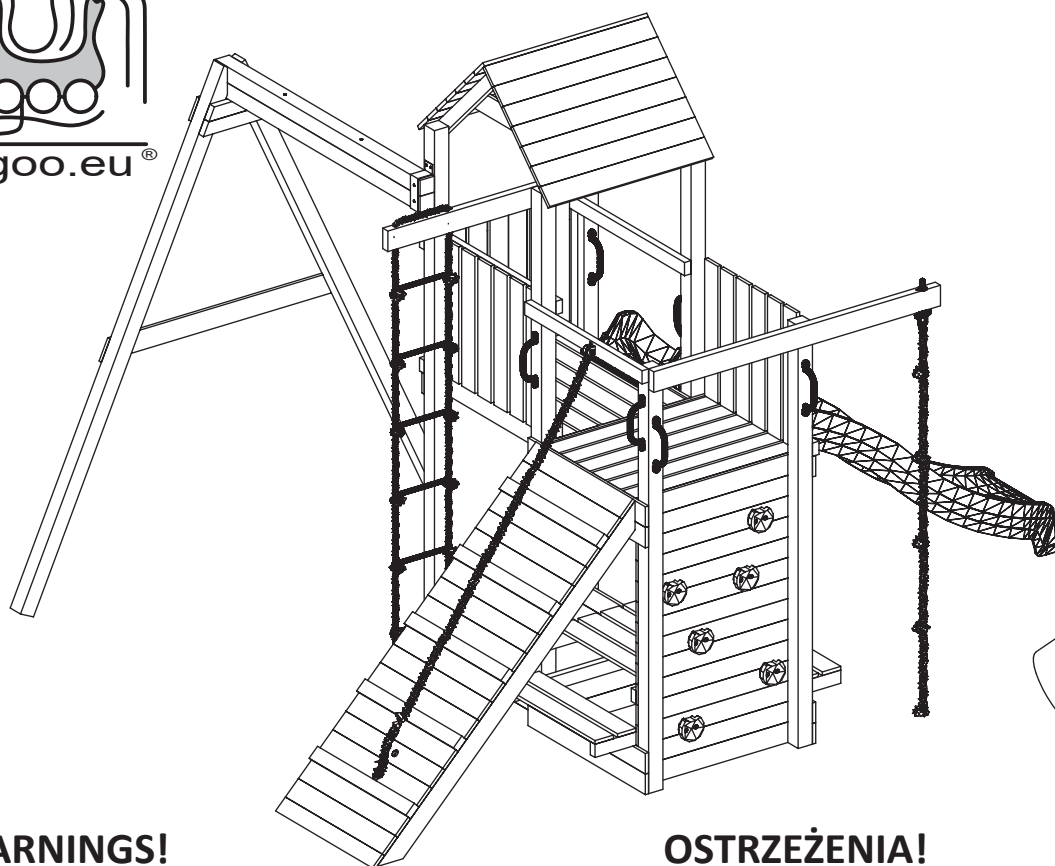

WARNINGS!

Only for home use.

Dedicated for external use only.

Not suitable for children under 3 years old.

Risk of falling down and/or hitting.

Maximum user weight is up to 50 kg.

Maximum number of users staying on the
playground at the same time: 9.

OSTRZEŻENIA!

Tylko do użytku domowego.

Przeznaczony do użytku na zewnątrz.

Nie przeznaczony dla dzieci poniżej 3 roku życia.

Niebezpieczeństwo upadku i/lub uderzenia.

Maksymalna waga użytkownika to 50 kg.

Maksymalna liczba użytkowników przebywających
na placu zabaw w tym samym czasie: 9.

ACHTUNG!

Nur für den privaten, häuslichen Bereich.

Ausschließlich für die Verwendung im Freien.

Nicht geeignet für Kinder unter 3 Jahren.

Stolper- und / oder Sturzgefahr

Höchstgewicht pro Einzelkind beträgt 50 kg

Der Aufenthalt auf diesem Spielturm ist max. : 9.

Kindern gleichzeitig erlaubt.

AVERTISSEMENT!

Aire exclusivement destinée à un usage privé.

Aire exclusivement destinée à un usage en extérieur.

Prévue pour les enfants de plus de 3 ans.

Danger de chute ou de choc.

Poids maximal d'un utilisateur : 50 kg.

Nombre maximal d'utilisateurs présents en
même temps sur la même aire de jeux: 9.

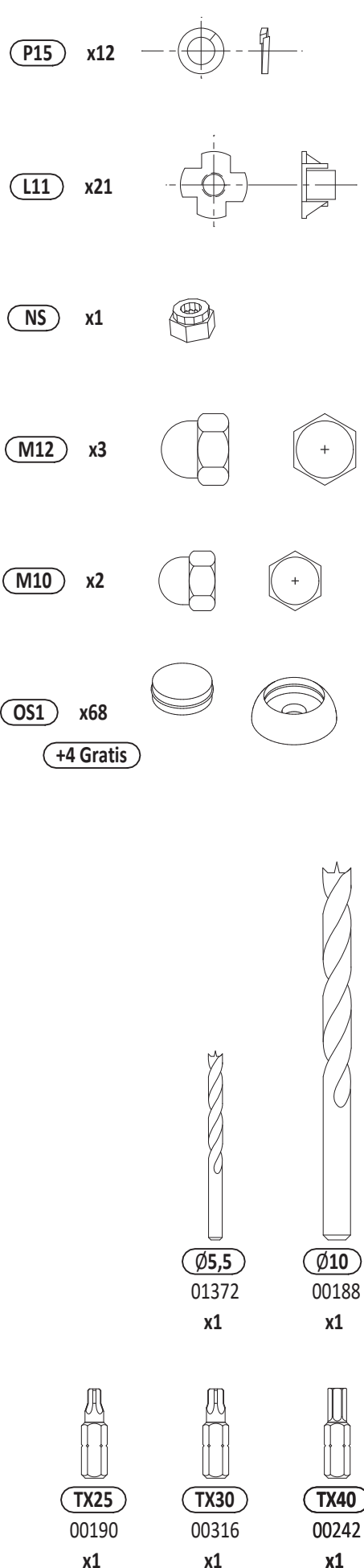
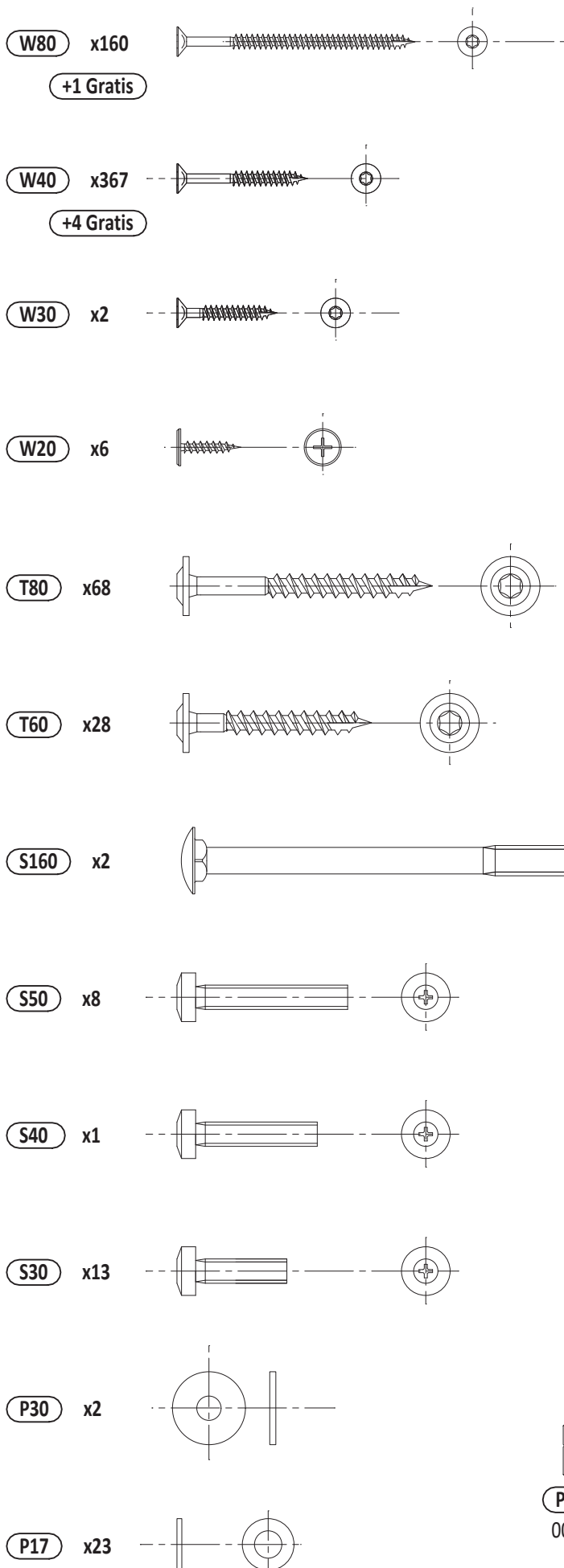

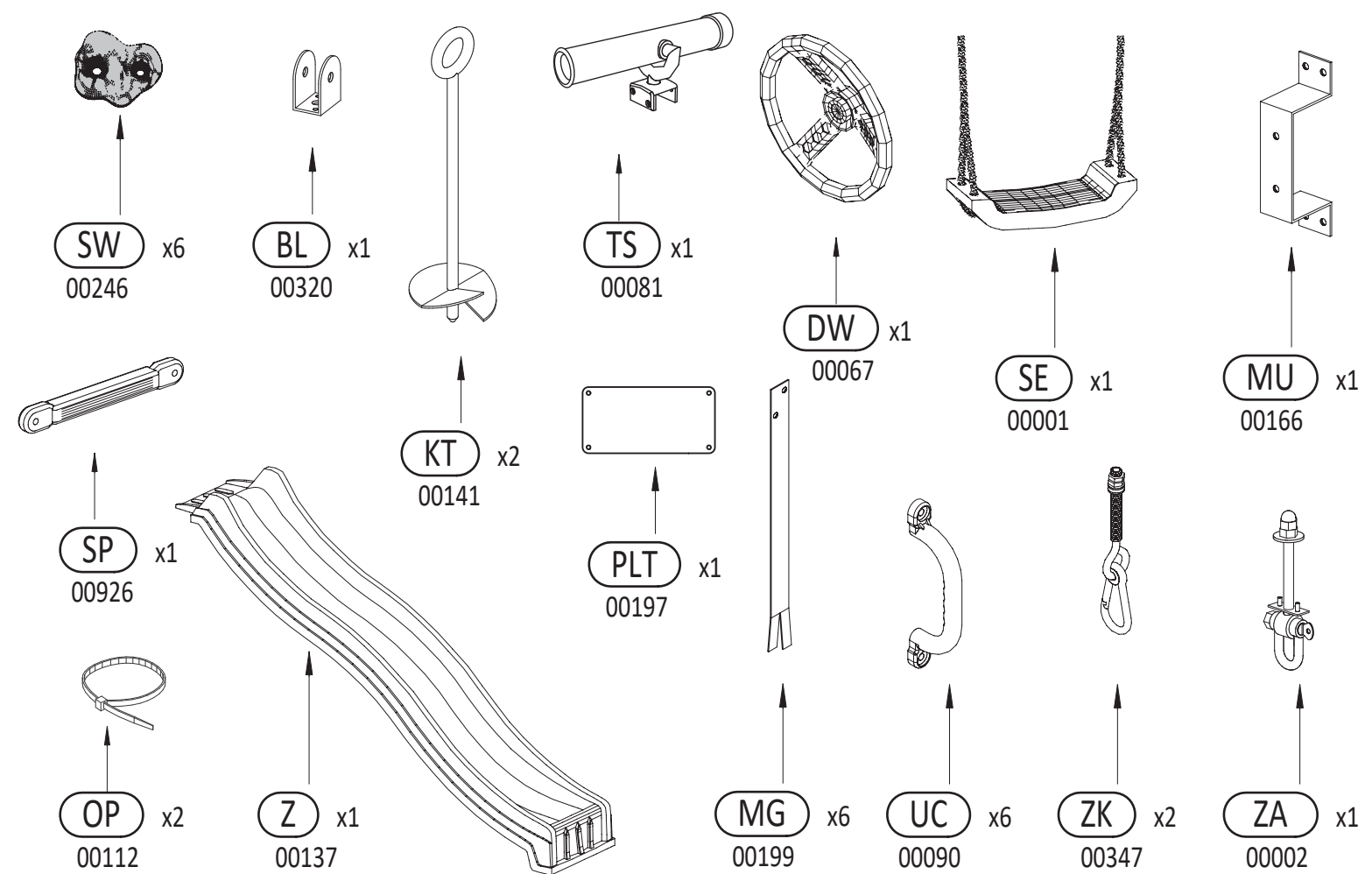
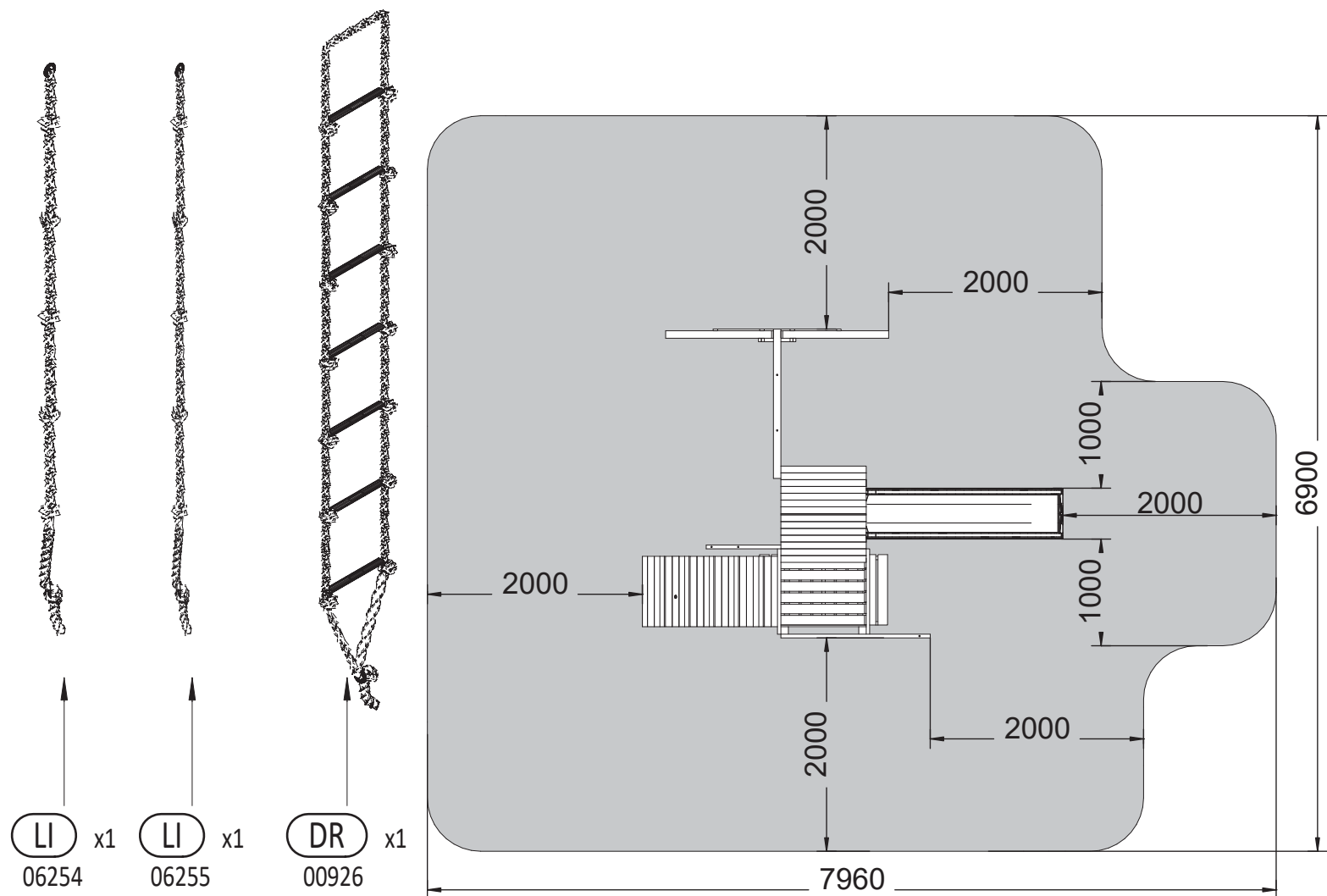

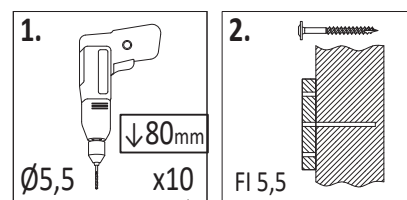
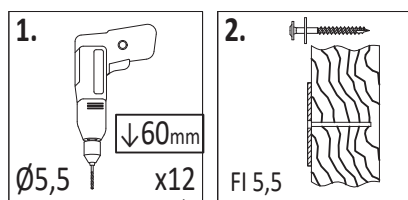
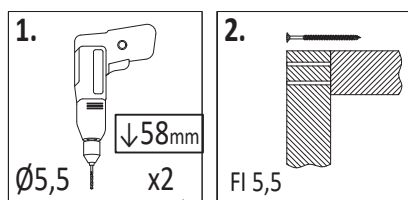
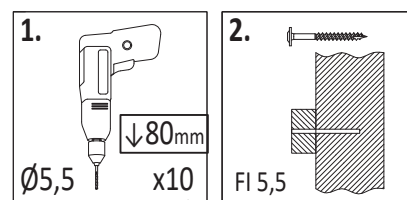
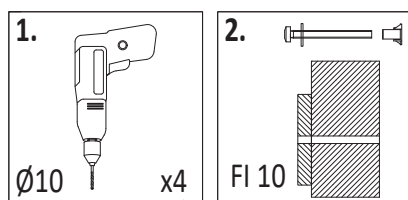
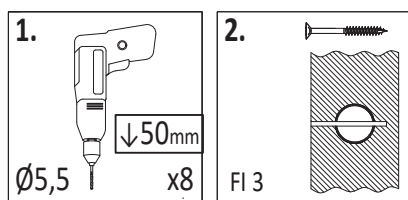
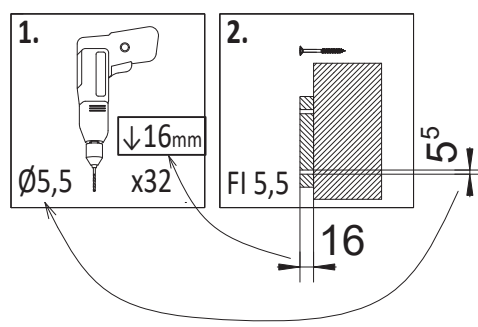
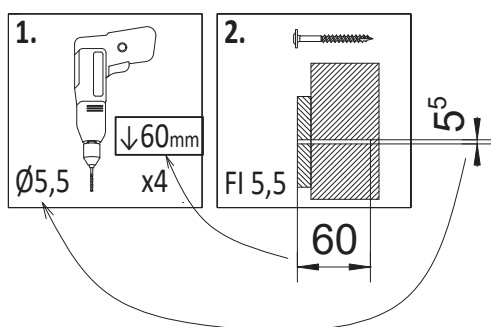
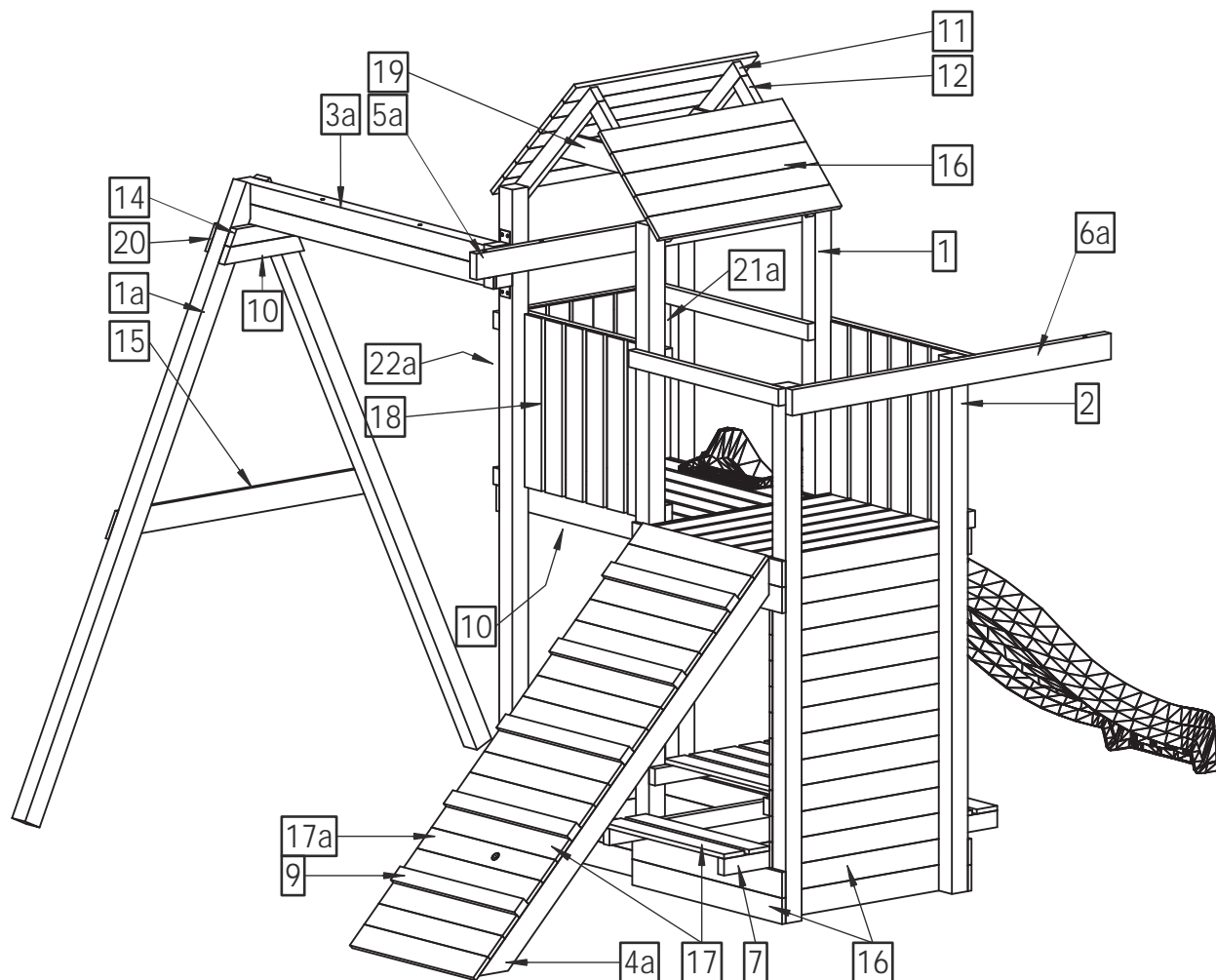

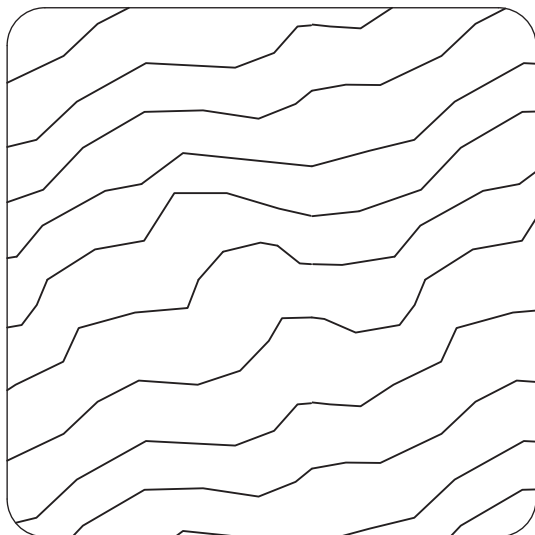

7,0 x 7,0 cm

| Lp. | Kod | Wymiary [mm] | szt. |
|-----|-------|--------------|------|
| 1 | 04451 | 70x70x2300mm | 4 |
| 1a | 04453 | 70x70x2300mm | 2 |
| 2 | 03931 | 70x70x1850mm | 2 |
| 3a | 04455 | 70x70x1400mm | 2 |

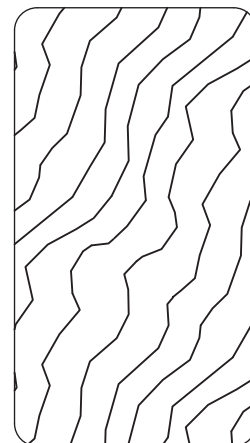

3,2 x 5,8 cm

| Lp. | Kod | Wymiary [mm] | szt. |
|-----|-------|--------------|------|
| 7 | 03889 | 32x58x1200mm | 2 |
| 8 | 04457 | 32x58x800mm | 10 |
| 9 | 04182 | 32x58x660mm | 5 |
| 10 | 04459 | 32x58x628mm | 6 |
| 11 | 04617 | 32x58x610mm | 2 |
| 12 | 04619 | 32x58x550mm | 2 |
| 13a | 04461 | 32x58x350mm | 1 |
| 14a | 04463 | 32x58x296mm | 1 |

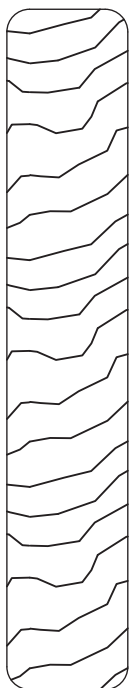

1,6 x 9,0 cm

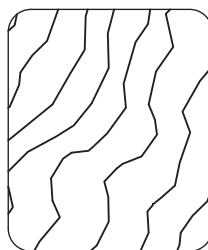

2,7 x 3,2 cm

| Lp. | Kod | Wymiary [mm] | szt. |
|-----|-------|--------------|------|
| 21a | 04471 | 27x32x542mm | 2 |
| 22a | 04476 | 27x32x484mm | 1 |

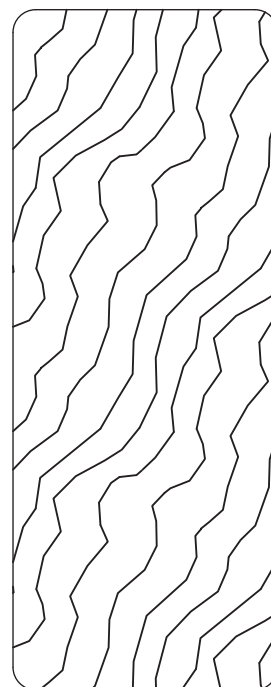

3,5 x 9,0 cm

| Lp. | Kod | Wymiary [mm] | szt. |
|-----|-------|--------------|------|
| 15a | 03920 | 16x90x1200mm | 1 |
| 16 | 04465 | 16x90x800mm | 59 |
| 17 | 04096 | 16x90x660mm | 27 |
| 17a | 04098 | 16x90x660mm | 1 |
| 18 | 04625 | 16x90x600mm | 18 |
| 19a | 04467 | 16x90x560mm | 2 |
| 20a | 04469 | 16x90x325mm | 1 |

| Lp. | Kod | Wymiary [mm] | szt. |
|-----|-------|--------------|------|
| 4a | 04474 | 35x90x1800mm | 2 |
| 5a | 05283 | 35x90x1500mm | 1 |
| 6a | 05285 | 35x90x1400mm | 1 |

01

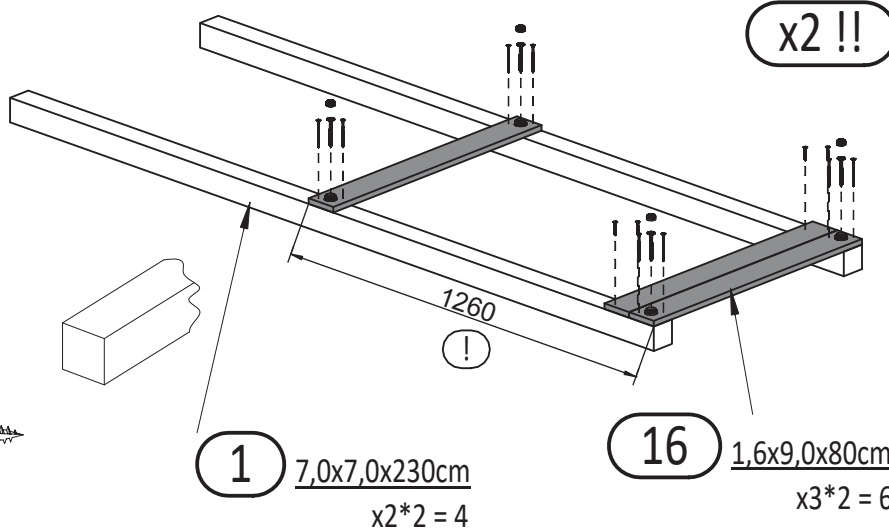
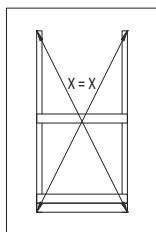
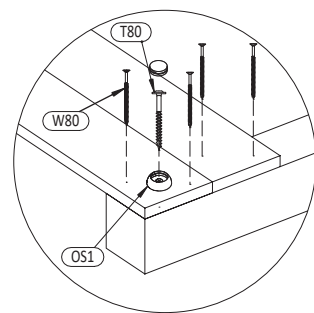
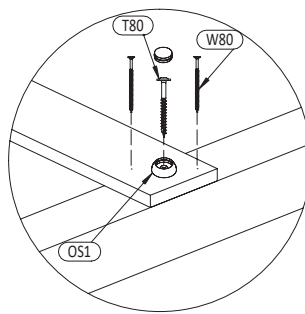
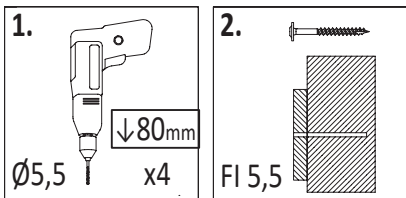

OS1 x4*2 = 8



W80 x12*2 = 24



T80 x4*2 = 8

02

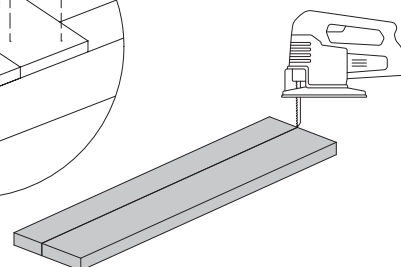
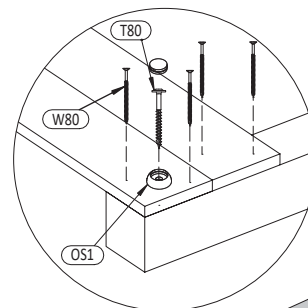
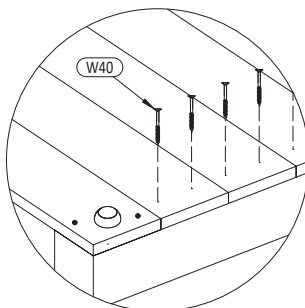
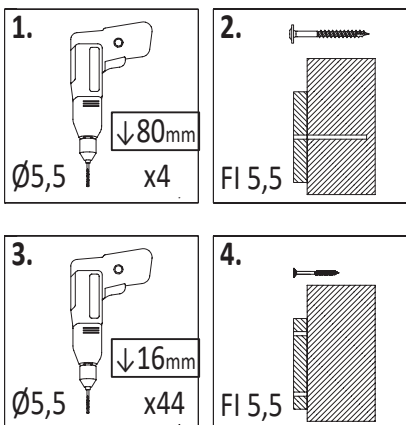

16 $1,6 \times 9,0 \times 80\text{cm}$
x14



W40 x44



OS1 x2



W80 x12

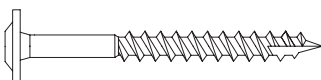

T80 x4

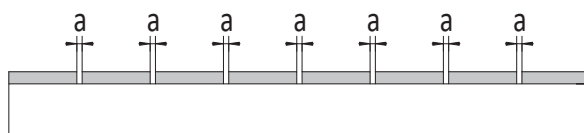
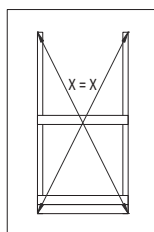

!!!min 2mm < a < !!!max 6mm



6

ACTIVER

Zgodnie z normą PN-EN 71 stosuj zalecenia producenta odnośnie odległości oraz metody mocowania poszczególnych elementów
In compliance with the standard PN-EN 71, apply guidelines of the producer in relation to distances and methods of fastening individual elements

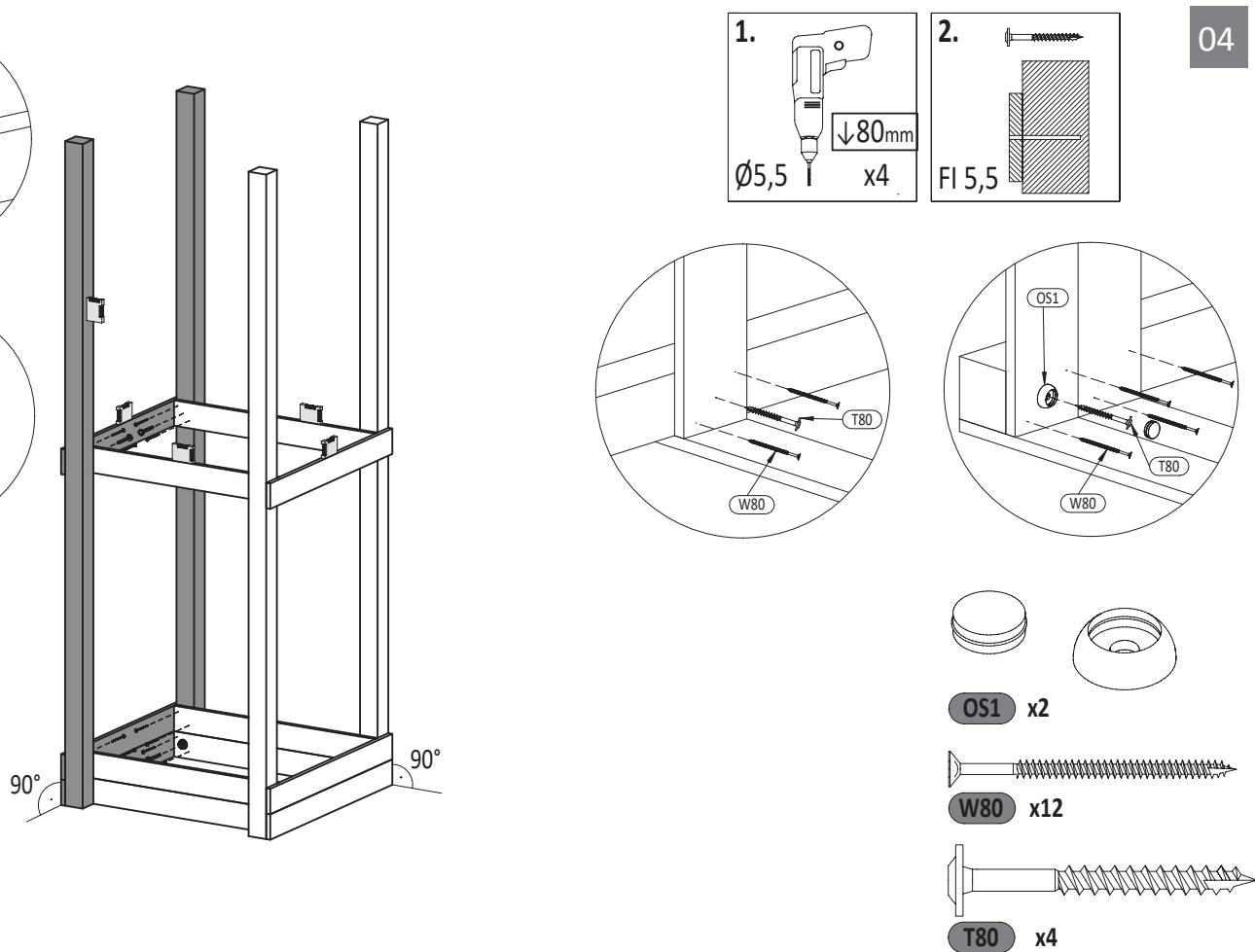
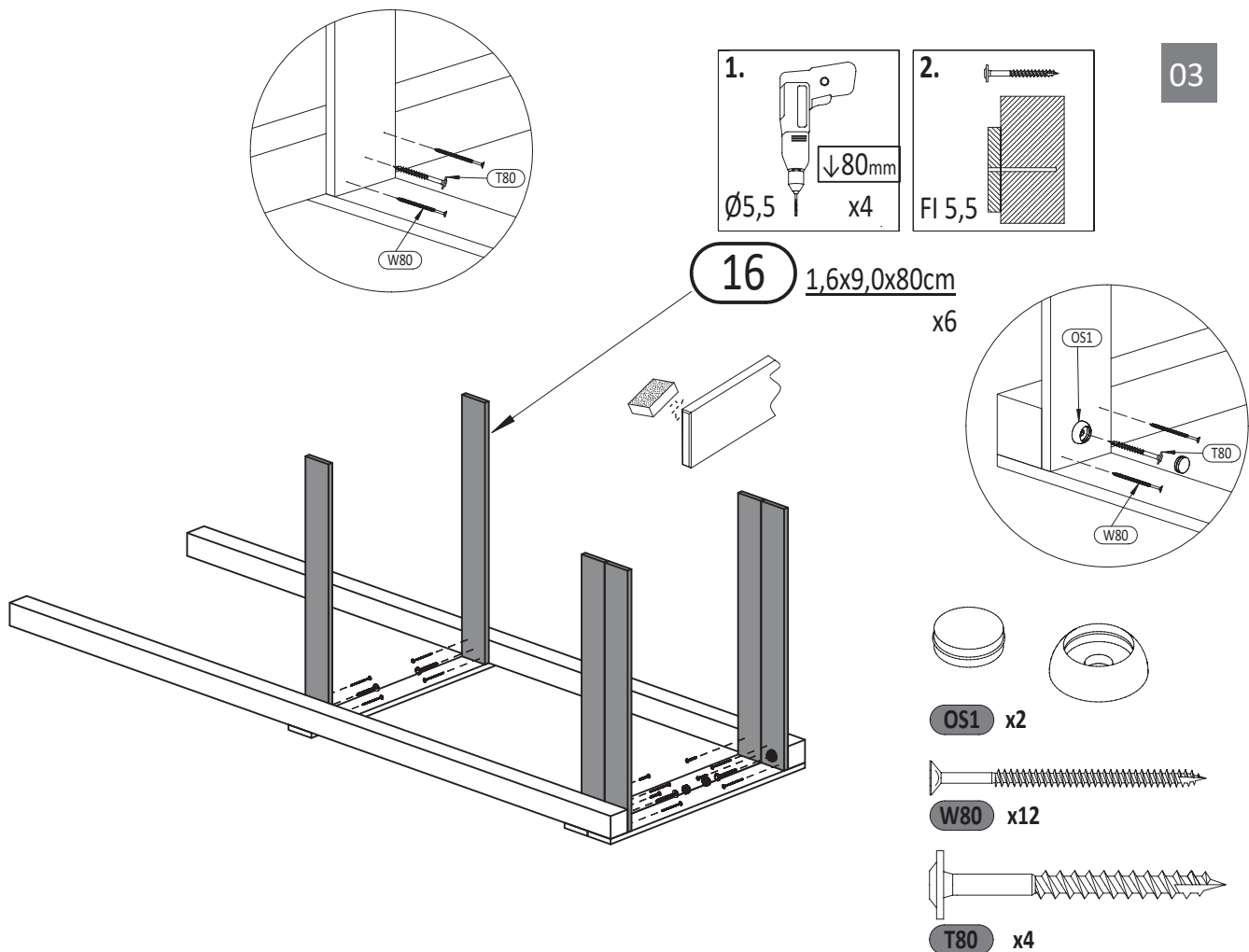

05

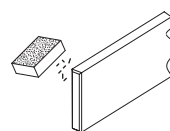
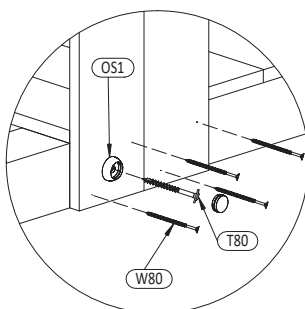
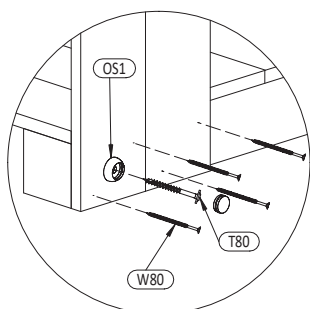
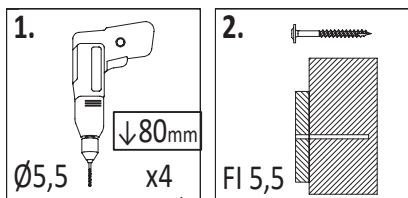

16 1,6x9,0x80cm
x7

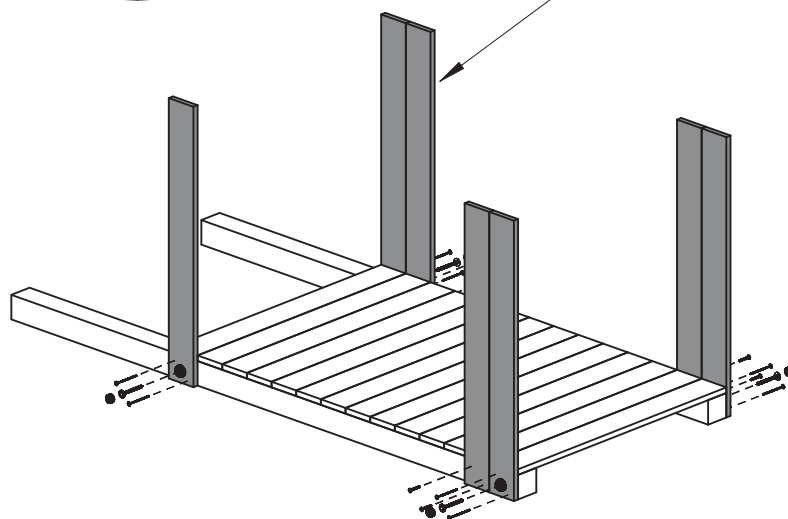

OS1 x4



W80 x14

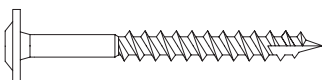

T80 x4

06

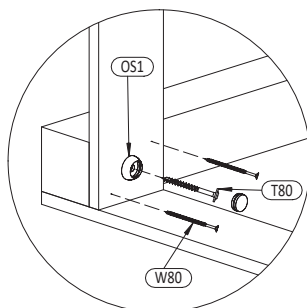
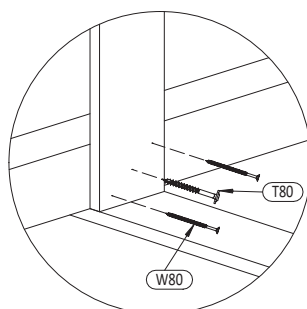
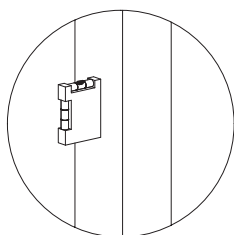
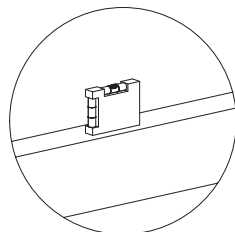
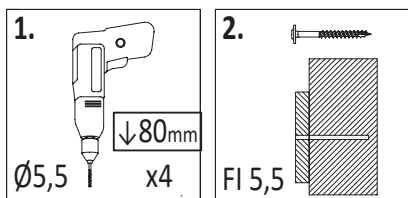

OS1 x4



W80 x14

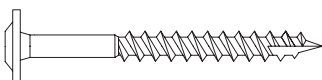

T80 x4

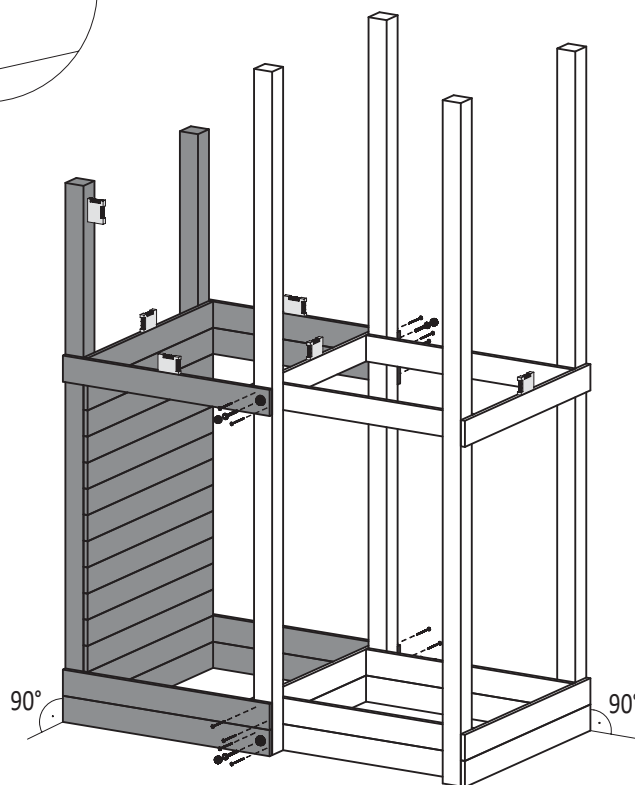

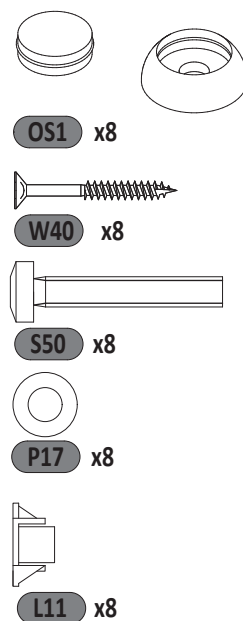
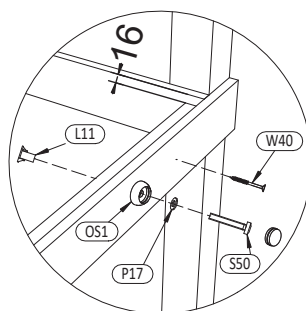
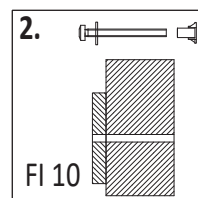
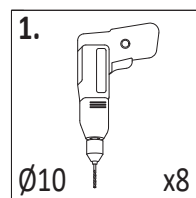
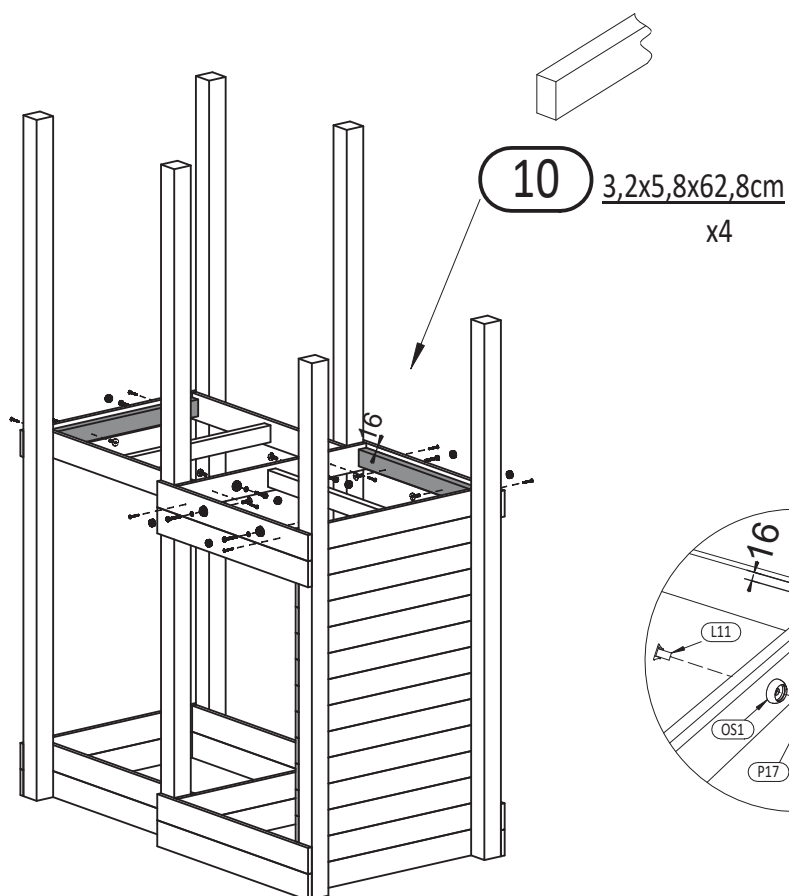
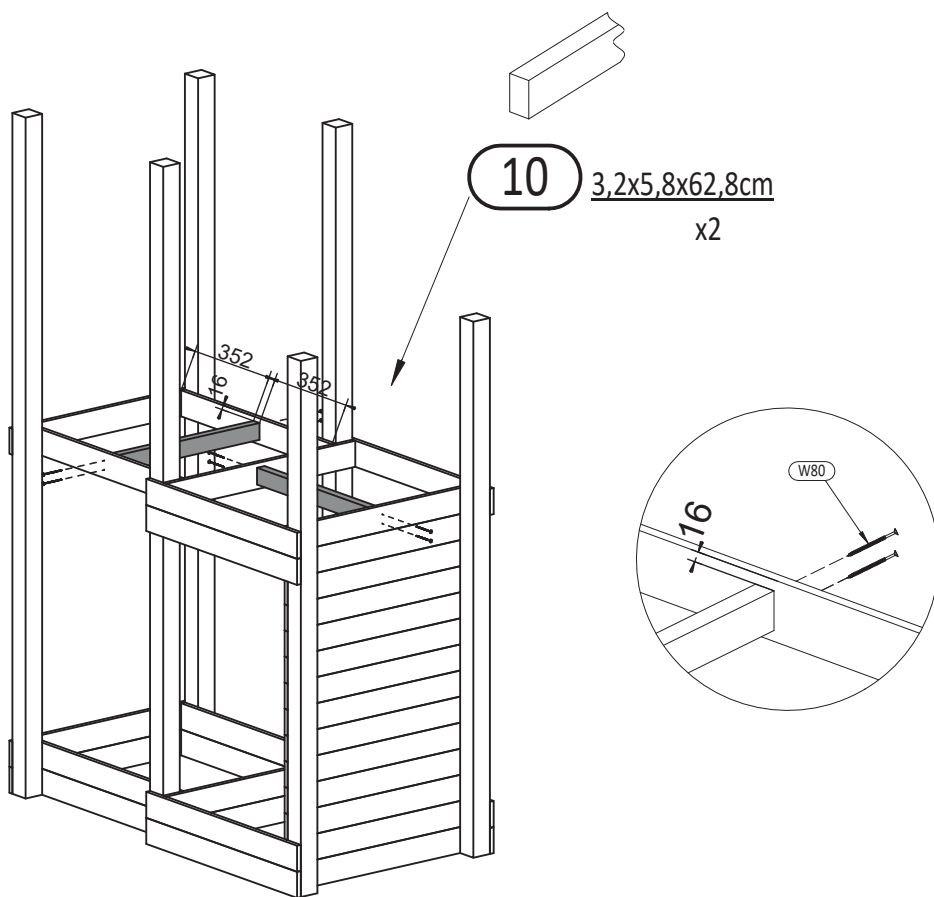

09

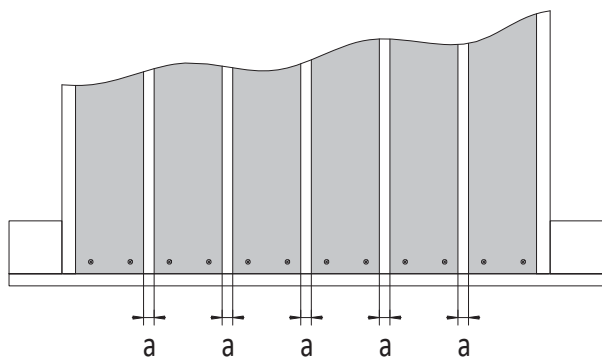
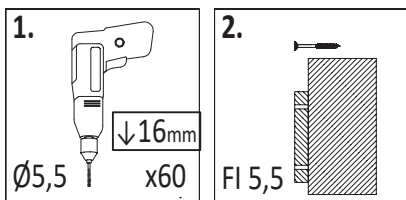

!!!min 13mm < **a** < !!!max 18mm

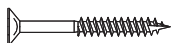

W40 x60

16

1,6x9,0x80cm

x12

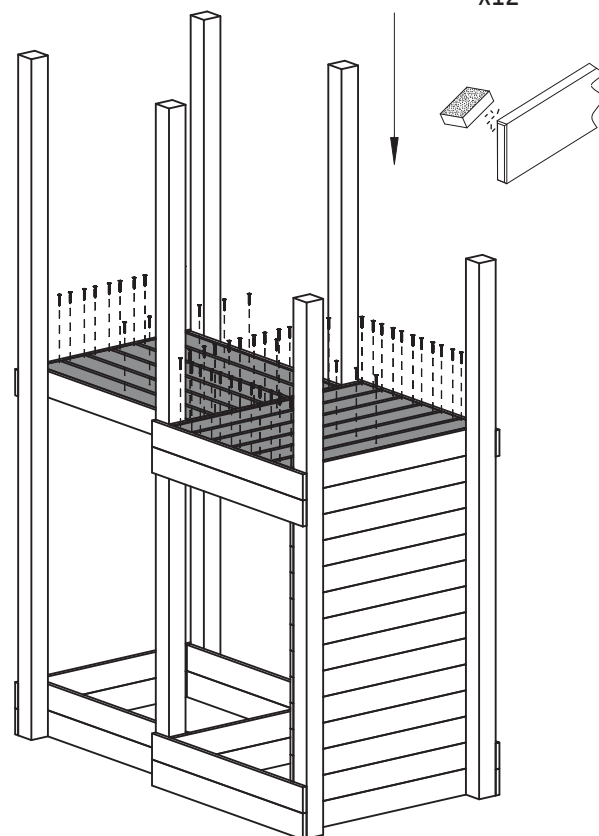

10

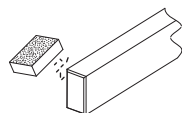
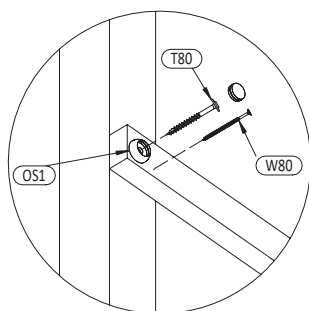
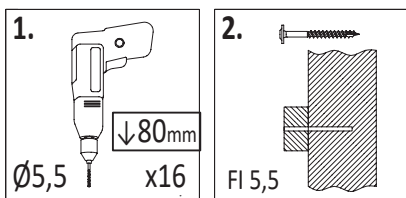

8

3,2x5,8x80cm

x8



OS1 x16



W80 x16

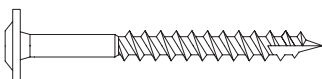

T80 x16

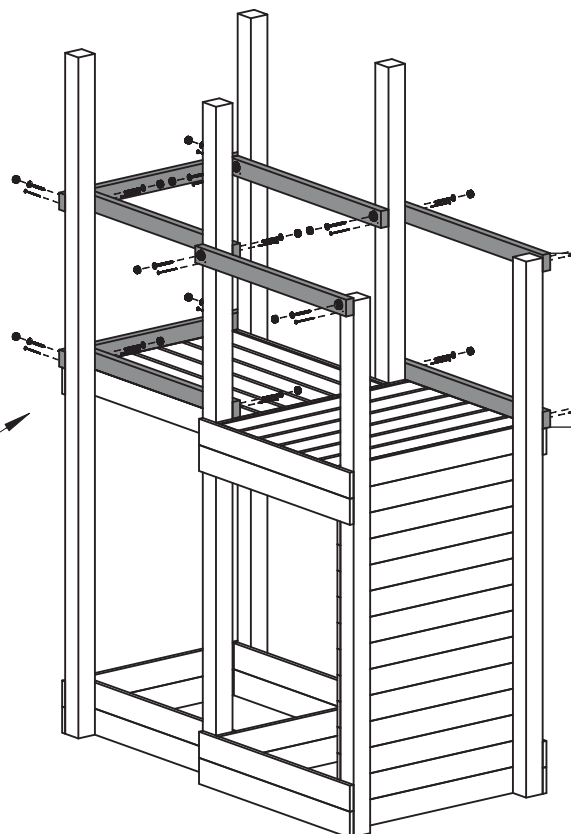

10 ACTIVER

Zgodnie z normą PN-EN 71 stosuj zalecenia producenta odnośnie odległości oraz metody mocowania poszczególnych elementów

In compliance with the standard PN-EN 71, apply guidelines of the producer in relation to distances and methods of fastening individual elements

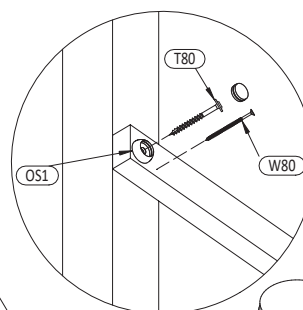
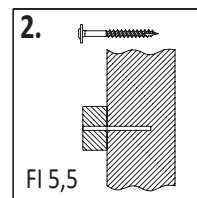
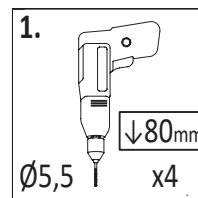
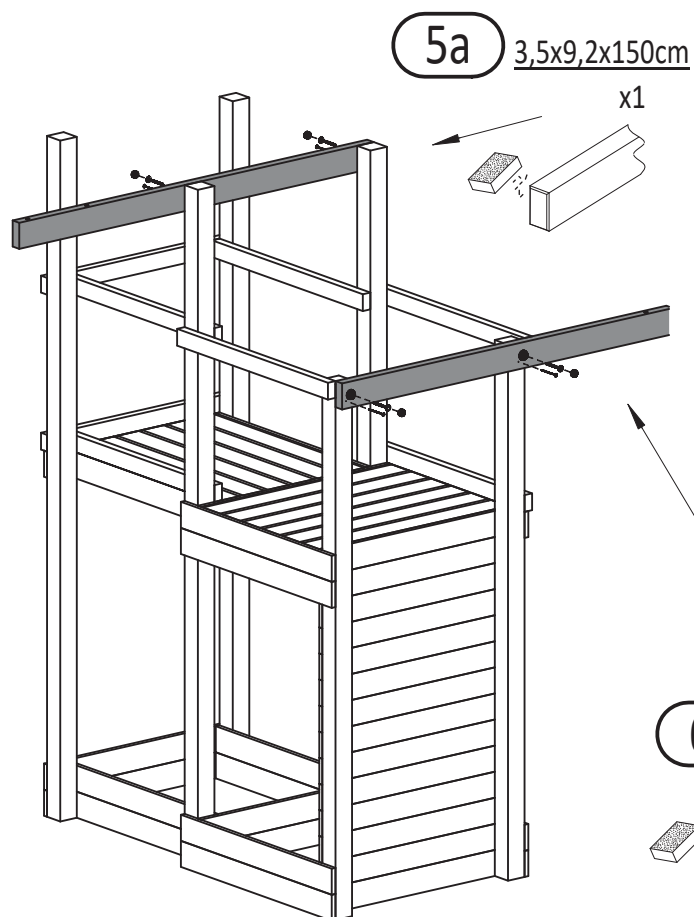

OS1 x4

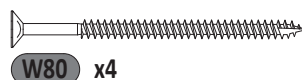

W80 x4

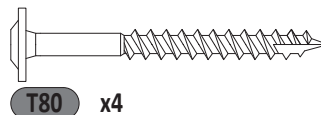

T80 x4

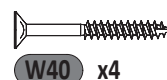
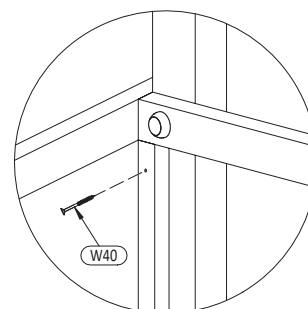
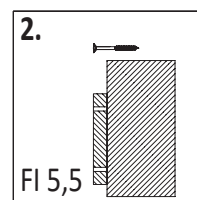
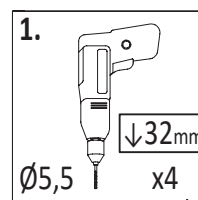
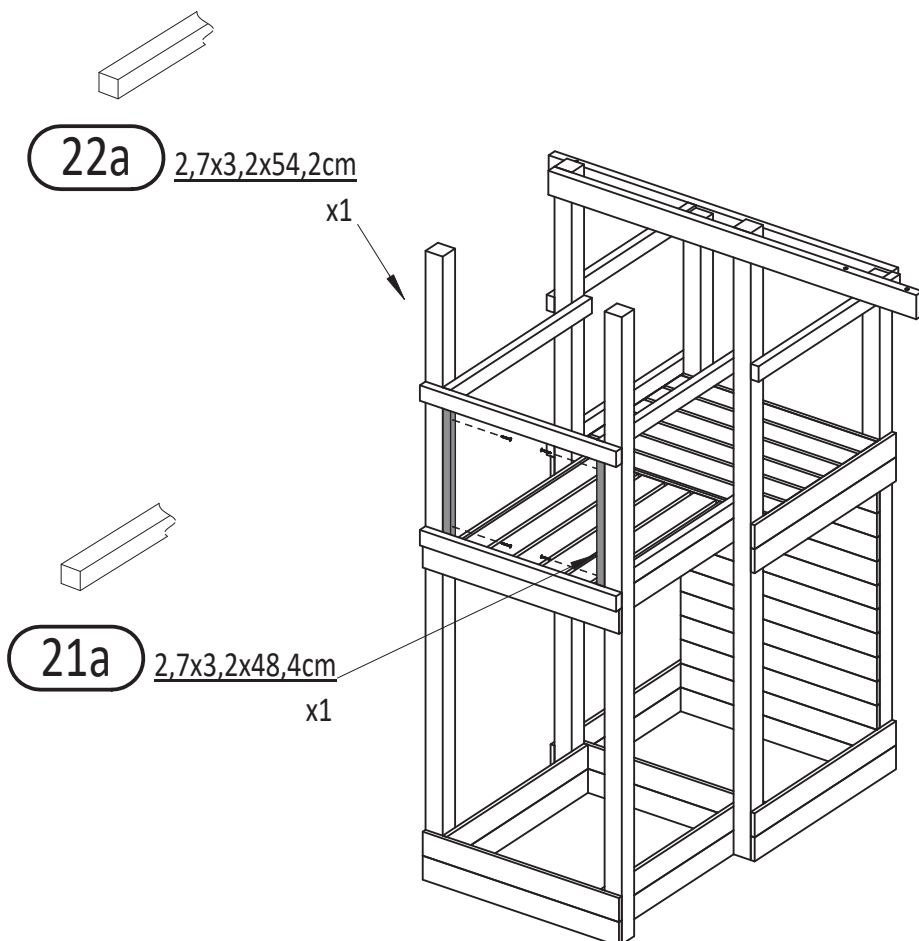

W40 x4

13

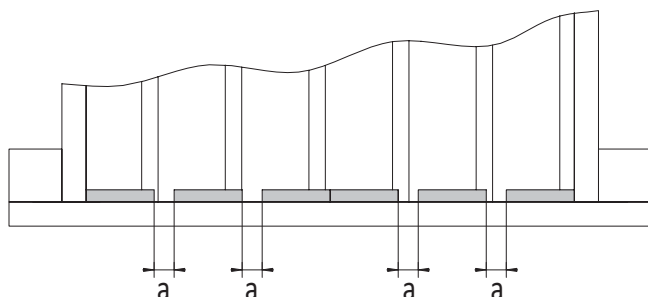
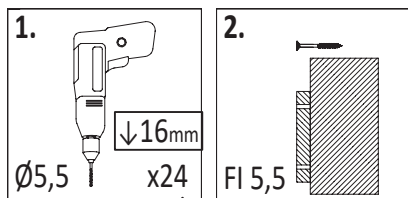

!!!min 13mm < **a** < !!!max 16mm

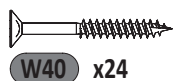

18 $1,6 \times 9,0 \times 60\text{cm}$

x6

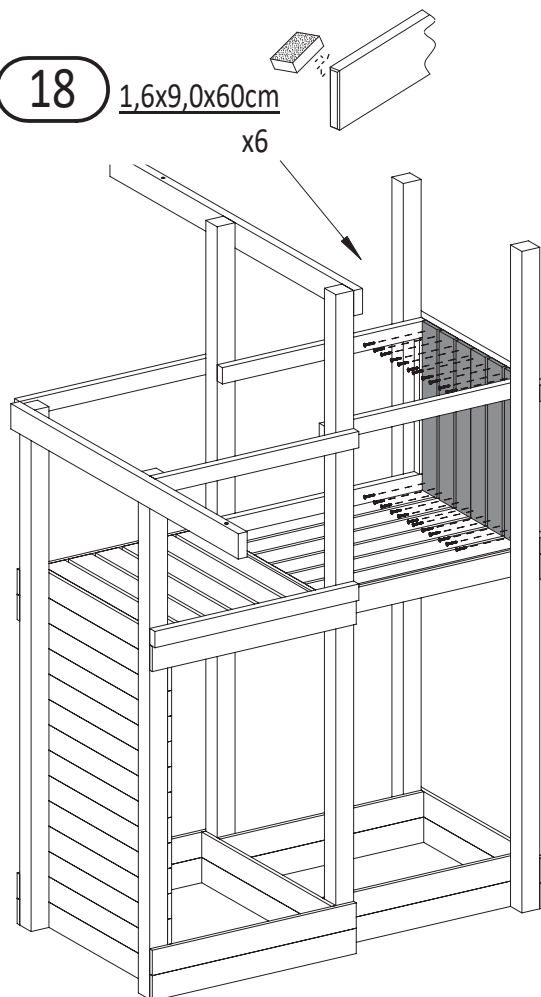

14

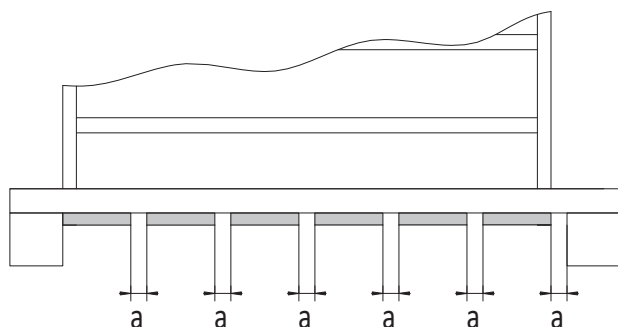
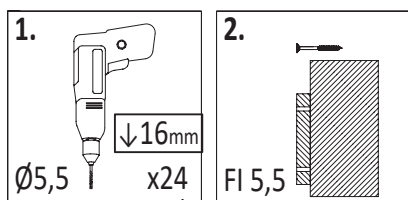

!!!min 13mm < **a** < !!!max 17mm

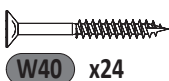

18

 $1,6 \times 9,0 \times 60\text{cm}$

x6

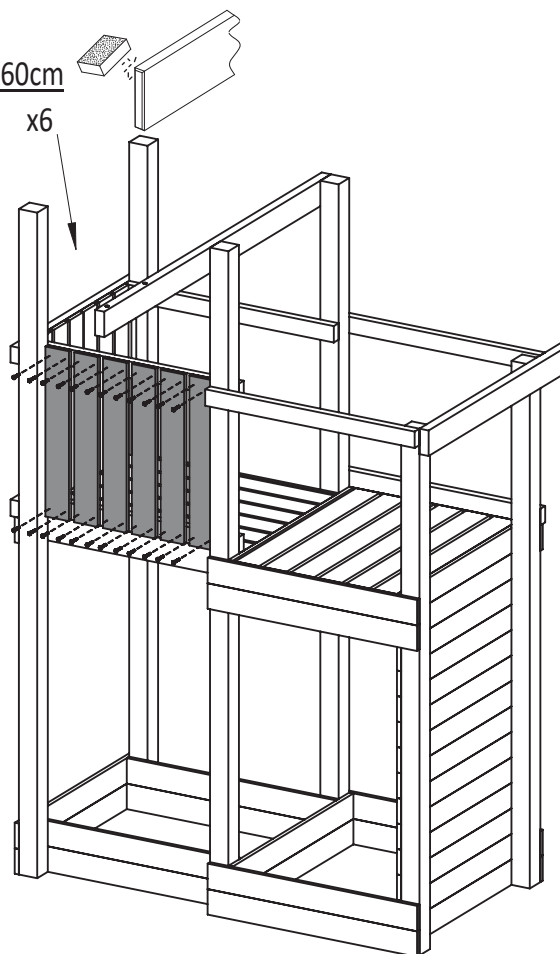

12

ACTIVER

Zgodnie z normą PN-EN 71 stosuj zalecenia producenta odnośnie odległości oraz metody mocowania poszczególnych elementów
In compliance with the standard PN-EN 71, apply guidelines of the producer in relation to distances and methods of fastening individual elements

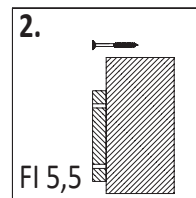
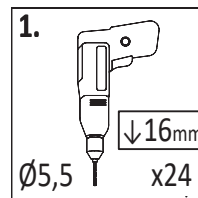
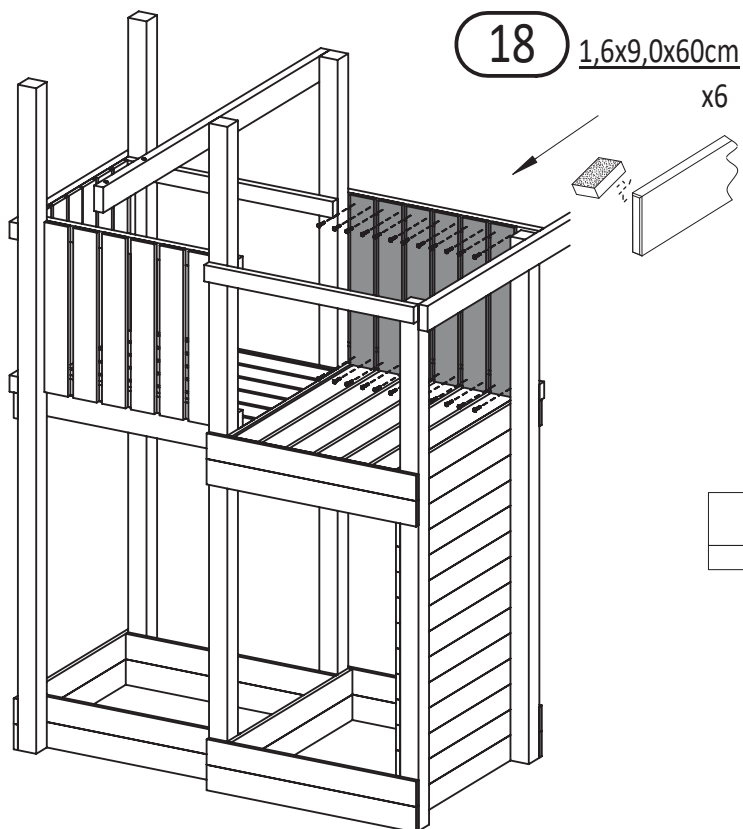

15

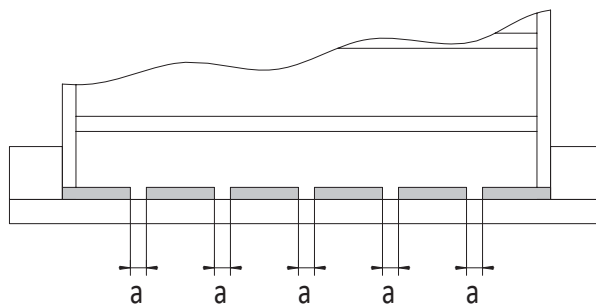

!!!min 13mm < a < !!!max 17mm

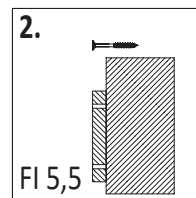
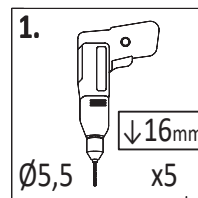
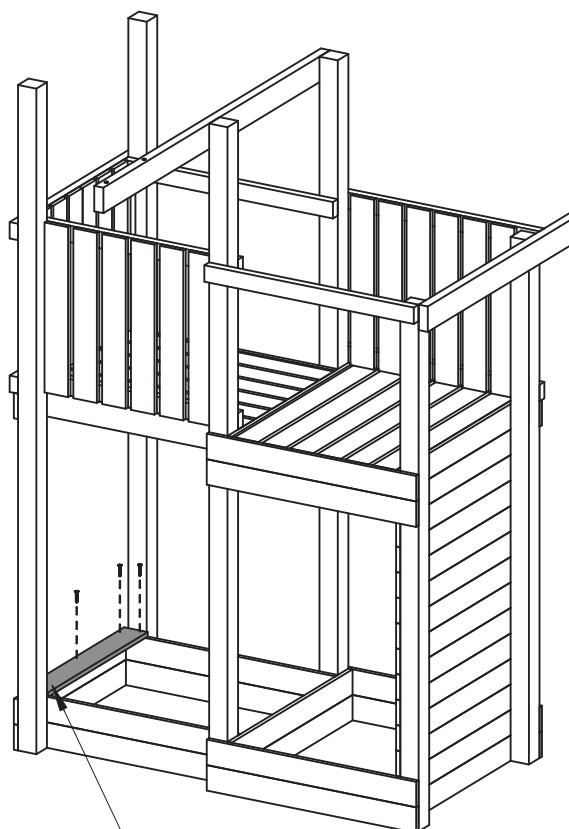
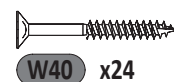

16

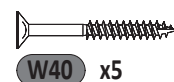
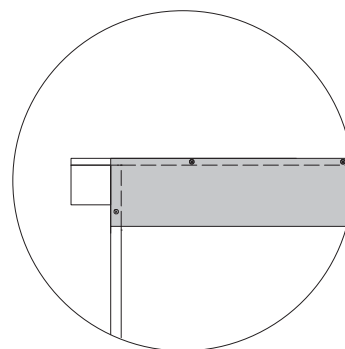

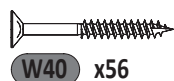
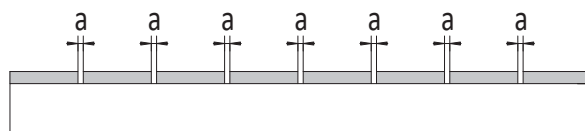
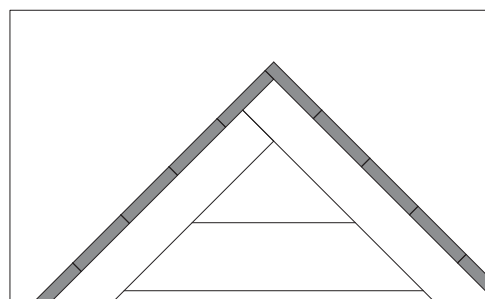
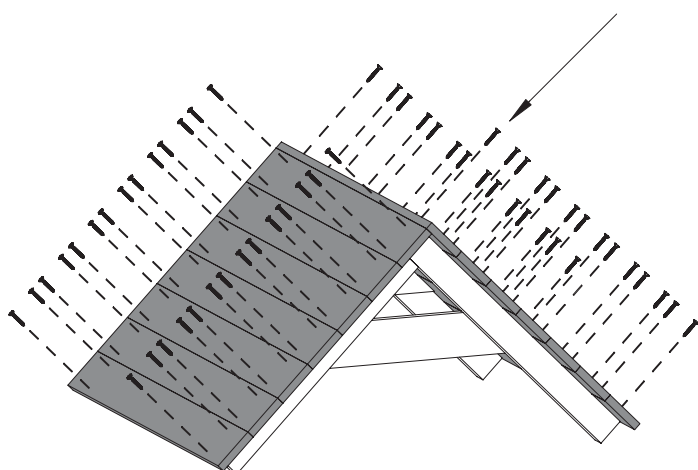
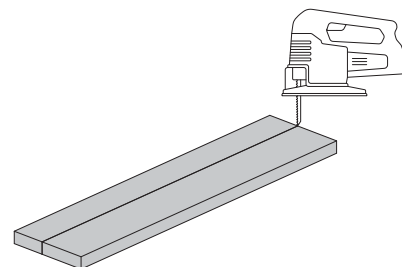
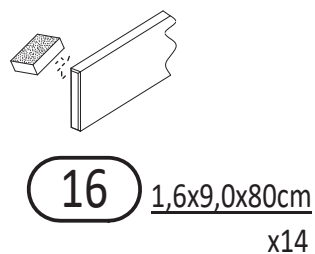
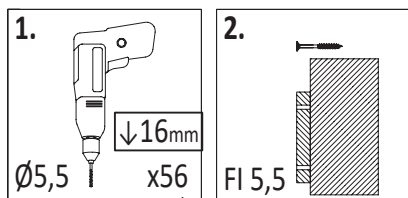
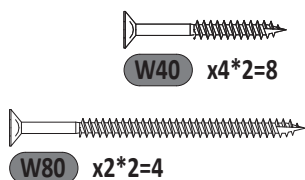
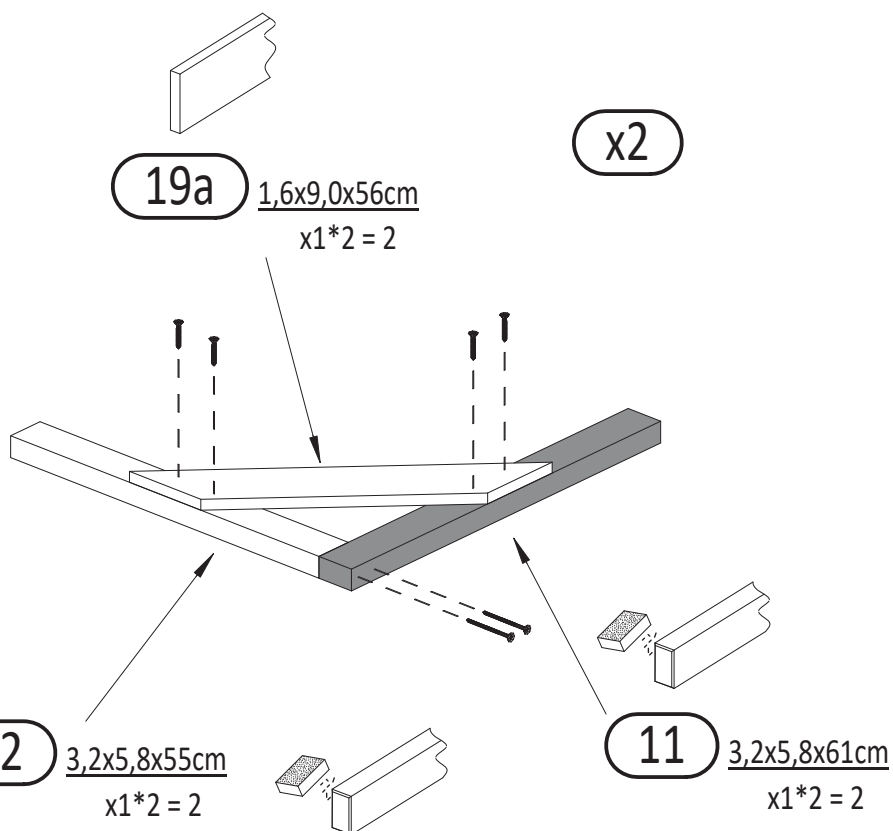
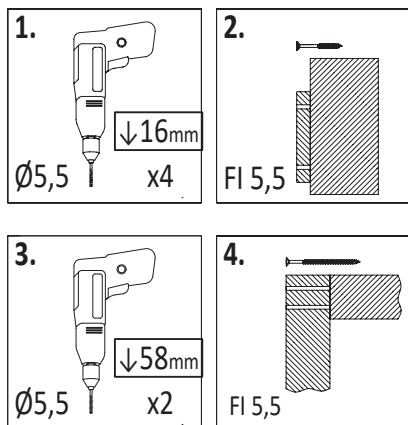

!!!min 2mm < a < !!!max 6mm

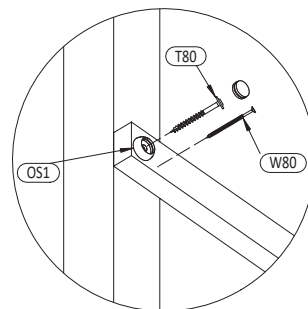
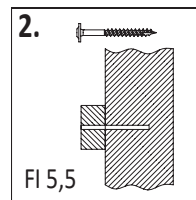
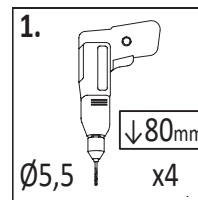
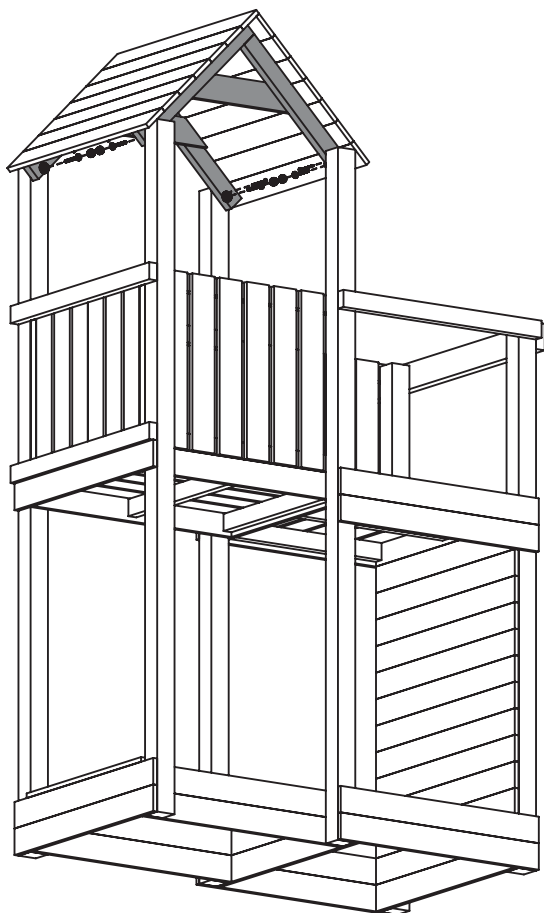

OS1 x4



W80 x4

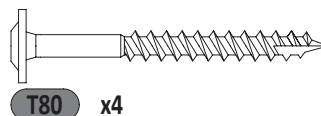

T80 x4

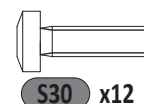
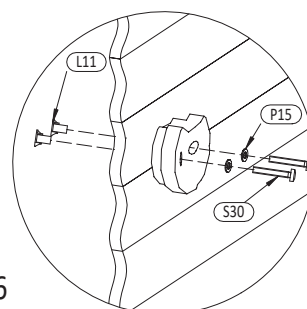
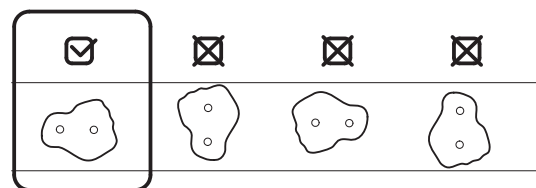
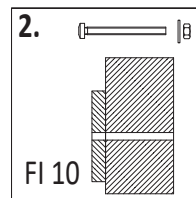
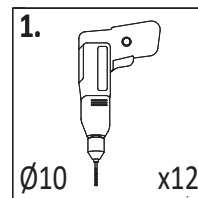
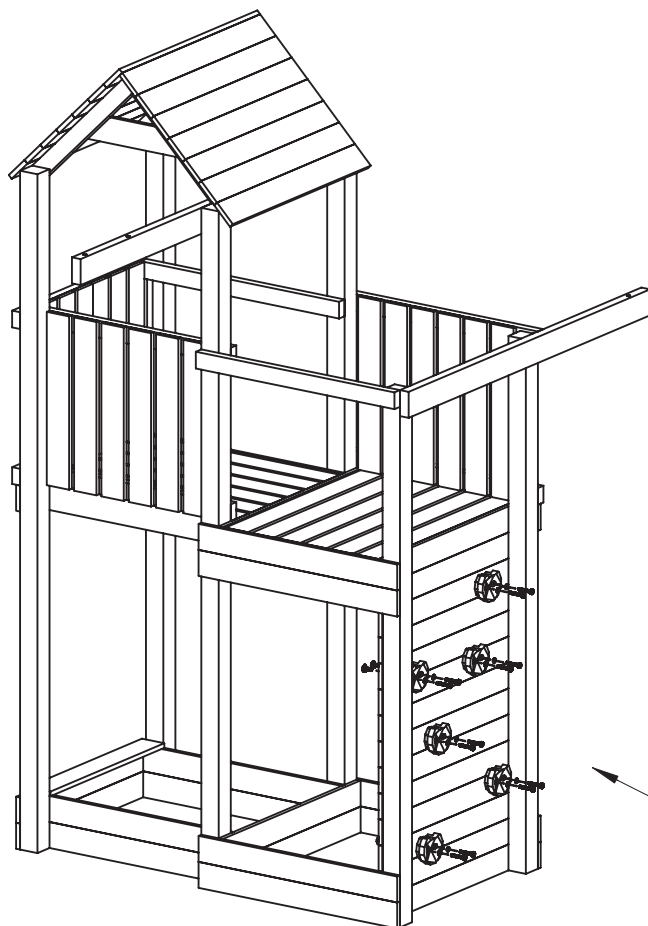

S30 x12



P15 x12

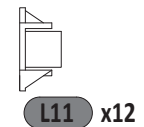

L11 x12

SW x6

21

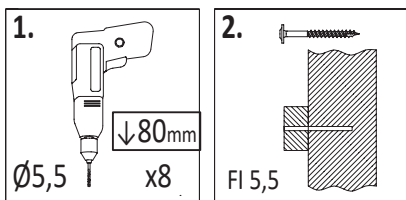

OS1 x8



W80 x8

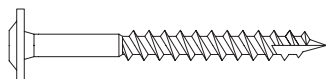

T80 x8

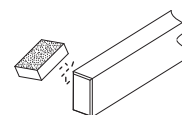
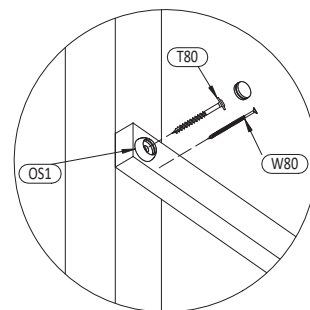
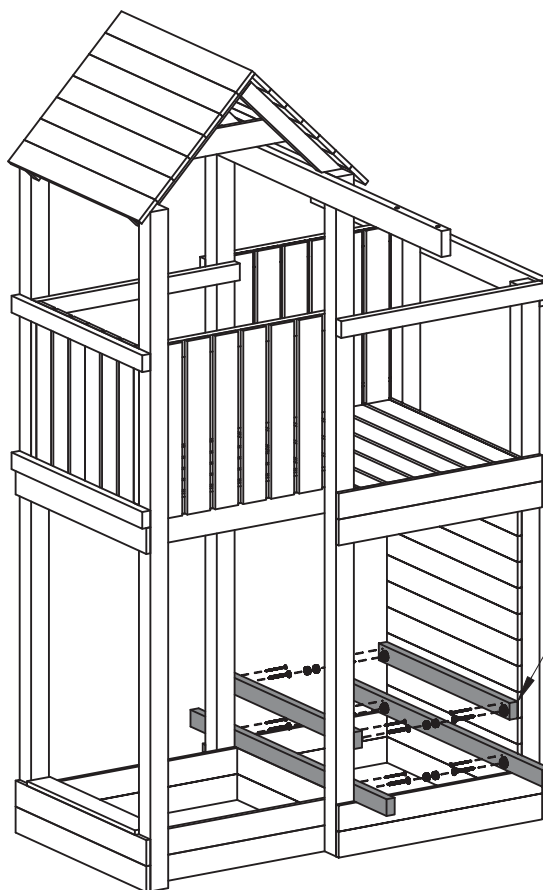

8 3,2x5,8x80cm
x2

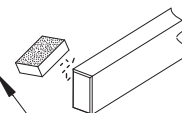

7 3,2x5,8x120cm
x2

22

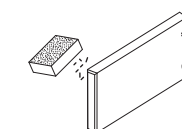
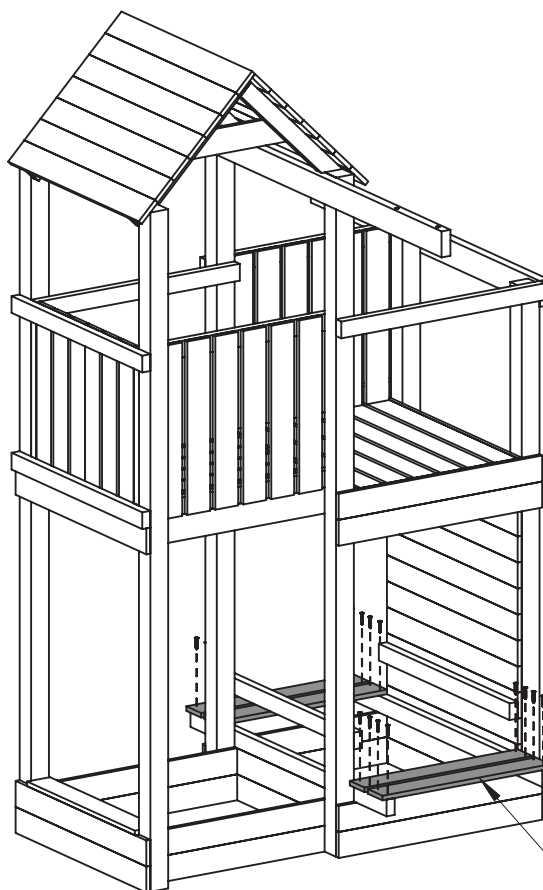
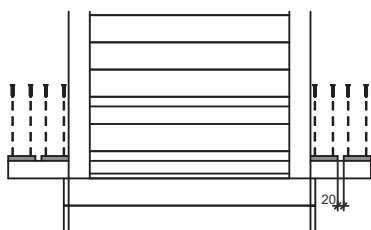
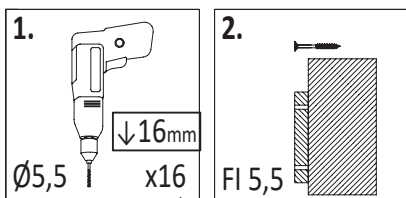

17 1,6x9,0x66cm
x4

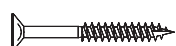

W40 x16

16 ACTIVER

Zgodnie z normą PN-EN 71 stosuj zalecenia producenta odnośnie odległości oraz metody mocowania poszczególnych elementów
In compliance with the standard PN-EN 71, apply guidelines of the producer in relation to distances and methods of fastening individual elements

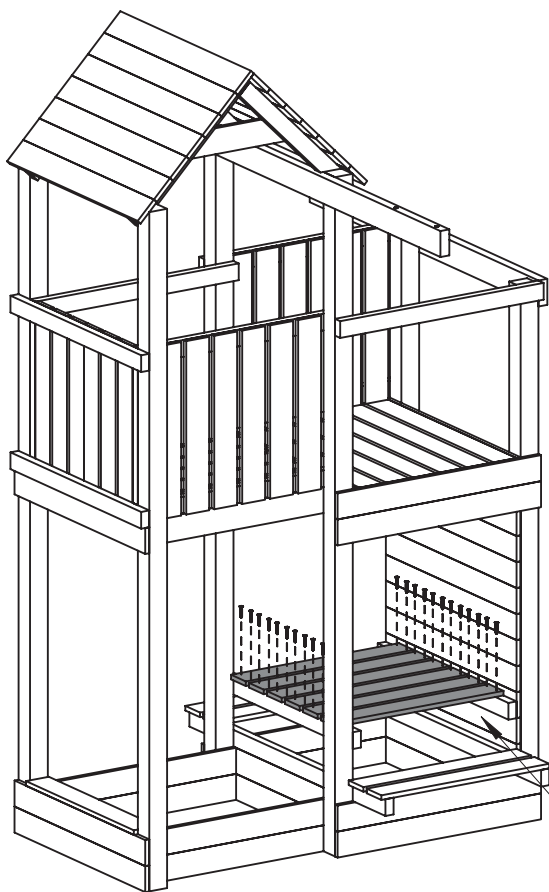
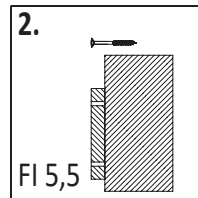
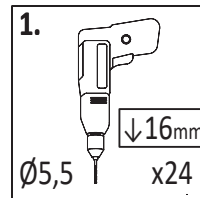

17 1,6x9,0x66cm
x6

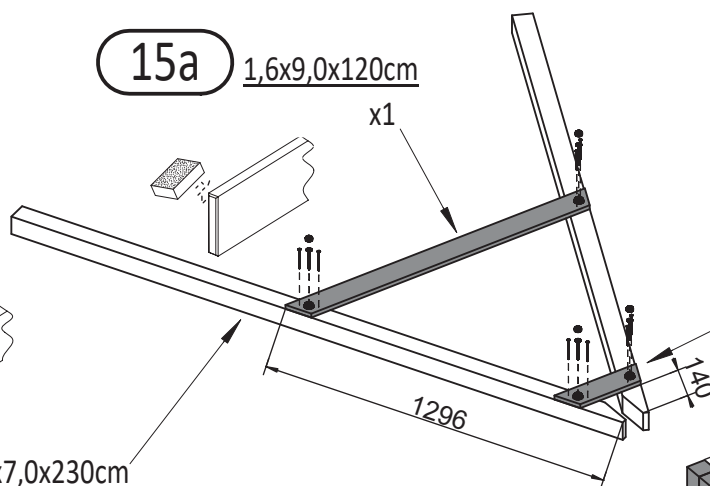
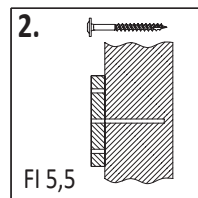
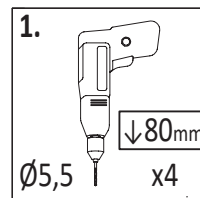
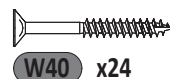
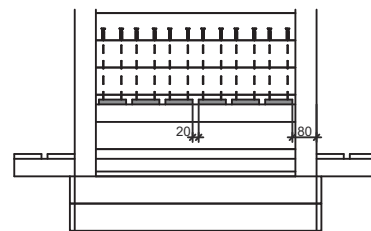

15a 1,6x9,0x120cm
x1

20a 1,6x9,0x32,5cm
x1

3a 7,0x7,0x140cm
x2

1a 7,0x7,0x230cm
x2

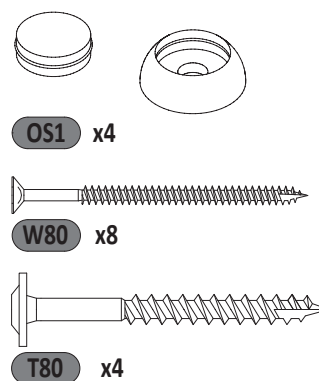
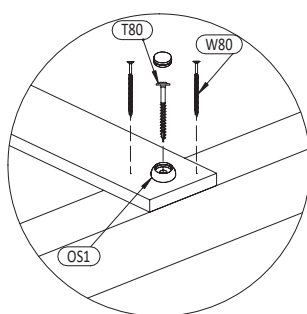
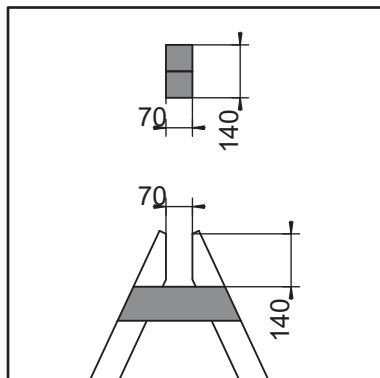

25

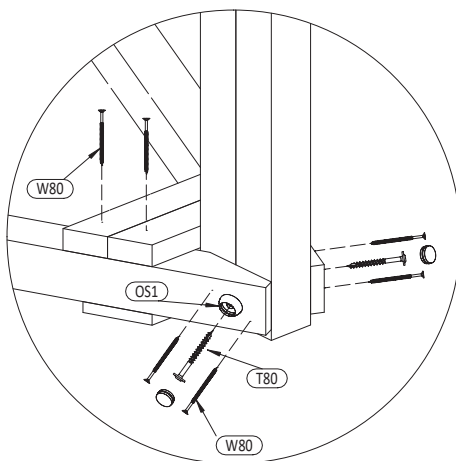
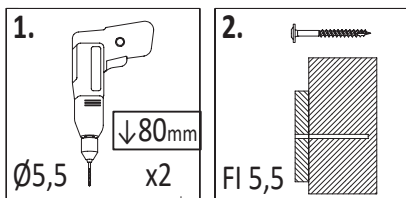

3a 7,0x7,0x140cm

x2

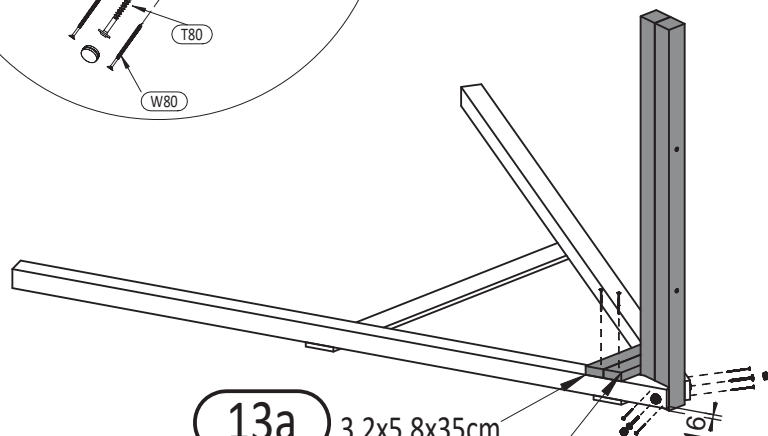
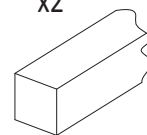

13a

3,2x5,8x35cm

x1

14a

3,2x5,8x29,6cm

x1



OS1 x2



W80 x8



T80 x2

26

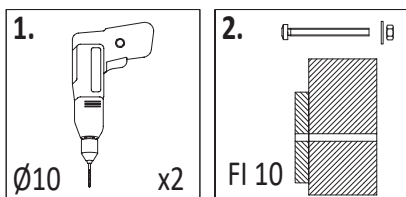
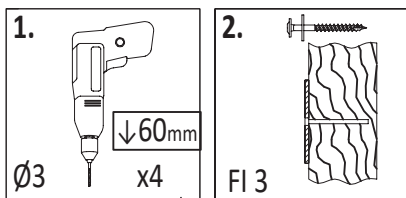

M10 x2



P30 x2

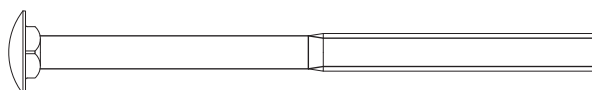

S160 x2

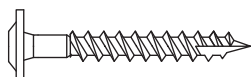

T60 x4

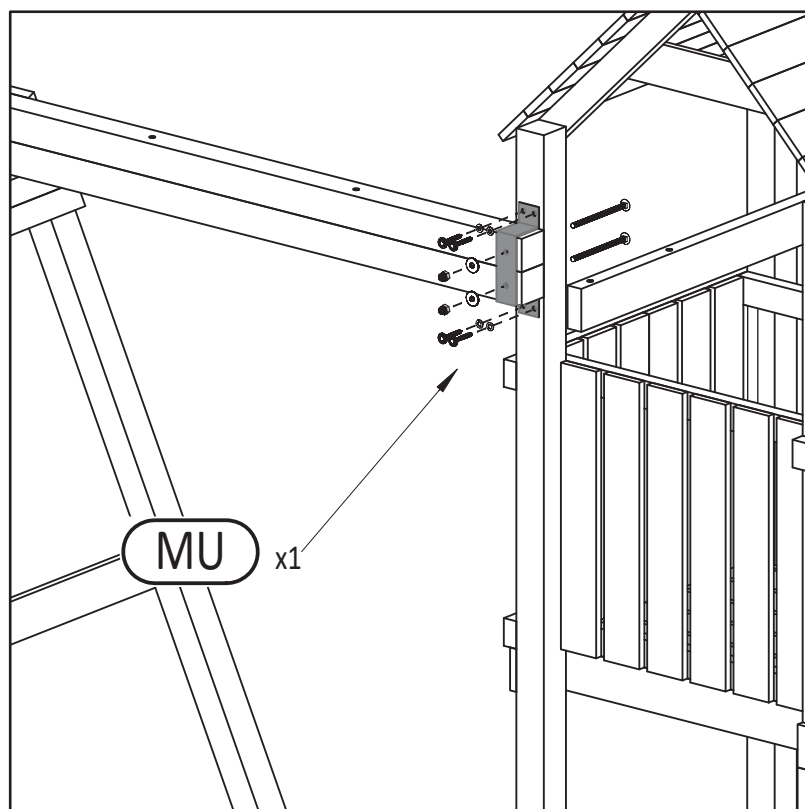
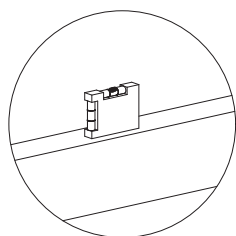

MU

x1

18

ACTIVER

Zgodnie z normą PN-EN 71 stosuj zalecenia producenta odnośnie odległości oraz metody mocowania poszczególnych elementów

In compliance with the standard PN-EN 71, apply guidelines of the producer in relation to distances and methods of fastening individual elements

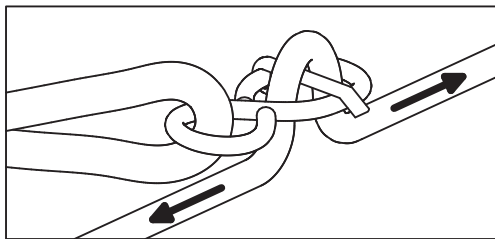

ZK x2



SE x1

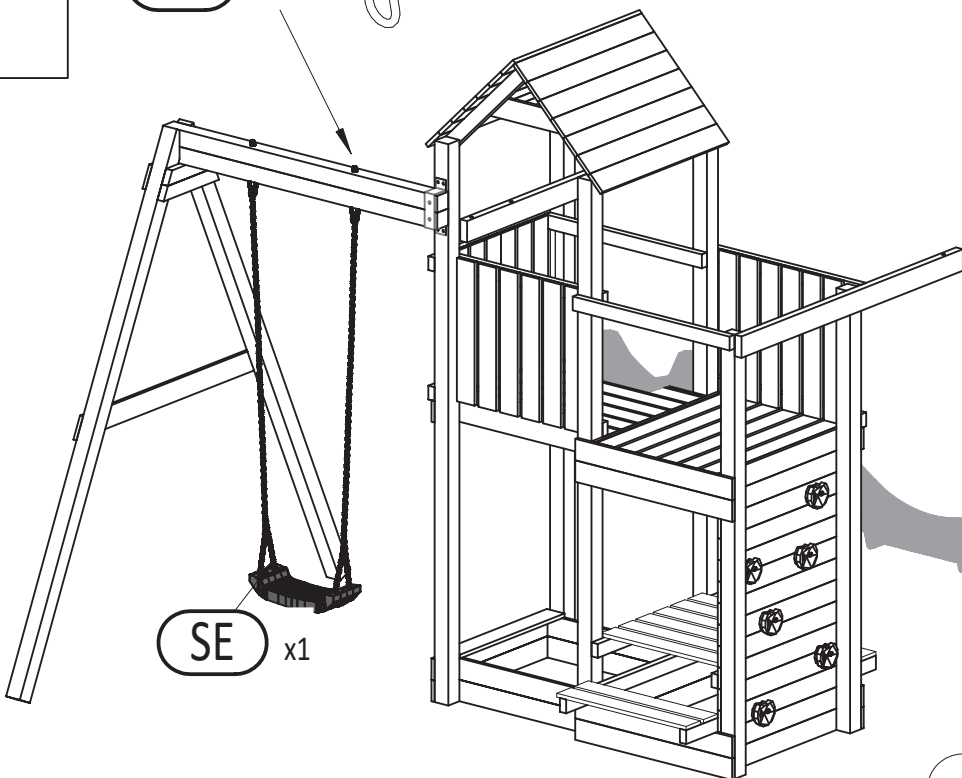

M12 x2

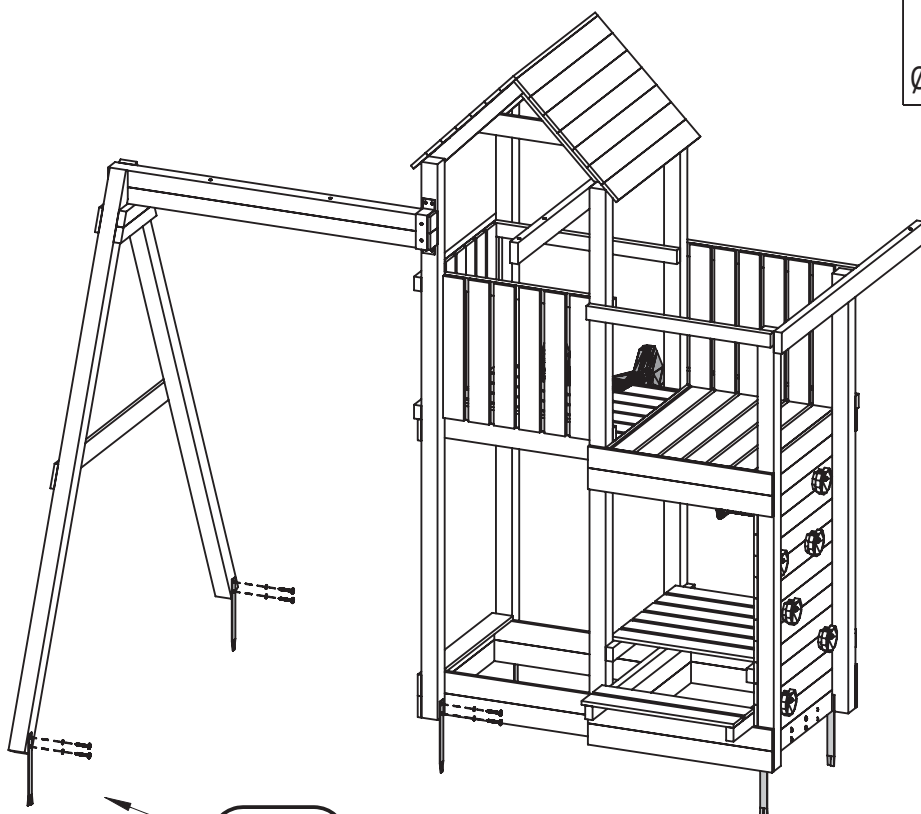
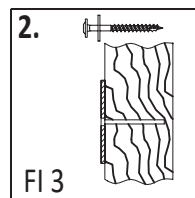
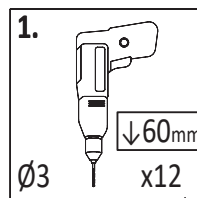

MG x6

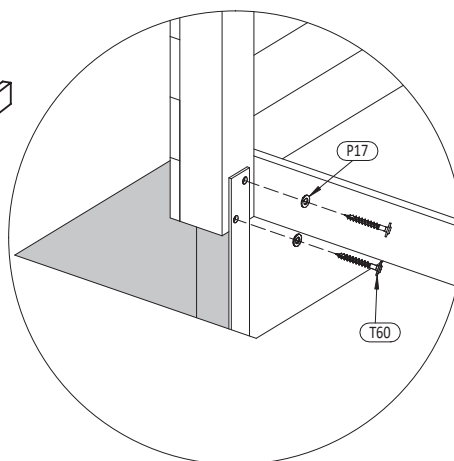

P17 x12

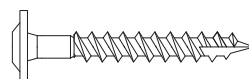

T60 x12

29

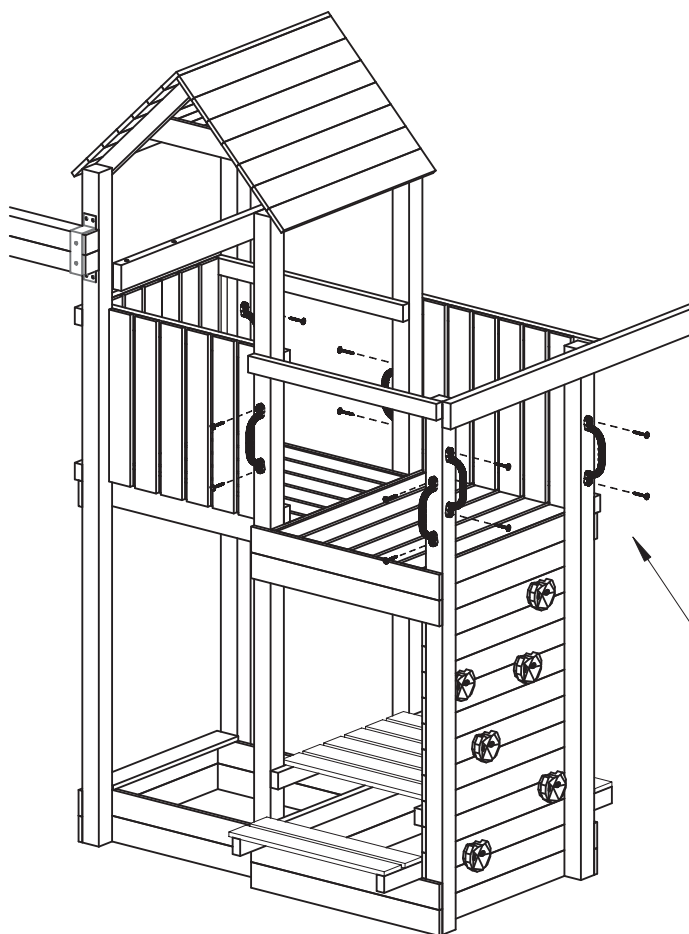
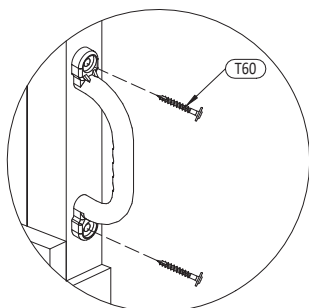
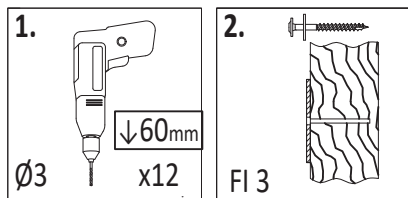

UC x6

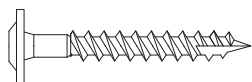

T60 x12

30

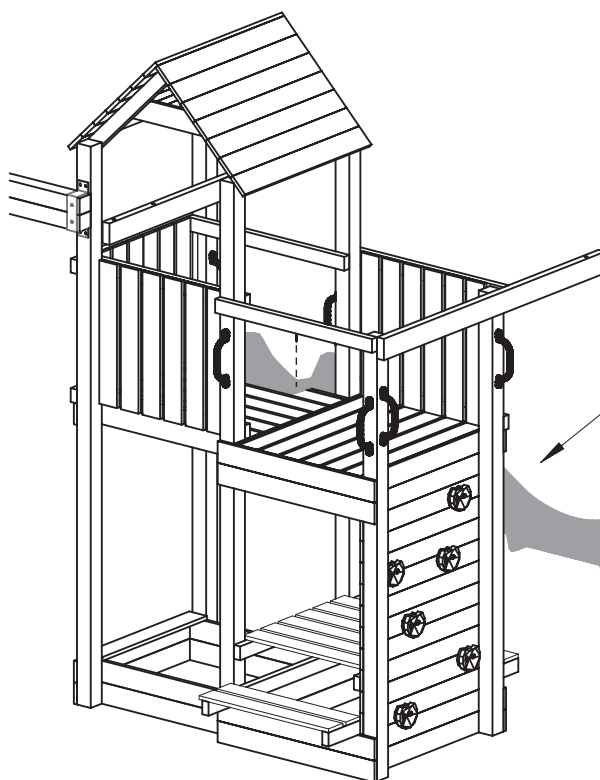
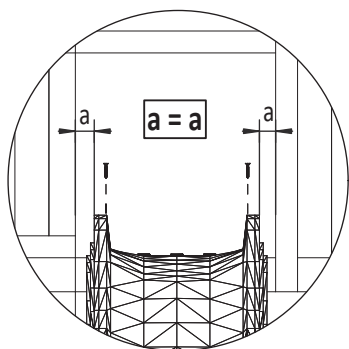

Z x1



W30 x2

20 ACTIVER

Zgodnie z normą PN-EN 71 stosuj zalecenia producenta odnośnie odległości oraz metody mocowania poszczególnych elementów
 In compliance with the standard PN-EN 71, apply guidelines of the producer in relation to distances and methods of fastening individual elements

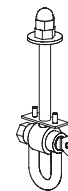
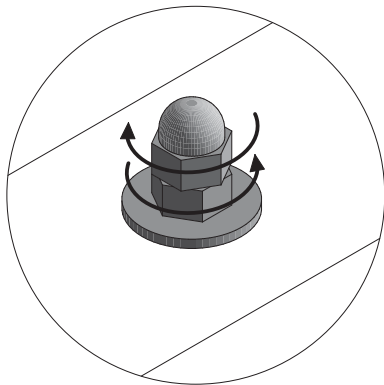

31

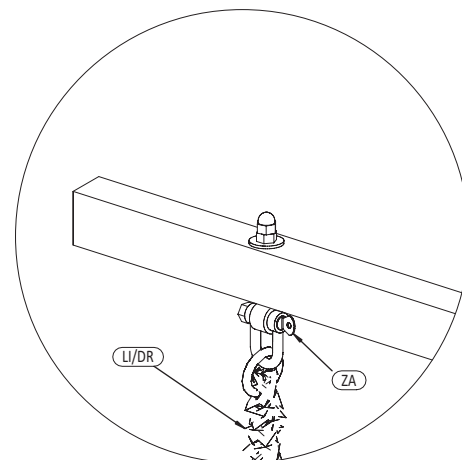

LI x1



M12 x1

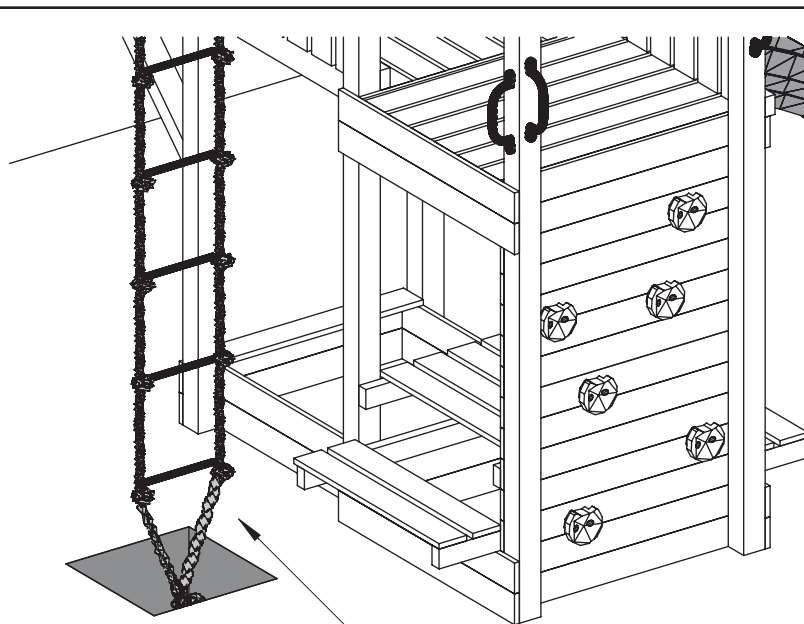

DR x1

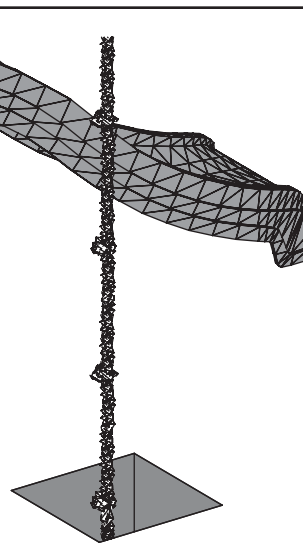

OP x2

KT x2

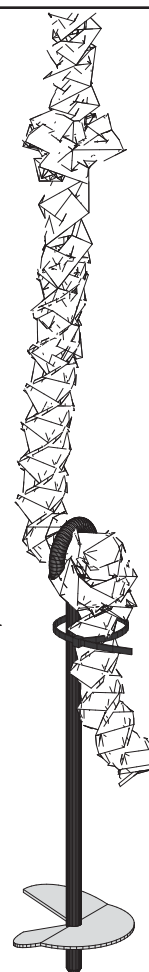
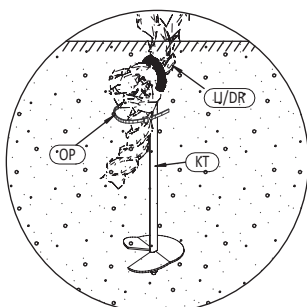

32

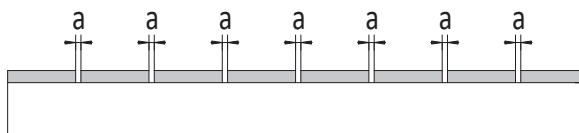
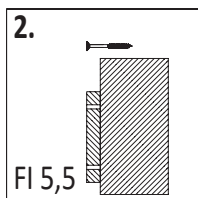
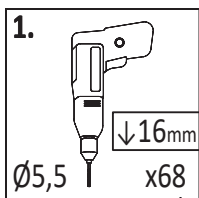

!!!min 2mm < a < !!!max 6mm

