

# PLAYGROUND SPIELPLATZ

# PLAC ZABAW AIRE DE JEUX

(367 x 480 x h298cm)

003\_09590\_25072024

## LOFTER\_2S

### INSTALLATION INSTRUCTIONS MONTAGEANLEITUNG

### INSTRUKCJA MONTAŻU GUIDE D'INSTALLATION

Warranty period - 2 years from purchase date  
Garantiezeit - 2 Jahre ab Kaufdatum

Okres gwarancji - 2 lata od momentu zakupu towaru  
Période de garantie - 2 ans à compter de l'achat

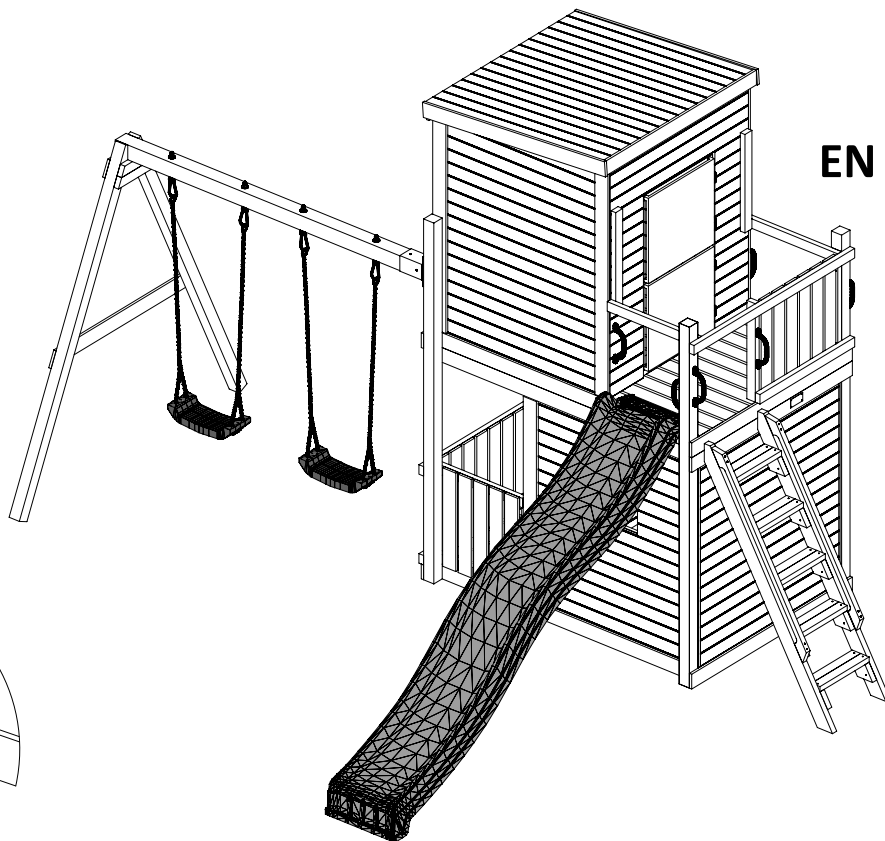
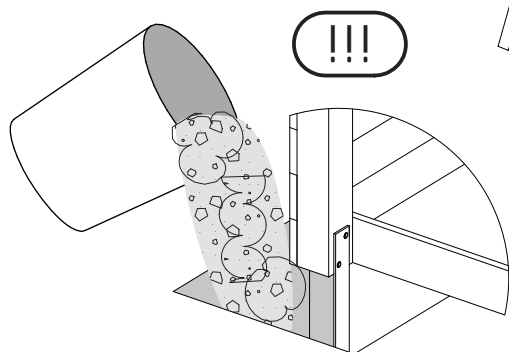

### WARNINGS!

Only for home use.  
Dedicated for external use only.  
Not suitable for children under 3 years old.  
Risk of falling down and/or hitting.  
Maximum user weight is up to 50 kg.  
Maximum number of users staying on the  
playground at the same time: 12.

### ACHTUNG!

Nur für den privaten, häuslichen Bereich.  
Ausschließlich für die Verwendung im Freien.  
Nicht geeignet für Kinder unter 3 Jahren.  
Stolper- und / oder Sturzgefahr  
Höchstgewicht pro Einzelkind beträgt 50 kg  
Der Aufenthalt auf diesem Spielturm ist max. : 12.  
Kindern gleichzeitig erlaubt.

### OSTRZEŻENIA!

Tylko do użytku domowego.  
Przeznaczony do użytku na zewnątrz.  
Nie przeznaczony dla dzieci poniżej 3 roku życia.  
Niebezpieczeństwo upadku i/lub uderzenia.  
Maksymalna waga użytkownika to 50 kg.  
Maksymalna liczba użytkowników przebywających  
na placu zabaw w tym samym czasie: 12.

### AVERTISSEMENT!

Aire exclusivement destinée à un usage privé.  
Aire exclusivement destinée à un usage en extérieur.  
Prévue pour les enfants de plus de 3 ans.  
Danger de chute ou de choc.  
Poids maximal d'un utilisateur : 50 kg.  
Nombre maximal d'utilisateurs présents en  
même temps sur la même aire de jeux: 12.

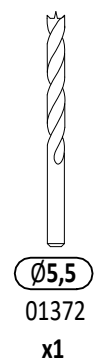
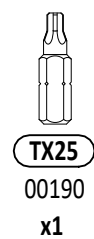
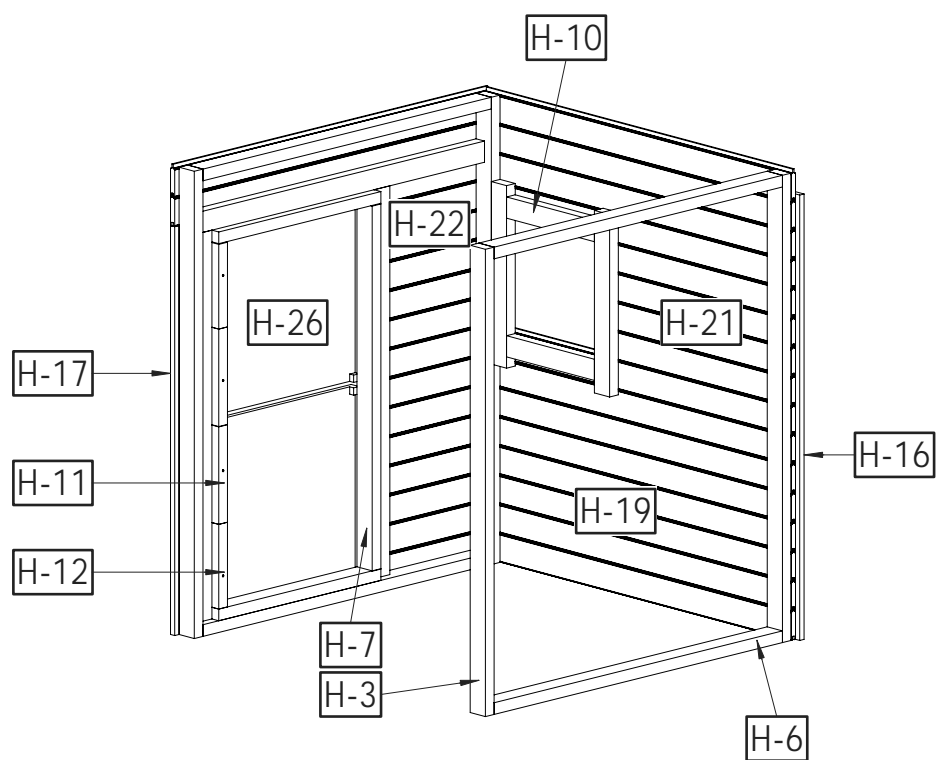
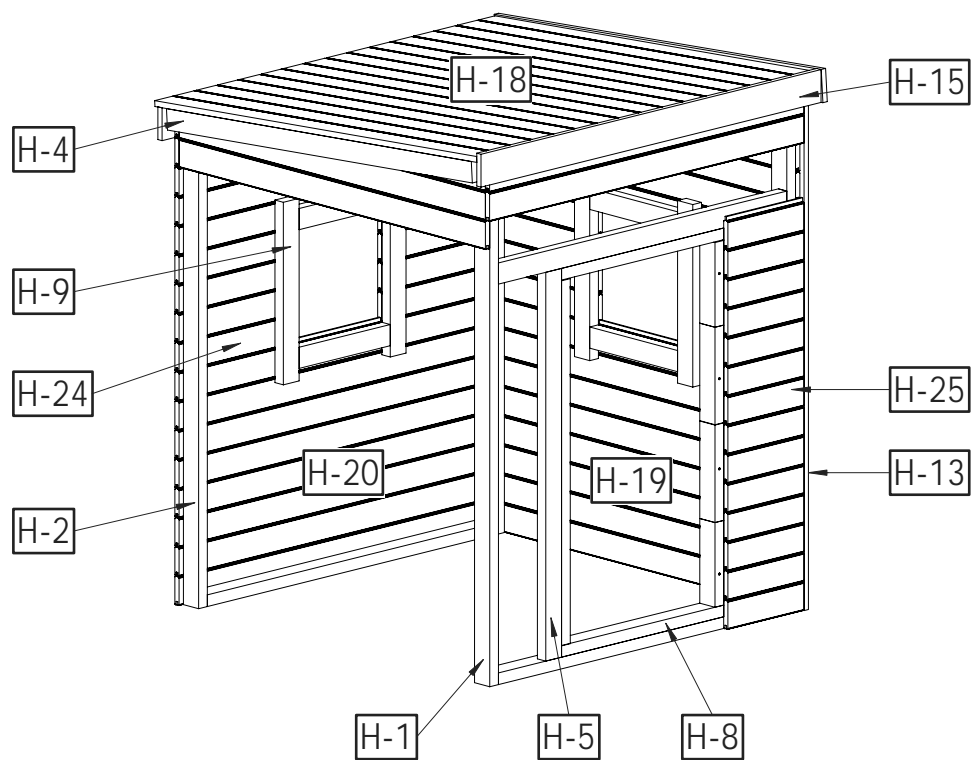

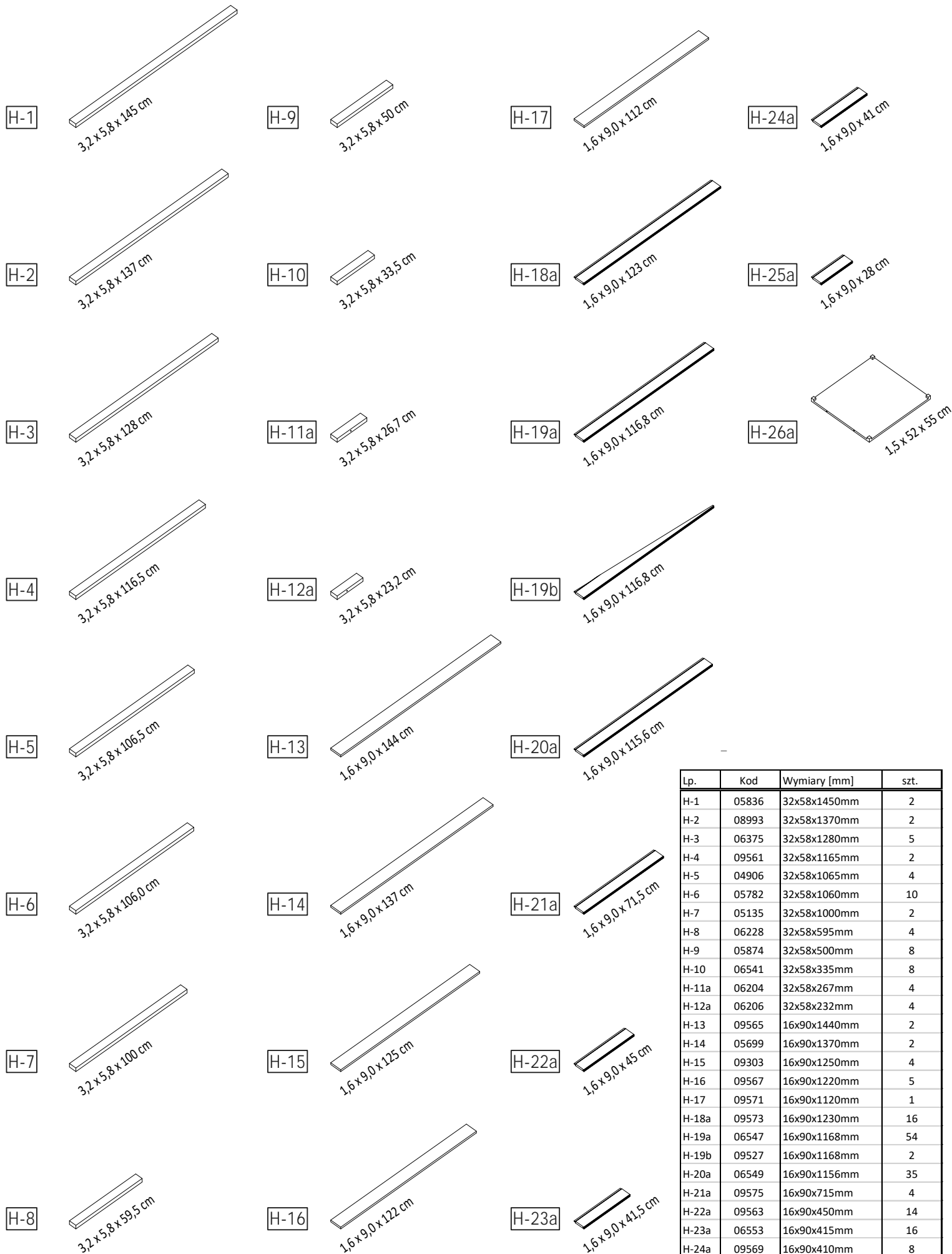

Lp.	Kod	Wymiary [mm]	szt.
H-1	05836	32x58x1450mm	2
H-2	08993	32x58x1370mm	2
H-3	06375	32x58x1280mm	5
H-4	09561	32x58x1165mm	2
H-5	04906	32x58x1065mm	4
H-6	05782	32x58x1060mm	10
H-7	05135	32x58x1000mm	2
H-8	06228	32x58x595mm	4
H-9	05874	32x58x500mm	8
H-10	06541	32x58x335mm	8
H-11a	06204	32x58x267mm	4
H-12a	06206	32x58x232mm	4
H-13	09565	16x90x1440mm	2
H-14	05699	16x90x1370mm	2
H-15	09303	16x90x1250mm	4
H-16	09567	16x90x1220mm	5
H-17	09571	16x90x1120mm	1
H-18a	09573	16x90x1230mm	16
H-19a	06547	16x90x1168mm	54
H-19b	09527	16x90x1168mm	2
H-20a	06549	16x90x1156mm	35
H-21a	09575	16x90x715mm	4
H-22a	09563	16x90x450mm	14
H-23a	06553	16x90x415mm	16
H-24a	09569	16x90x410mm	8
H-25a	06559	16x90x280mm	28
H-26a	06809	15x550x520mm	4

W80 x269

+1 Gratis

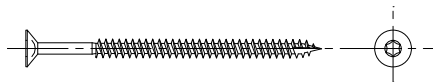

W40 x1044

+11 Gratis



W30 x2

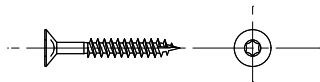

W20 x4



T80 x41

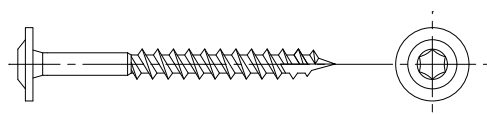

T60 x52

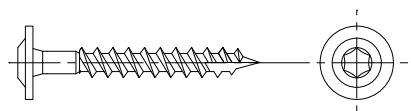

S50 x8

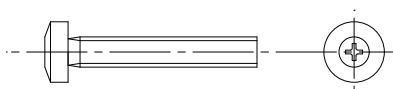

S30 x16

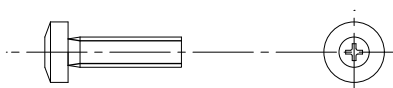

L11 x24

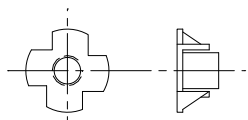

P17 x28

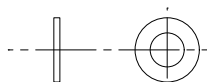

P15 x16

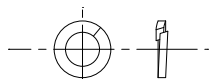

M12 x4

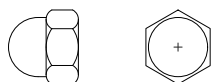

OS1 x43

+3 Gratis



Ø3  
00239  
x1

Ø5,5  
01372  
x1

Ø10  
00188  
x1

PH3  
00068  
x1

PZ2  
00241  
x1

TX25  
00190  
x1

TX30  
00316  
x1

TX40  
00242  
x1



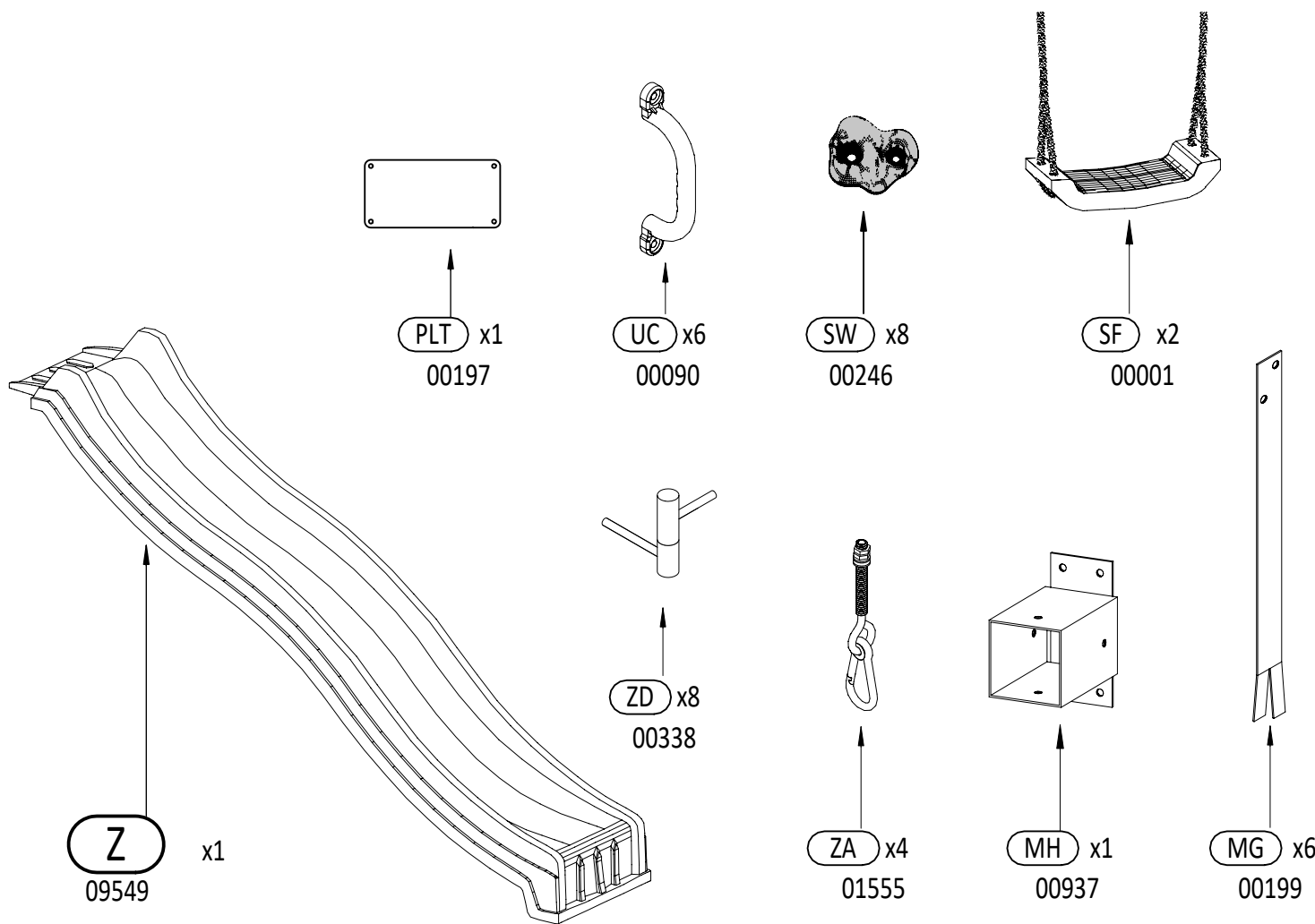
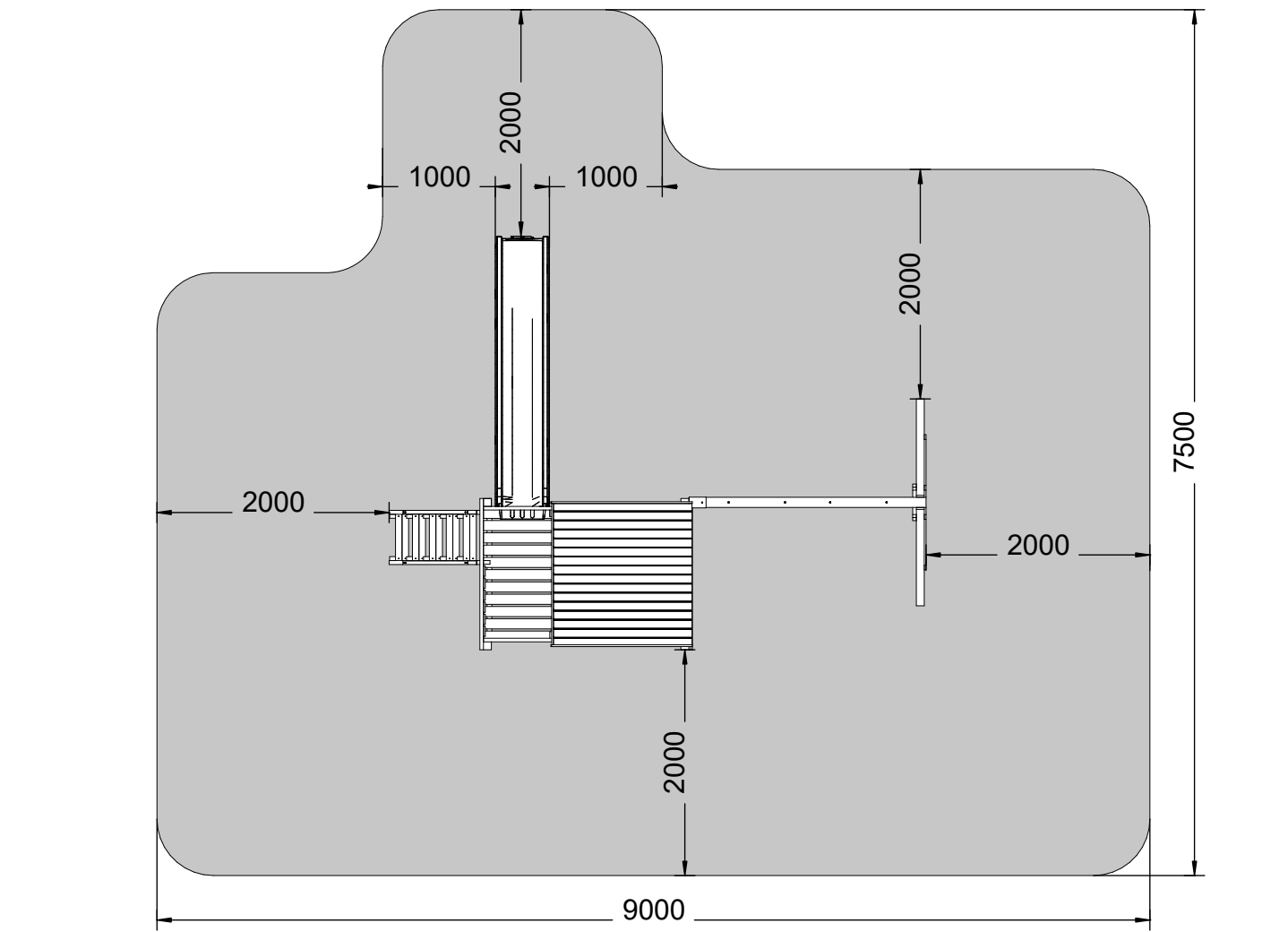

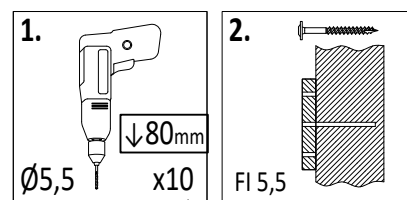
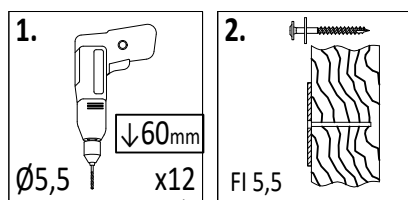
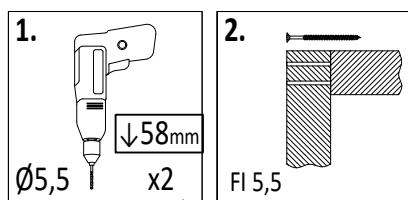
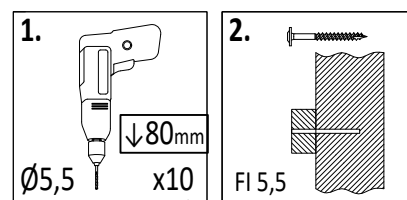
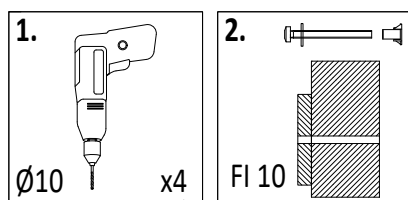
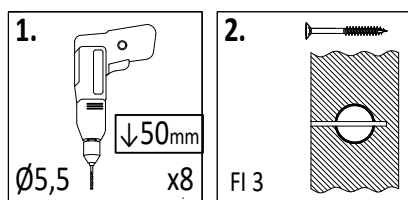
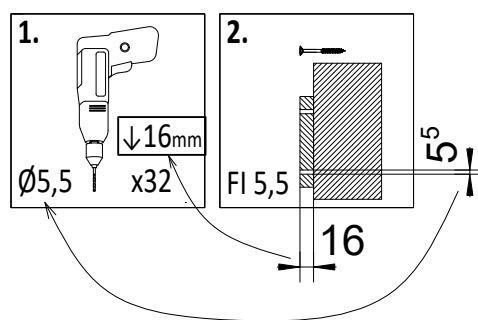
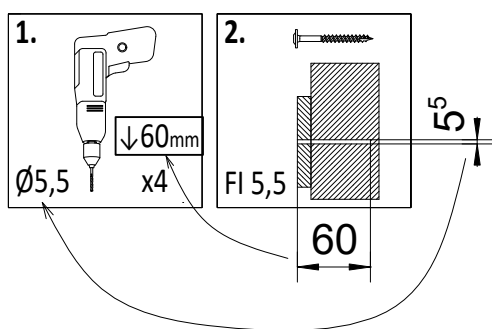
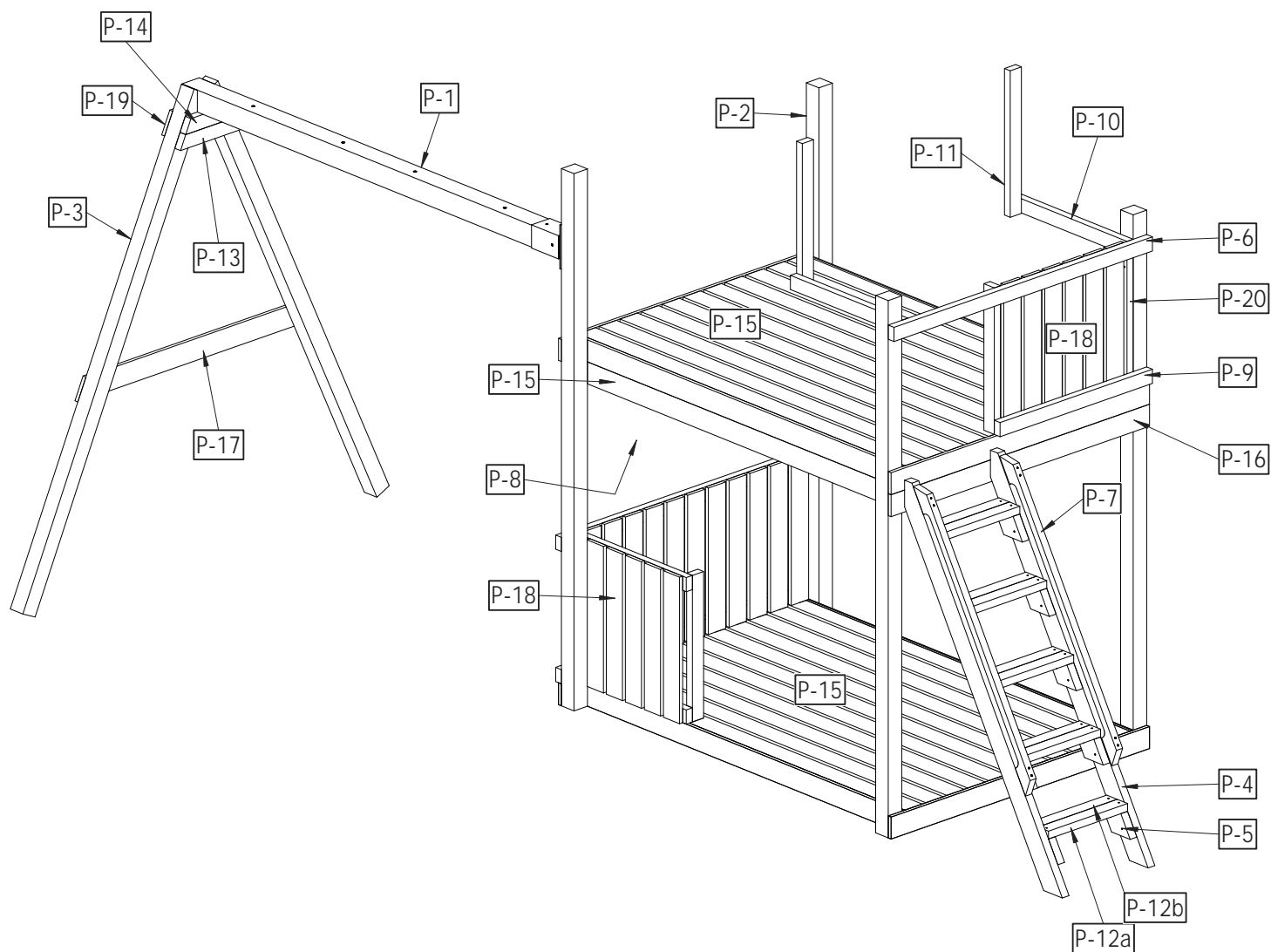

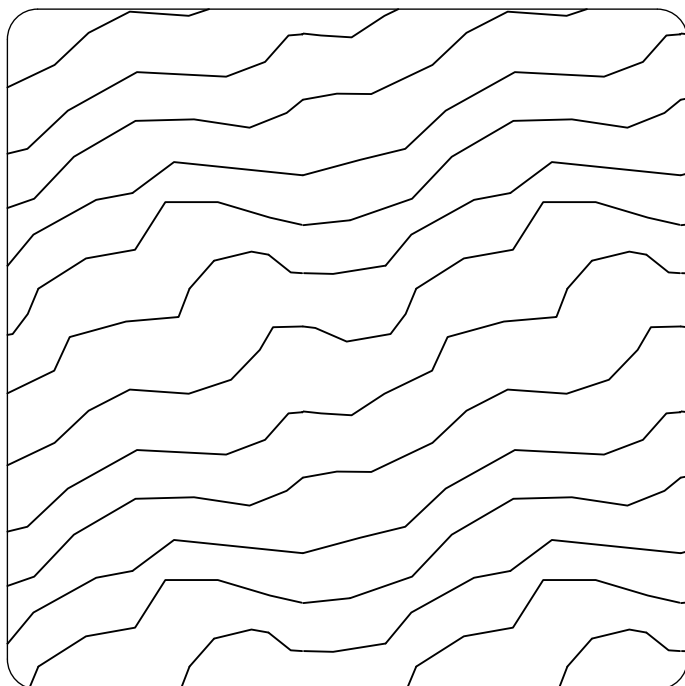

**9 x 9 cm**

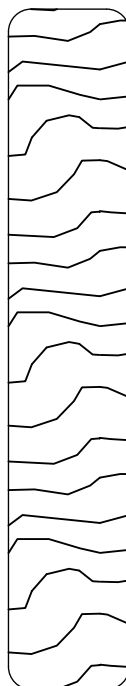

**1,6 x 9,0 cm**

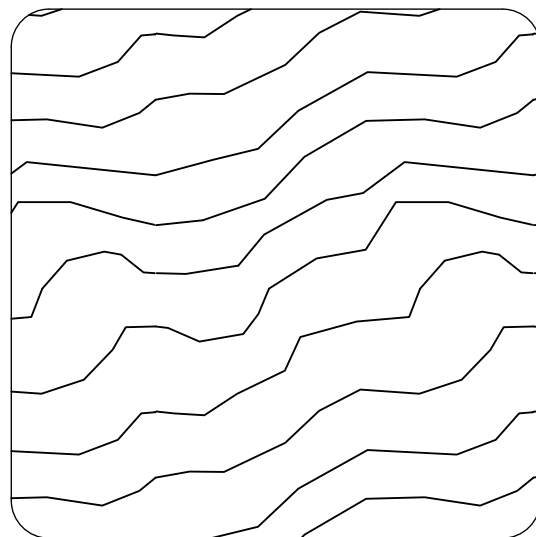

**7,0 x 7,0 cm**

Lp.	Kod	Wymiary [mm]	szt.
P-1a	04655	90x90x2100mm	1

Lp.	Kod	Wymiary [mm]	szt.
P-15	06567	16x90x1820mm	30
P-16	05558	16x90x1340mm	5
P-17a	03920	16x90x1200mm	1
P-18	04625	16x90x600mm	22
P-19a	05187	16x90x300mm	1

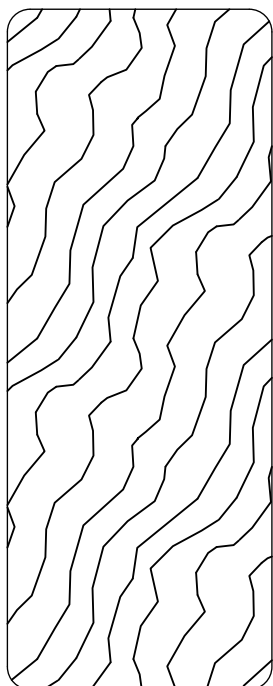

**3,5 x 9,0 cm**

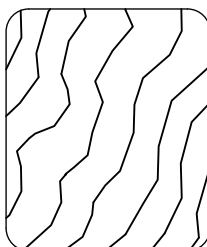

**2,7 x 3,2 cm**

Lp.	Kod	Wymiary [mm]	szt.
P-20a	04471	27x32x542mm	1

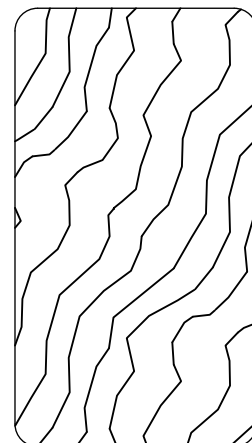

**3,2 x 5,8 cm**

Lp.	Kod	Wymiary [mm]	szt.
P-4a	06707	35x90x1695mm	2
P-5a	00730	35x90x156mm	10

Lp.	Kod	Wymiary [mm]	szt.
P-6	05816	32x58x1340mm	3
P-7a	01412	32x58x1250mm	2
P-8	05353	32x58x1168mm	8
P-9	05217	32x58x790mm	1
P-10	05327	32x58x620mm	4
P-11	03100	32x58x600mm	4
P-12a	00350	32x58x410mm	5
P-12b	00340	32x58x410mm	5
P-13a	05177	32x58x324mm	1
P-14a	05179	32x58x270mm	1

P-1a

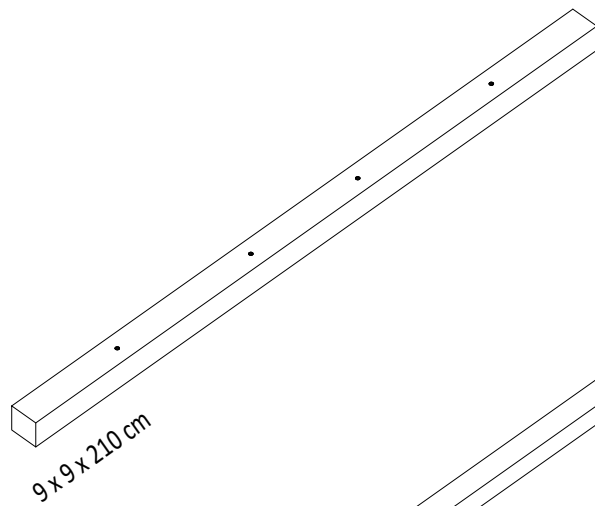

P-2

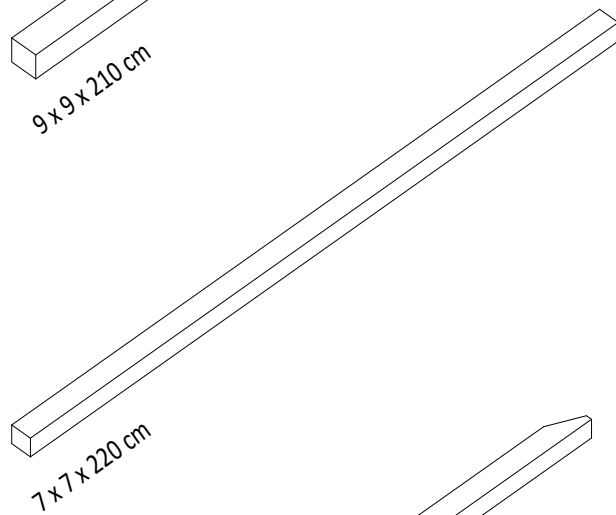

P-3a

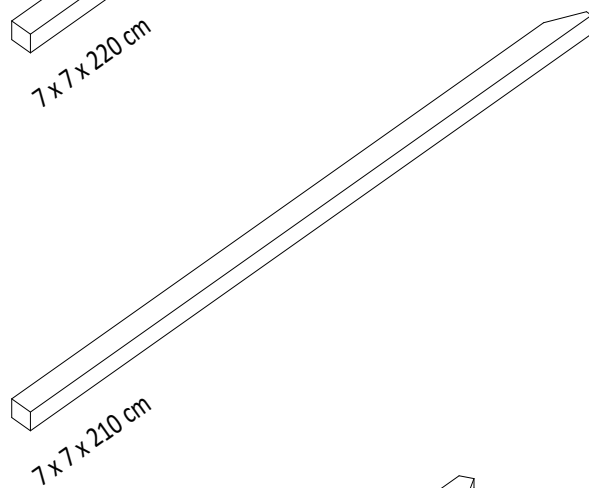

P-4a

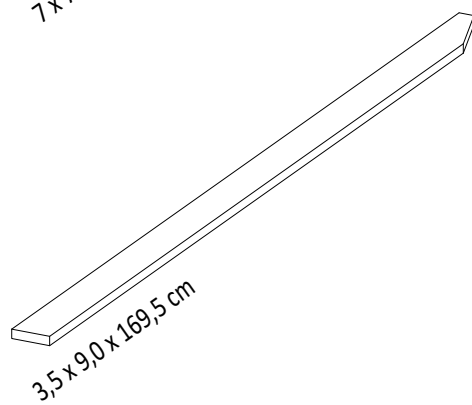

P-5a

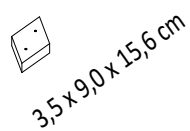

P-6

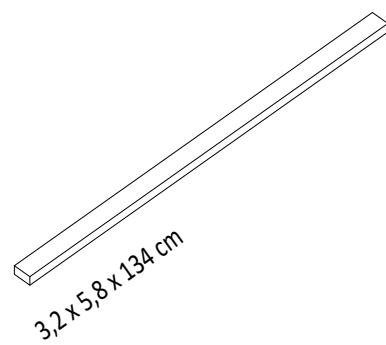

P-7a

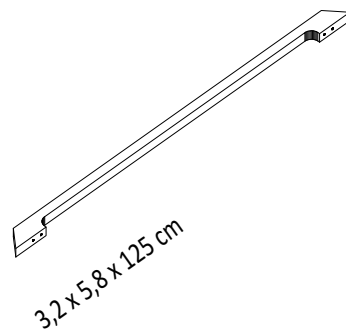

P-8

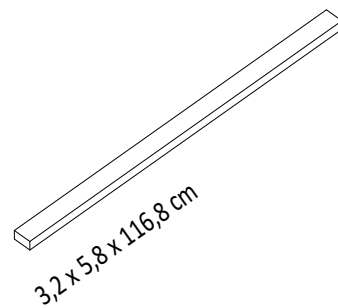

P-9

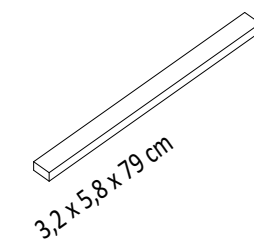

P-10

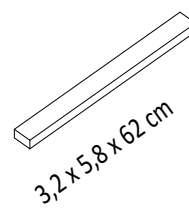

P-11

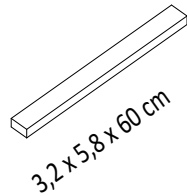

P-12a

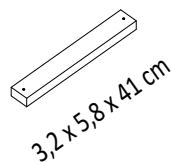

P-12b

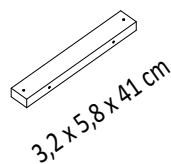

P-13a

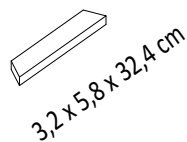

P-14a

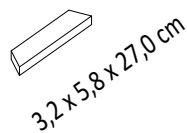

P-15

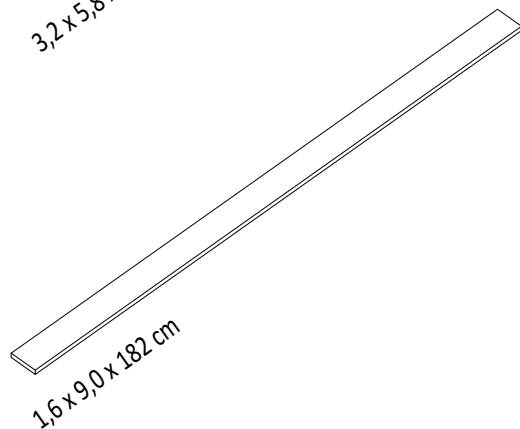

P-16

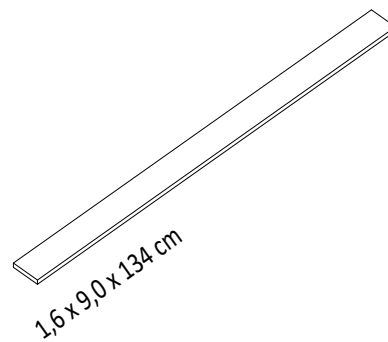

P-17a

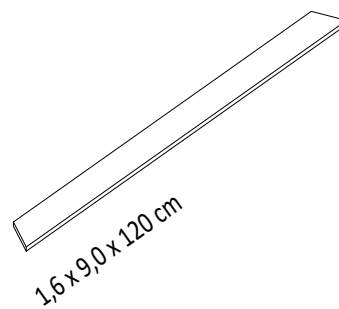

P-18

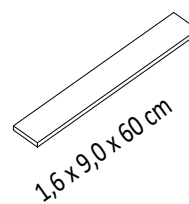

P-19a

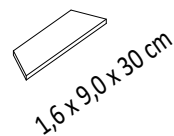

P-20a

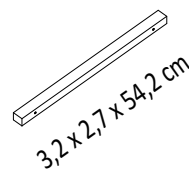

01

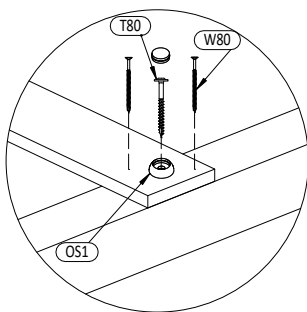
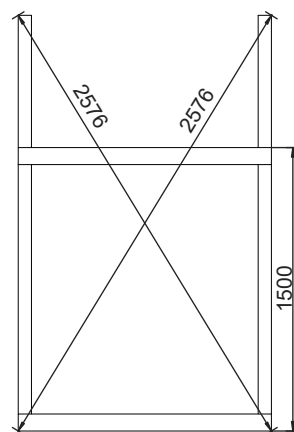
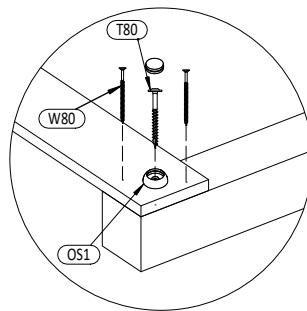
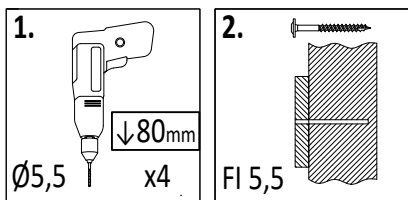

!!! x2



OS1 x4 \*2 = 8

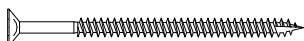

W80 x8 \*2 = 16

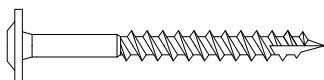

T80 x4 \*2 = 8

**P-2** 7,0x7,0x220cm  
x2

**P-16** 1,6x9,0x134cm  
x2

02

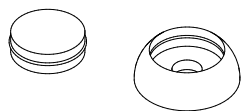
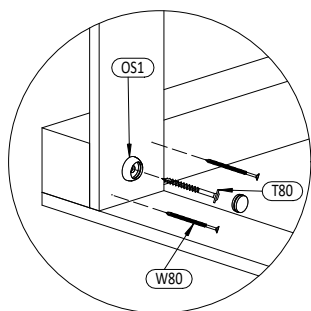
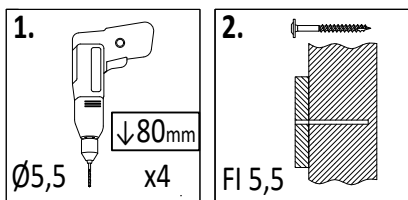

OS1 x2

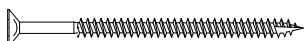

W80 x12

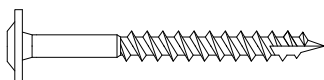

T80 x4

**P-15** 1,6x9,0x182cm  
x6

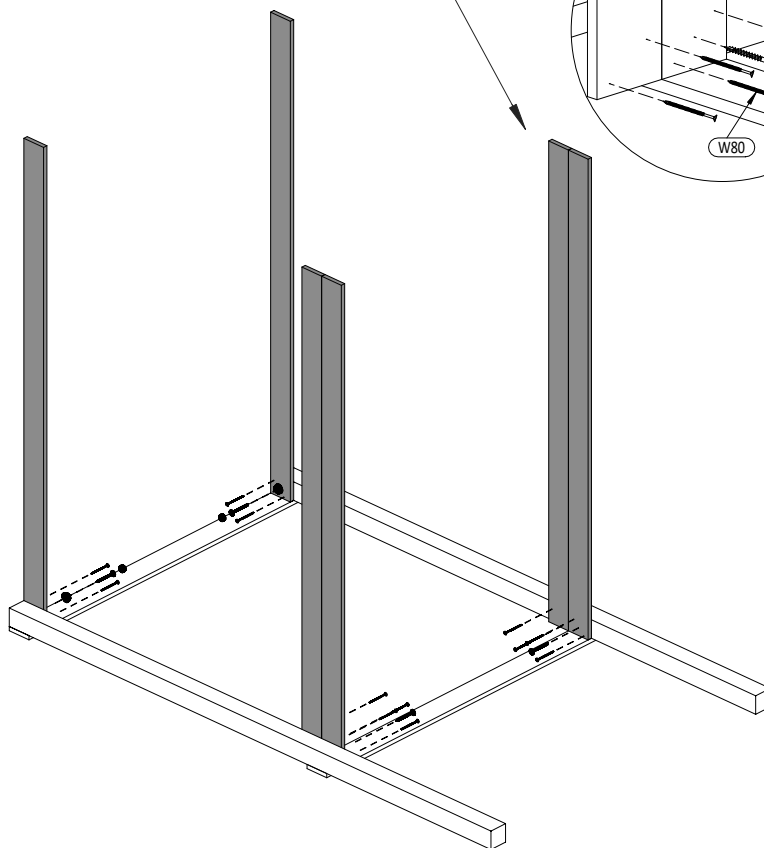
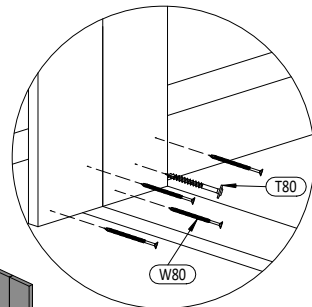

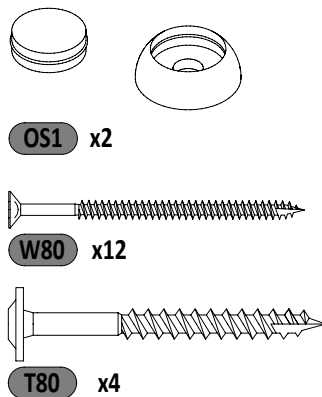
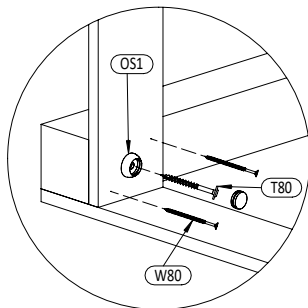
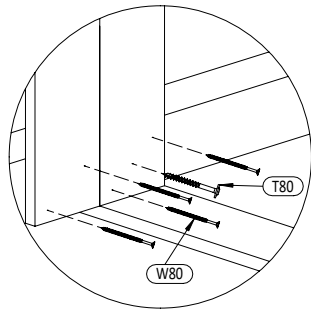
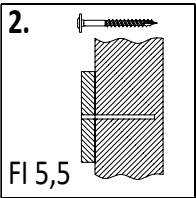
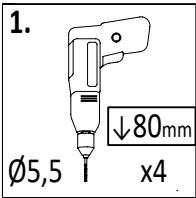
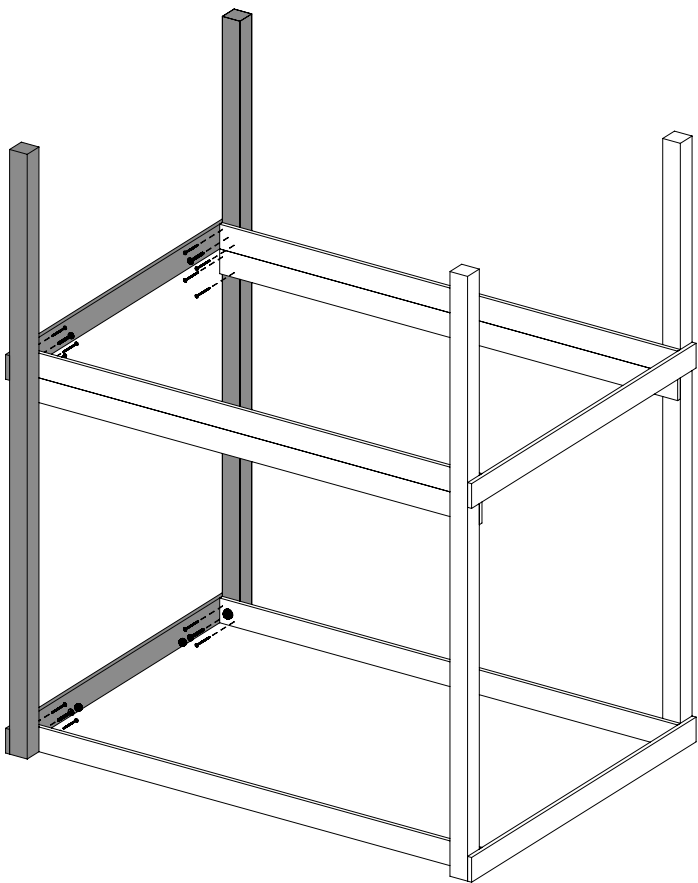

**P-8** 3,2x5,8x116,8cm x4

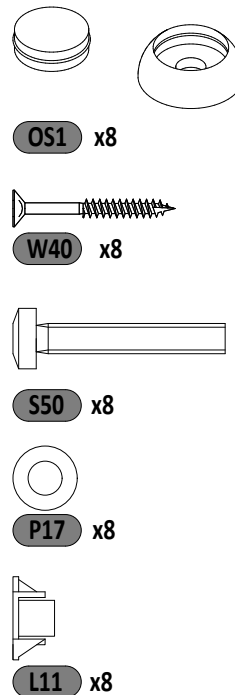
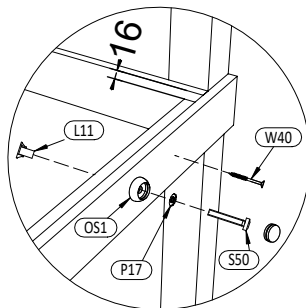
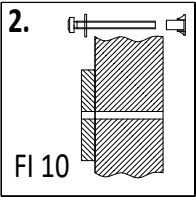
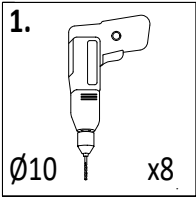
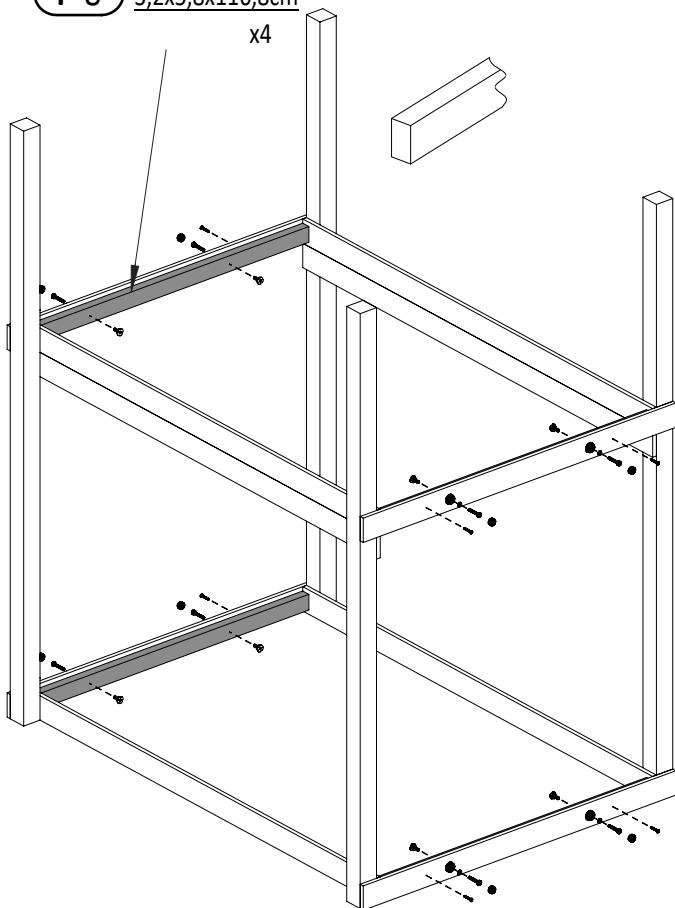

05

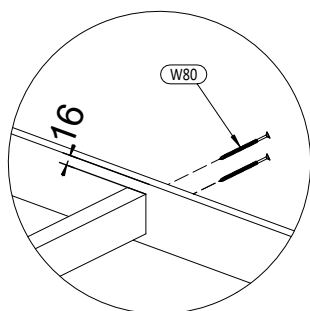

W80 x16

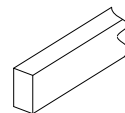

P-8 3,2x5,8x116,8cm

x4

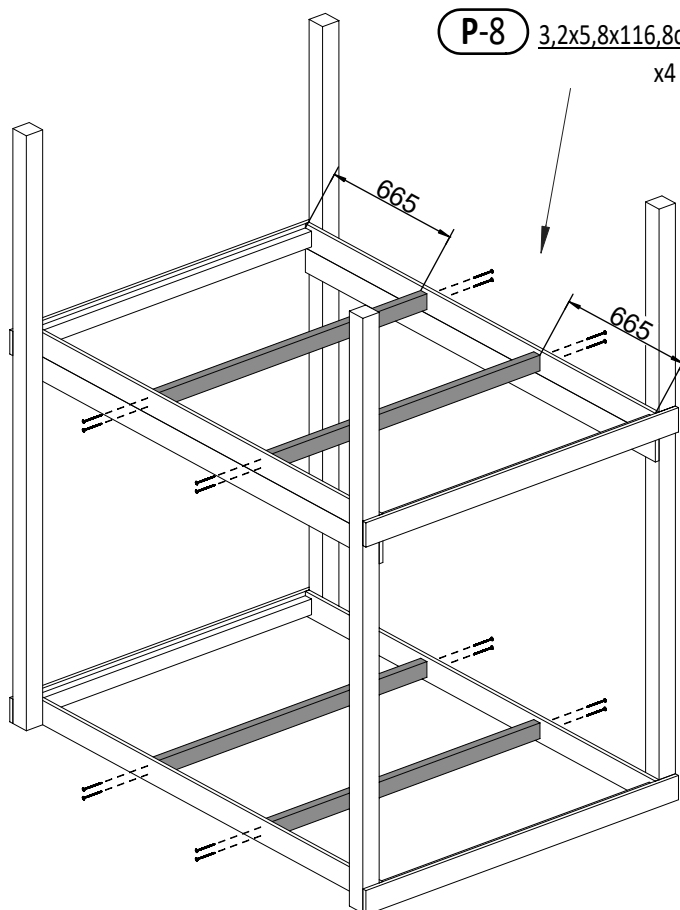

06

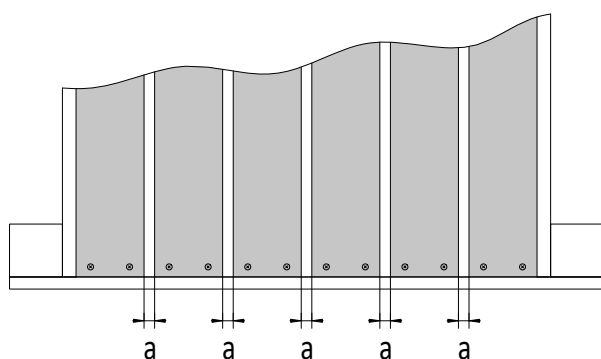
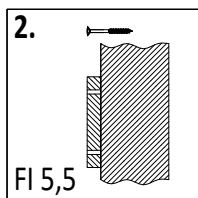
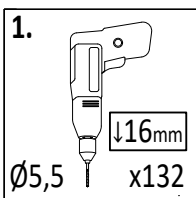

!!!min 13mm &lt; a &lt; !!!max 16mm

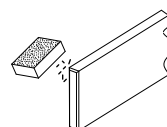

P-15 1,6x9,0x182cm

x22

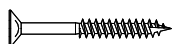
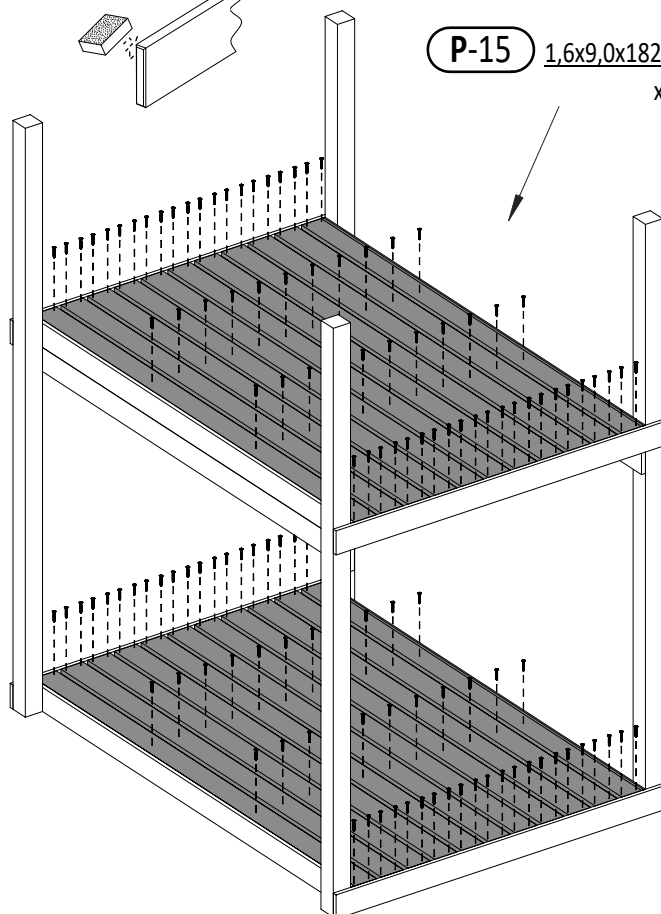

W40 x132



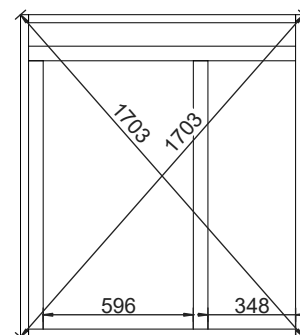
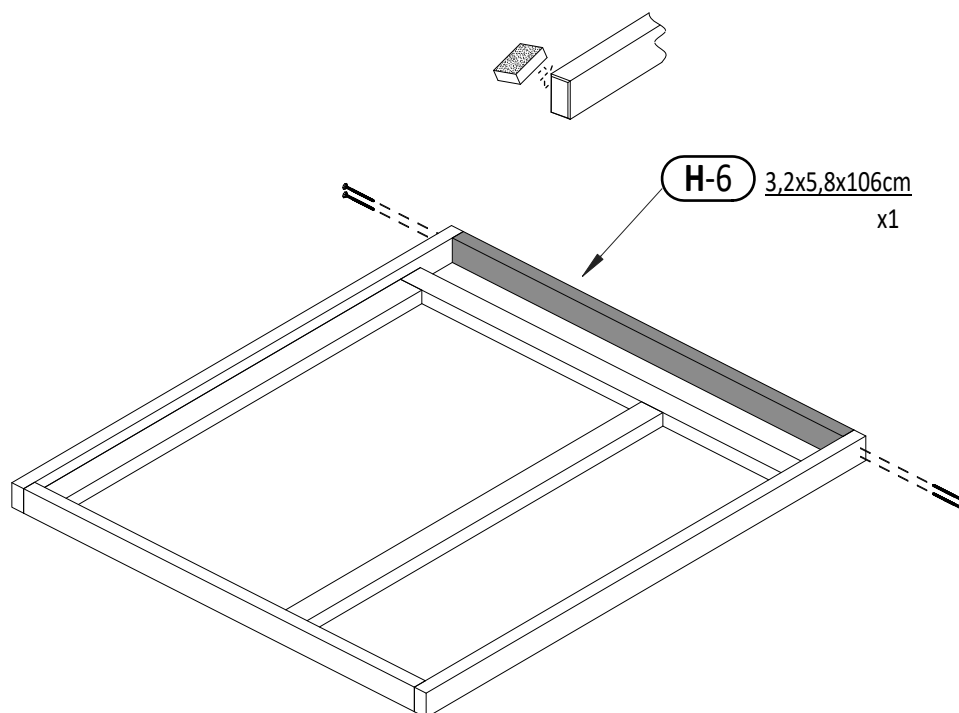
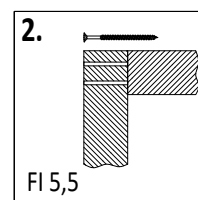
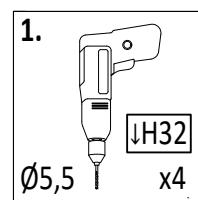
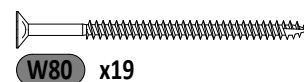
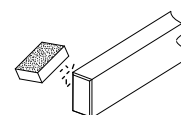
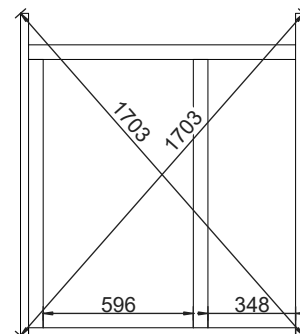
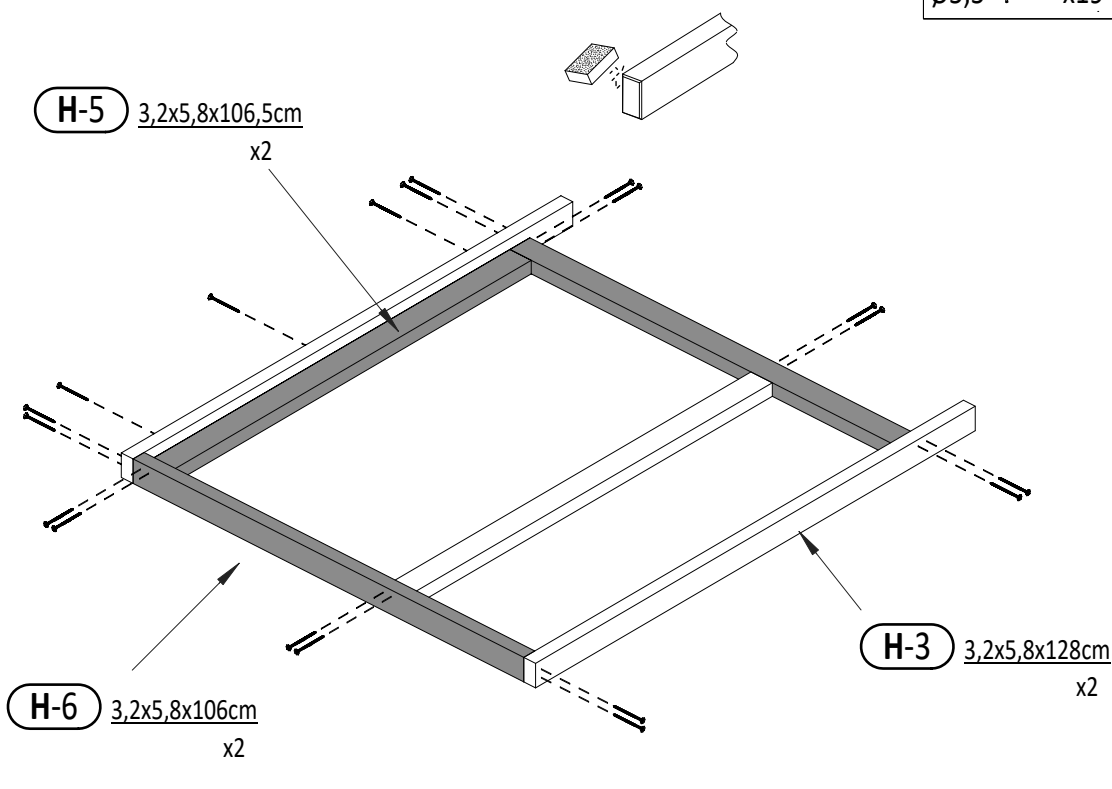
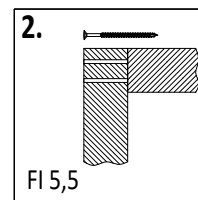
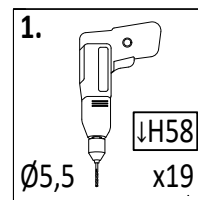

09

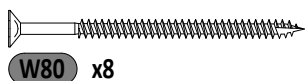
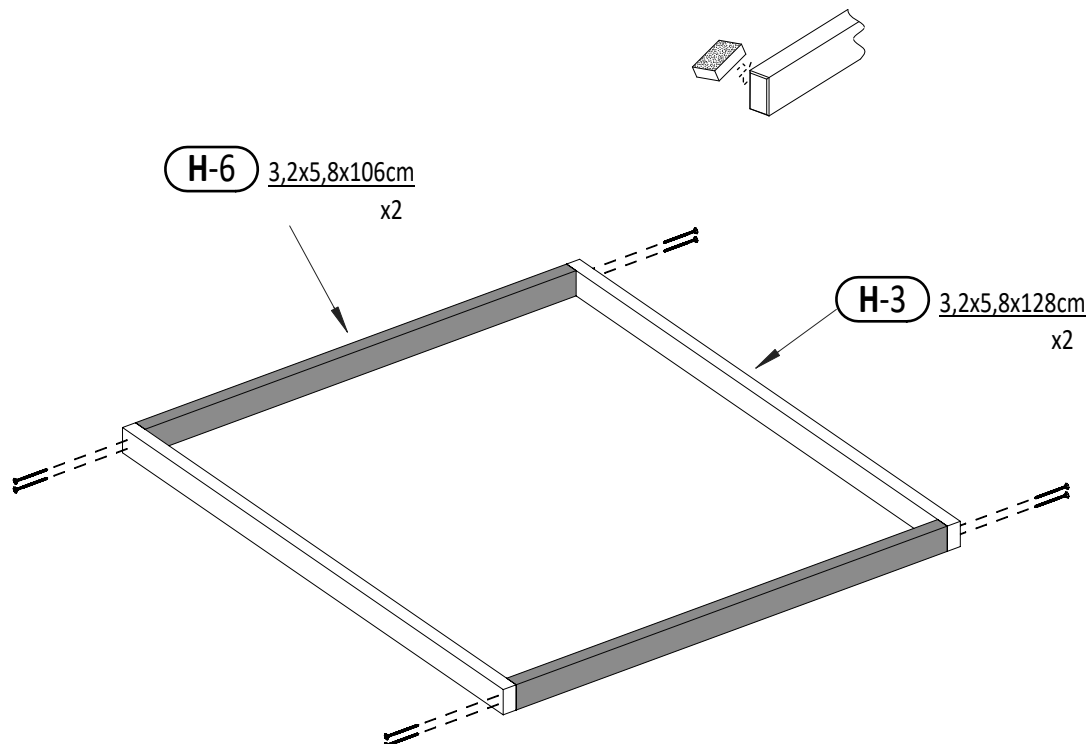
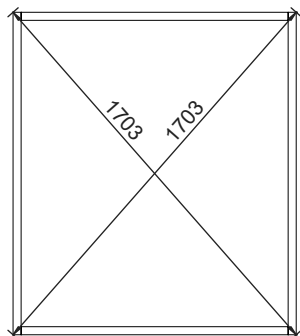
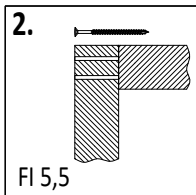
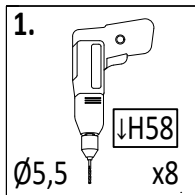

10

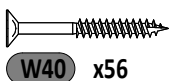
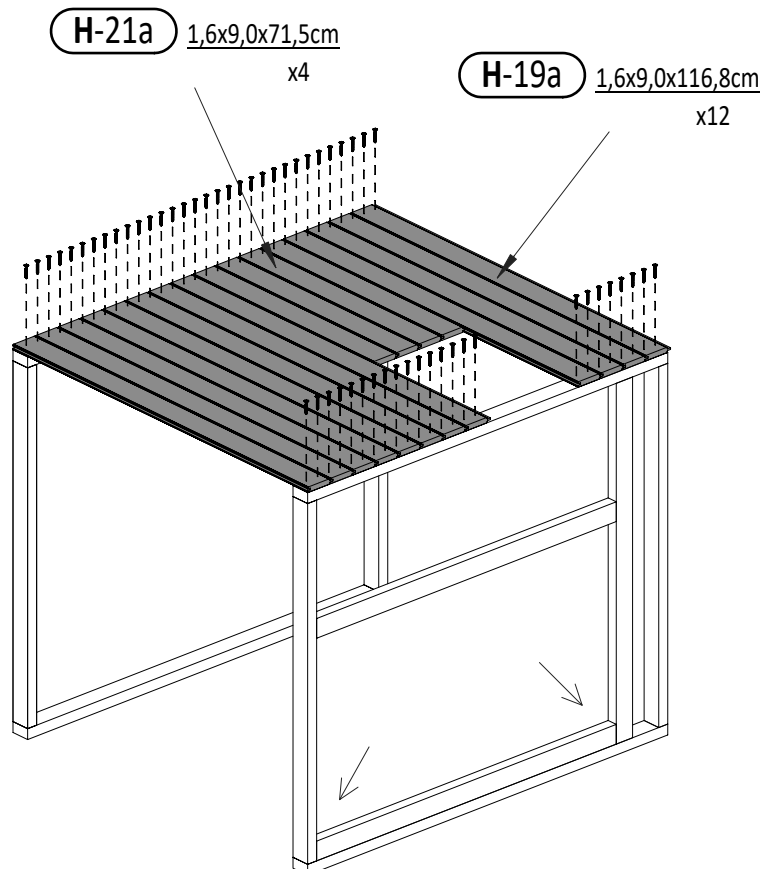
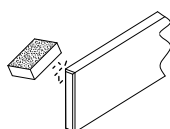
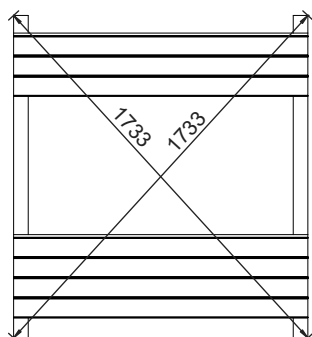
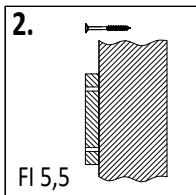
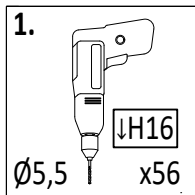

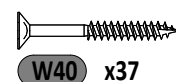
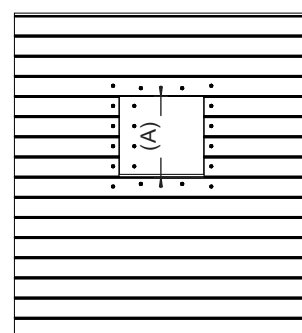
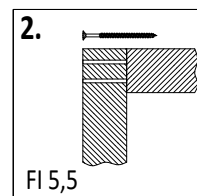
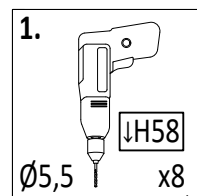
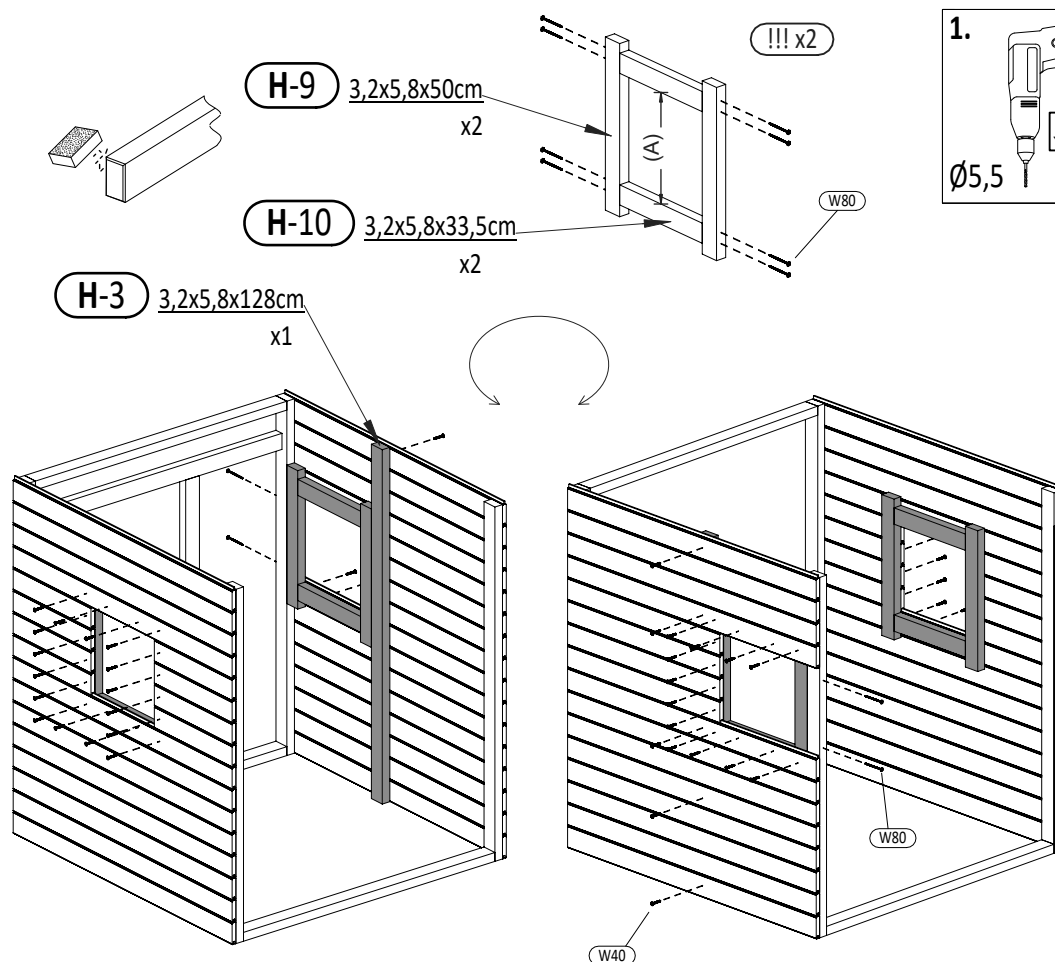
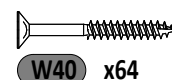
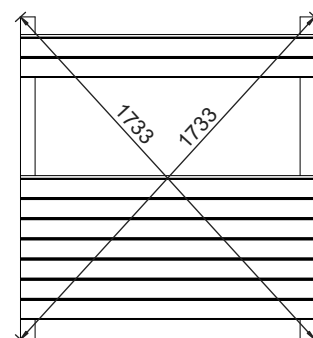
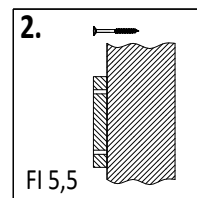
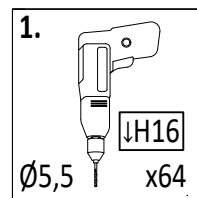
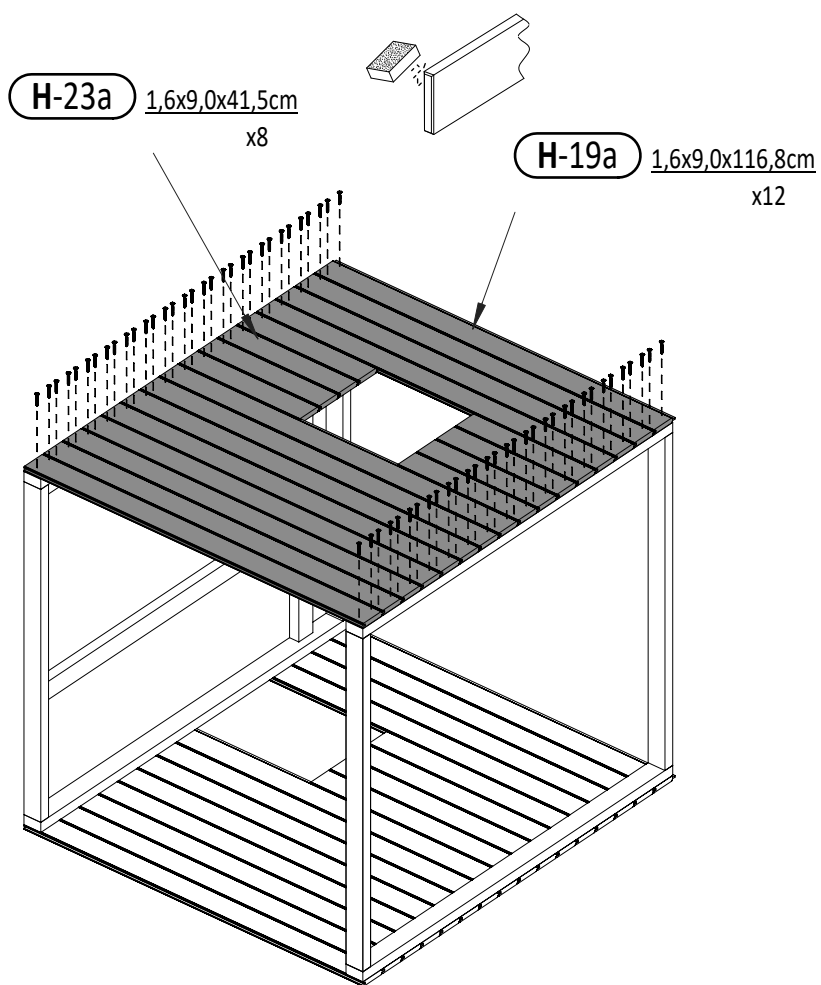

13

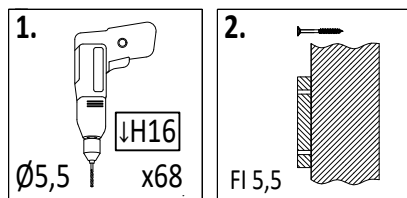

**H-20a** 1,6x9,0x115,6cm  
x16

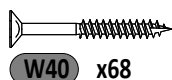
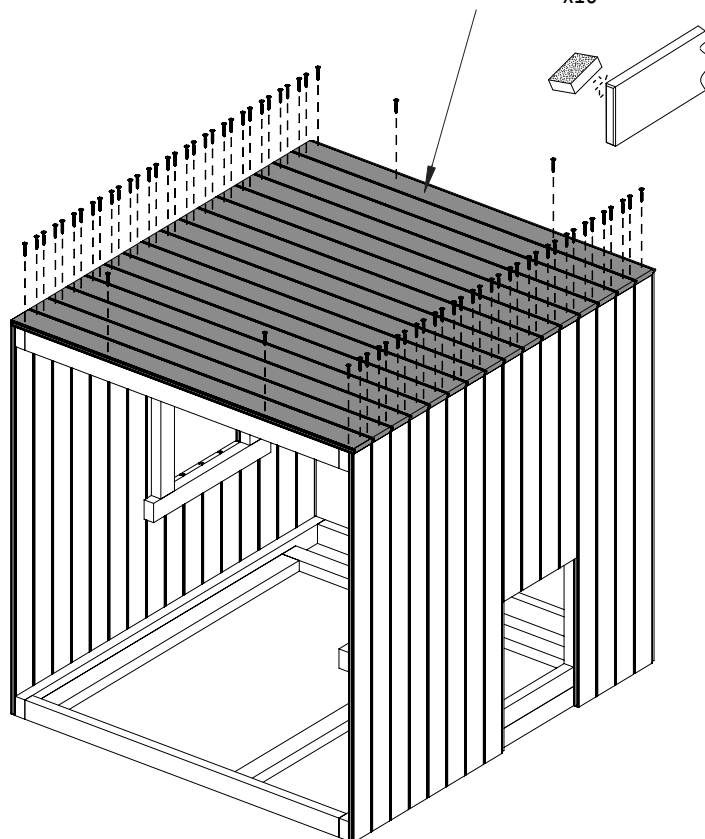

14

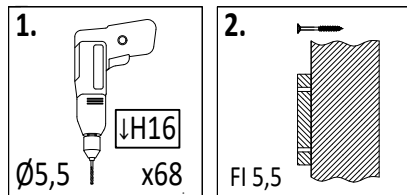

**H-22a** 1,6x9,0x45cm  
x14

**H-20a** 1,6x9,0x115,6cm  
x2

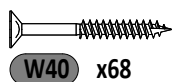
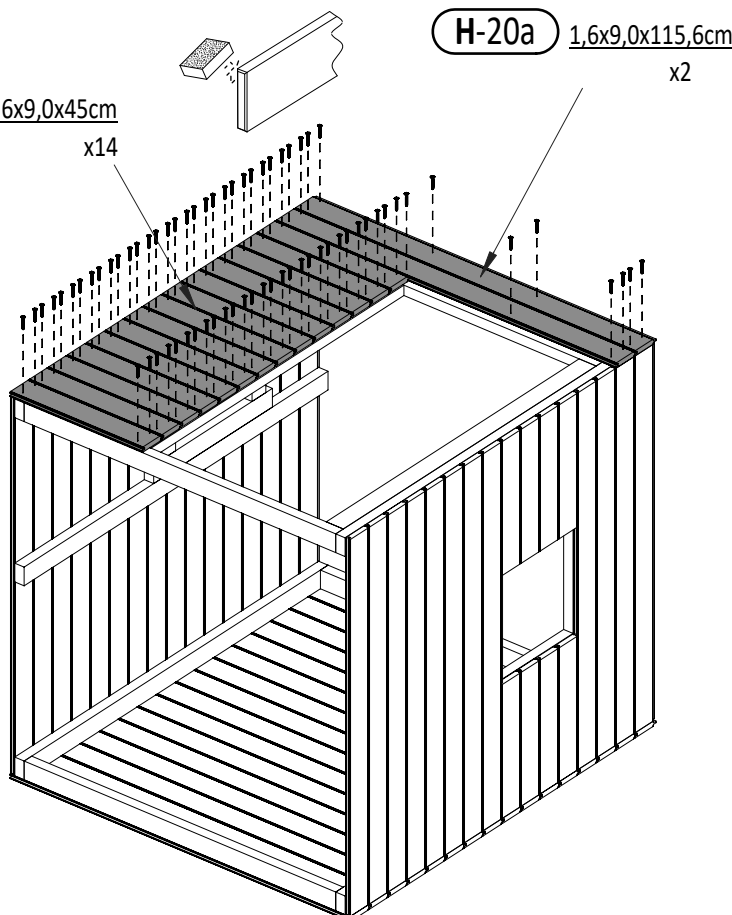

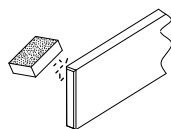

**H-16** 1,6x9,0x122cm  
x5

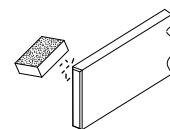
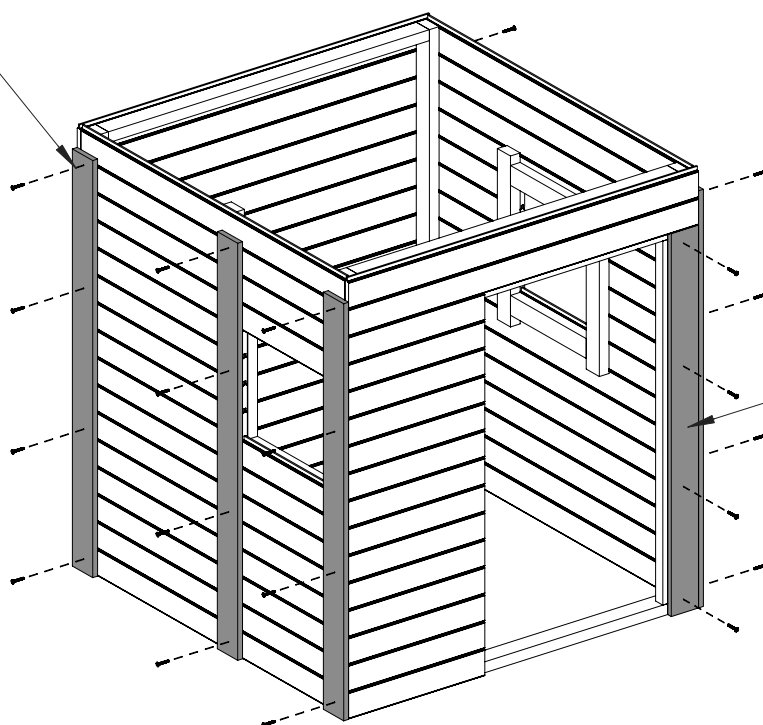
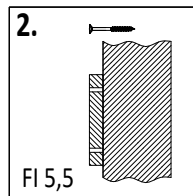
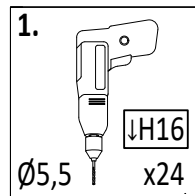

**H-17** 1,6x9,0x112cm  
x1

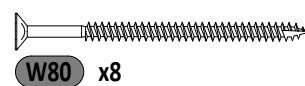
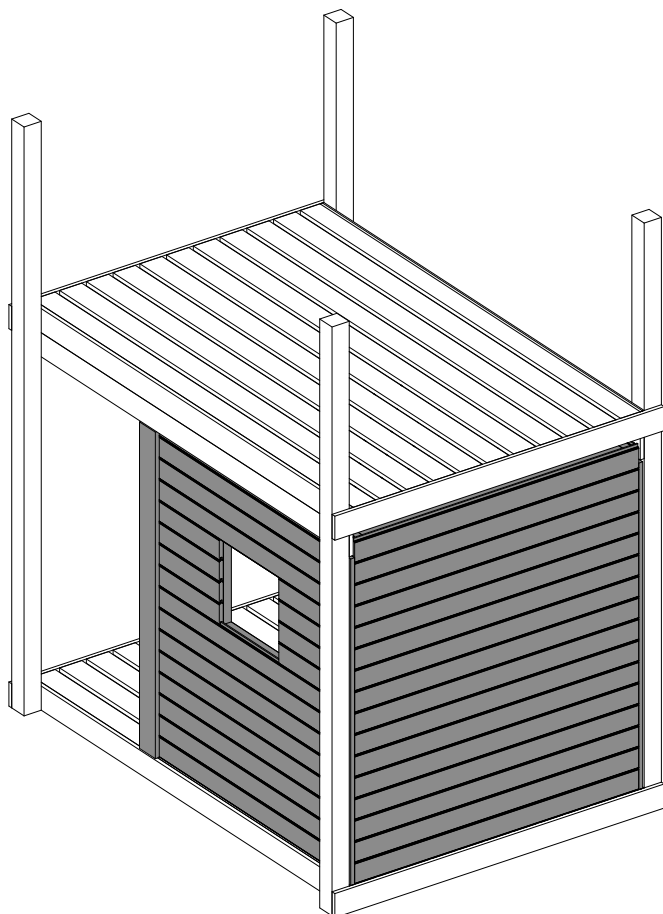
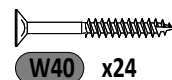

17

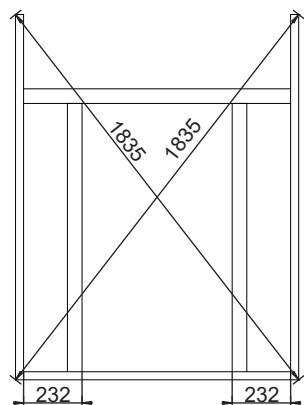
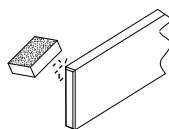
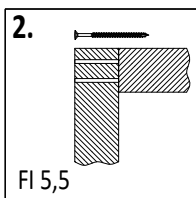
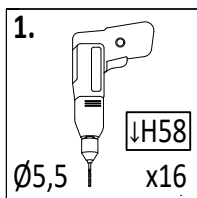

**H-1** 3,2x5,8x145cm  
x2

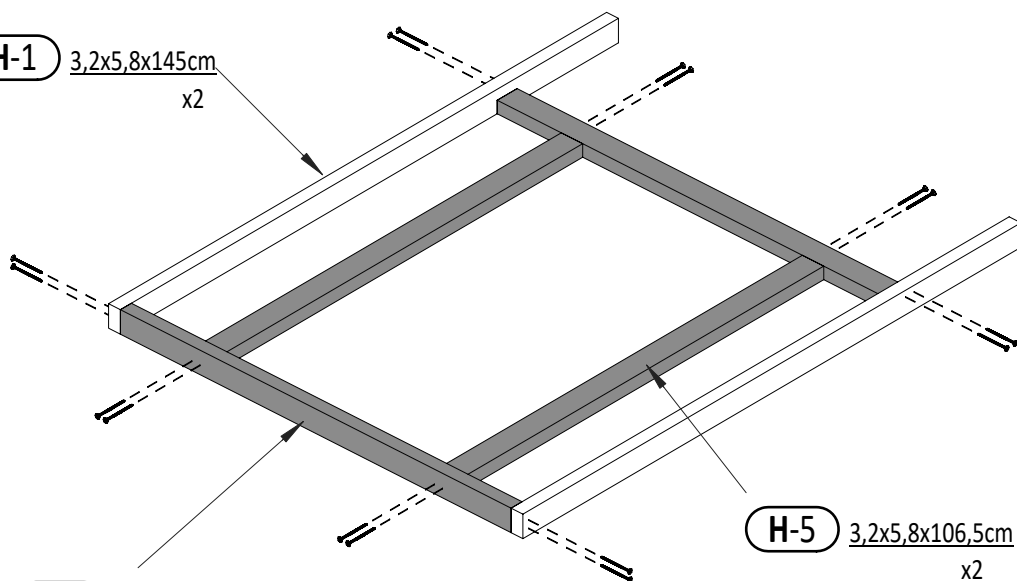

**H-5** 3,2x5,8x106,5cm  
x2

**H-6** 3,2x5,8x106cm  
x2



**W80** x16

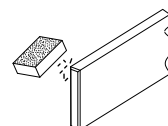

18

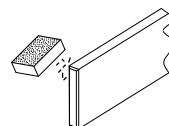
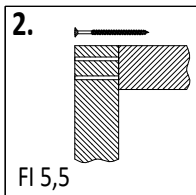
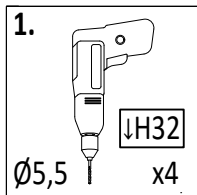

**H-6** 3,2x5,8x106cm  
x1

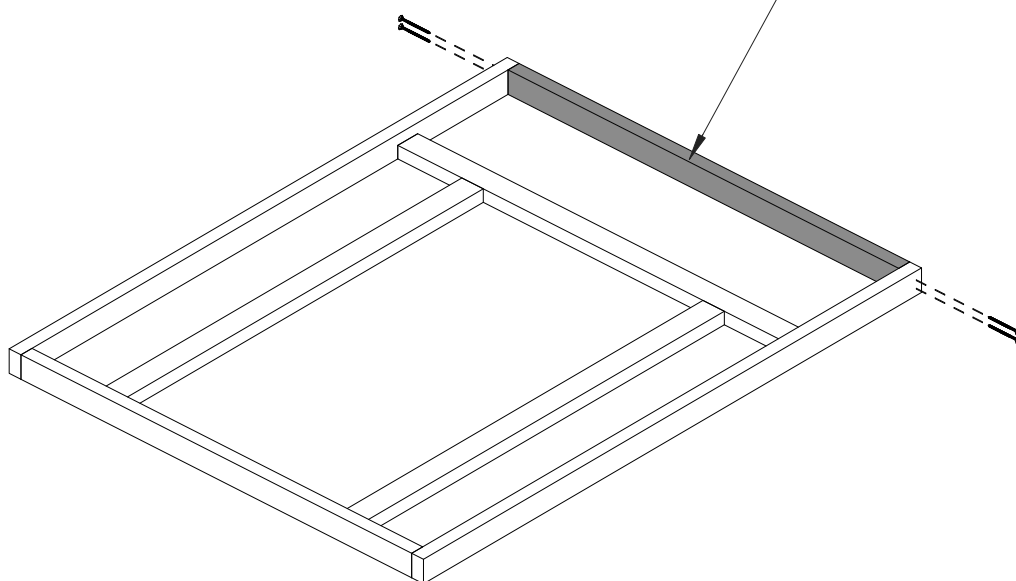
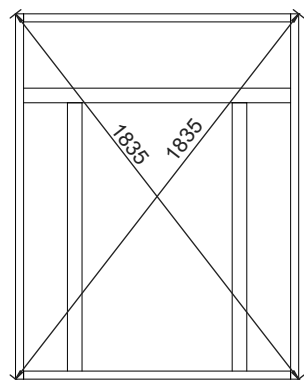

**W80** x4

**18 LOFTER\_2S**

Zgodnie z normą PN-EN 71 stosuj zalecenia producenta odnośnie odległości oraz metody mocowania poszczególnych elementów  
In compliance with the standard PN-EN 71, apply guidelines of the producer in relation to distances and methods of fastening individual elements

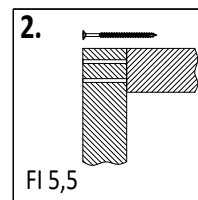
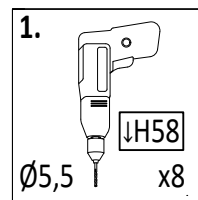

**H-6** 3,2x5,8x106cm

x2

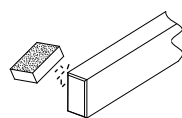
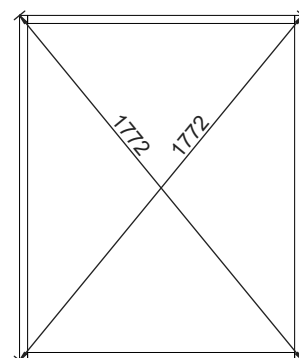

**H-2** 3,2x5,8x137cm

x2

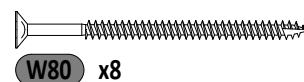

**H-19a** 1,6x9,0x116,8cm

x17

**H-19b** 1,6x9,0x116,8cm

x1

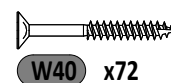
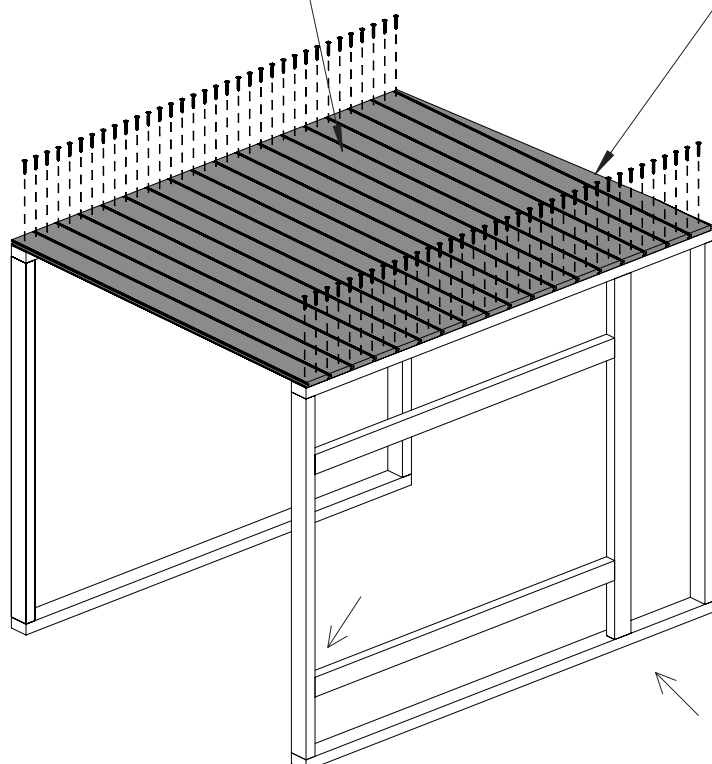
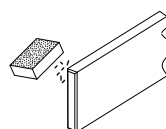
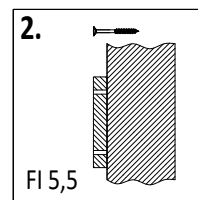
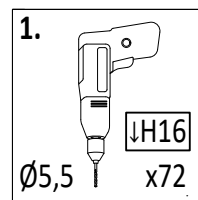

21

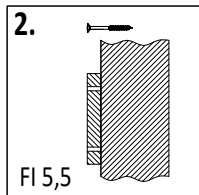
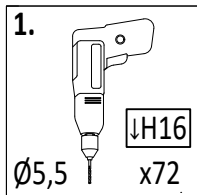

**H-23a** 1,6x9,0x41,5cm

**H-19b** 1,6x9,0x116,8cm

x1

x8

**H-19a** 1,6x9,0x116,8cm

x13

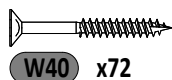
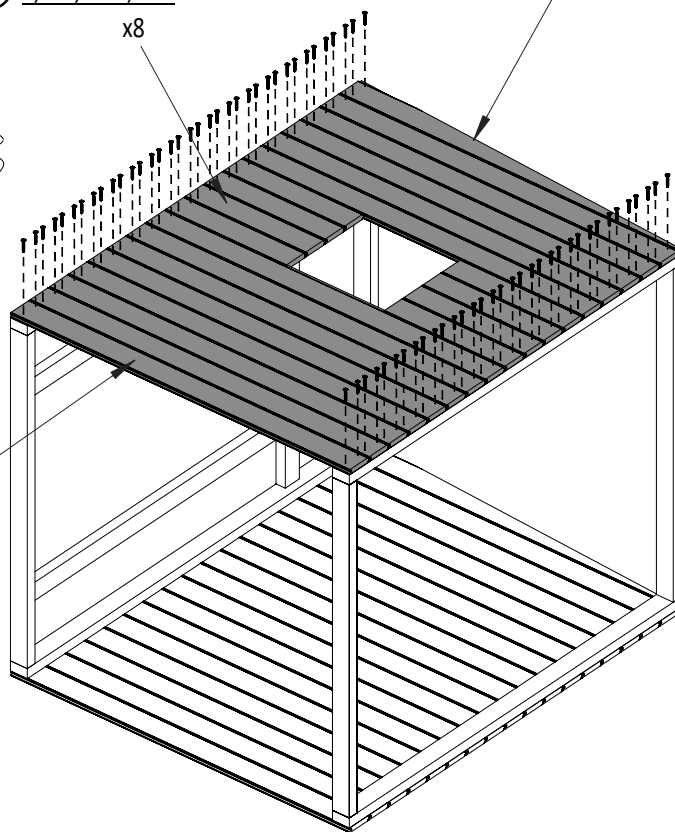
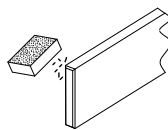
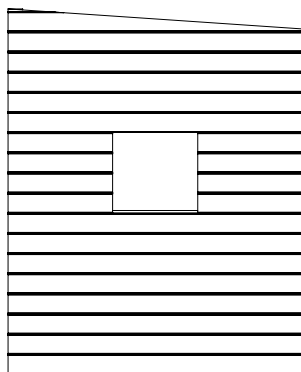

22

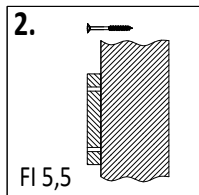
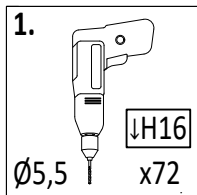

**H-24a** 1,6x9,0x74cm

**H-20a** 1,6x9,0x115,6cm

x13

x8

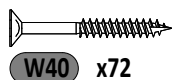
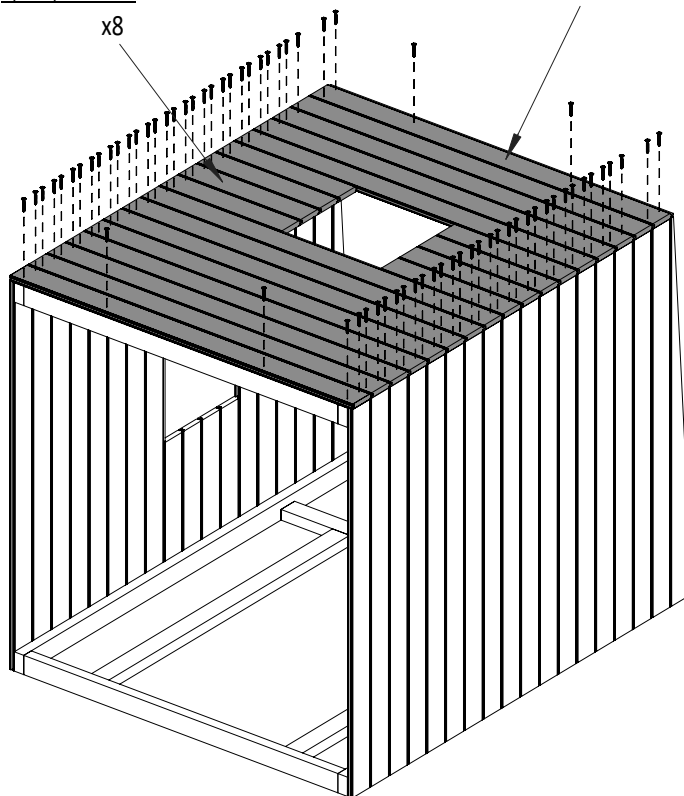
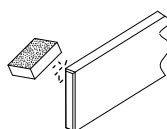
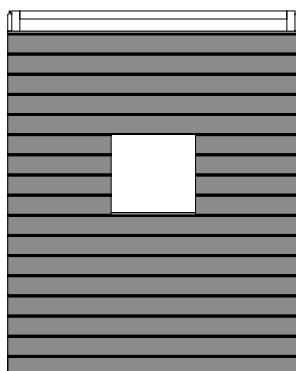



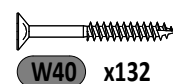
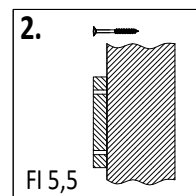
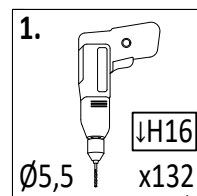
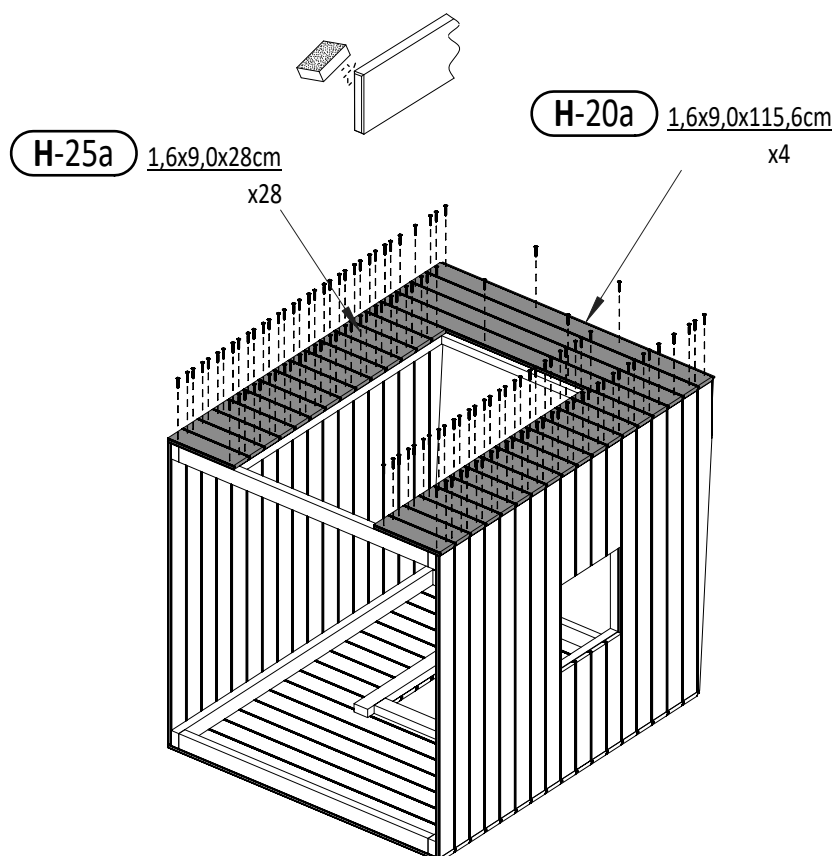
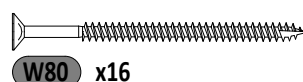
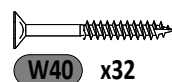
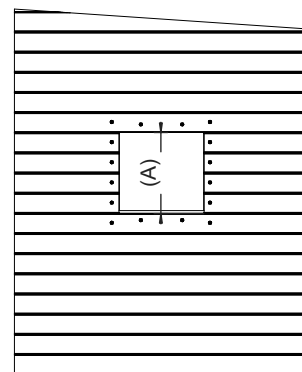
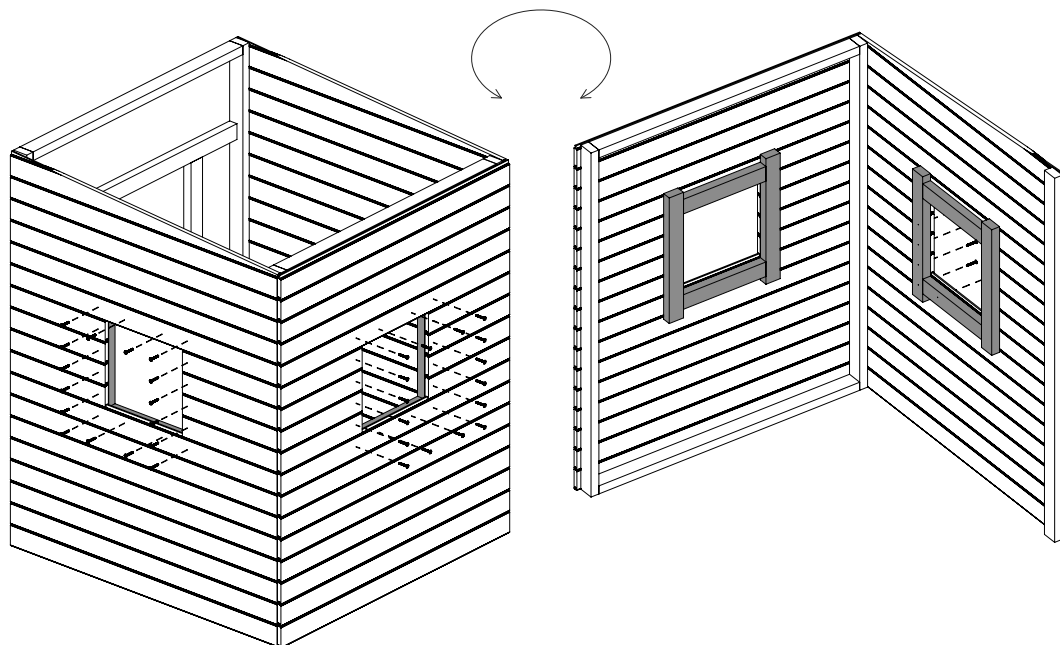
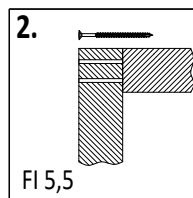
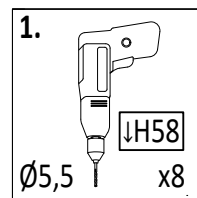
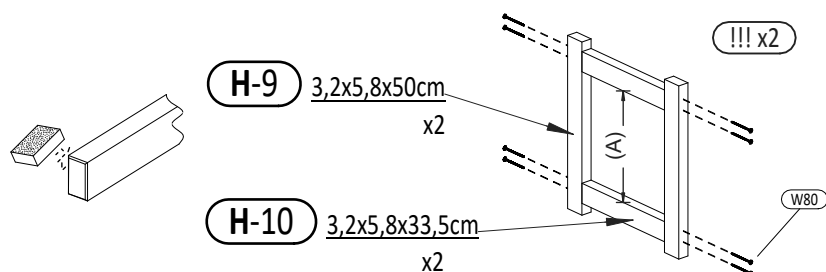

25

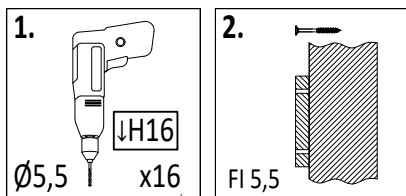

**H-14** 1,6x9,0x137cm  
x2

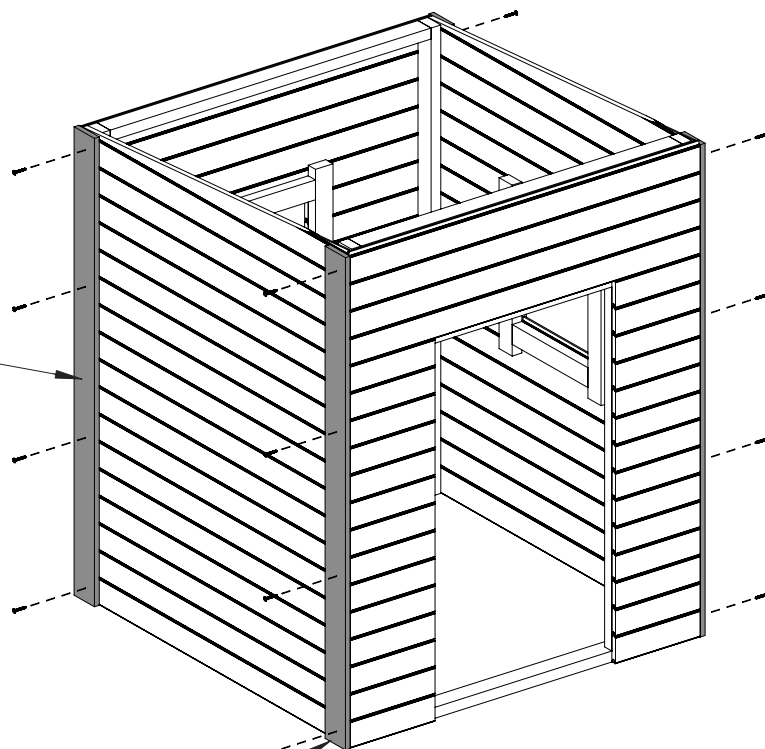
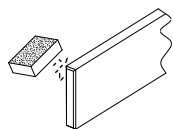

**H-13** 1,6x9,0x144cm  
x2

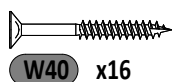

26

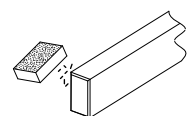
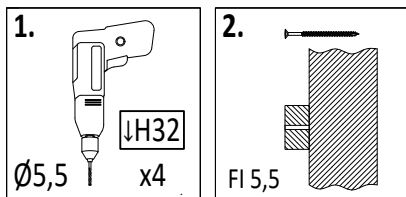

**H-4** 3,2x5,8x116,5cm  
x2

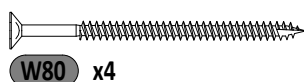
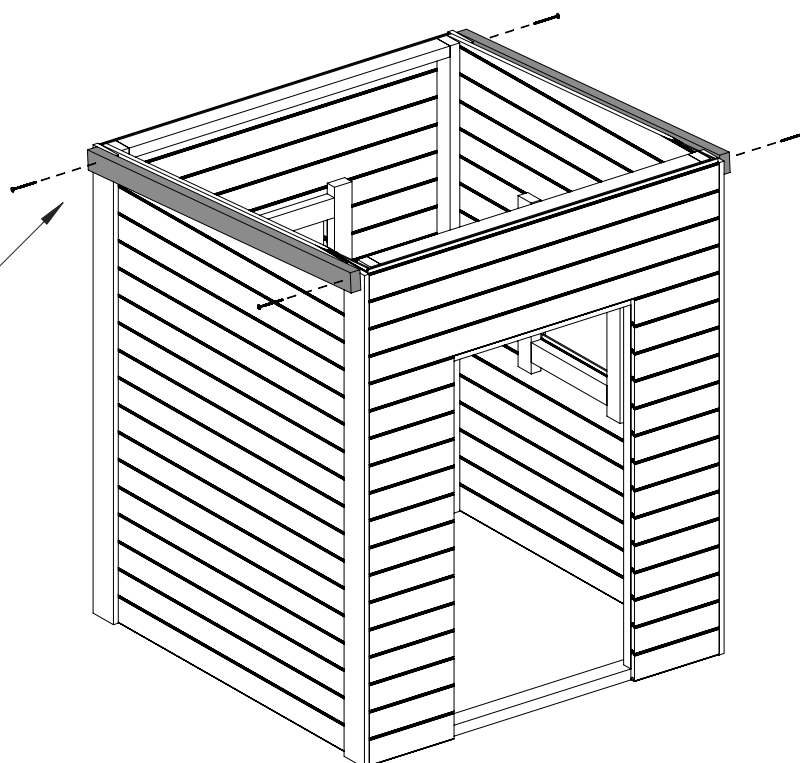
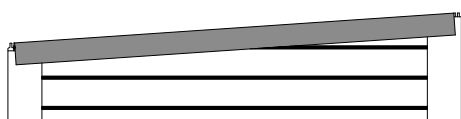

**H-18a** 1,6x9,0x123cm  
x16

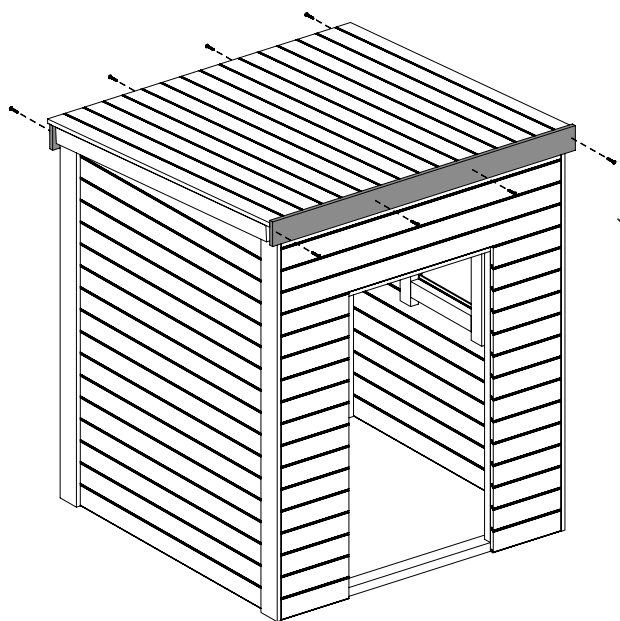
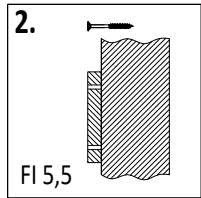
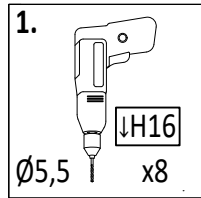
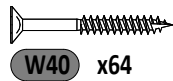
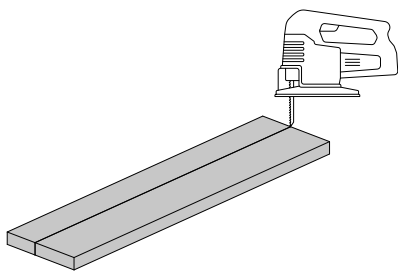
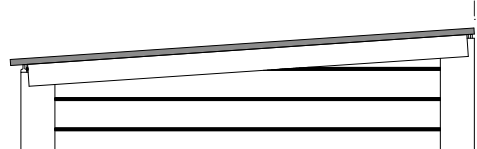
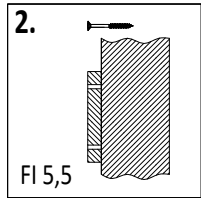
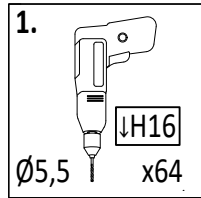
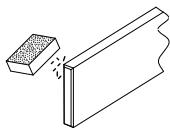

**H-15** 1,6x9,0x125cm  
x2

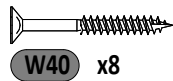
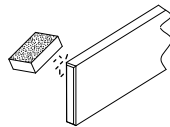

29

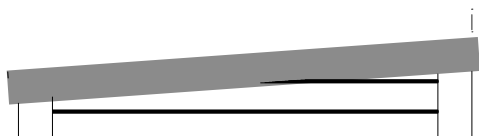
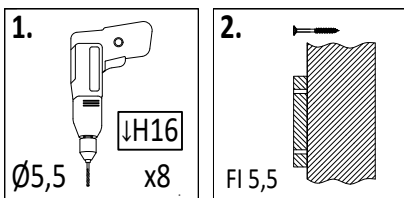

**H-15** 1,6x9,0x125cm  
x2

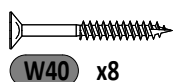
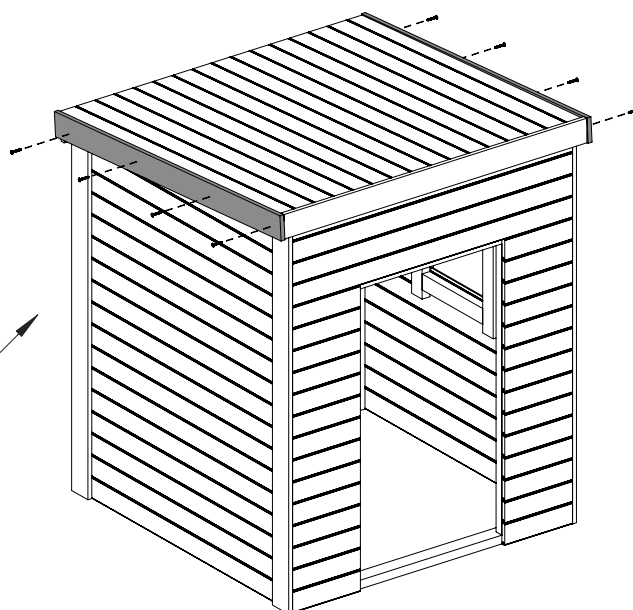
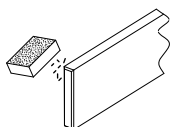

**W40** x8

30

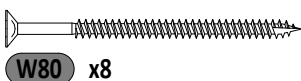
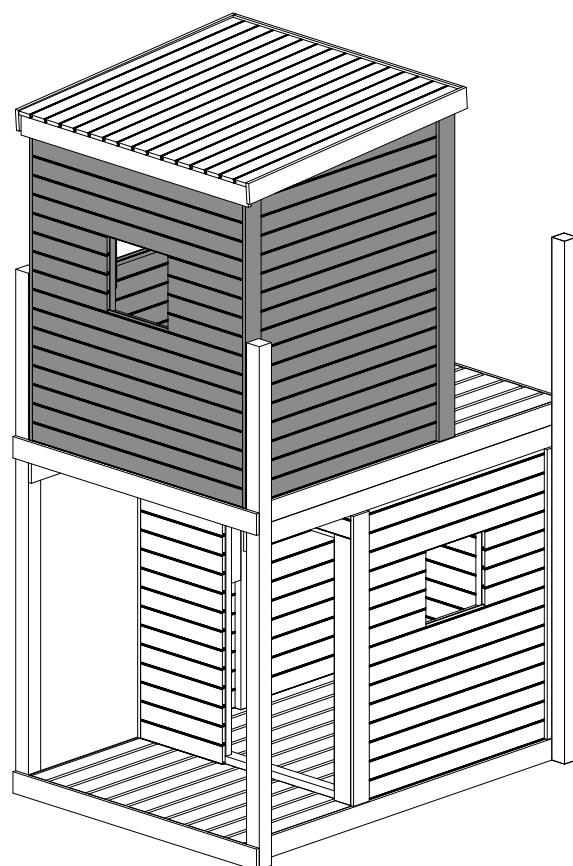

**W80** x8

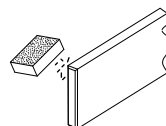
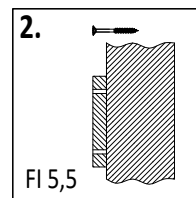
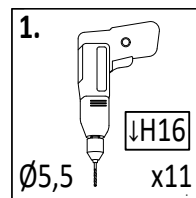
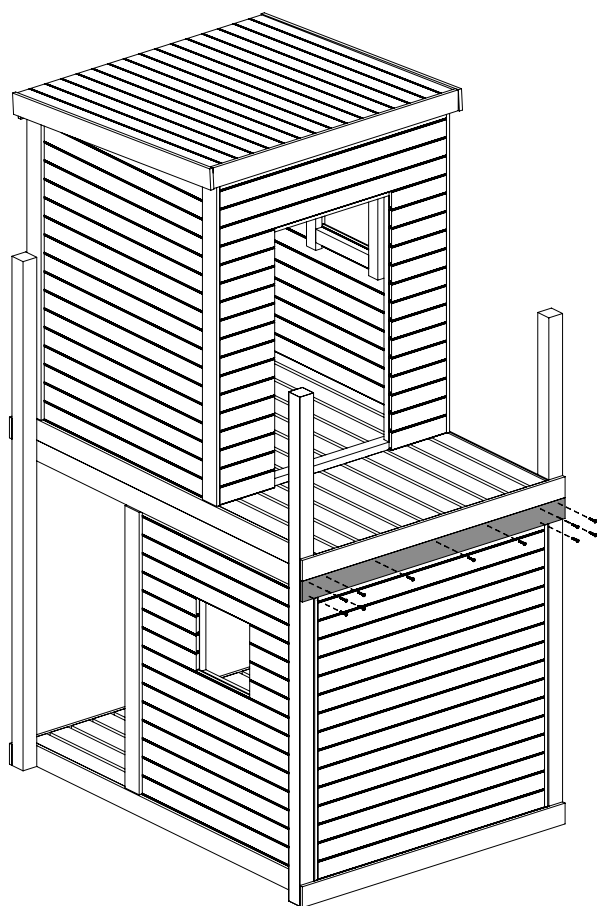

**P-16** 1,6x9,0x134cm  
x1

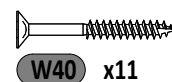

**H-8** 3,2x5,8x59,5cm  
x2

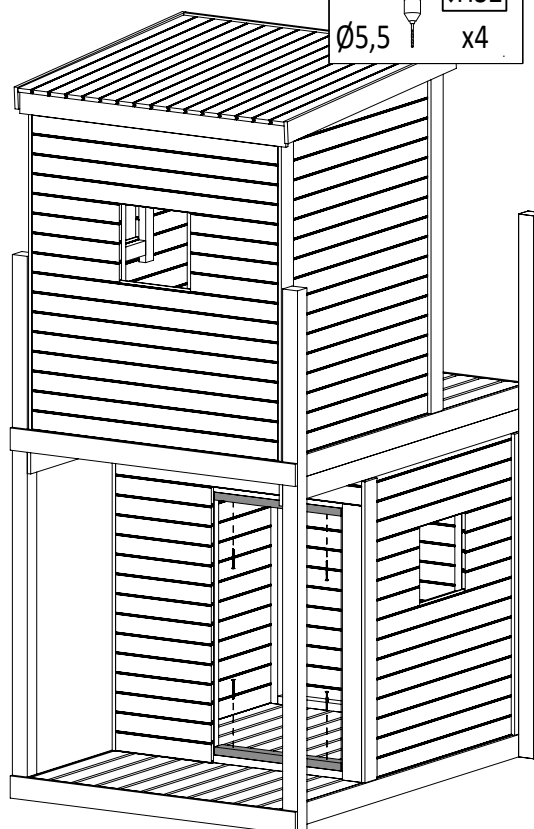
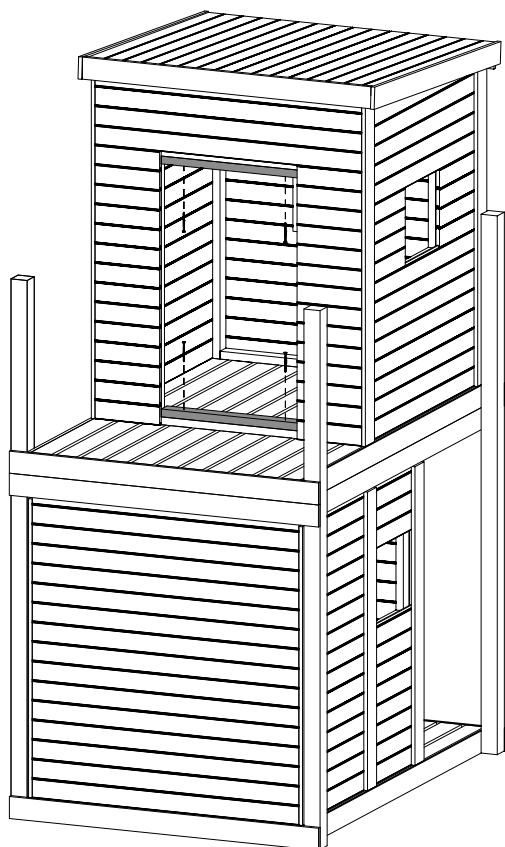
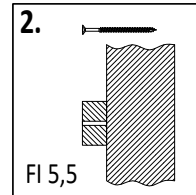
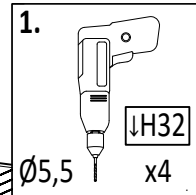

**H-8** 3,2x5,8x59,5cm  
x2

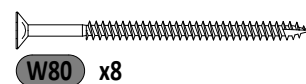

33

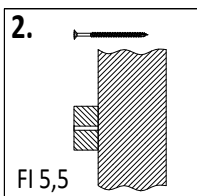
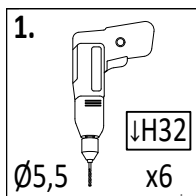
**H-7** 3,2x5,8x100cm

x1

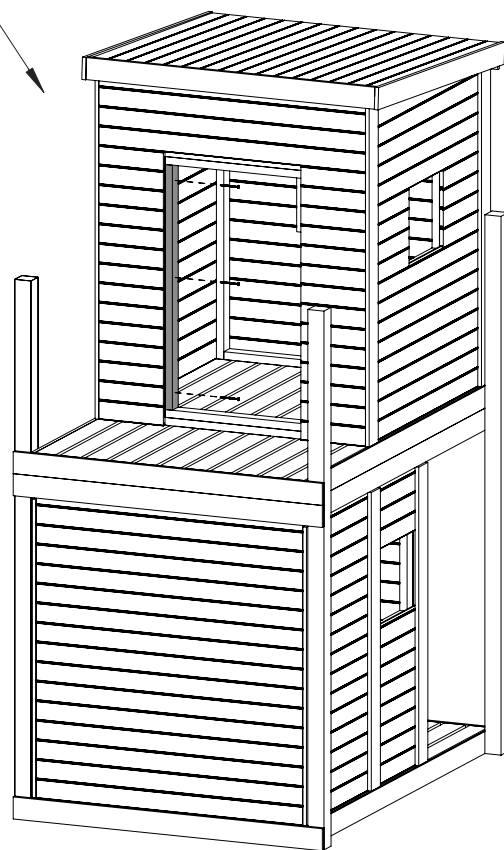
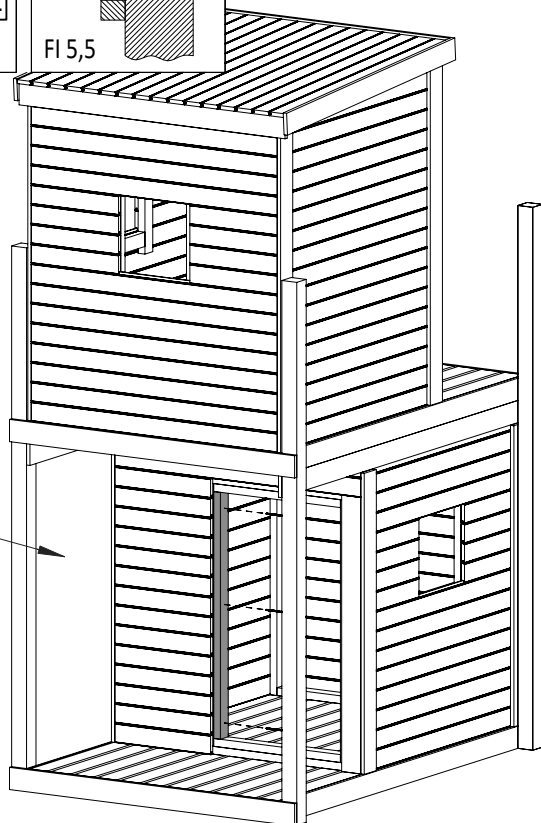
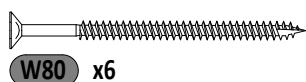
**H-7** 3,2x5,8x100cm  
x1

34

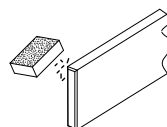
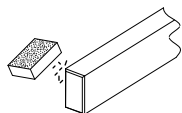
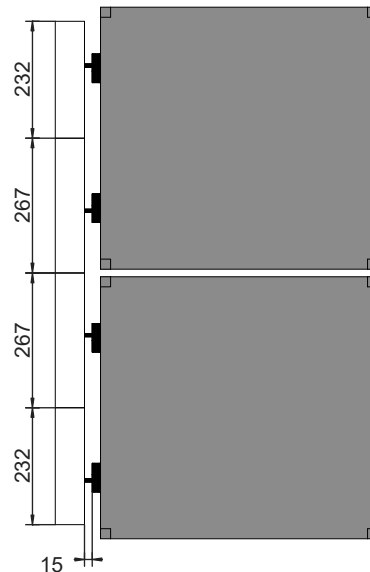
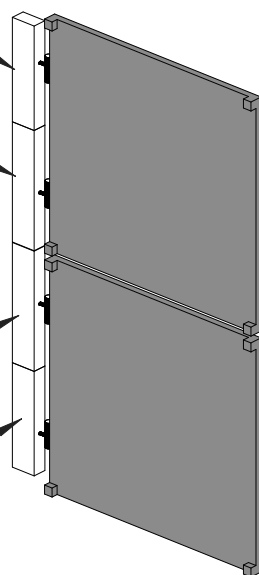
**!!!** x2**H-26a** 1,5x55,0x52,0cm  
x2**ZD**  
x4**H-12a** 3,2x5,8x223,2cm  
x1**H-11a** 3,2x5,8x26,7cm  
x1**H-11a** 3,2x5,8x26,7cm  
x1**H-12a** 3,2x5,8x223,2cm  
x1

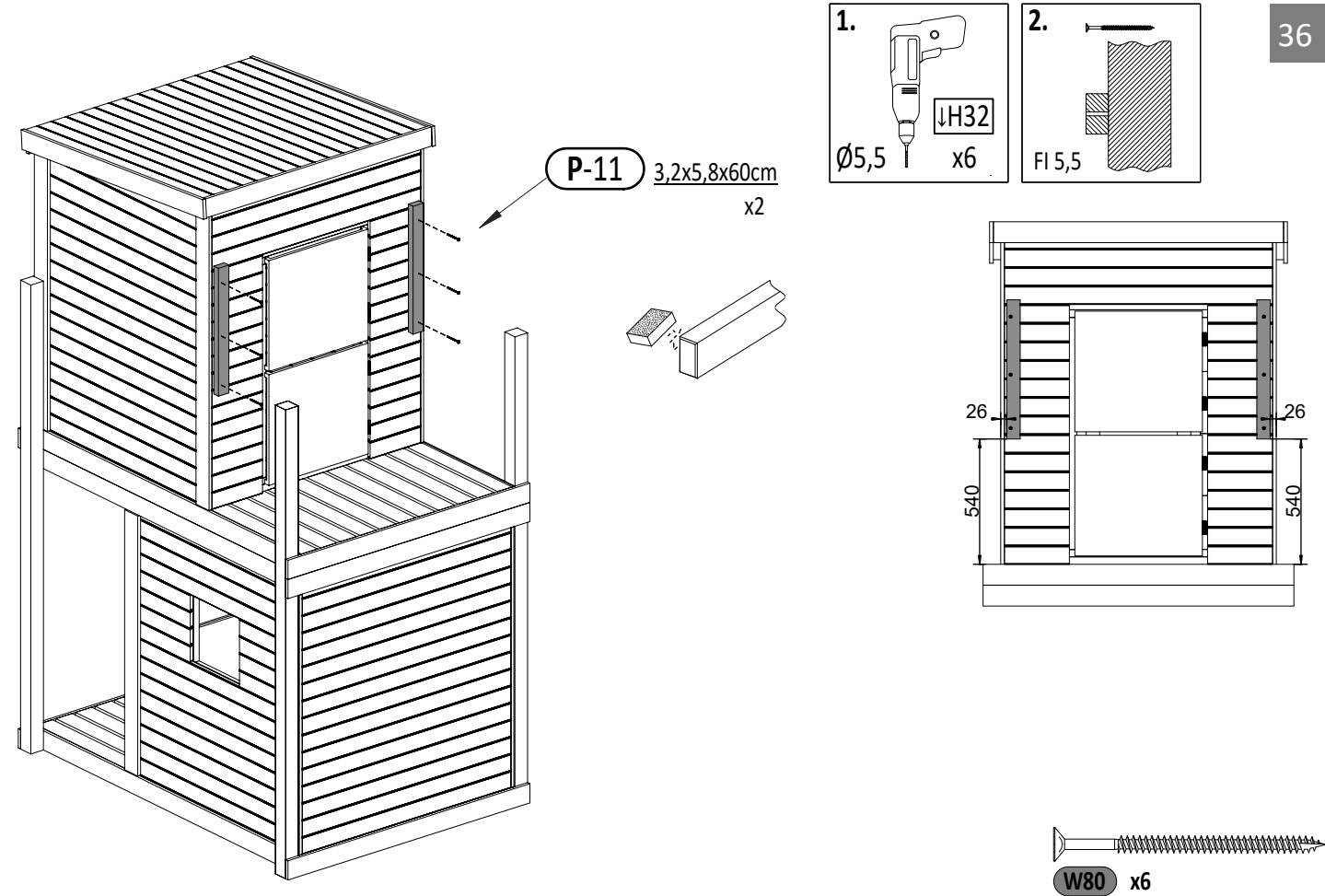
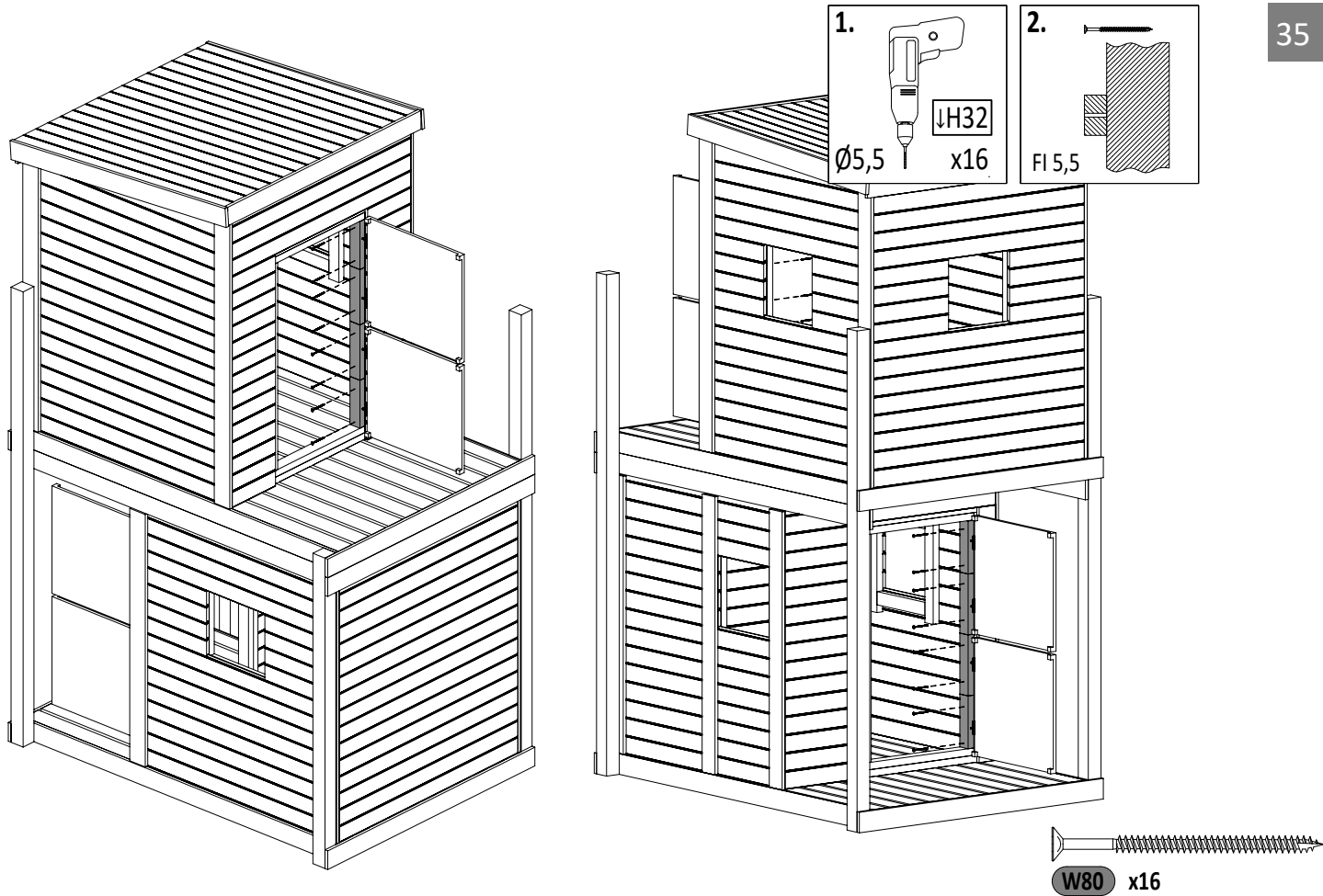

37

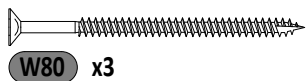
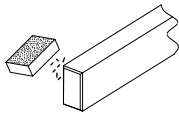
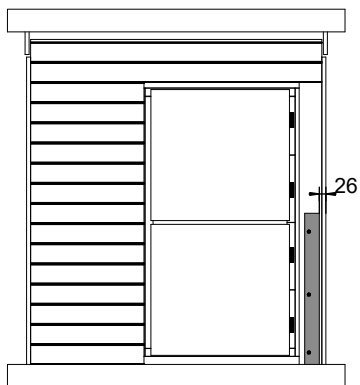
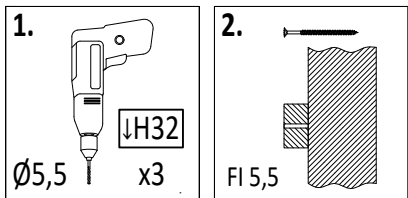

**P-11** 3,2x5,8x60cm  
x1

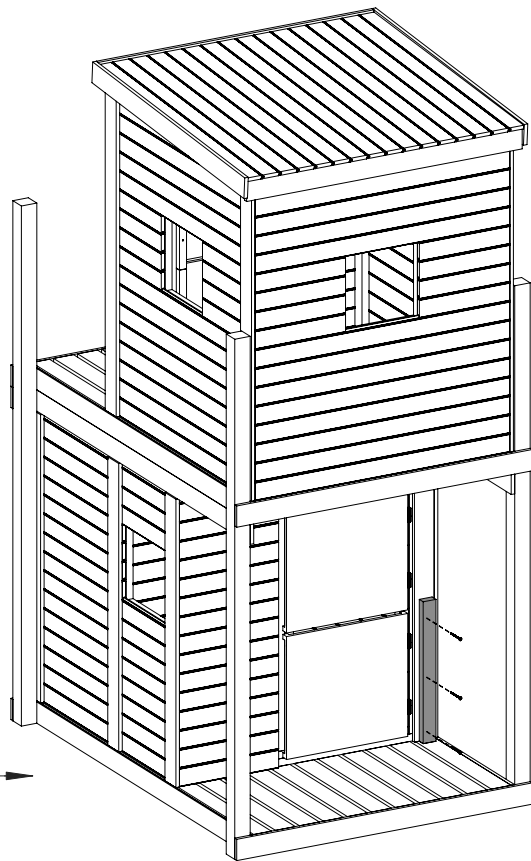

38

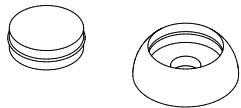
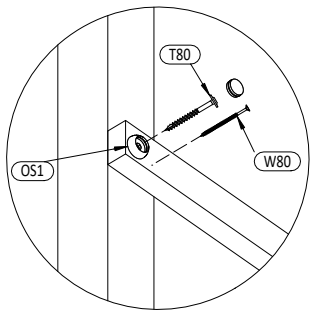
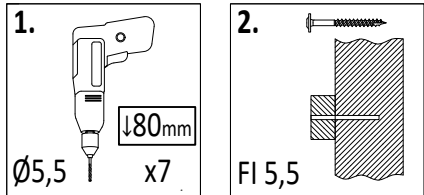

OS1 x7

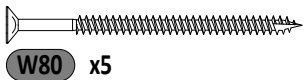

**W80** x5

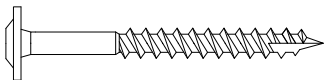

**T80 x7**

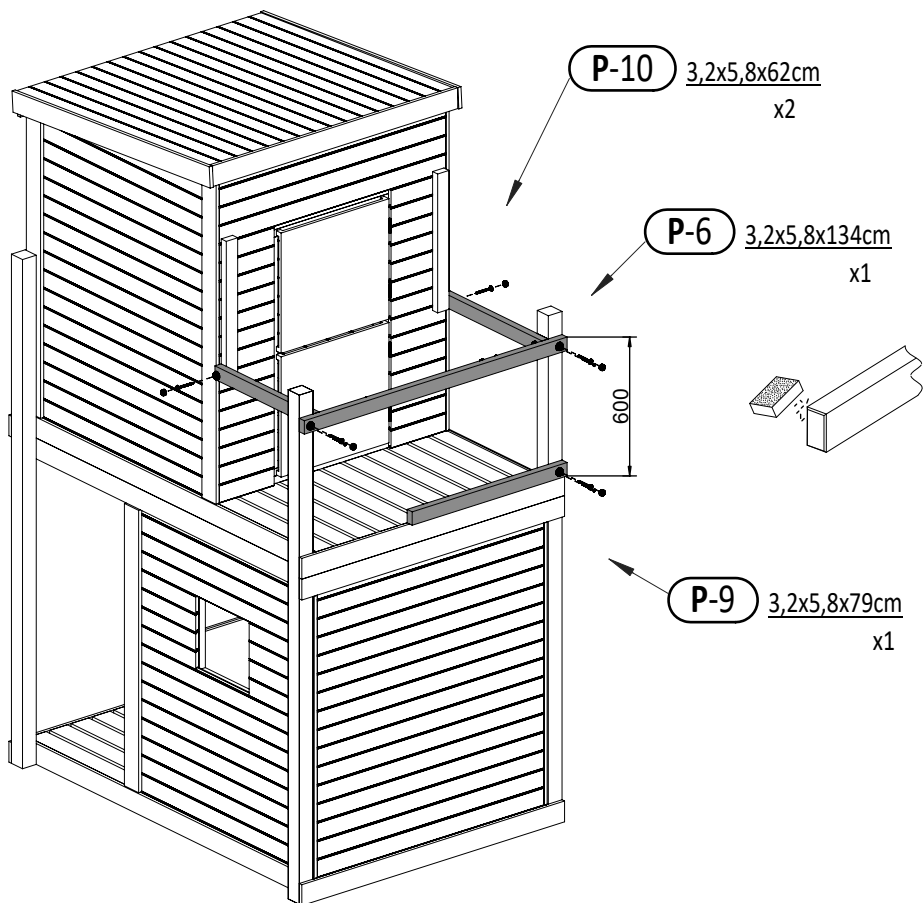

28 LOFTER\_2S

Zgodnie z normą PN-EN 71 stosuj zalecenia producenta odnośnie odległości oraz metody mocowania poszczególnych elementów



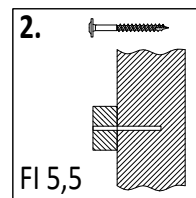
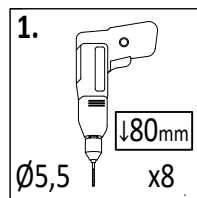
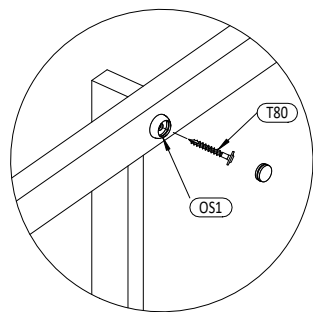

**P-6** 3,2x5,8x134cm  
x2

600

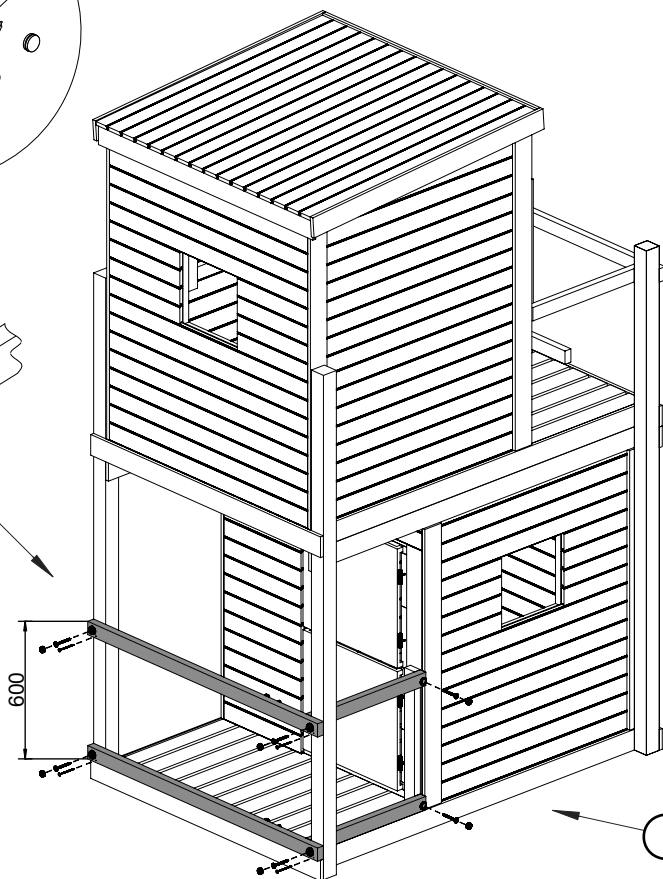

**P-10** 3,2x5,8x62cm  
x2

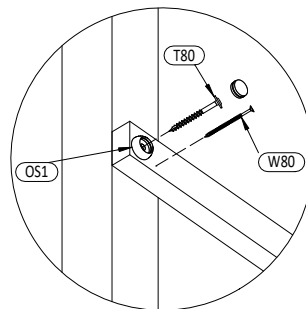
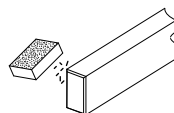

**OS1** x8

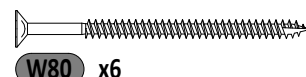

**W80** x6

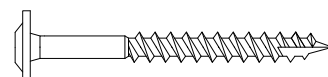

**T80** x8

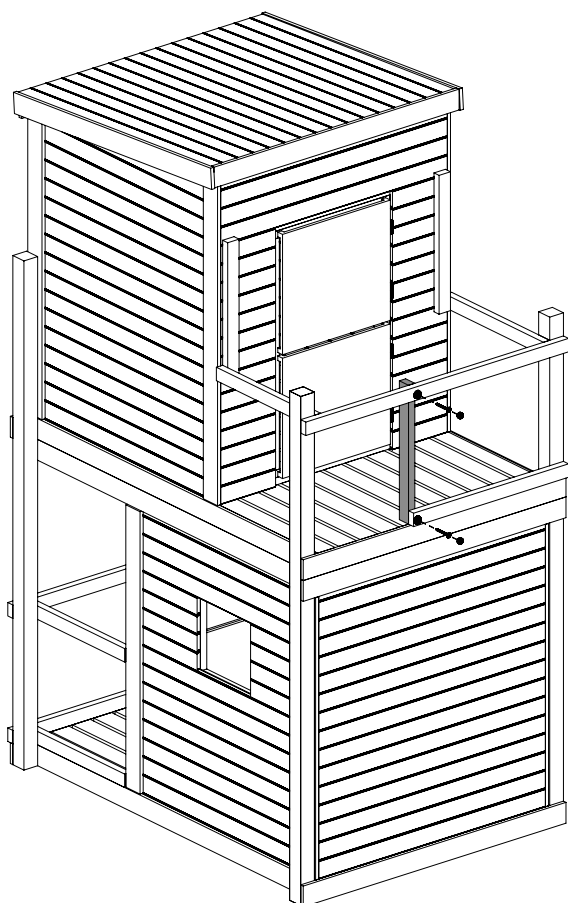
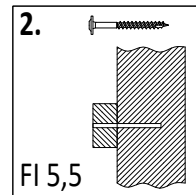
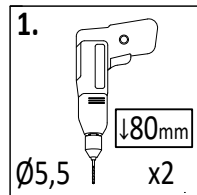

**P-11** 1,6x9,0x60cm  
x1

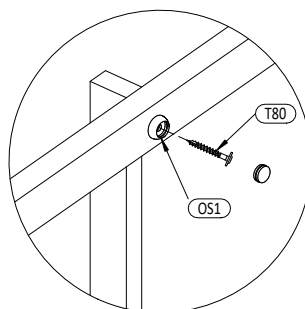

**OS1** x2

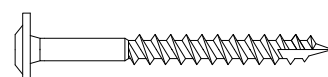

**T80** x2

41

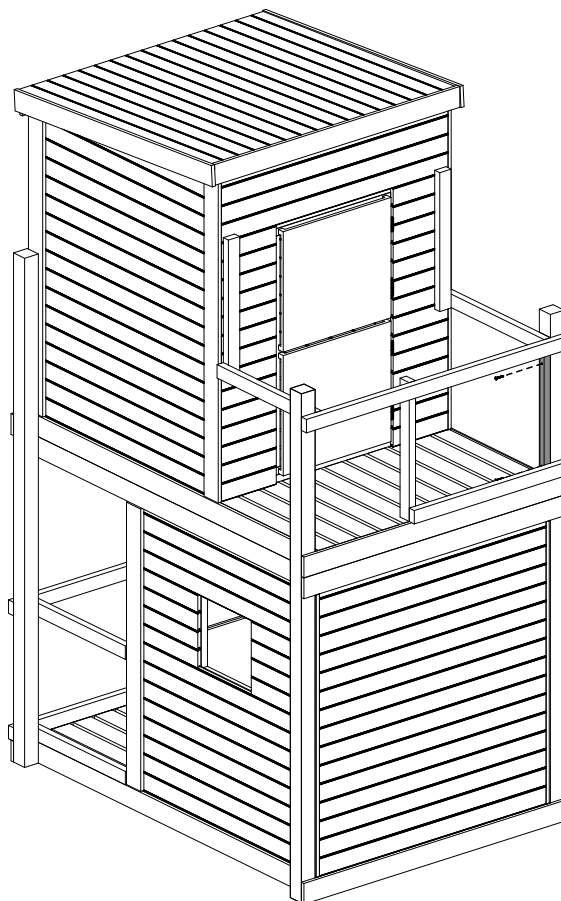
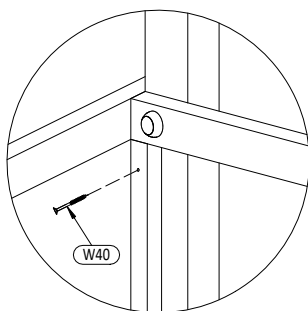
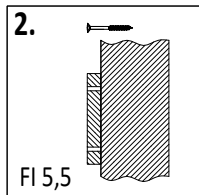
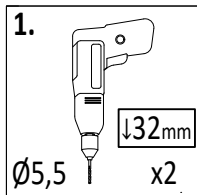

**P-20a** 2,7x3,2x54,2cm  
x1

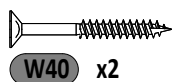

42

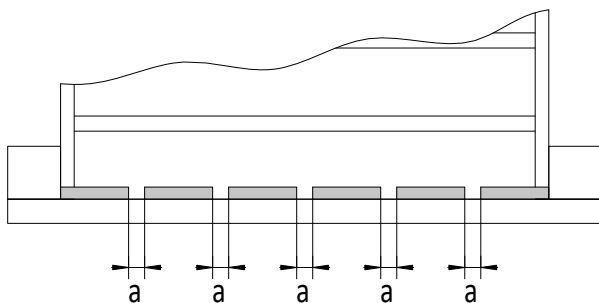
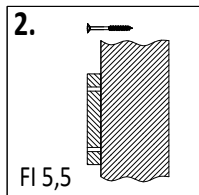
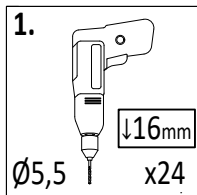

!!!min 13mm < a < !!!max 23mm

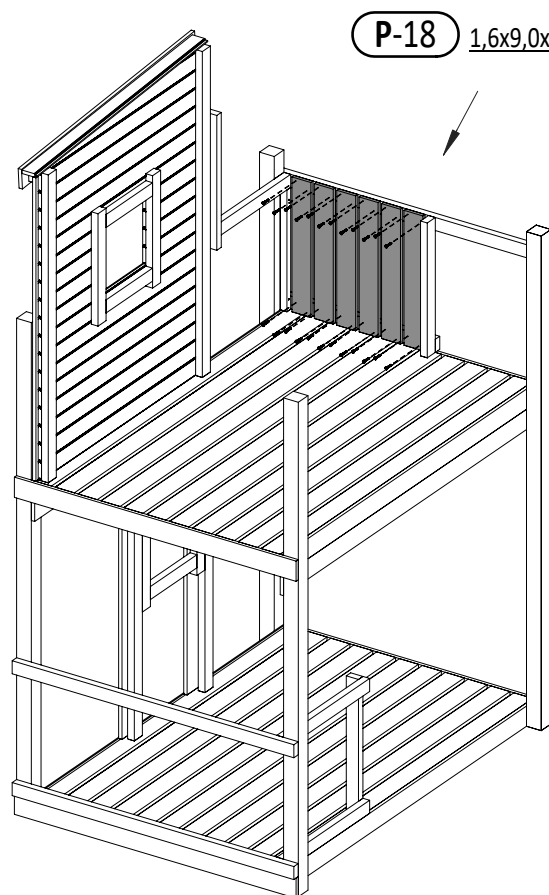

**P-18** 1,6x9,0x60cm  
x6

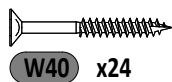

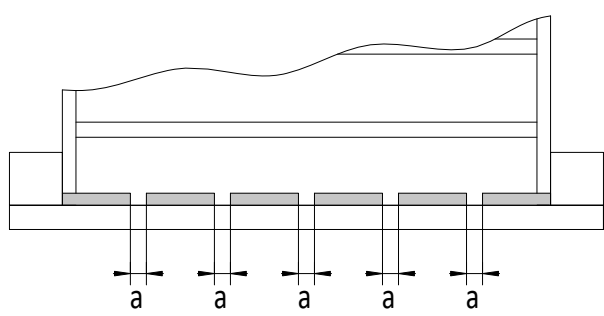
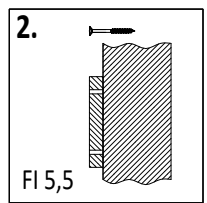
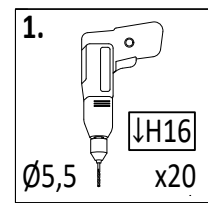
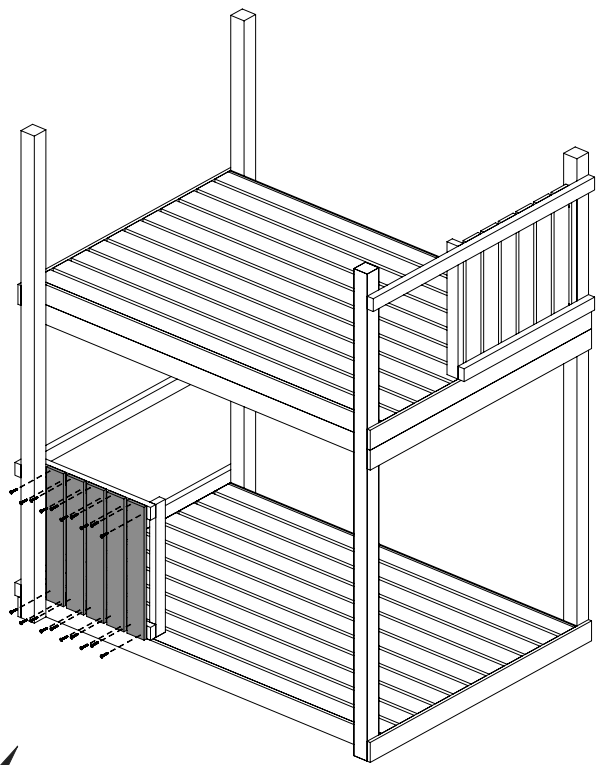

!!!min 13mm < a < !!!max 23mm

**P-18** 1,6x9,0x90cm  
x5

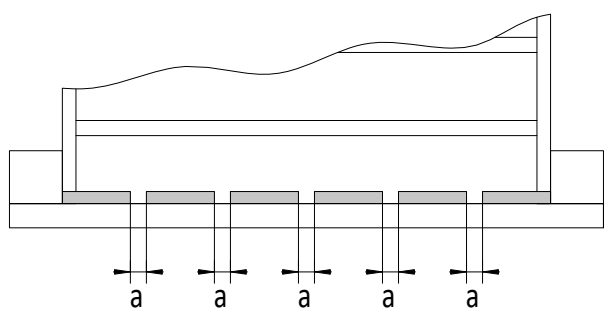
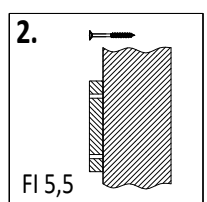
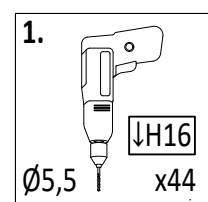
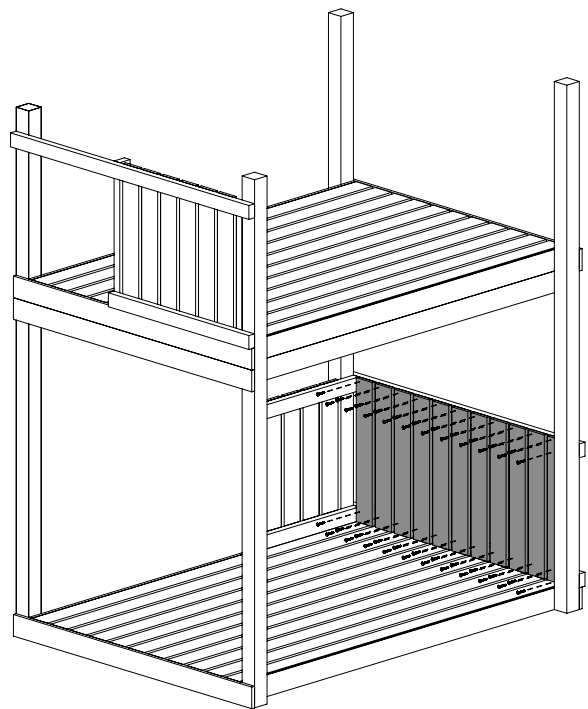
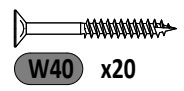

!!!min 13mm < a < !!!max 23mm

**P-18** 1,6x9,0x90cm  
x11

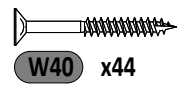

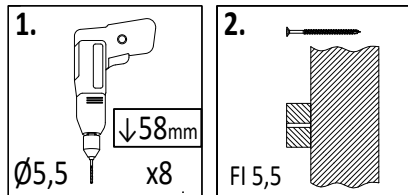
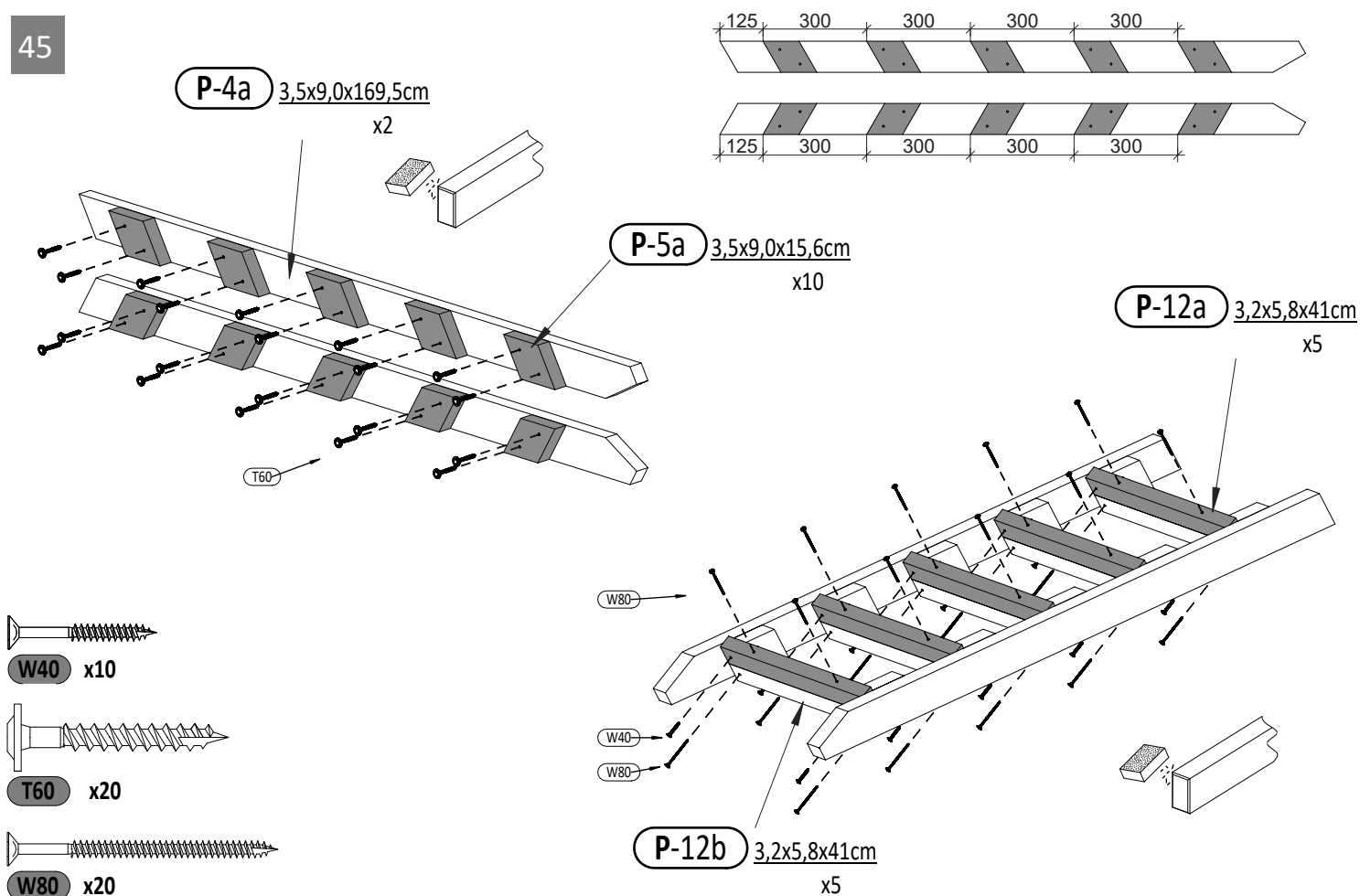

**P-7a** 3,2x5,8x125cm x2

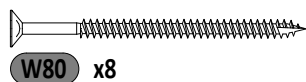
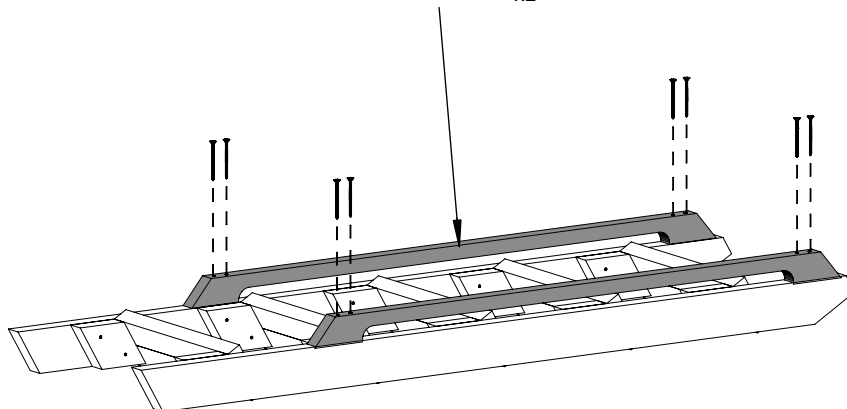

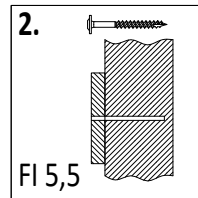
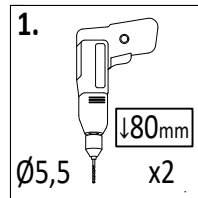
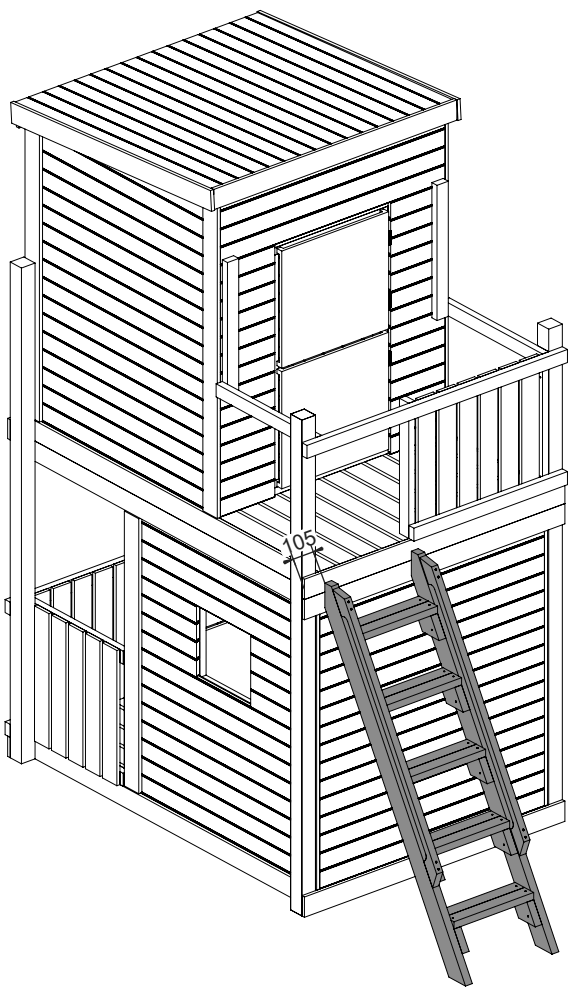

47

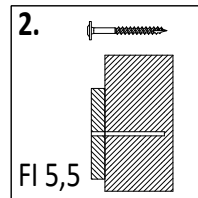
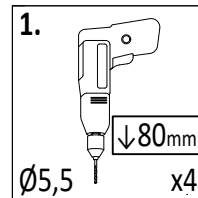
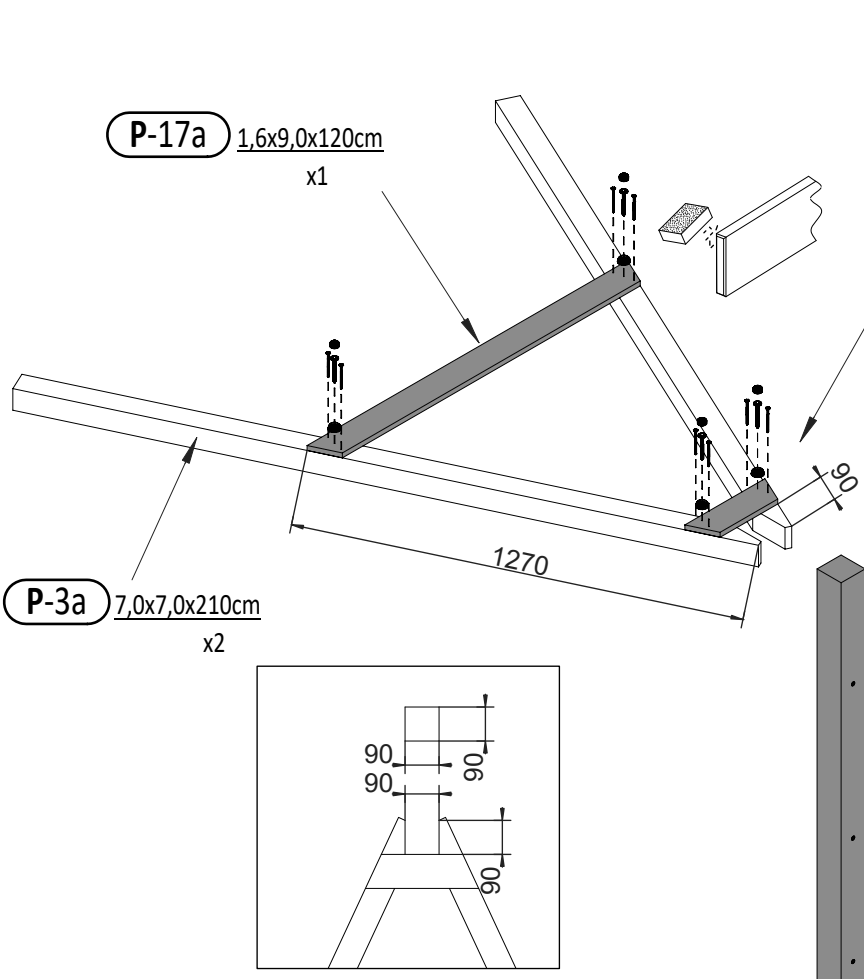
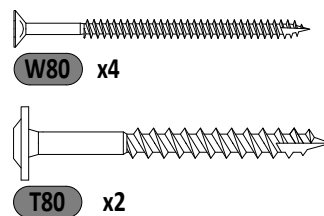
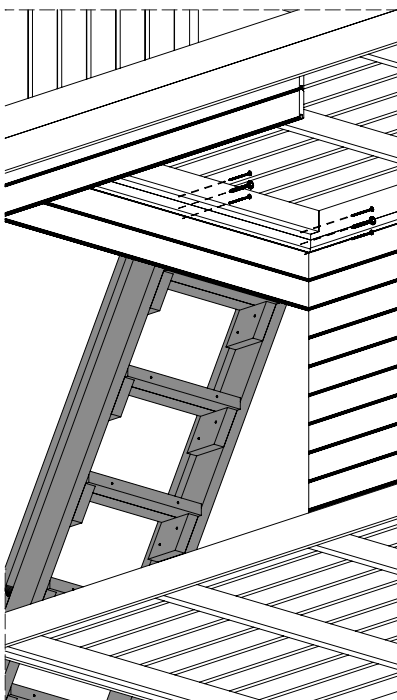

48

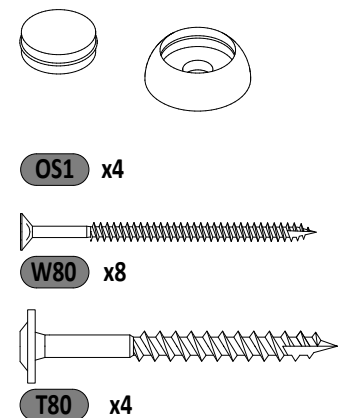
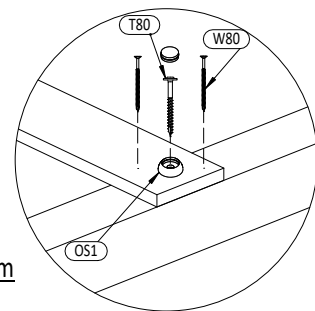

49

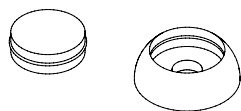
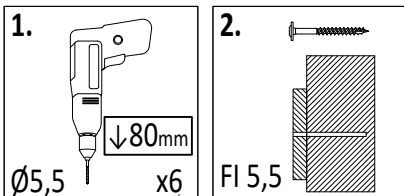

OS1 x2



P17 x4

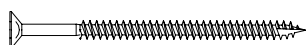

W80 x8

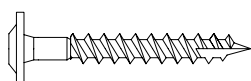

T60 x4



T80 x2

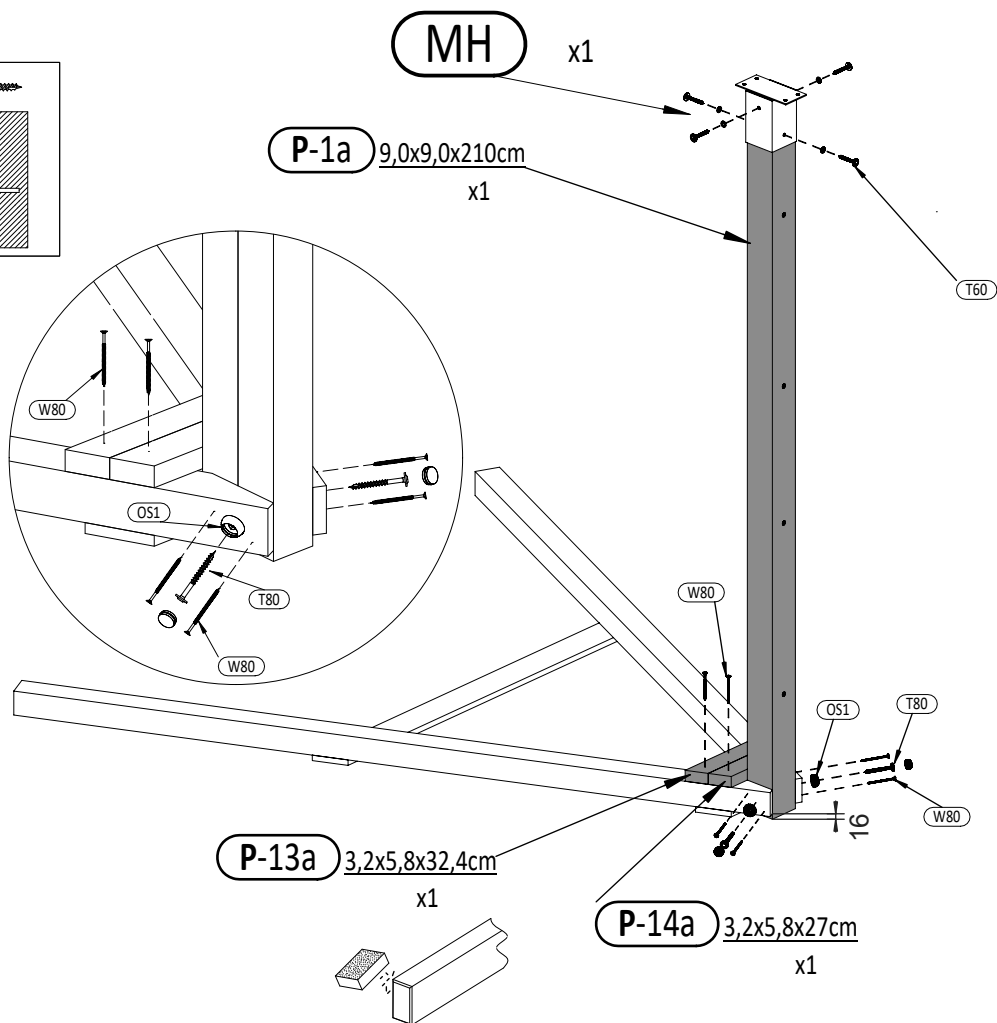

50

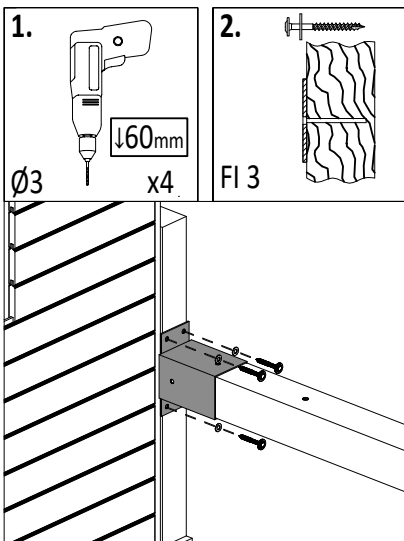

P17 x4

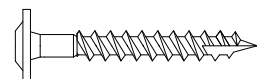

T60 x4

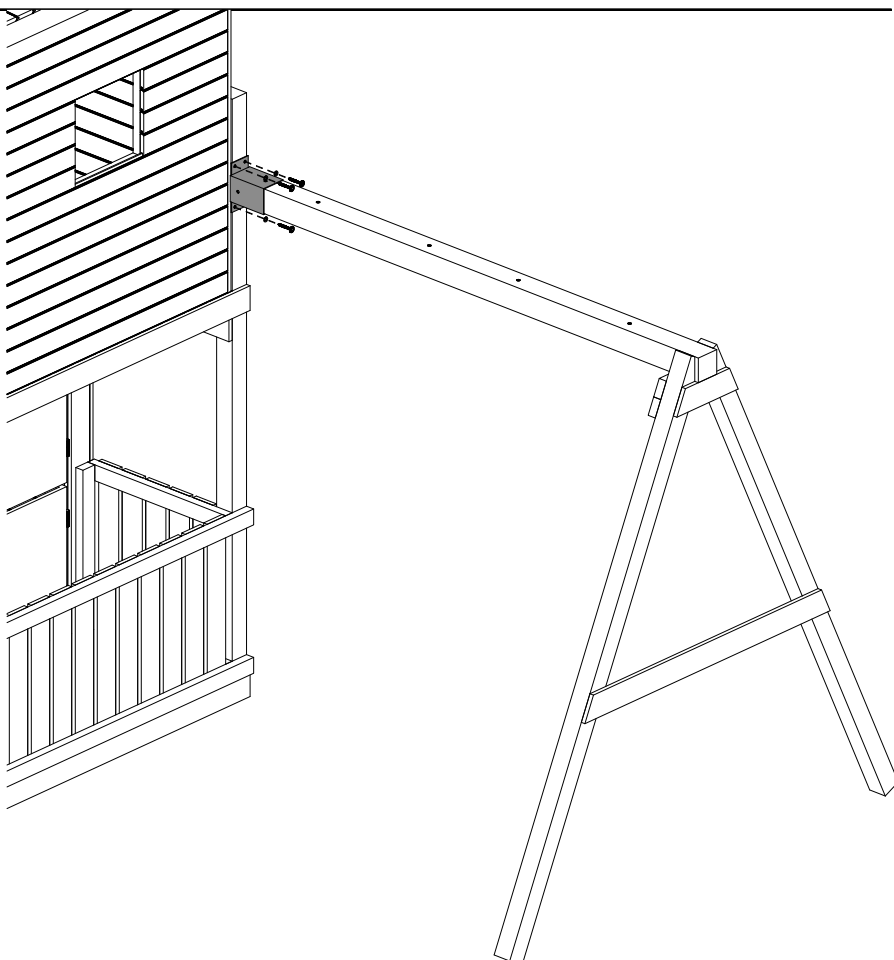

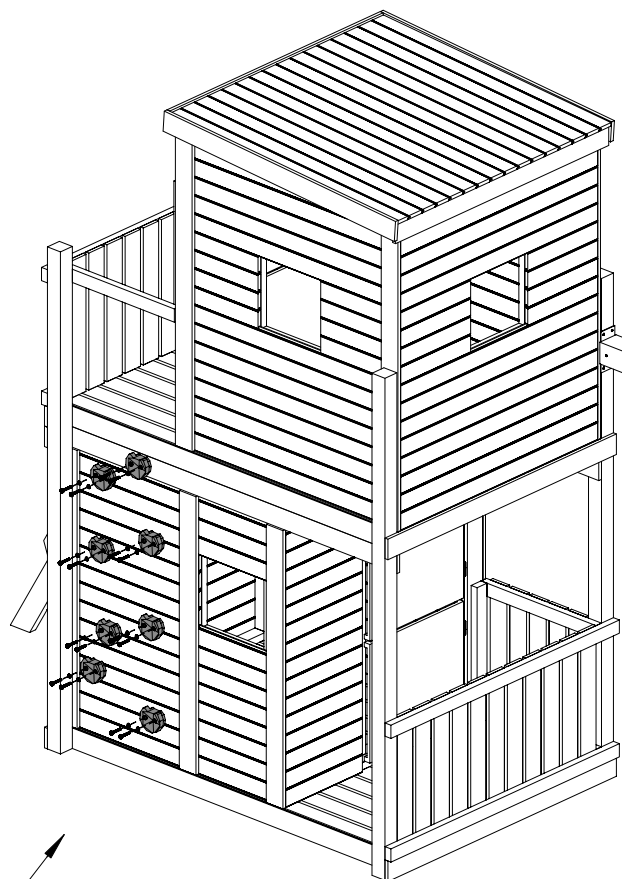

**SW** x8

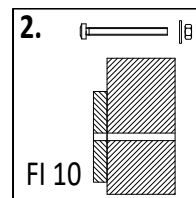
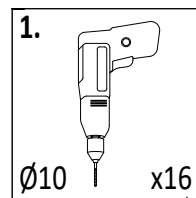

51

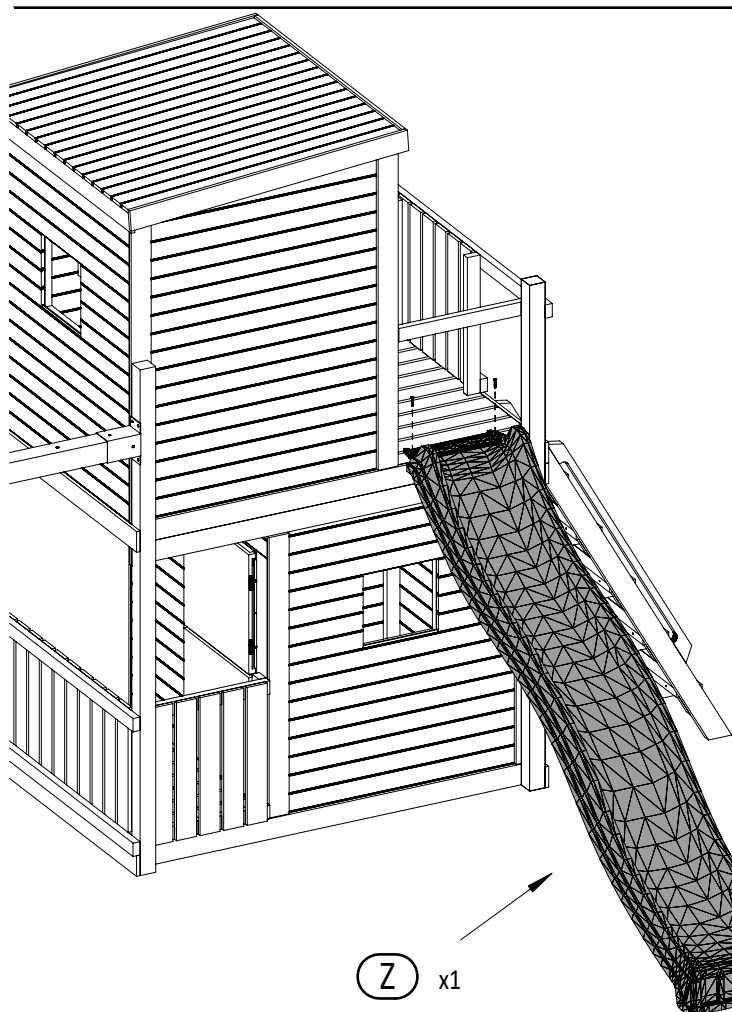
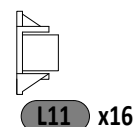
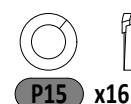
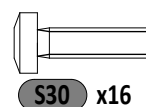
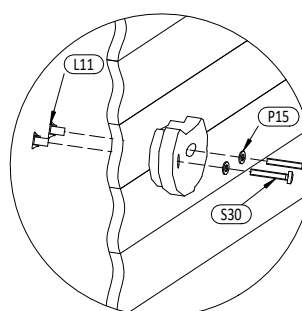
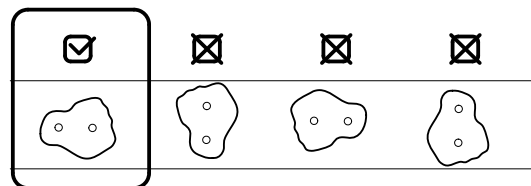

**Z** x1

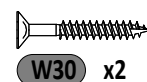
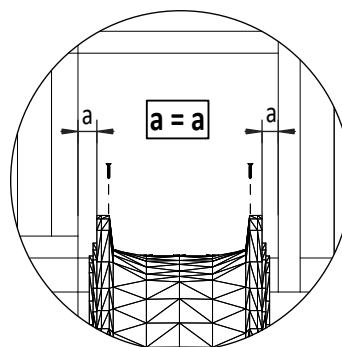

52

Zgodnie z normą PN-EN 71 stosuj zalecenia producenta odnośnie odległości oraz metody mocowania poszczególnych elementów

In compliance with the standard PN-EN 71, apply guidelines of the producer in relation to distances and methods of fastening individual elements

LOFTER\_2S **35**

53

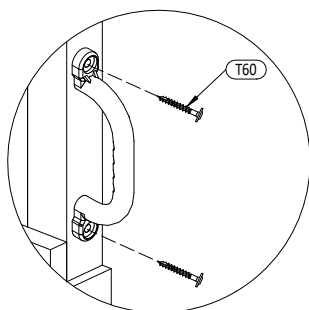
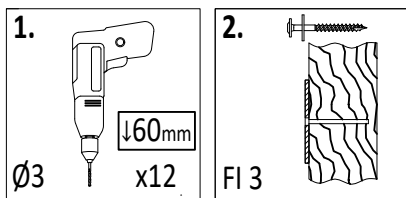

UC x6

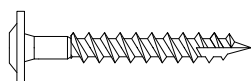
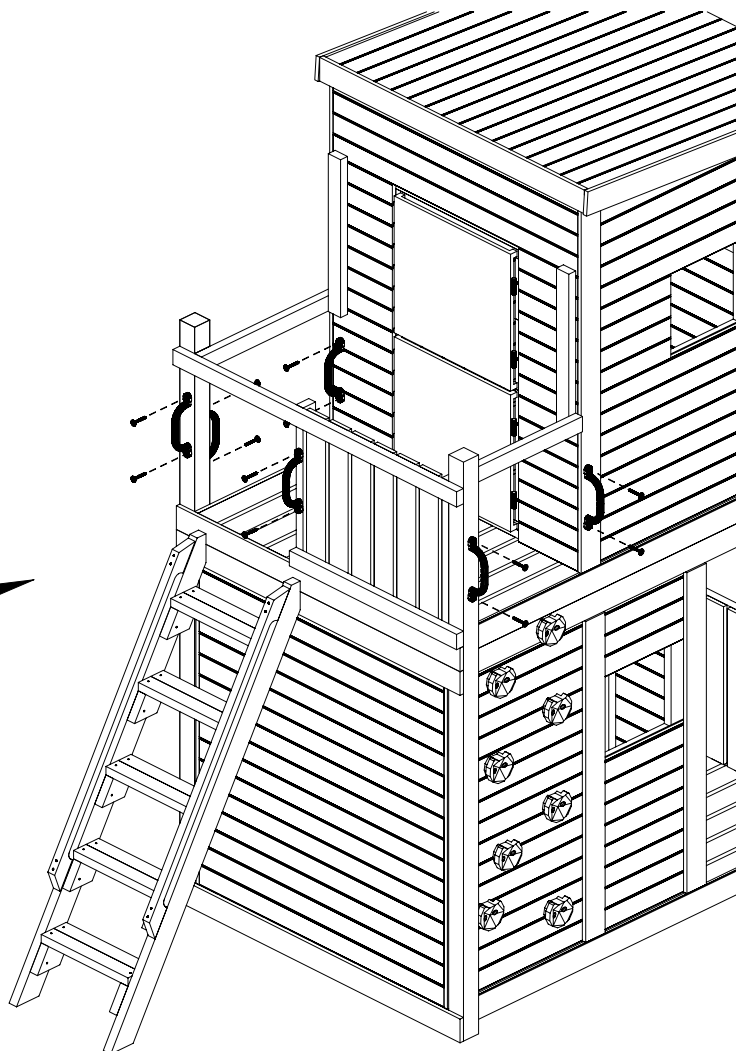

T60 x12

54

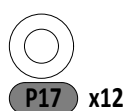
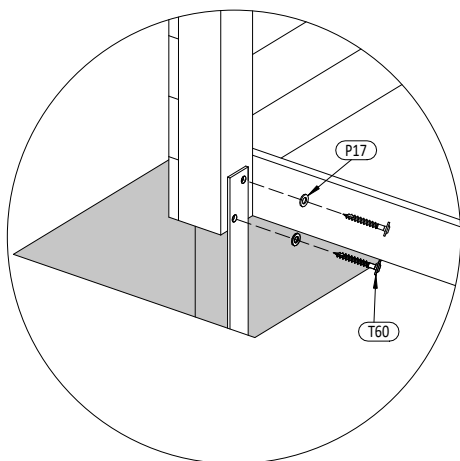
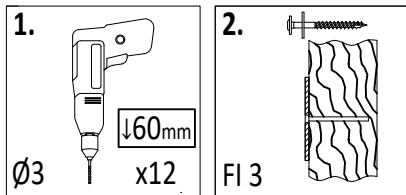

P17 x12

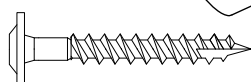

T60 x12

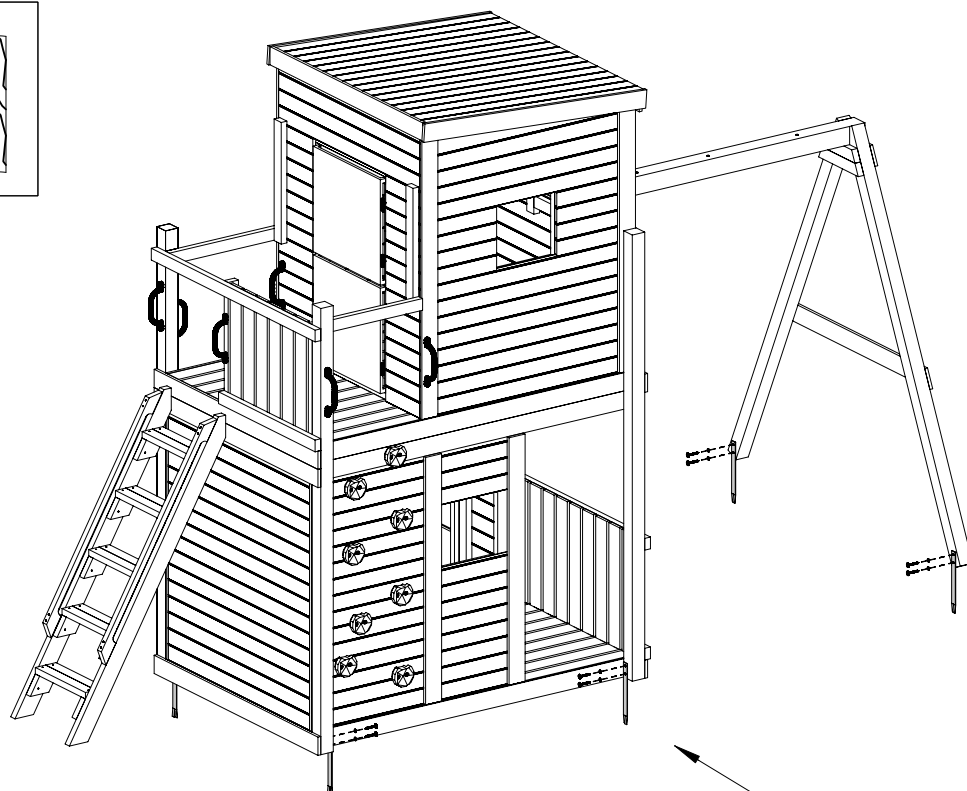

MG x6



55

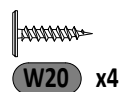
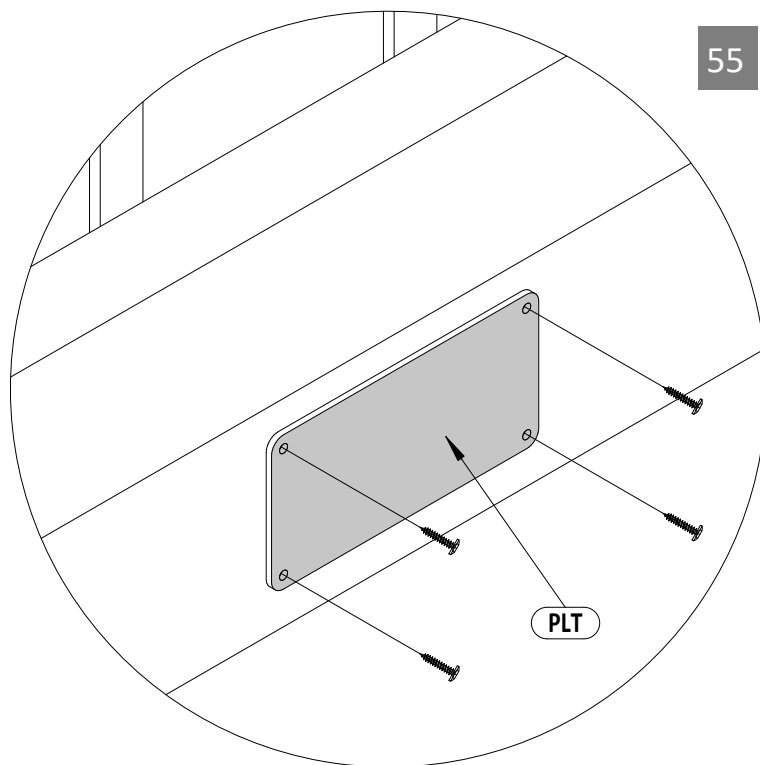
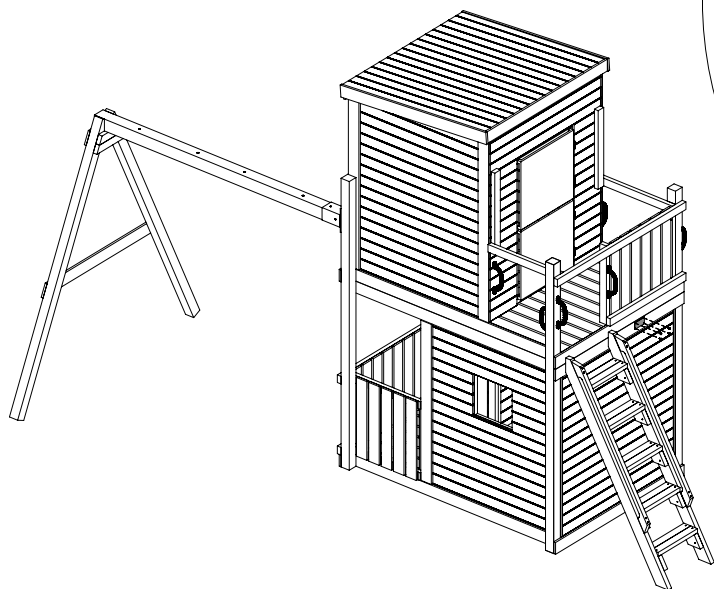

56

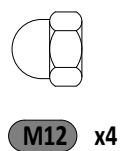
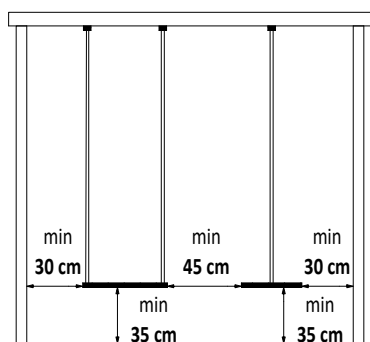
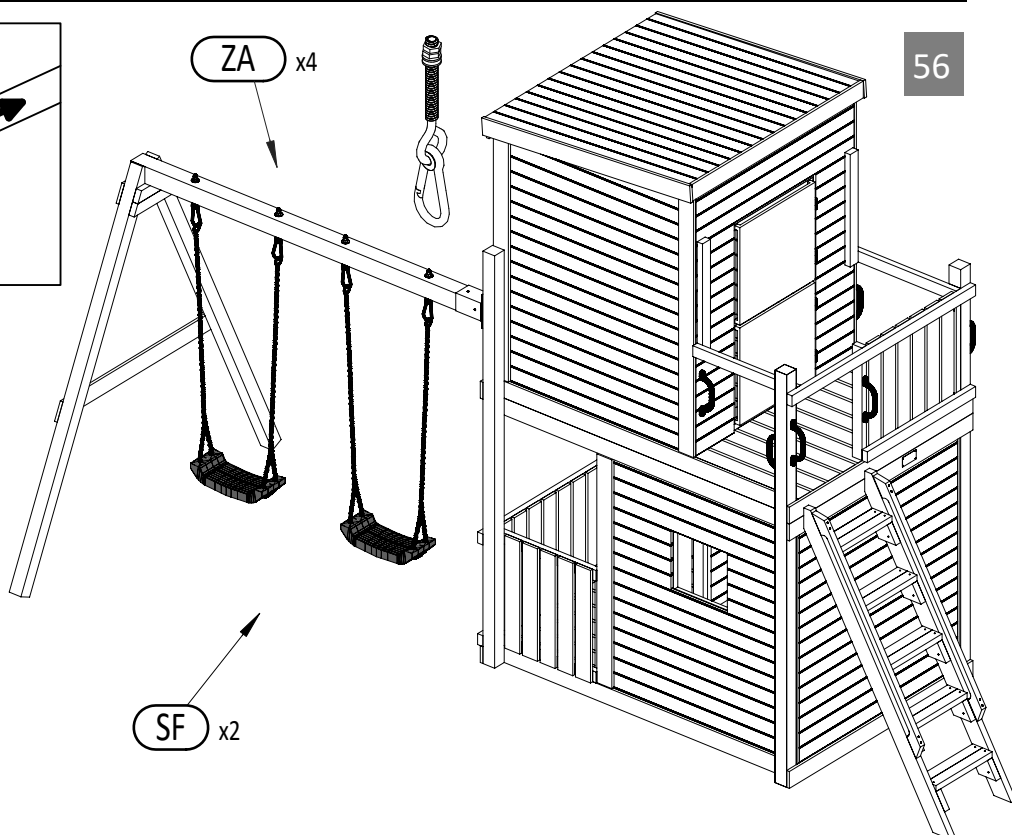
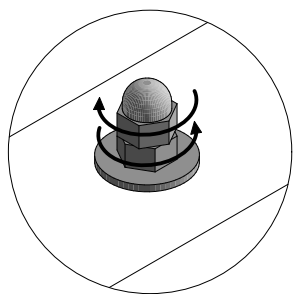
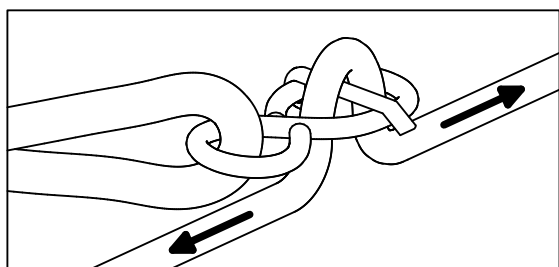

Zgodnie z normą PN-EN 71 stosuj zalecenia producenta odnośnie odległości oraz metody mocowania poszczególnych elementów

In compliance with the standard PN-EN 71, apply guidelines of the producer in relation to distances and methods of fastening individual elements