

PLAYGROUND SPIELPLATZ

PLAC ZABAW AIRE DE JEUX

(938 x 211 x h257cm)

003_08500_10102024

Maxi Funny Spacelonger

INSTALLATION INSTRUCTIONS
MONTAGEANLEITUNG

INSTRUKCJA MONTAŻU
GUIDE D'INSTALLATION

Warranty period - 2 years from purchase date

Garantiezeit - 2 Jahre ab Kaufdatum

Okres gwarancji - 2 lata od momentu zakupu towaru

Période de garantie - 2 ans à compter de l'achat



EN - 71

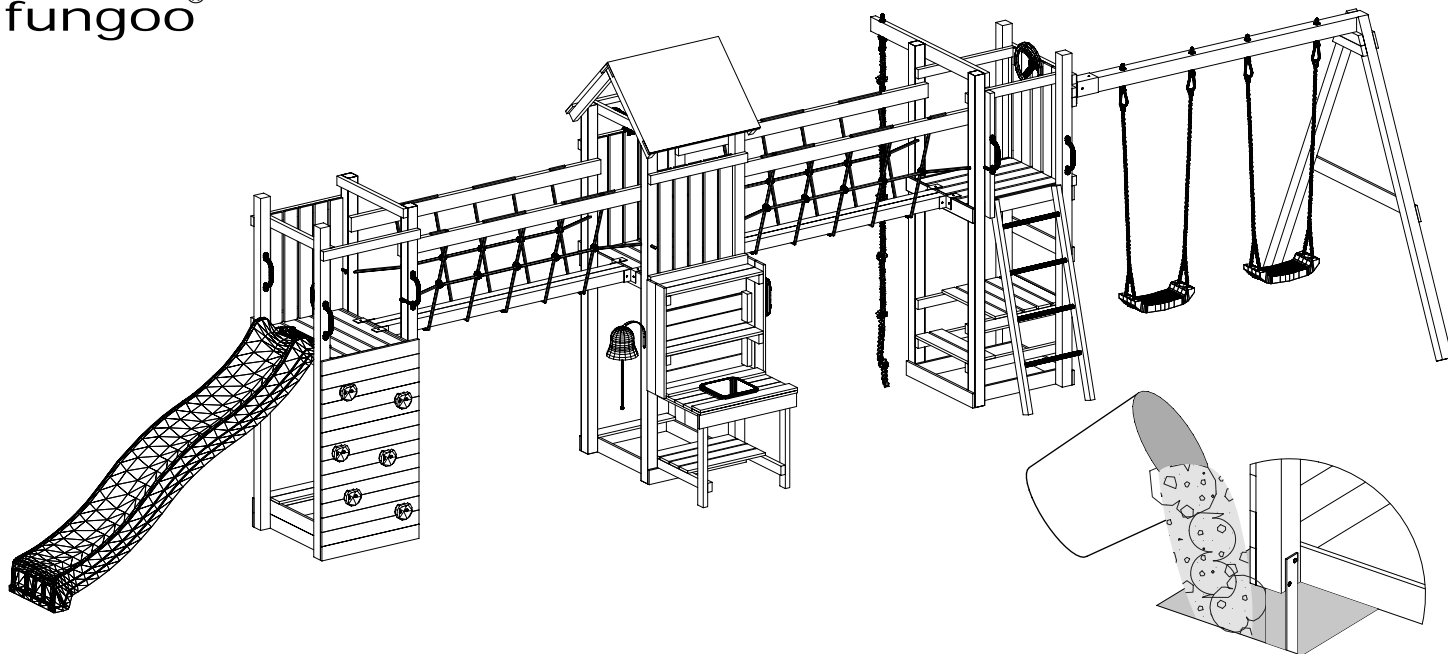

WARNINGS!

Only for home use.

Dedicated for external use only.

Not suitable for children under 3 years old.

Risk of falling down and/or hitting.

Maximum user weight is up to 50 kg.

Maximum number of users staying on the
playground at the same time: 15.

OSTRZEŻENIA !

Tylko do użytku domowego .

Przeznaczony do użytku na zewnątrz .

Nie przeznaczony dla dzieci poniżej 3 roku życia .

Niebezpieczeństwo upadku i /lub uderzenia .

Maksymalna waga użytkownika to 50 kg .

Maksymalna liczba użytkowników przebywających
na placu zabaw w tym samym czasie: 15.

ACHTUNG!

Nur für den privaten , häuslichen Bereich .

Ausschließlich für die Verwendung im Freien .

Nicht geeignet für Kinder unter 3 Jahren .

Stolper- und / oder Sturzgefahr

Höchstgewicht pro Einzelkind beträgt 50 kg

Der Aufenthalt auf diesem Spielturm ist max. : 15.

Kindern gleichzeitig erlaubt.

AVERTISSEMENT!

Aire exclusivement destinée à un usage privé .

Aire exclusivement destinée à un usage en extérieur .

Prévue pour les enfants de plus de 3 ans .

Danger de chute ou de choc.

Poids maximal d'un utilisateur : 50 kg .

Nombre maximal d'utilisateurs présents en
même temps sur la même aire de jeux : 15.

Maxi Funny Spacelonger

W80 x197
+1 Gratis



M12 x5

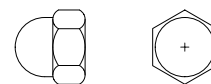

W40 x424
+4 Gratis



OS1 x132
+4 Gratis

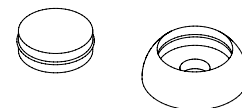

W30 x12

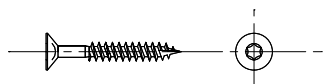

W20 x12

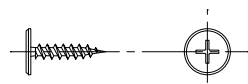

T80 x110

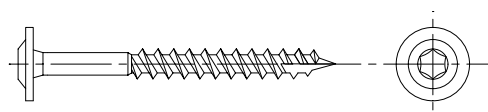

T60 x58



S50 x20

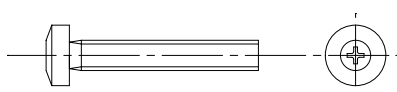

S30 x12

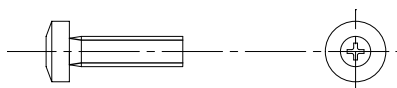

L11 x32

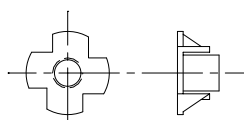

Ø3
00239
x1

Ø5,5
01372
x1

Ø10
00188
x1

P17 x52

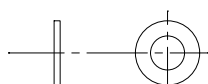

P15 x12

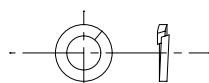

P28 x8

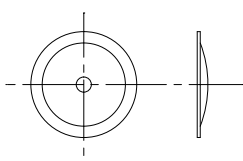

PH3
00068
x1

PZ2
00241
x1

TX25
00190
x1

TX30
00316
x1

TX40
00242
x1

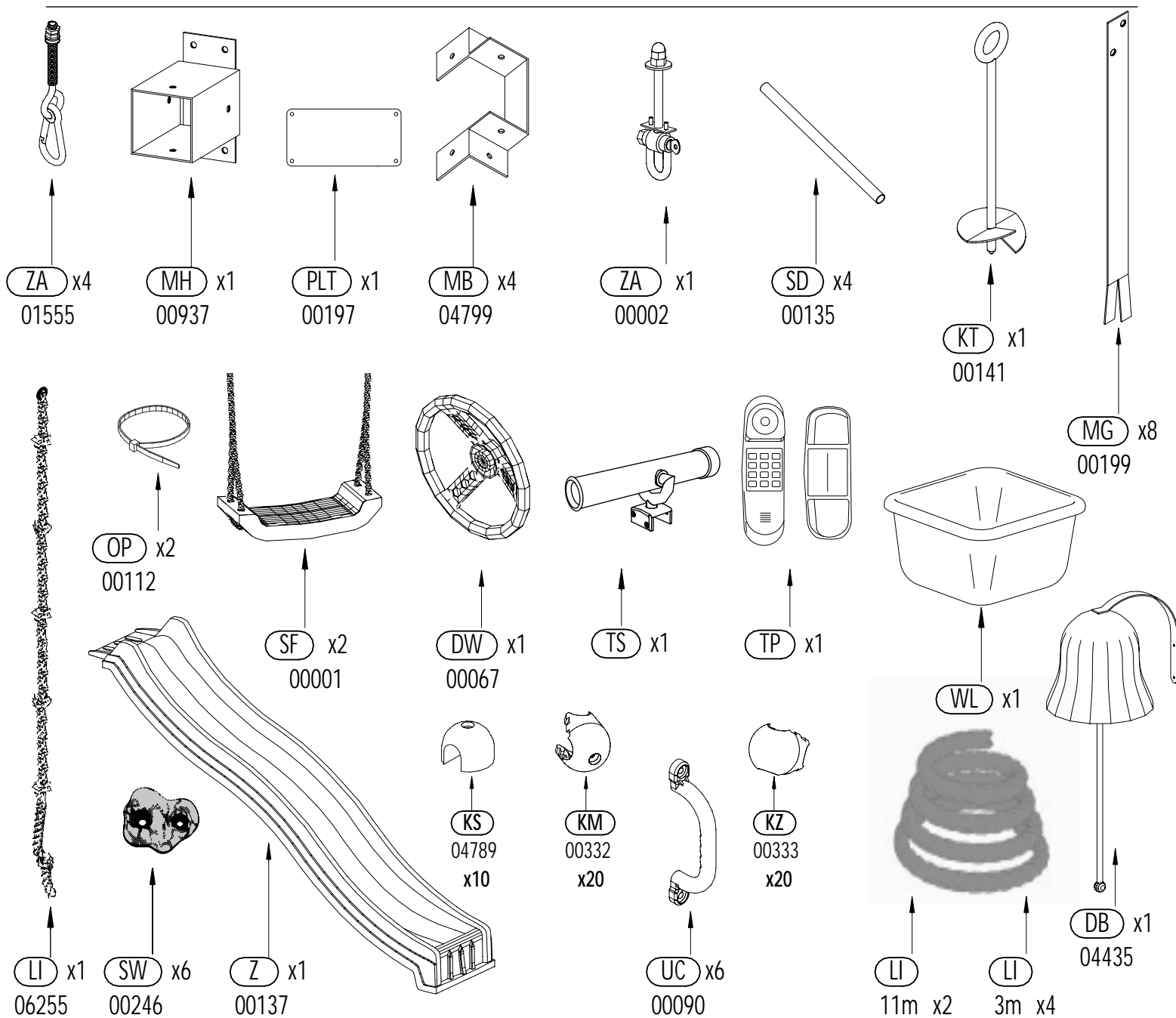
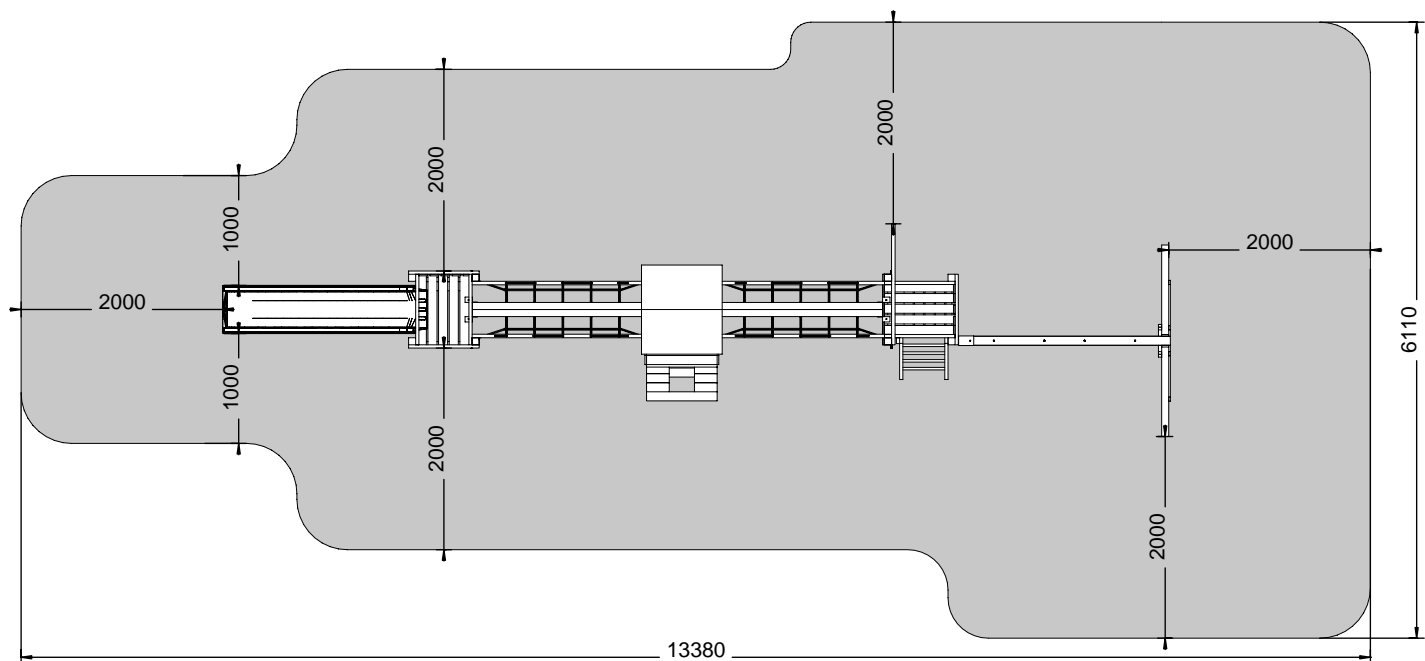

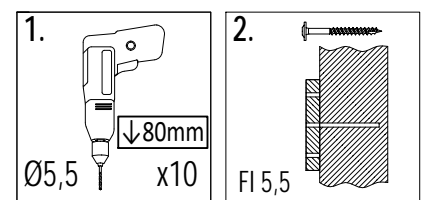
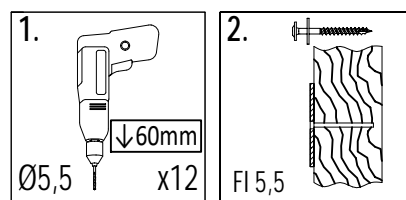
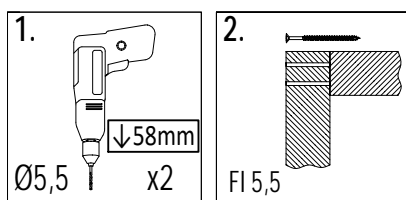
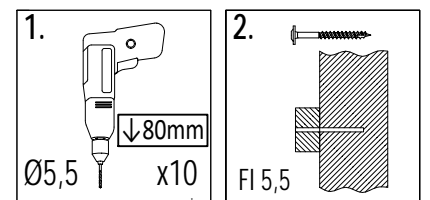
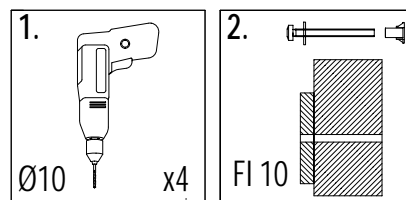
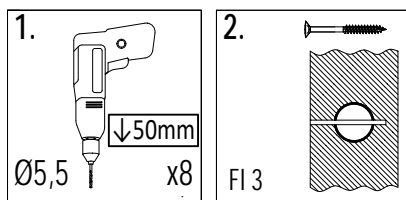
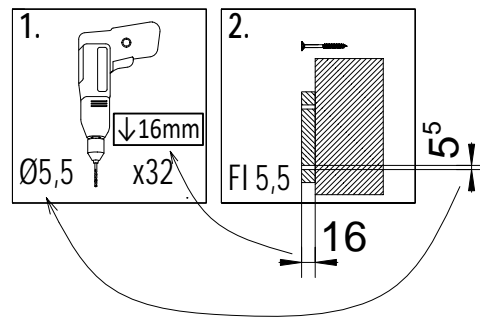
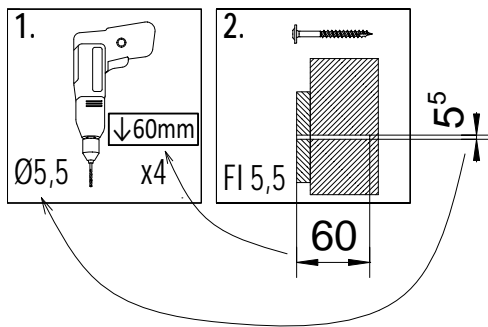
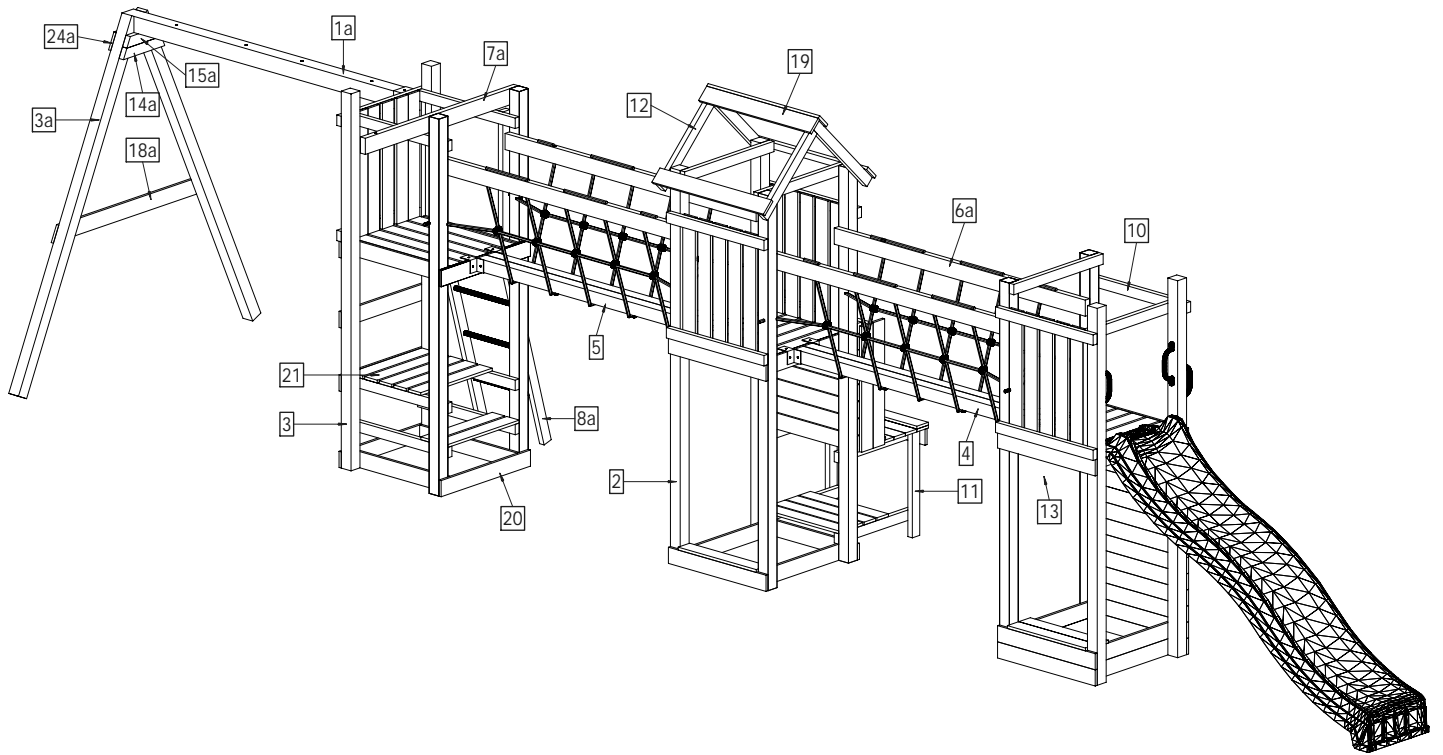

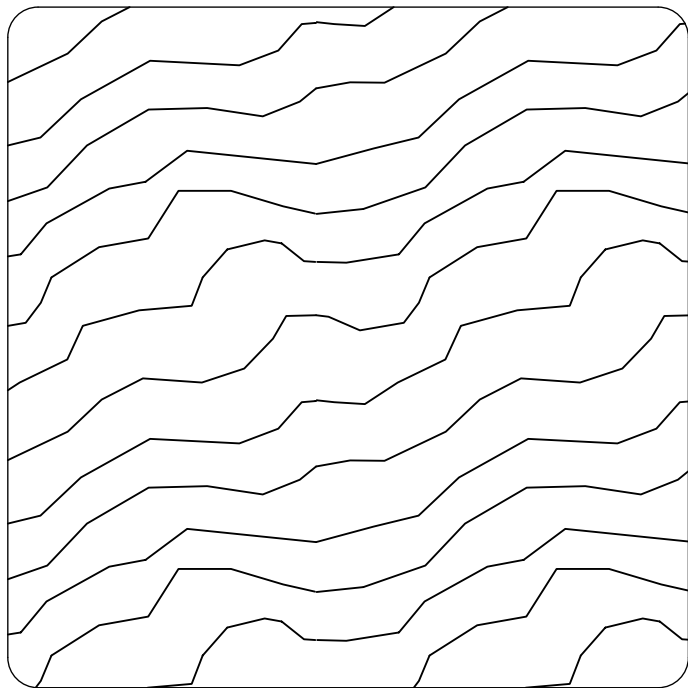

9 x 9 cm

Lp.	Kod	Wymiary [mm]	szt.
1a	04655	90x90x2100mm	1

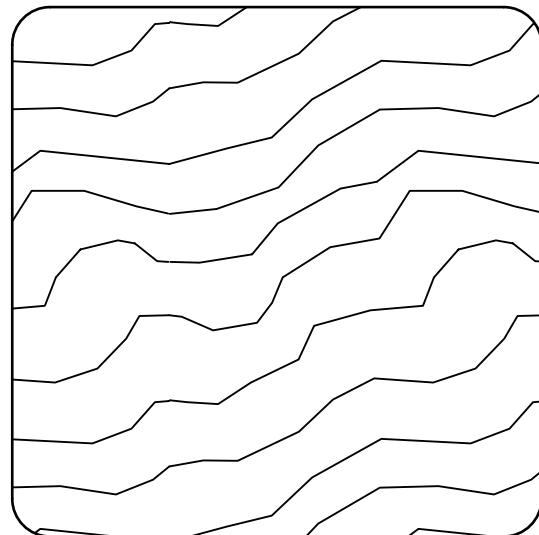

7 x 7 cm

Lp.	Kod	Wymiary [mm]	szt.
2	03901	70x70x2200mm	4
3	04611	70x70x2100mm	8
3a	05197	70x70x2100mm	2
4	05245	70x70x1800mm	2
5	08234	70x70x1710mm	2

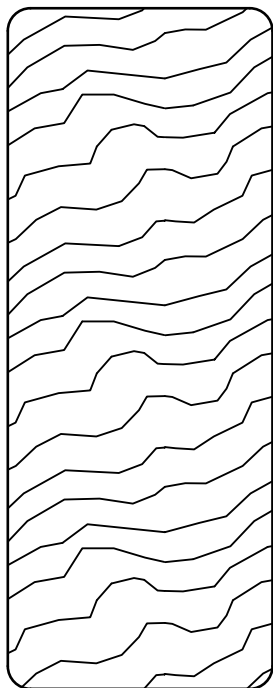

3,5 x 9,0 cm

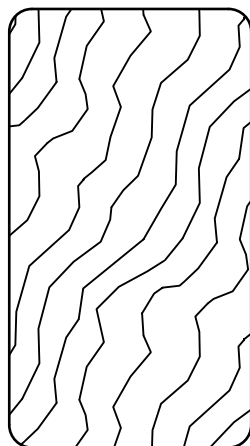

3,2 x 5,8 cm

Lp.	Kod	Wymiary [mm]	szt.
8a	04613	32x58x1300mm	2
9	05217	32x58x790mm	1
10	05219	32x58x700mm	19
11	03100	32x58x600mm	8
12	04619	32x58x550mm	2
13	05221	32x58x528mm	9
14a	05177	32x58x324mm	1
15a	05179	32x58x270mm	1
16	08441	32x58x180mm	8
17	05269	32x58x100mm	2

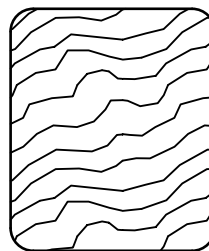

2,7 x 3,2 cm

Lp.	Kod	Wymiary [mm]	szt.
25a	05225	27x32x642mm	3

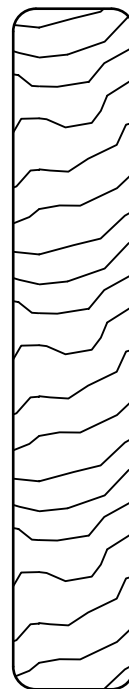

1,6 x 9,0 cm

Lp.	Kod	Wymiary [mm]	szt.
18a	03920	16x90x1200mm	1
19	04465	16x90x800mm	4
20	05223	16x90x700mm	98
21	05263	16x90x560mm	14
22	06226	16x90x450mm	2
23a	05187	16x90x300mm	1
24	08443	16x90x225mm	6

Lp.	Kod	Wymiary [mm]	szt.
6a	04818	35x90x1800mm	4
7a	05351	35x90x1200mm	1

01

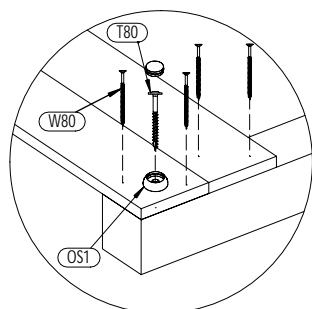
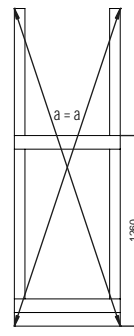
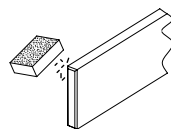
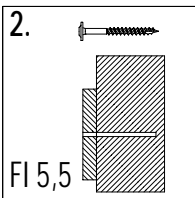
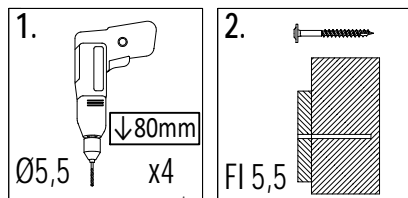

20 1,6x9,0x70cm x3

3 7,0x7,0x210cm x2

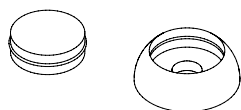
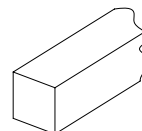
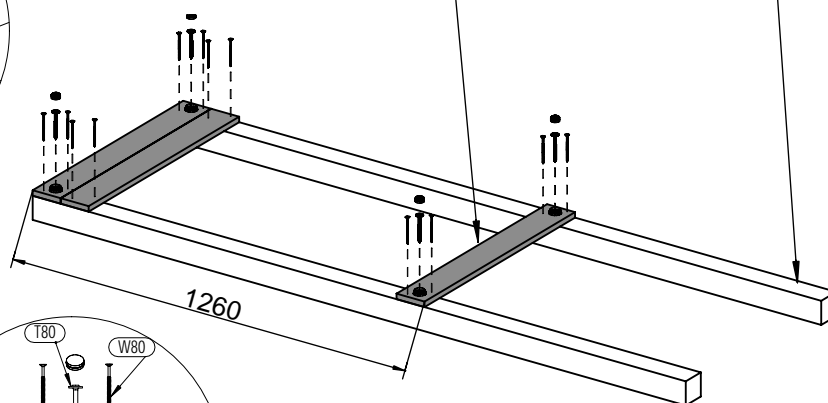

OS1 x4



W80 x12

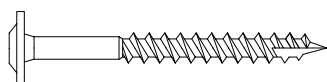

T80 x4

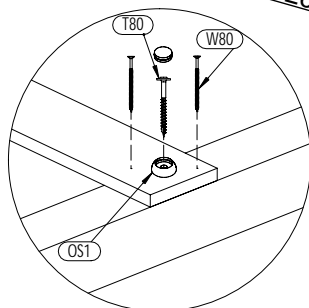

02

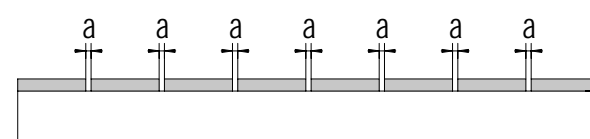
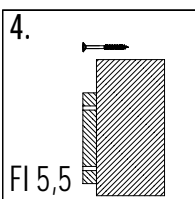
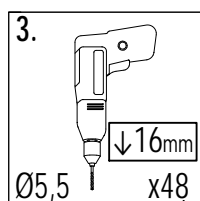
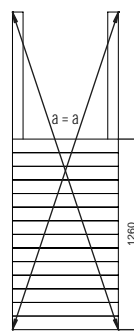
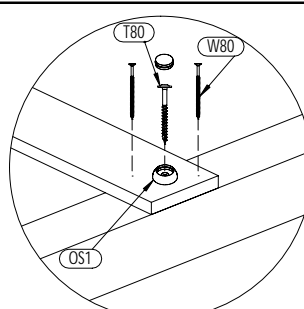
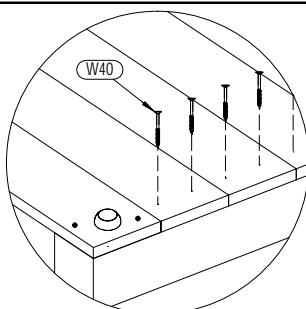
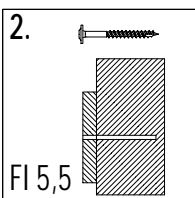
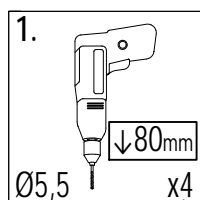

!!!min 2mm < a < !!!max 6mm

20 1,6x9,0x70cm x14

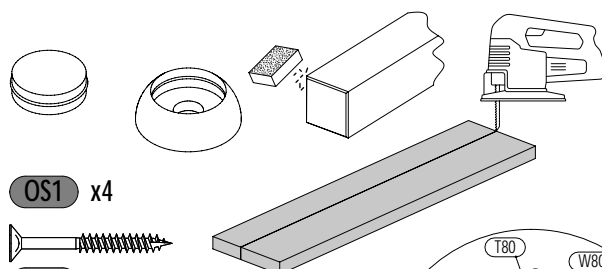

OS1 x4

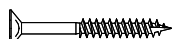

W40 x48



W80 x8

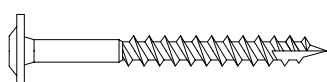

T80 x4

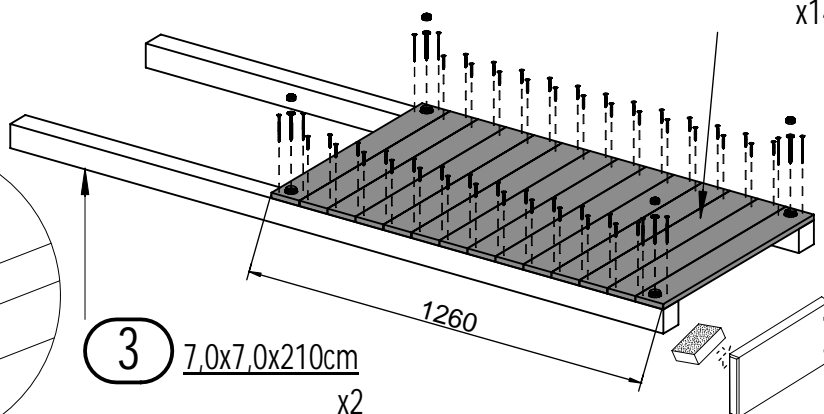
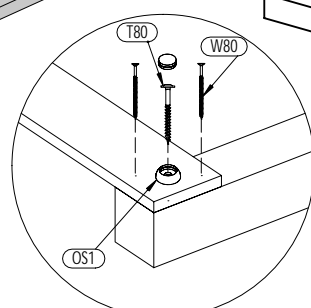

3 7,0x7,0x210cm x2

20 1,6x9,0x70cm

x6

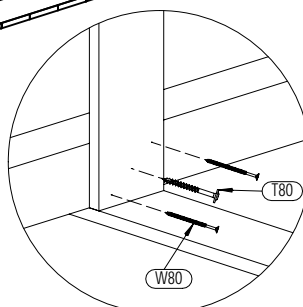
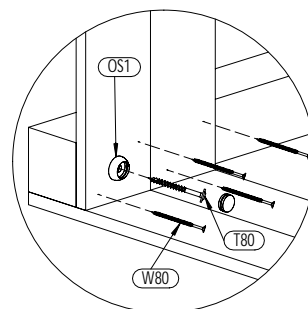
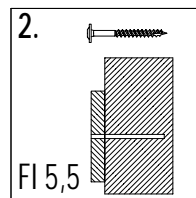
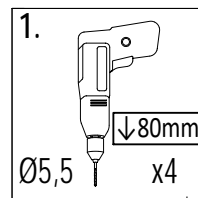
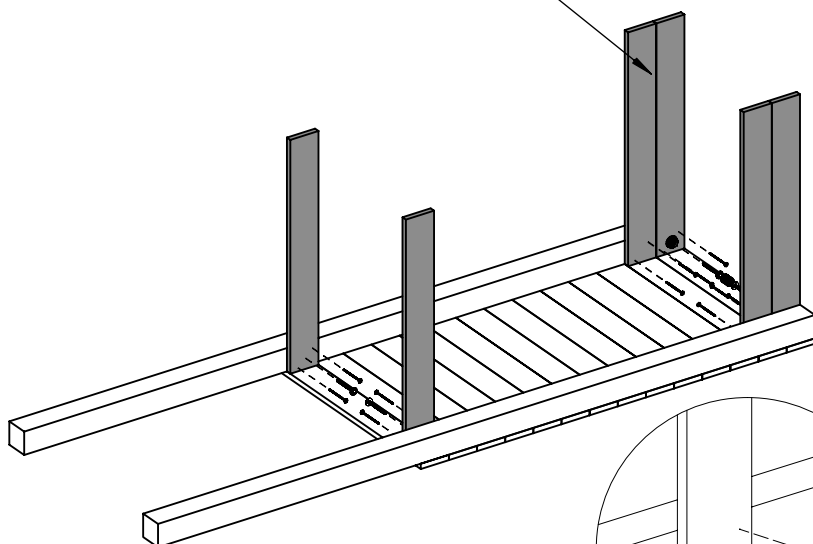

OS1 x2



W80 x12



T80 x4

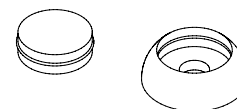
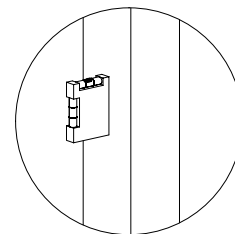
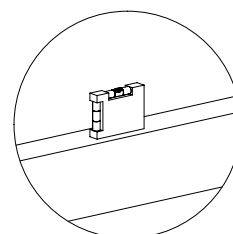
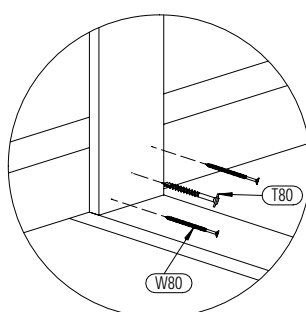
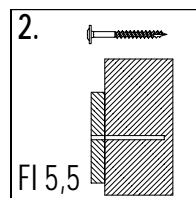
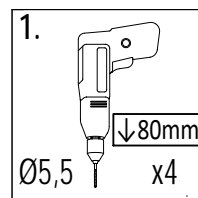

OS1 x2

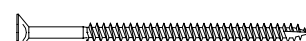

W80 x12

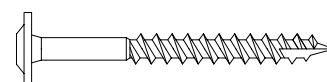

T80 x4

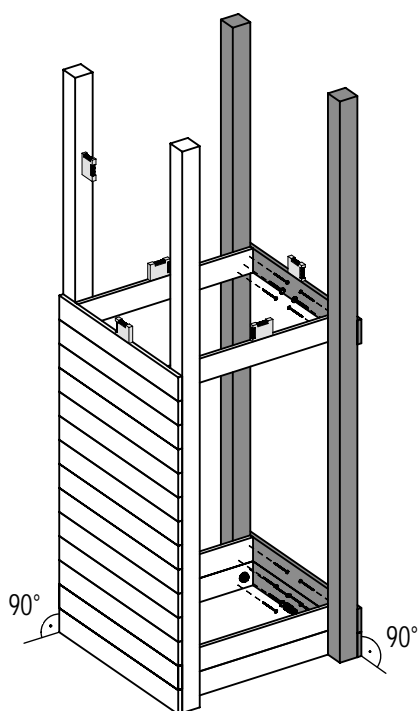

05

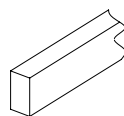
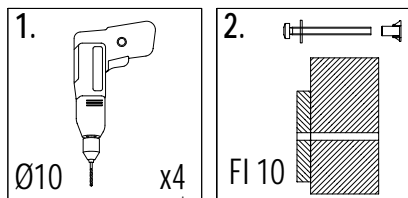

13 3,2x5,8x52,8cm
x2

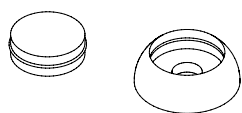

OS1 x4

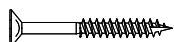

W40 x4

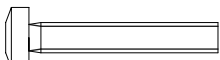

S50 x4



P17 x4



L11 x4

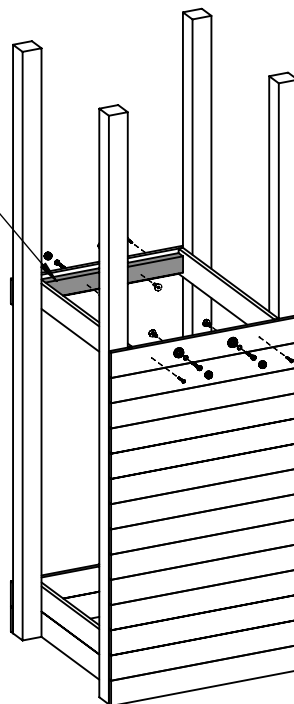
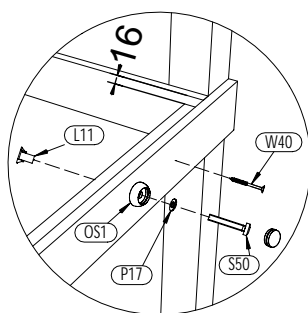

06

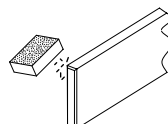
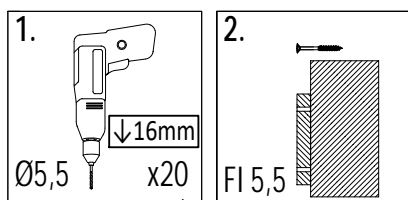

20 1,6x9,0x70cm
x5

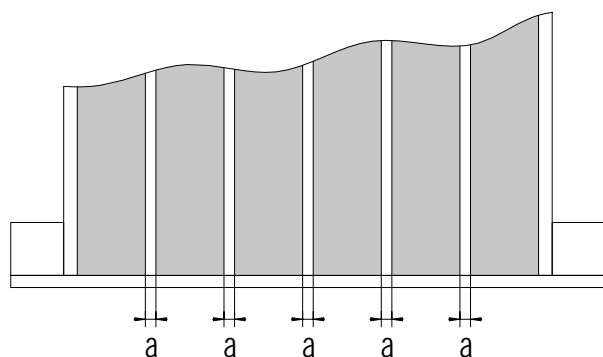

!!!min 13mm < a < !!!max 23mm

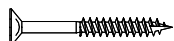

W40 x20

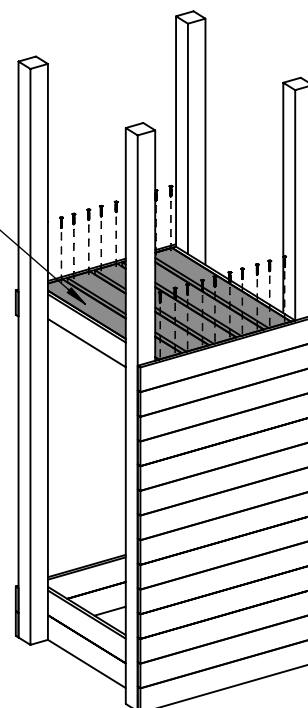

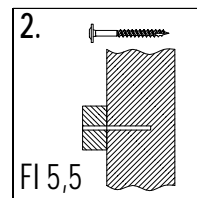
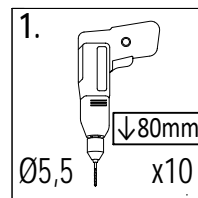
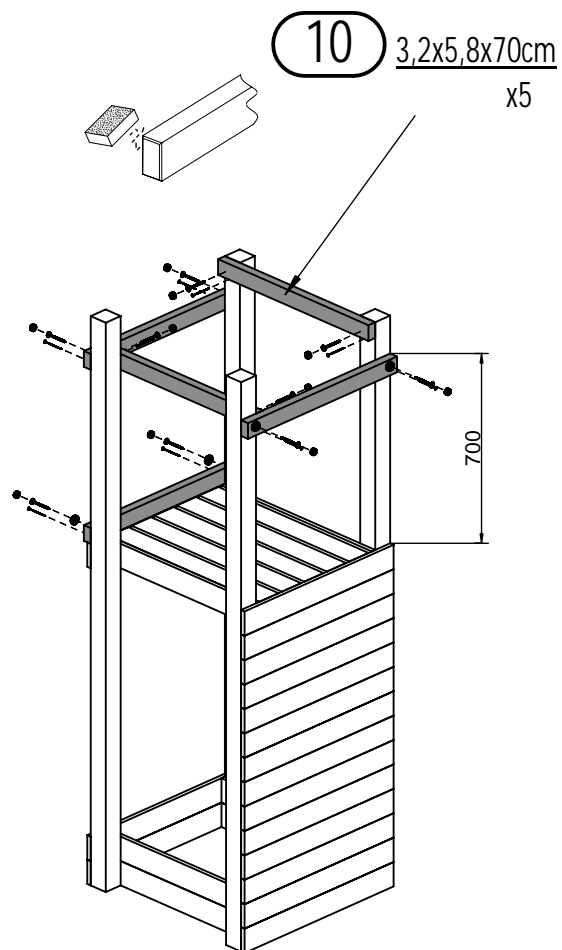

07



OS1 x10



W80 x10

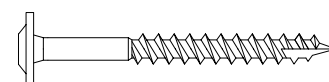

T80 x10

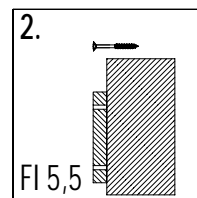
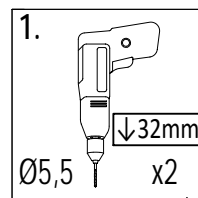
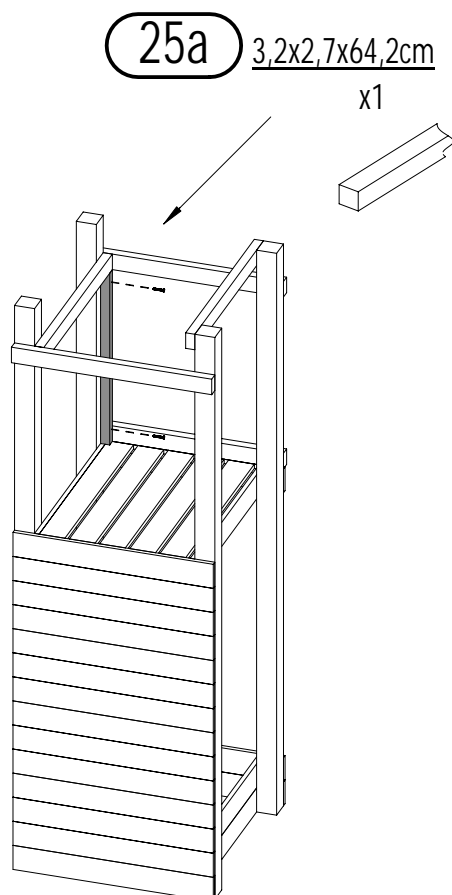

08

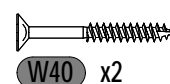
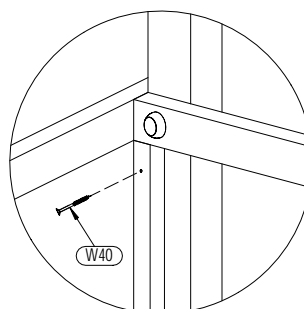

W40 x2

09

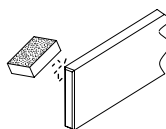
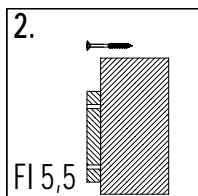
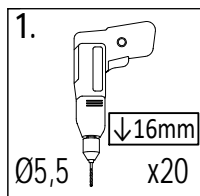

20 1,6x9,0x70cm
x5

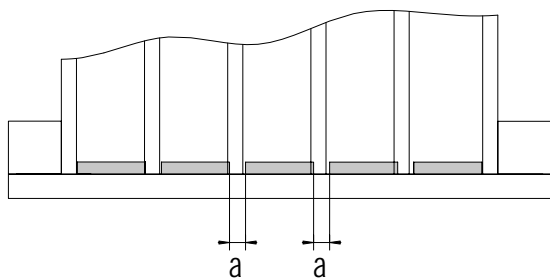

!!!min 13mm < **a** < !!!max 23mm

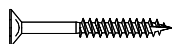
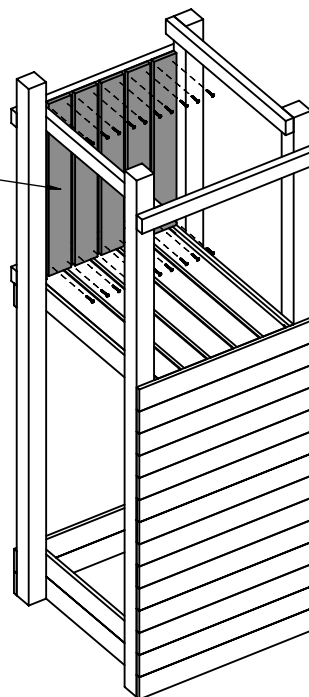

W40 x20

10

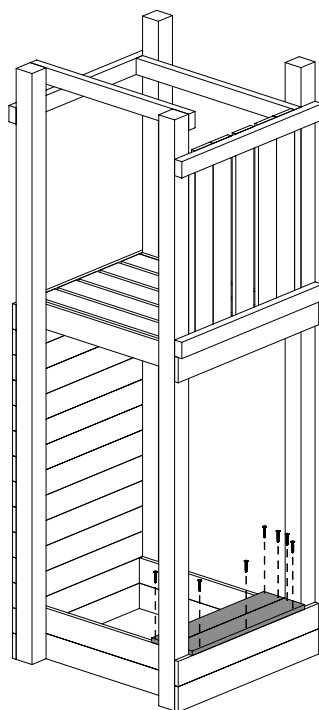
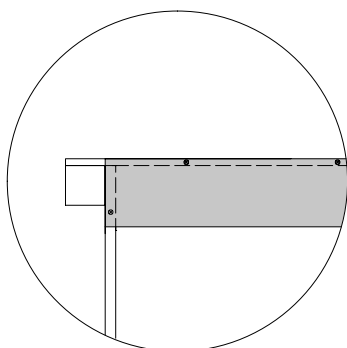
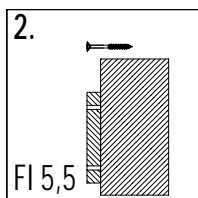
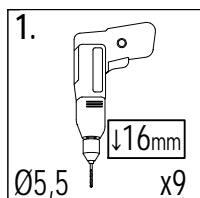

21 1,6x9,0x56cm
x2

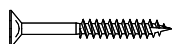

W40 x9

10

Zgodne z normą PN-EN 71 stosuj zalecenia producenta odnośnie odległości oraz metody mocowania poszczególnych elementów
In compliance with the standard PN-EN 71, apply guidelines of the producer in relation to distances and methods of fastening individual elements

Maxi Funny Spacelonger

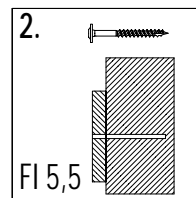
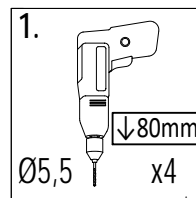
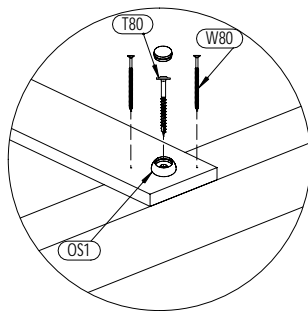
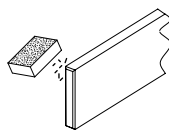
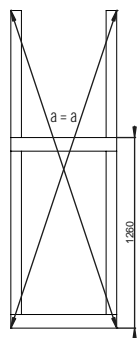

11

20 1,6x9,0x70cm x2

3 7,0x7,0x210cm x2

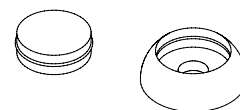
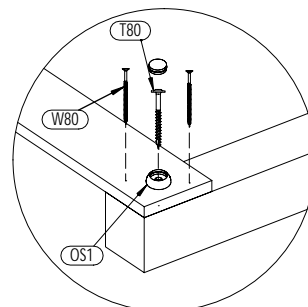
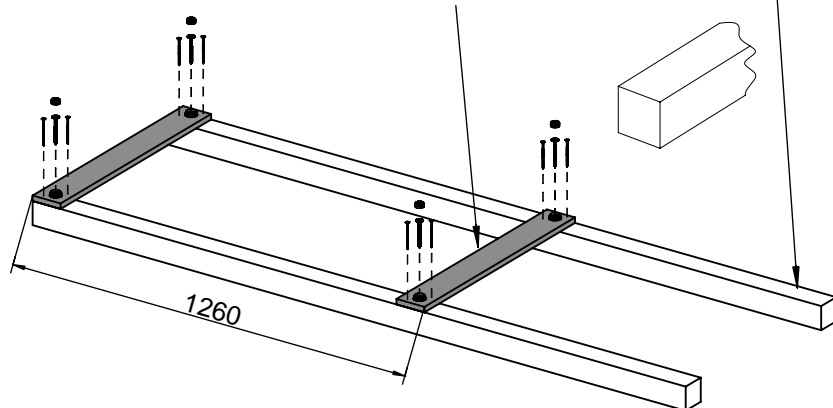

OS1 x4

W80 x8

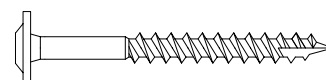

T80 x4

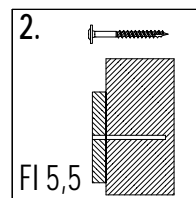
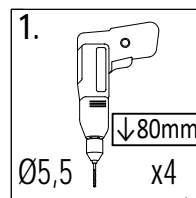
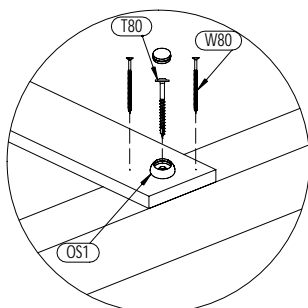
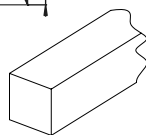
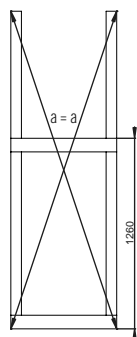

12

3 7,0x7,0x210cm x2

20 1,6x9,0x70cm x3

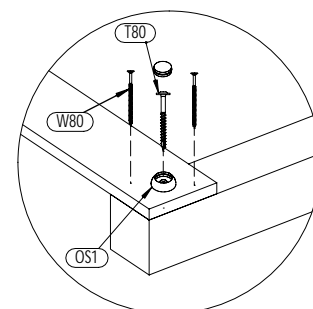
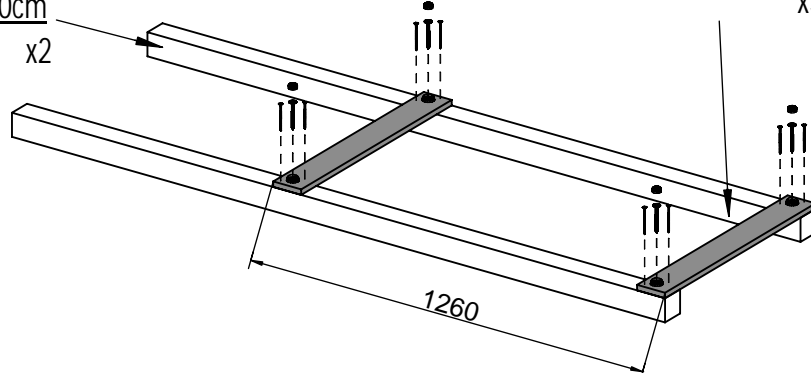

OS1 x4

W80 x8

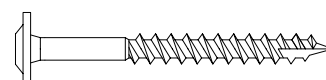

T80 x4

13

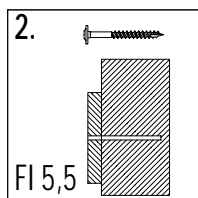
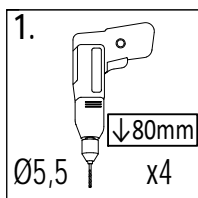

20 1,6x9,0x70cm
x4

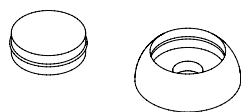
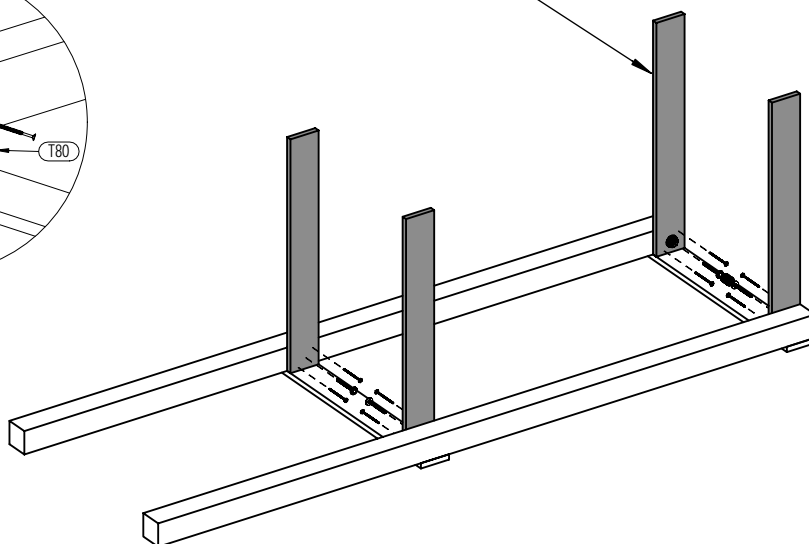
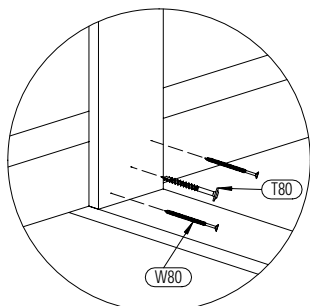
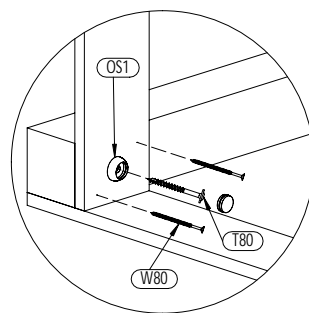

OS1 x2

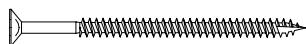

W80 x8



T80 x4

14

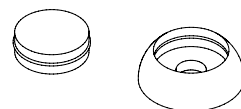
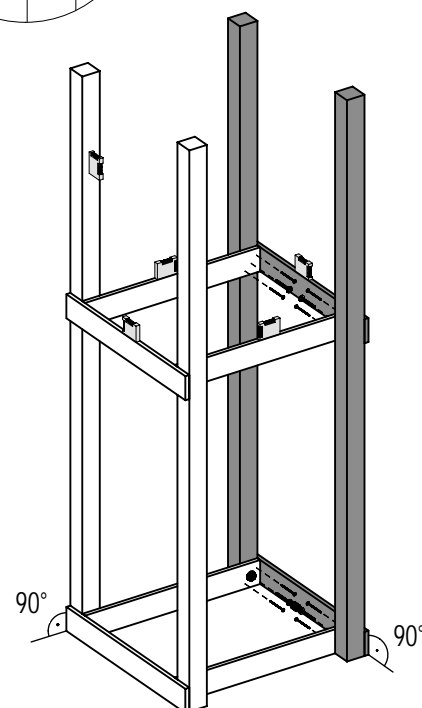
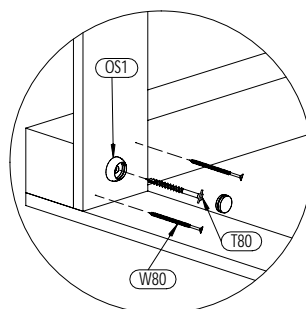
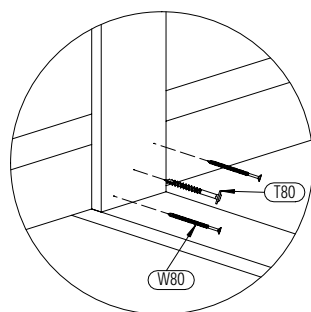
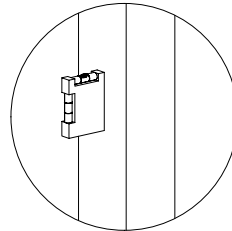
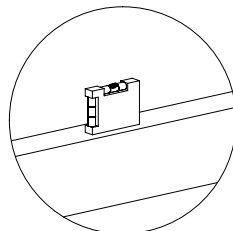
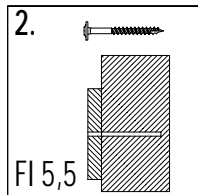
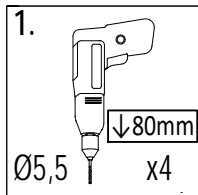

OS1 x2



W80 x8

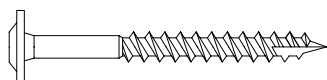

T80 x4

12

Zgodnie z normą PN-EN 71 stosuj zalecenia producenta odnośnie odległości oraz metody mocowania poszczególnych elementów
In compliance with the standard PN-EN 71, apply guidelines of the producer in relation to distances and methods of fastening individual elements

Maxi Funny Spacelonger

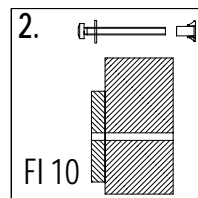
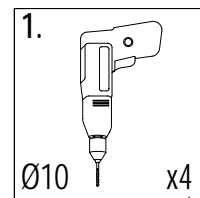
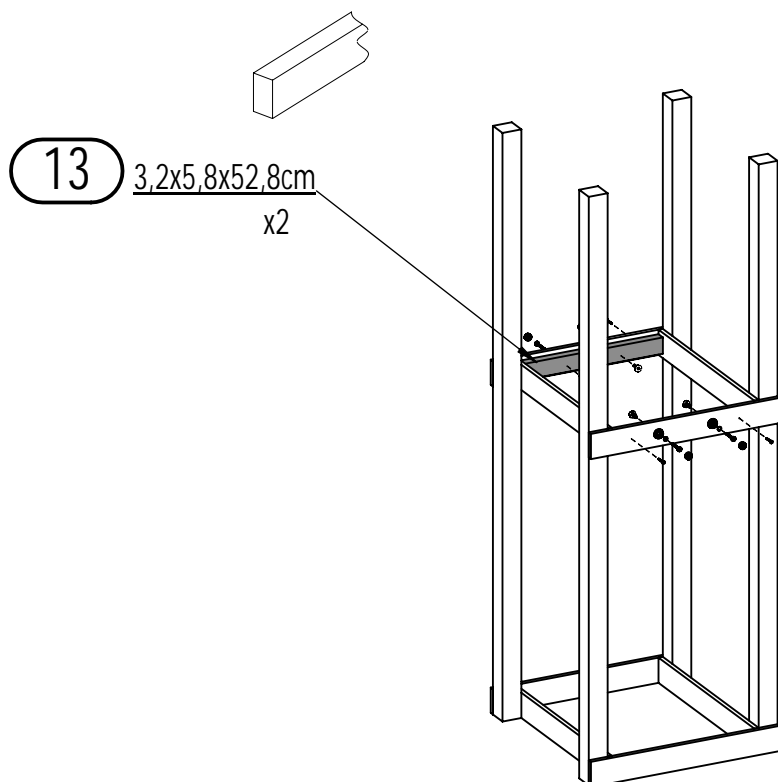

15

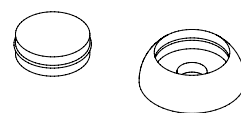
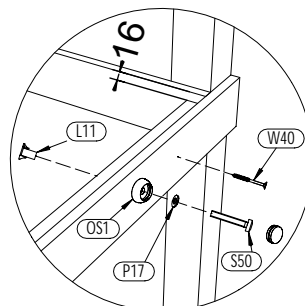

OS1 x4

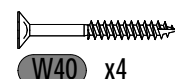

W40 x4

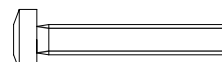

S50 x4



P17 x4



L11 x4

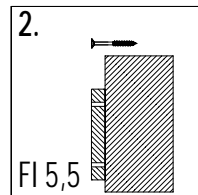
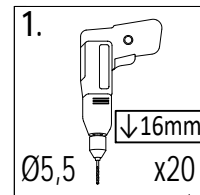
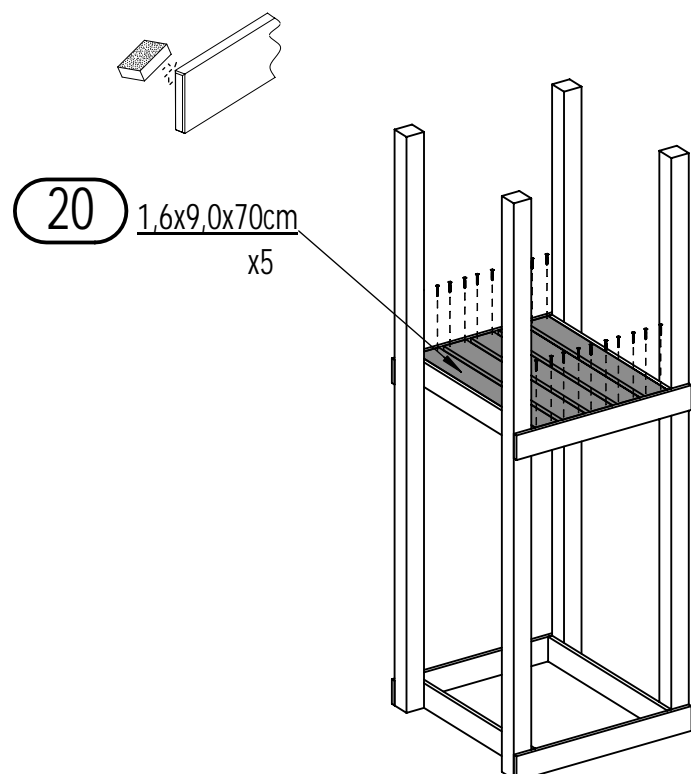

16

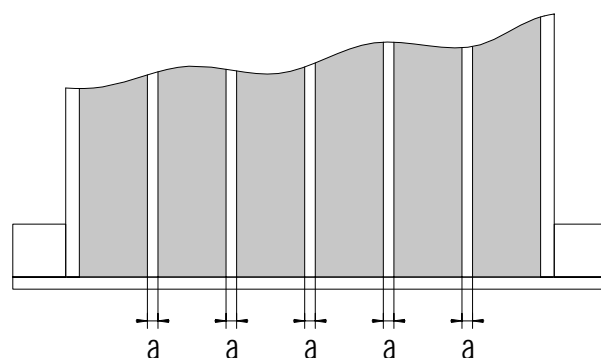

!!!min 13mm < **a** < !!!max 23mm

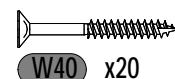

W40 x20

13

17

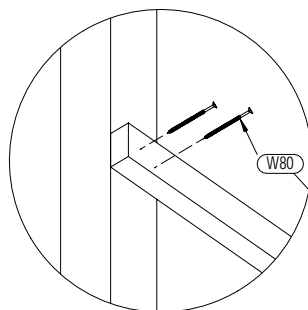
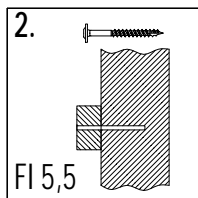
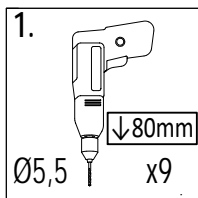

7a

3,5x9,0x120cm

x1

10

3,2x5,8x70cm

x4

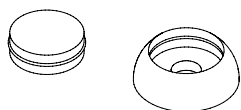

OS1 x9

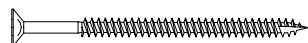

W80 x11



T80 x9

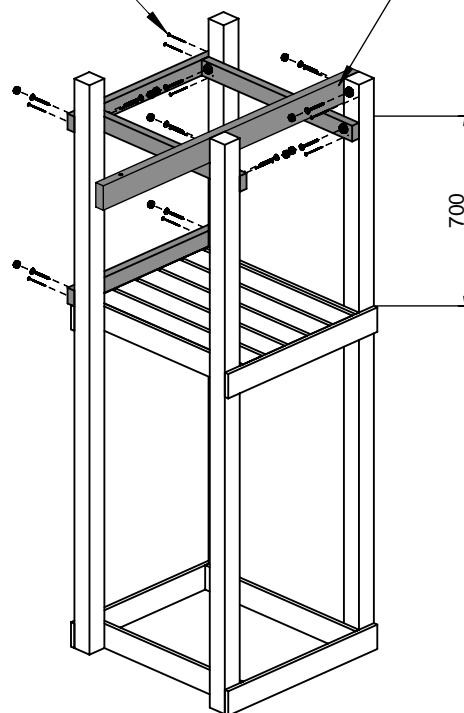
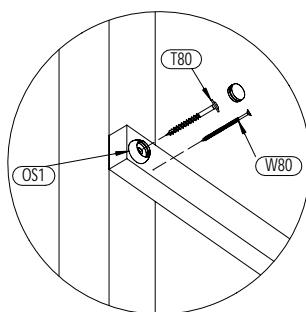

18

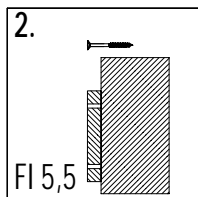
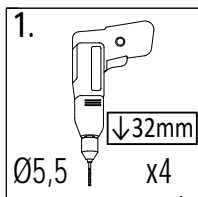

25a

3,2x2,7x64,2cm

x2

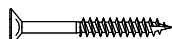
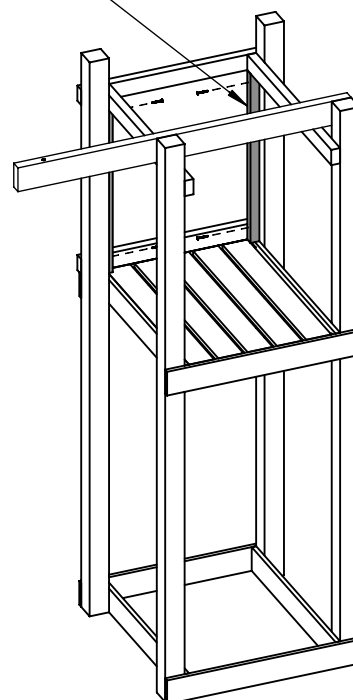
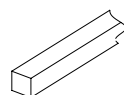
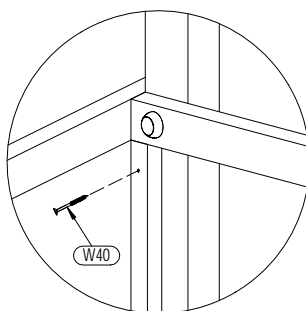

W40 x4

14

Zgodnie z normą PN-EN 71 stosuj zalecenia producenta odnośnie odległości oraz metody mocowania poszczególnych elementów
In compliance with the standard PN-EN 71, apply guidelines of the producer in relation to distances and methods of fastening individual elements

Maxi Funny Spacelonger

20 1,6x9,0x70cm
x5

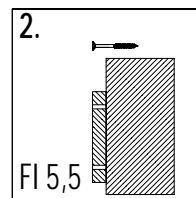
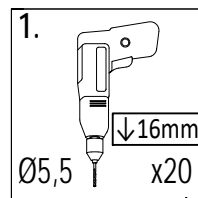
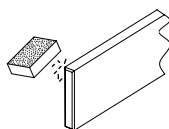
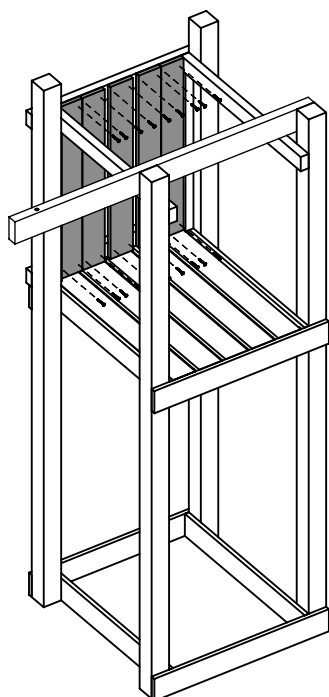

19

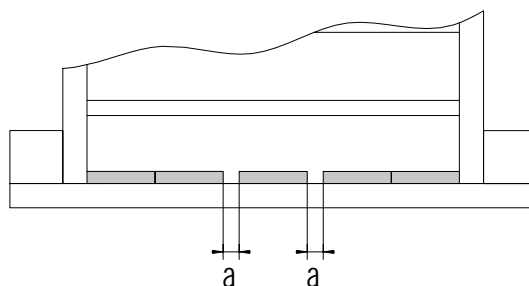

!!!min 13mm < a < !!!max 23mm

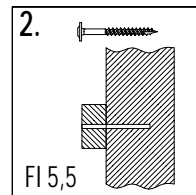
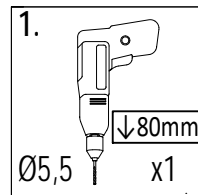
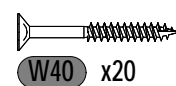

20

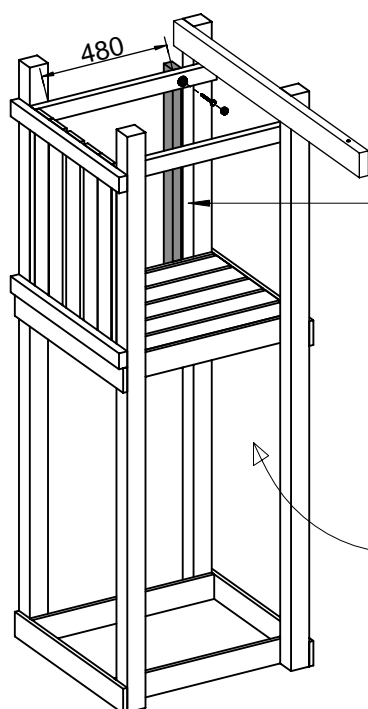

9 3,2x5,8x79cm
x1

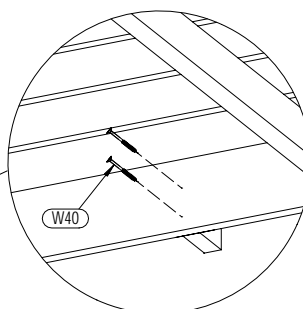
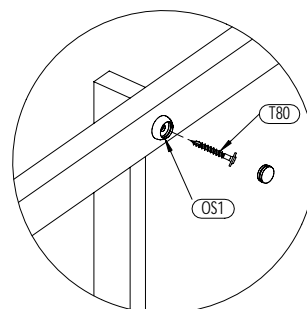
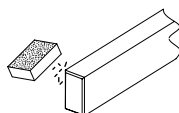

OS1 x1

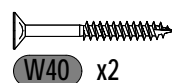

W40 x2

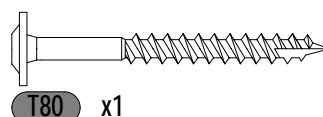

T80 x1

21

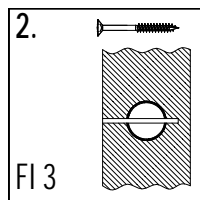
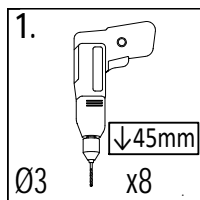

8a 3,2x5,8x130cm x2

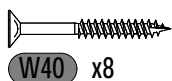
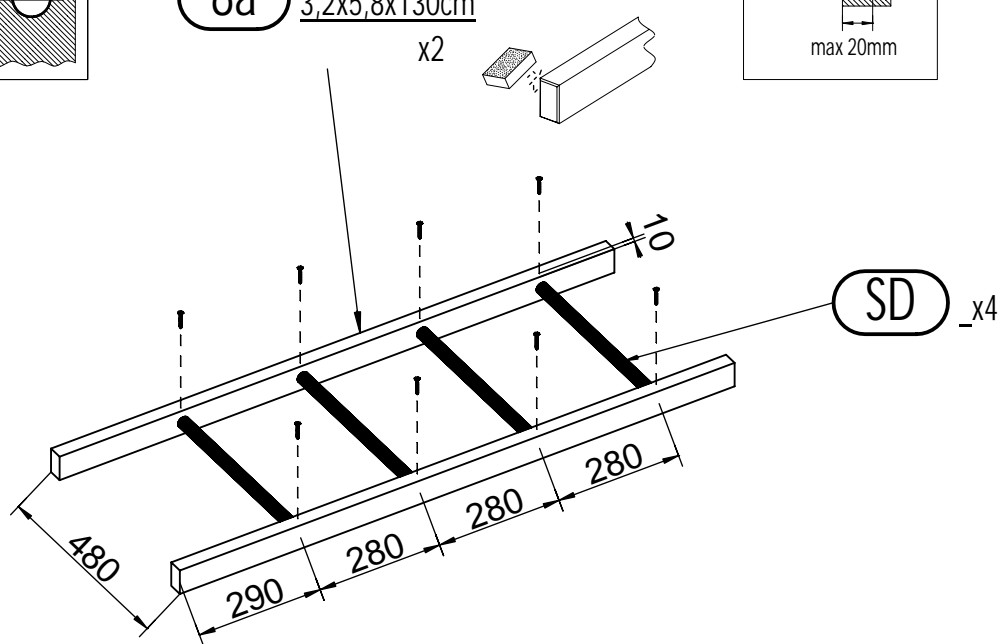
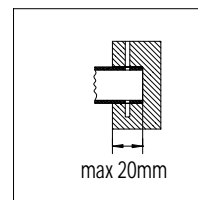

22

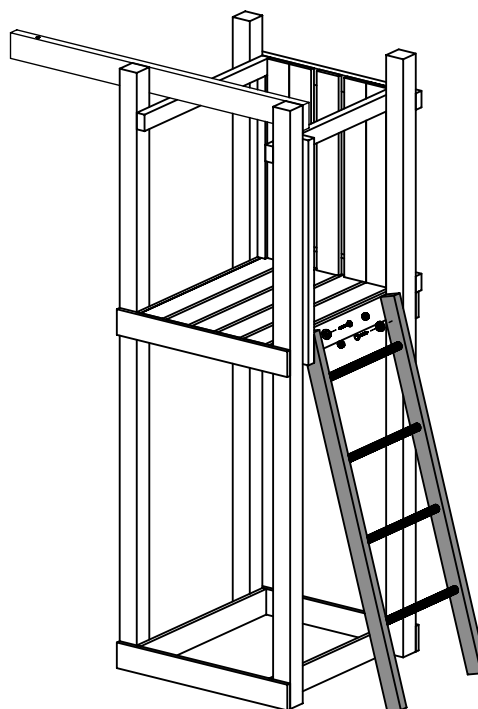
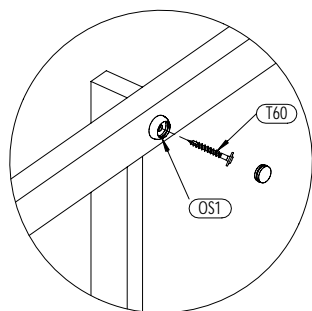
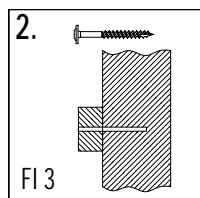
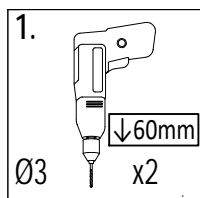

OS1 x2

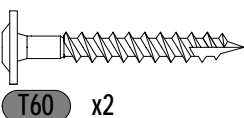

16

Zgodnie z normą PN-EN 71 stosuj zalecenia producenta odnośnie odległości oraz metody mocowania poszczególnych elementów
In compliance with the standard PN-EN 71, apply guidelines of the producer in relation to distances and methods of fastening individual elements

Maxi Funny Spacelonger

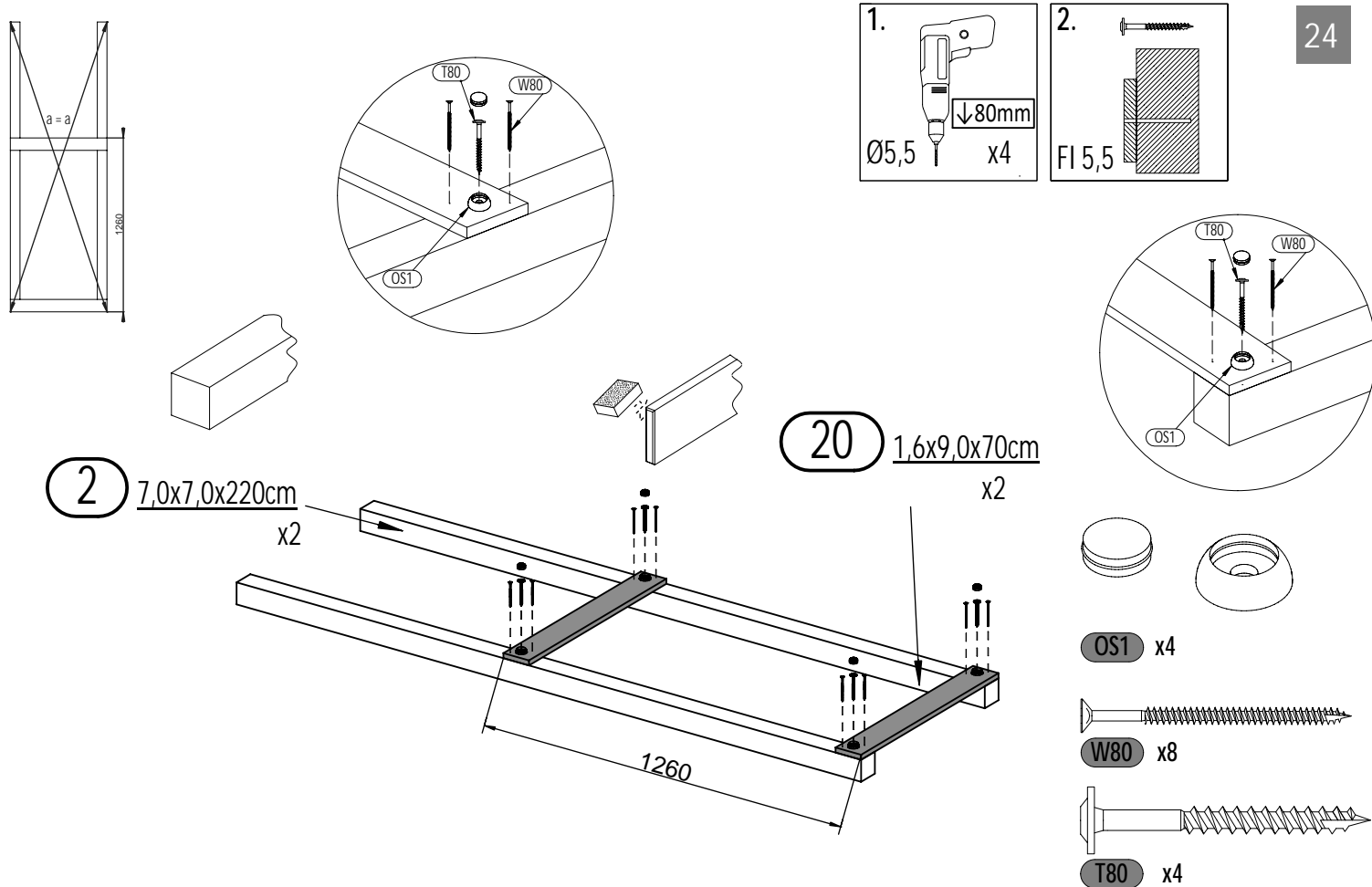
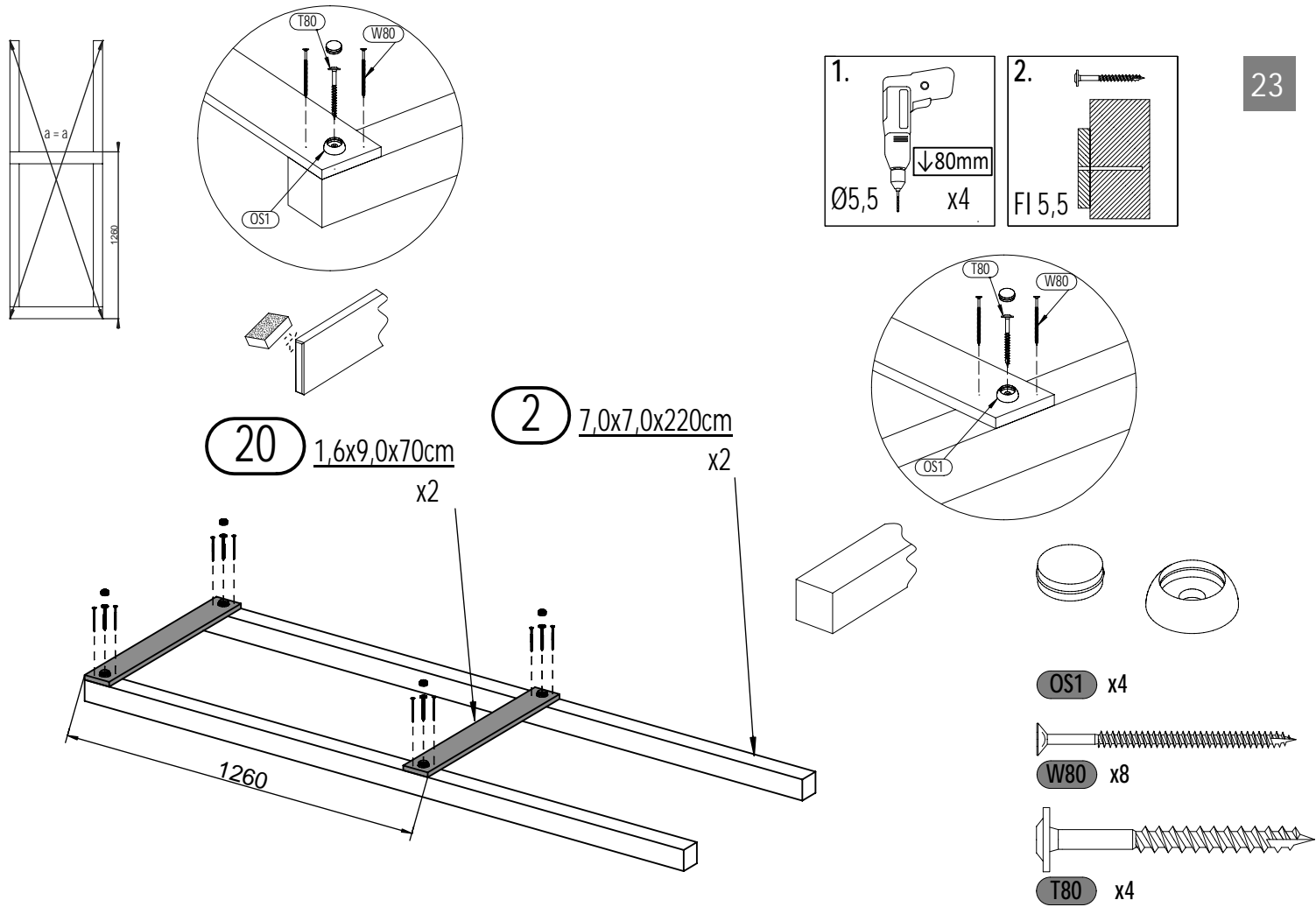

25

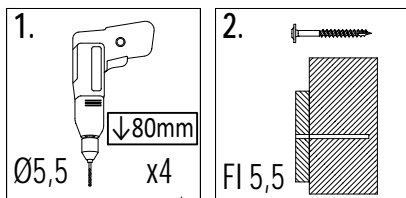

20 1,6x9,0x70cm

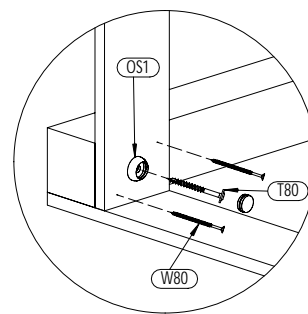

x6

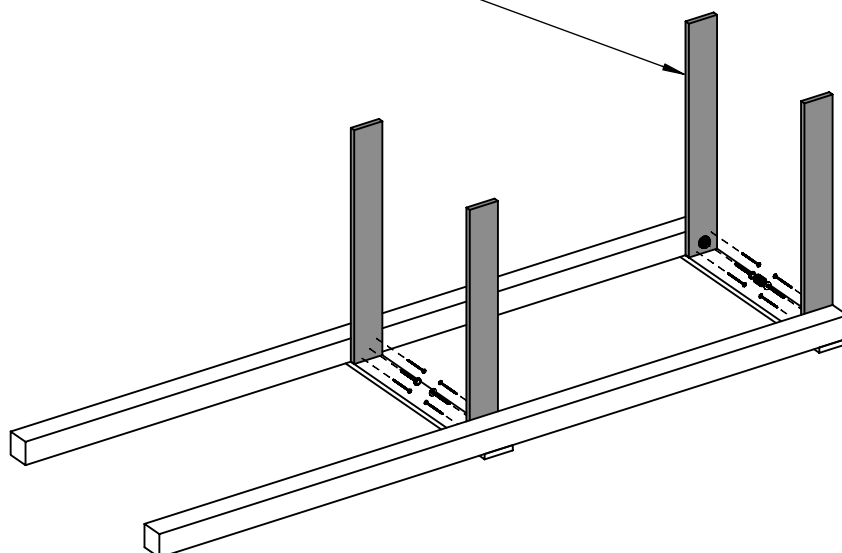

OS1 x2



W80 x8



T80 x4

26

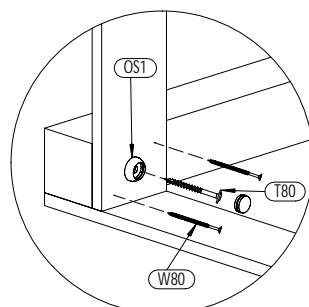
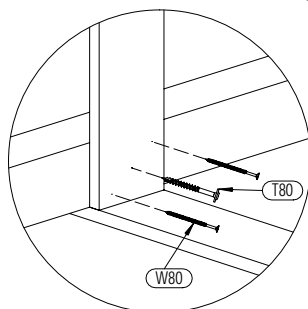
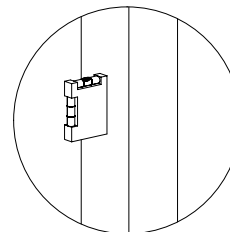
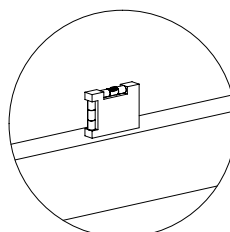
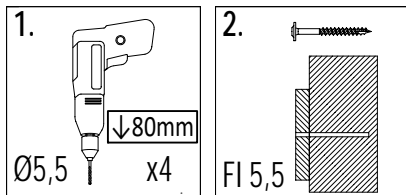

OS1 x2



W80 x8

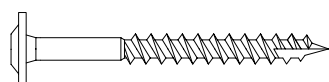

T80 x4

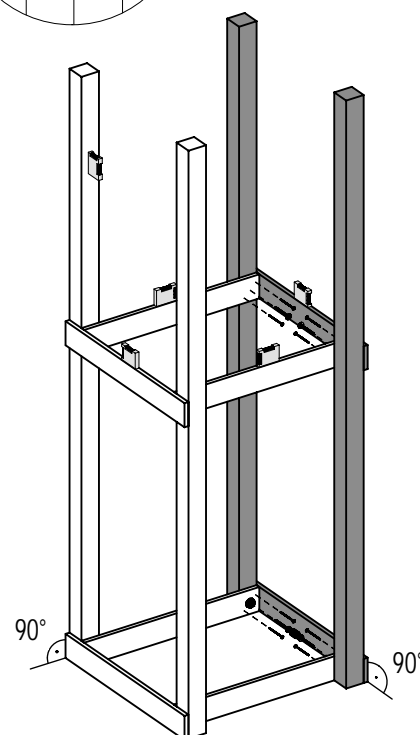

18

Zgodnie z normą PN-EN 71 stosuj zalecenia producenta odnośnie odległości oraz metody mocowania poszczególnych elementów
In compliance with the standard PN-EN 71, apply guidelines of the producer in relation to distances and methods of fastening individual elements

Maxi Funny Spacelonger

13 3,2x5,8x52,8cm
x2

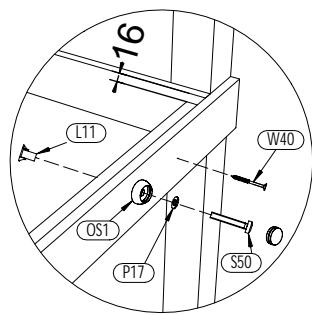
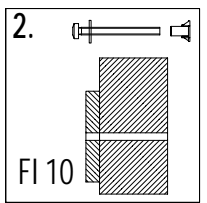
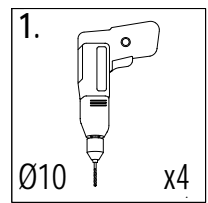
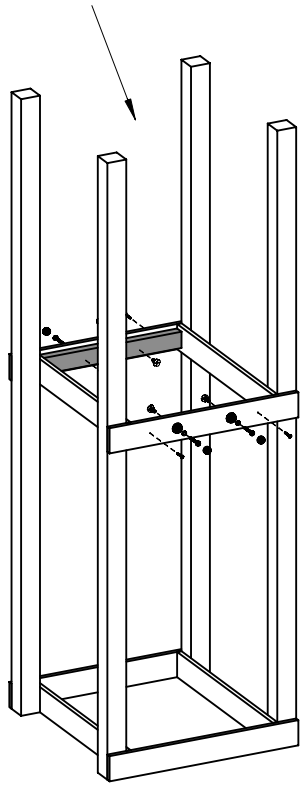

- OS1 x4
- W40 x4
- S50 x4
- P17 x4
- L11 x4

20 1,6x9,0x70cm
x5

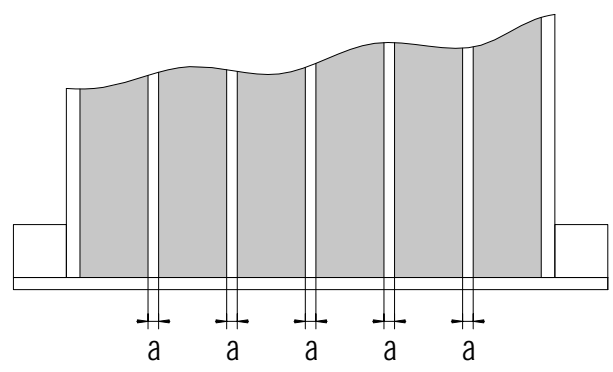
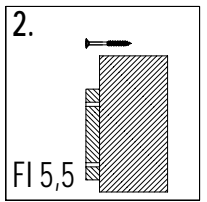
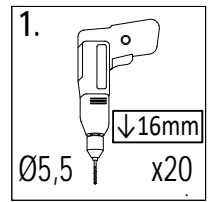
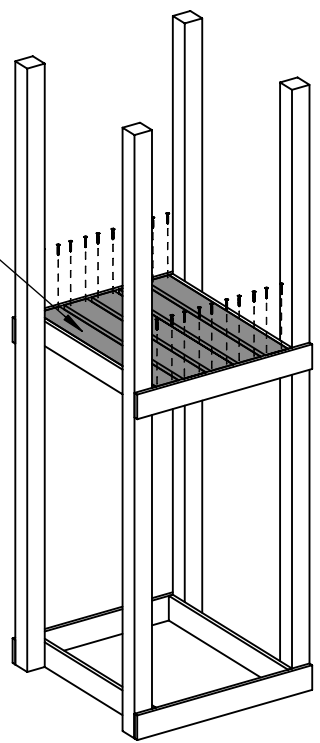
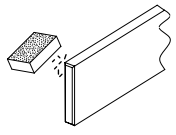

!!!min 13mm < a < !!!max 23mm

- W40 x20

29

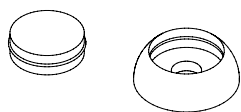
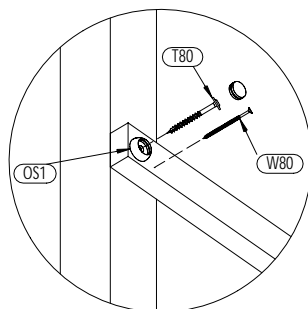
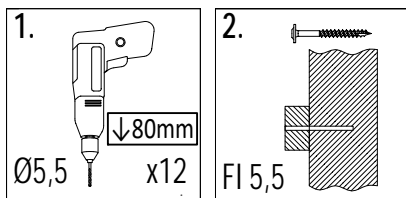

OS1 x12

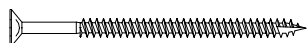

W80 x12

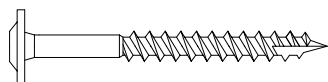

T80 x12

10 $3,2 \times 5,8 \times 70\text{cm}$
x6

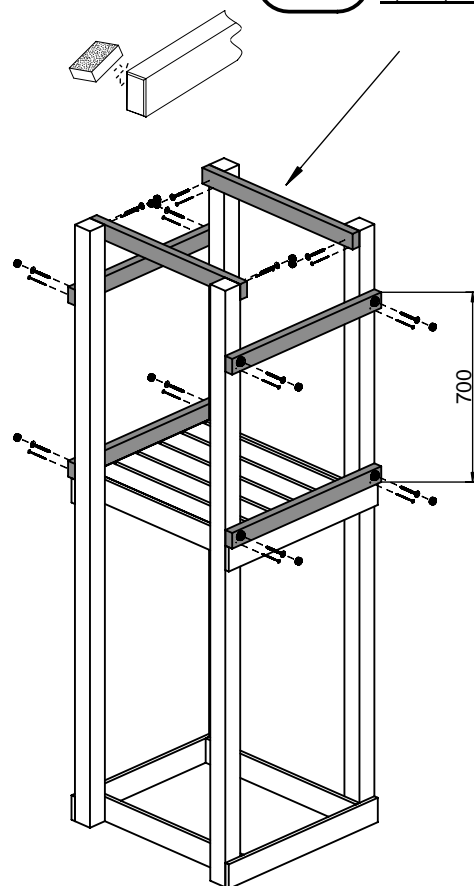

30

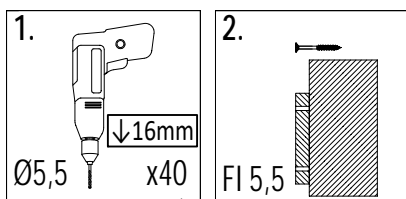

20 $1,6 \times 9,0 \times 70\text{cm}$
x10

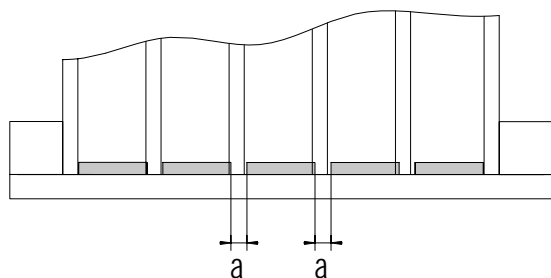
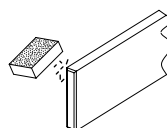

!!!min 13mm < a < !!!max 23mm

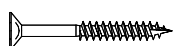

W40 x40

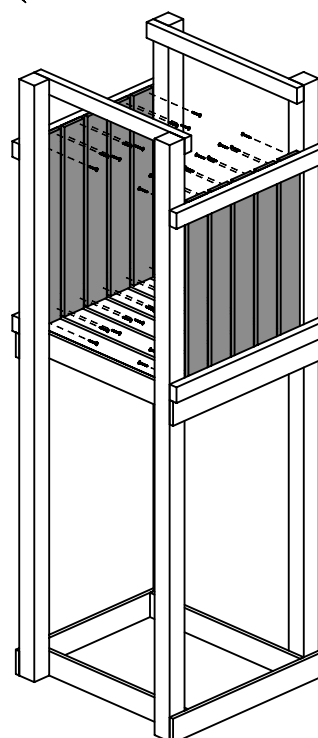

20

Zgodnie z normą PN-EN 71 stosuj zalecenia producenta odnośnie odległości oraz metody mocowania poszczególnych elementów
In compliance with the standard PN-EN 71, apply guidelines of the producer in relation to distances and methods of fastening individual elements

Maxi Funny Spacelonger

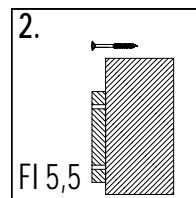
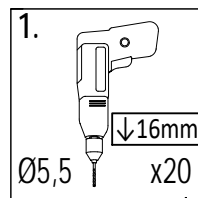
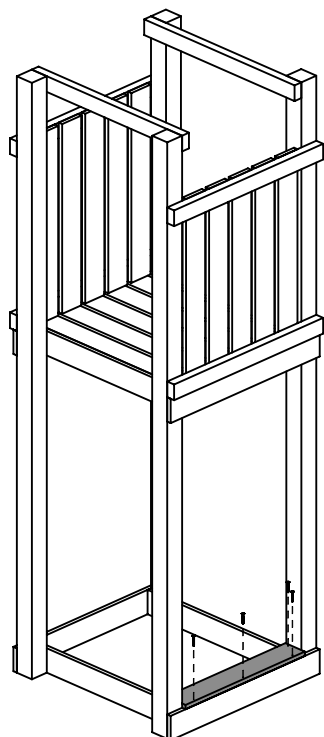

31

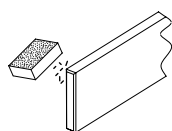

21 1,6x9,0x56cm
x1

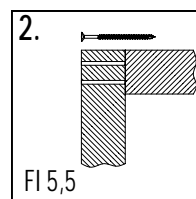
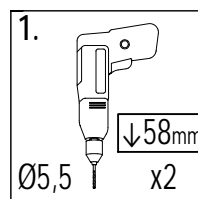
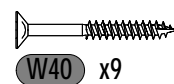

32

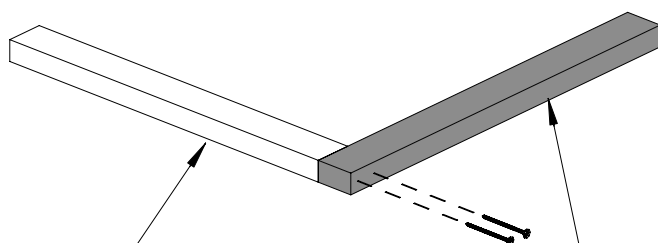

12 3,2x5,8x55cm
x1

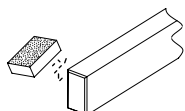

x2

11 3,2x5,8x60cm
x1

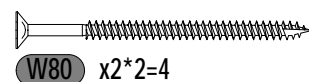
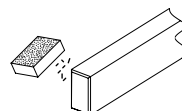

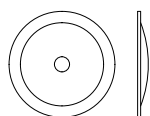
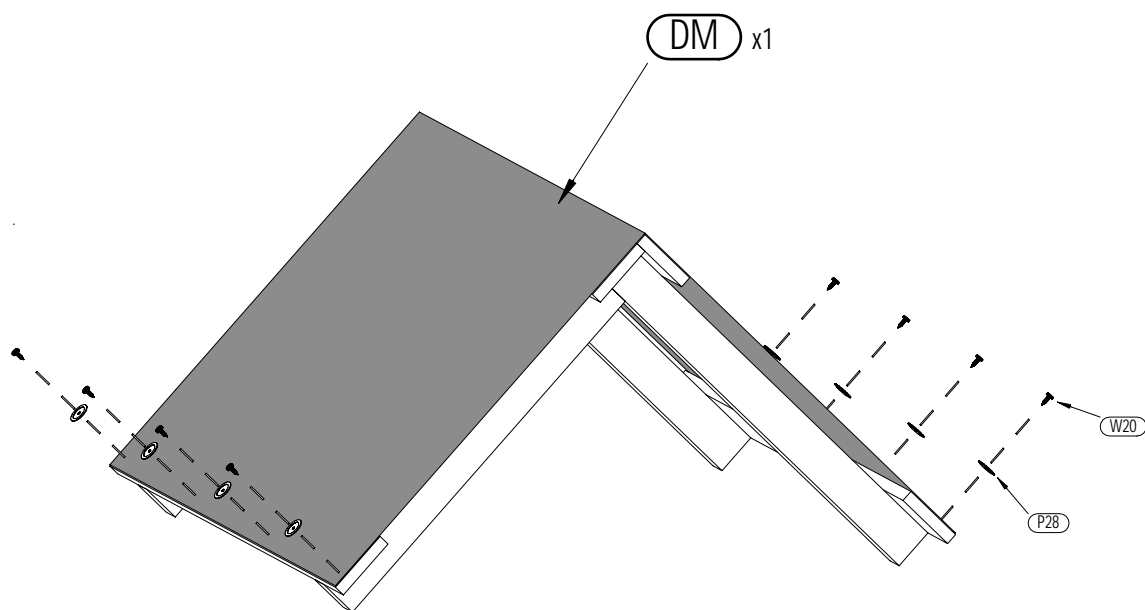
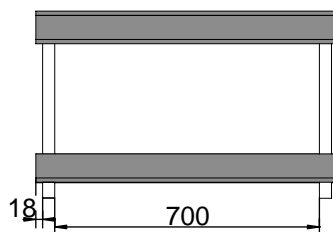
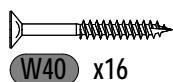
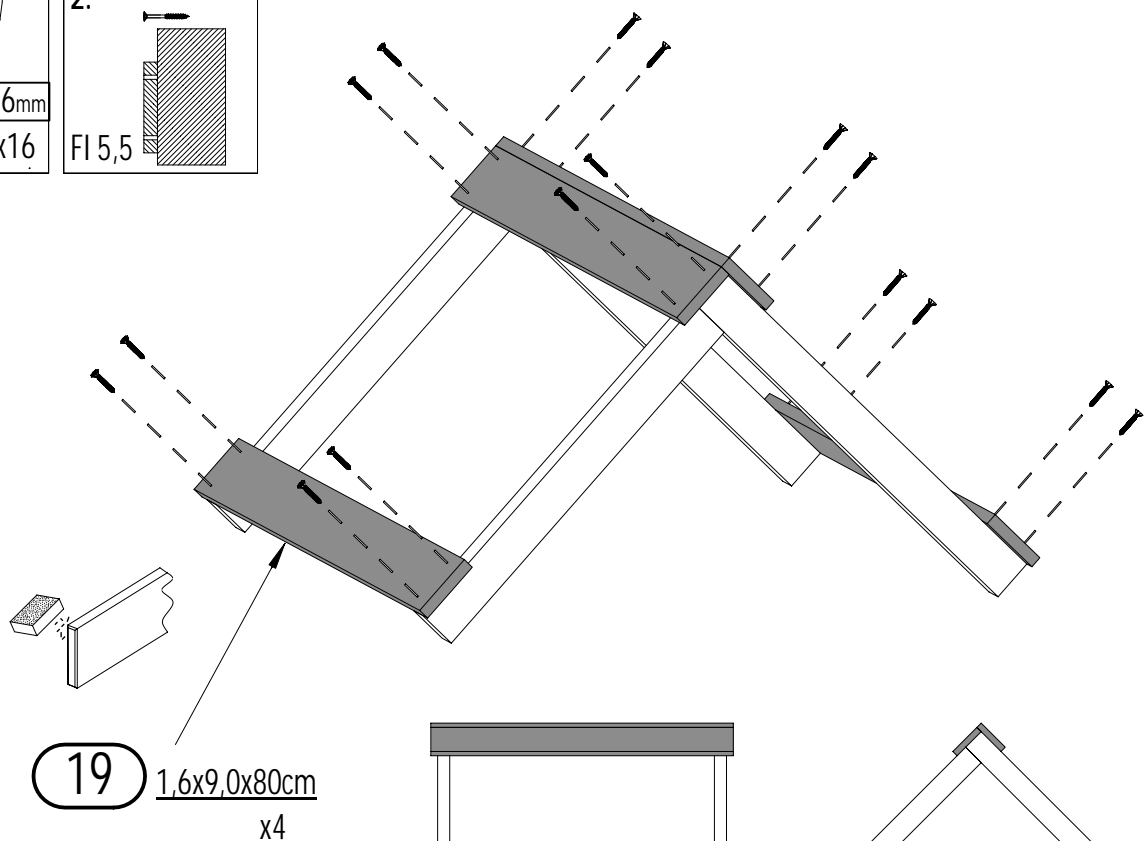
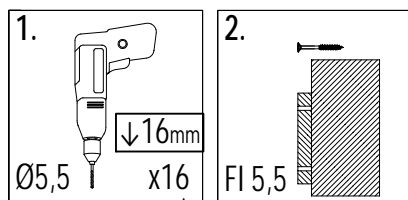

P28 x8



W20 x8

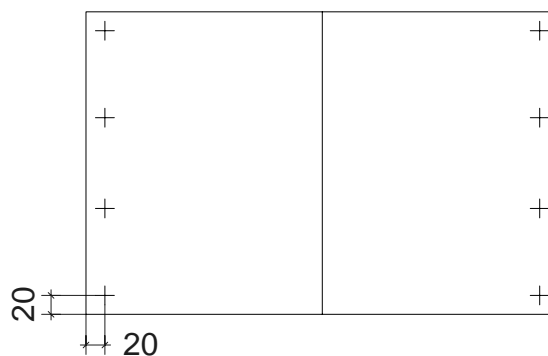

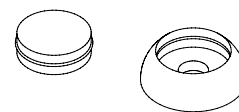
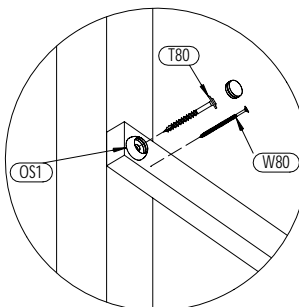
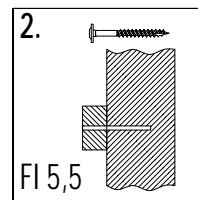
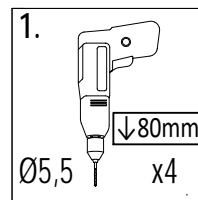
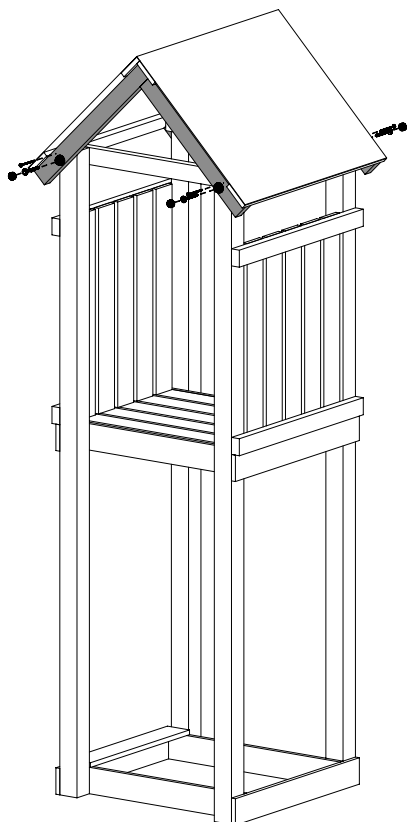

OS1 x4



W80 x4



T80 x4

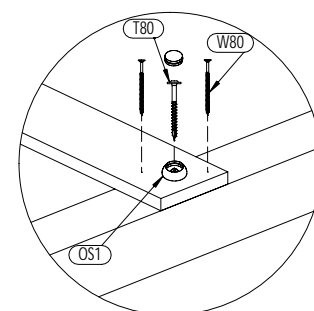
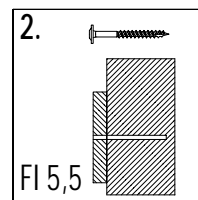
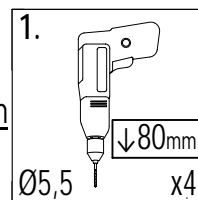
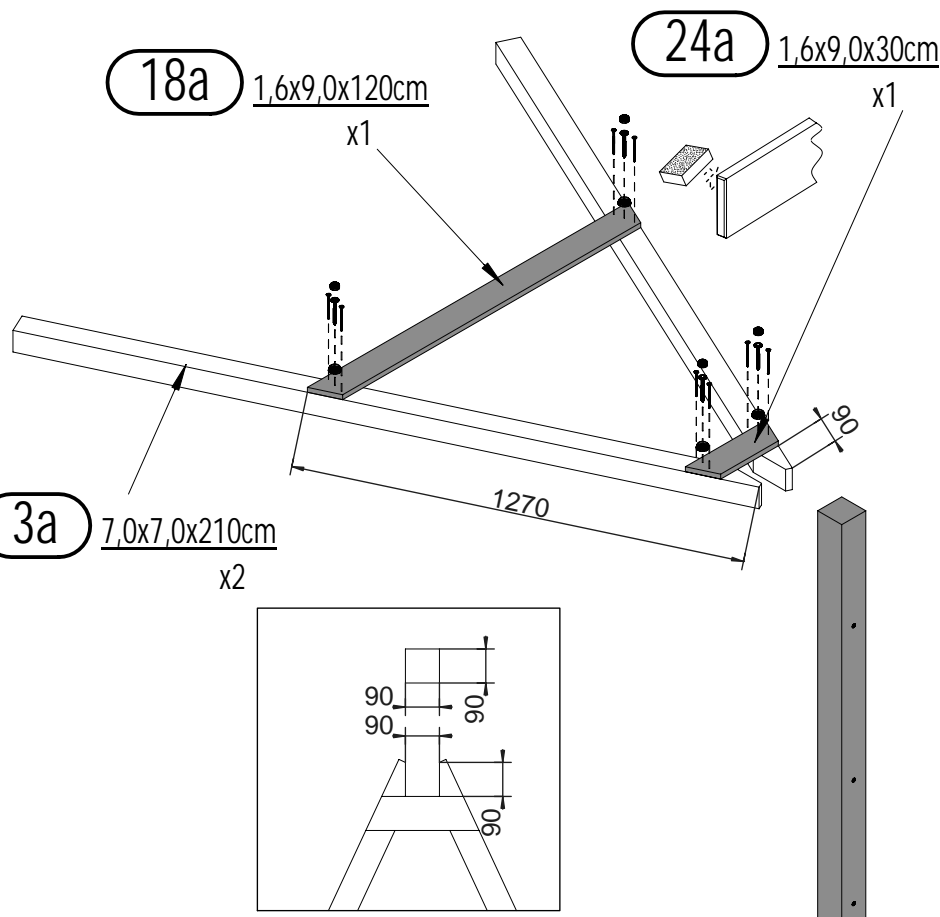

OS1 x4



W80 x8

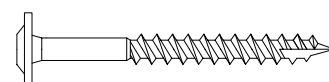

T80 x4

37

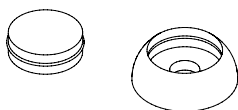
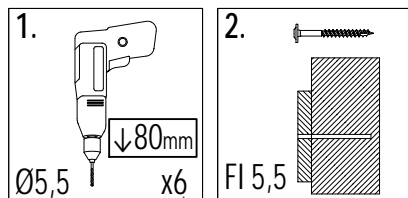

OS1 x2



P17 x4



W80 x8

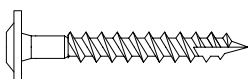

T60 x4

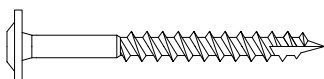

T80 x2

1a

9,0x9,0x210cm

x1

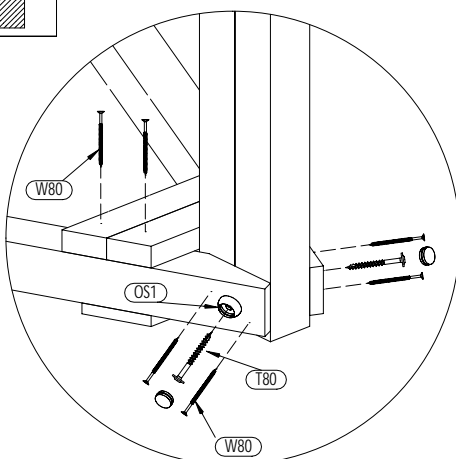

14a

3,2x5,8x32,4cm

x1

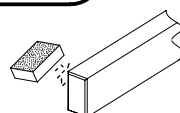

15a

3,2x5,8x27cm

x1

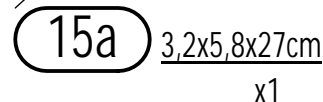

38

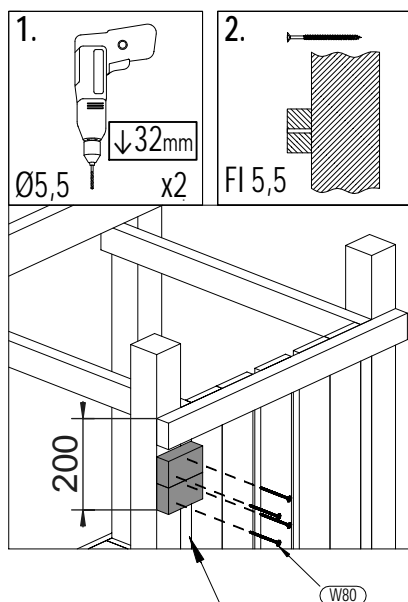

P17 x4



W80 x4

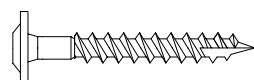

T60 x4

17

3,2x5,8x10cm

x2

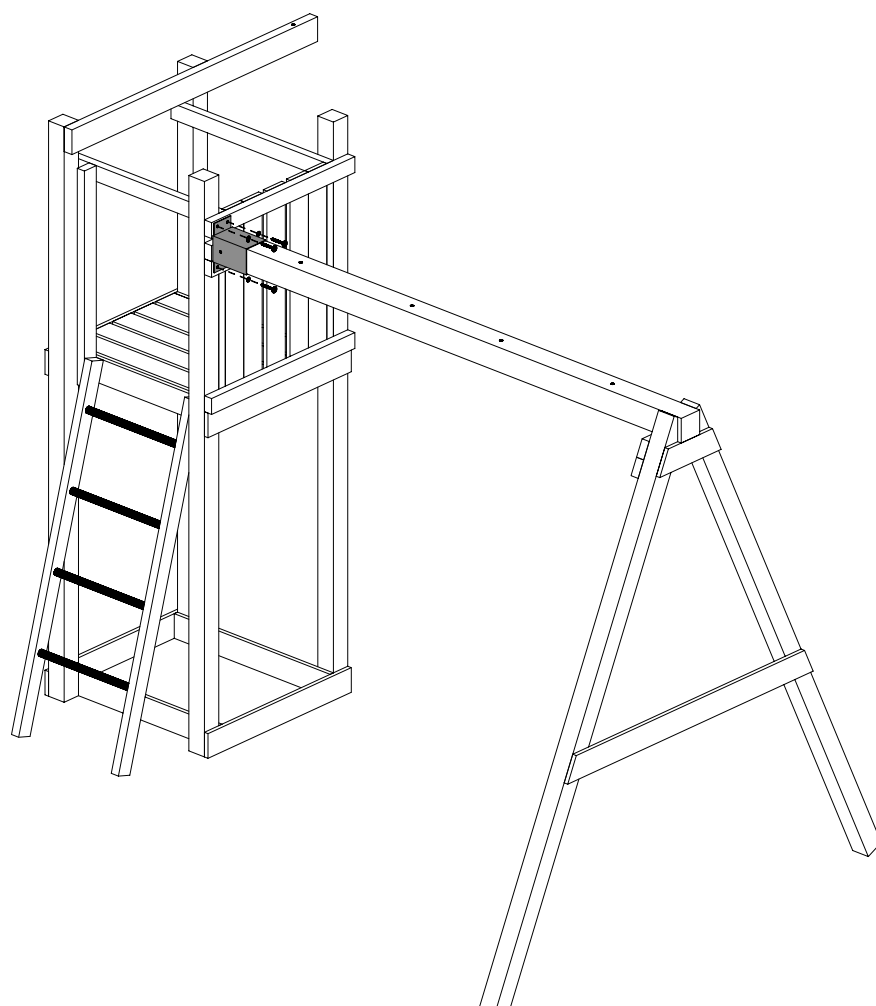

24

Zgodnie z normą PN-EN 71 stosuj zalecenia producenta odnośnie odległości oraz metody mocowania poszczególnych elementów
In compliance with the standard PN-EN 71, apply guidelines of the producer in relation to distances and methods of fastening individual elements

Maxi Funny Spacelonger

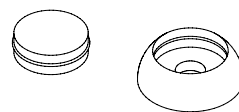
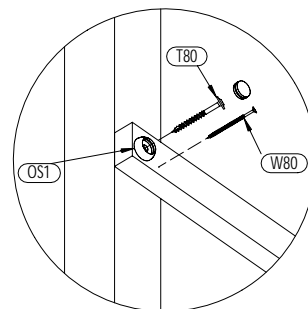
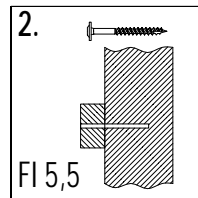
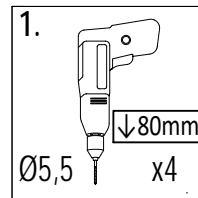
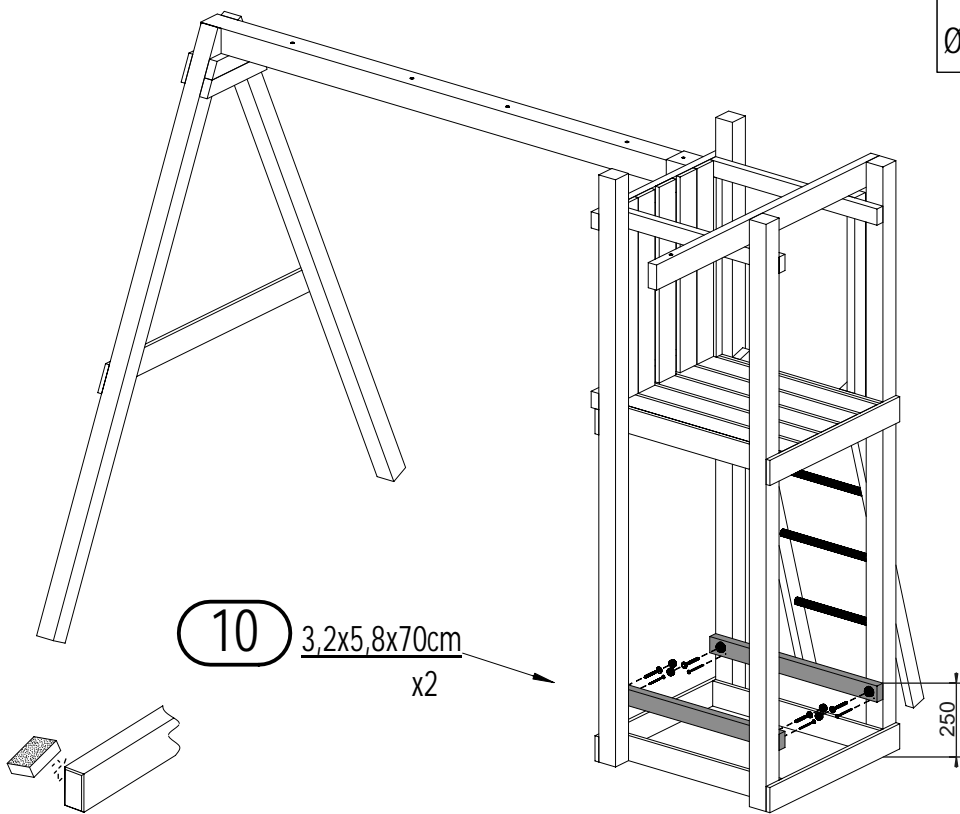

OS1 x4

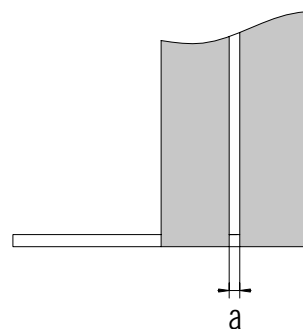
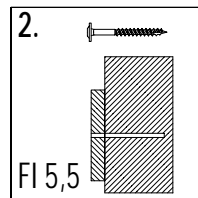
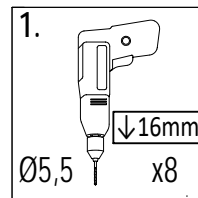
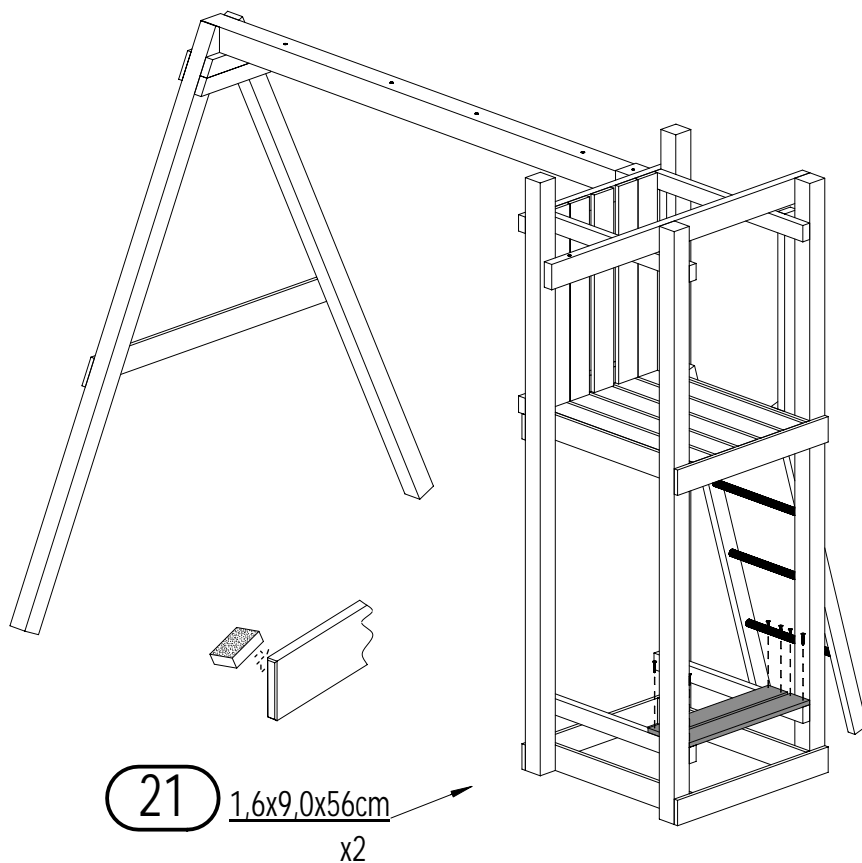

!!!min 13mm < a < !!!max 23mm

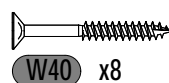

41

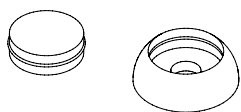
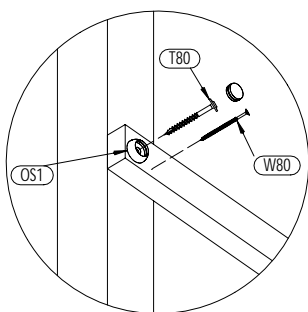
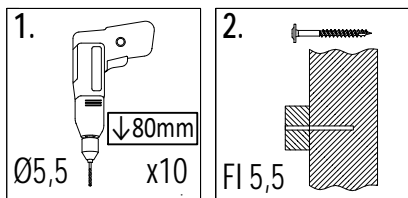

OS1 x4



W80 x4

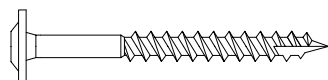

T80 x4

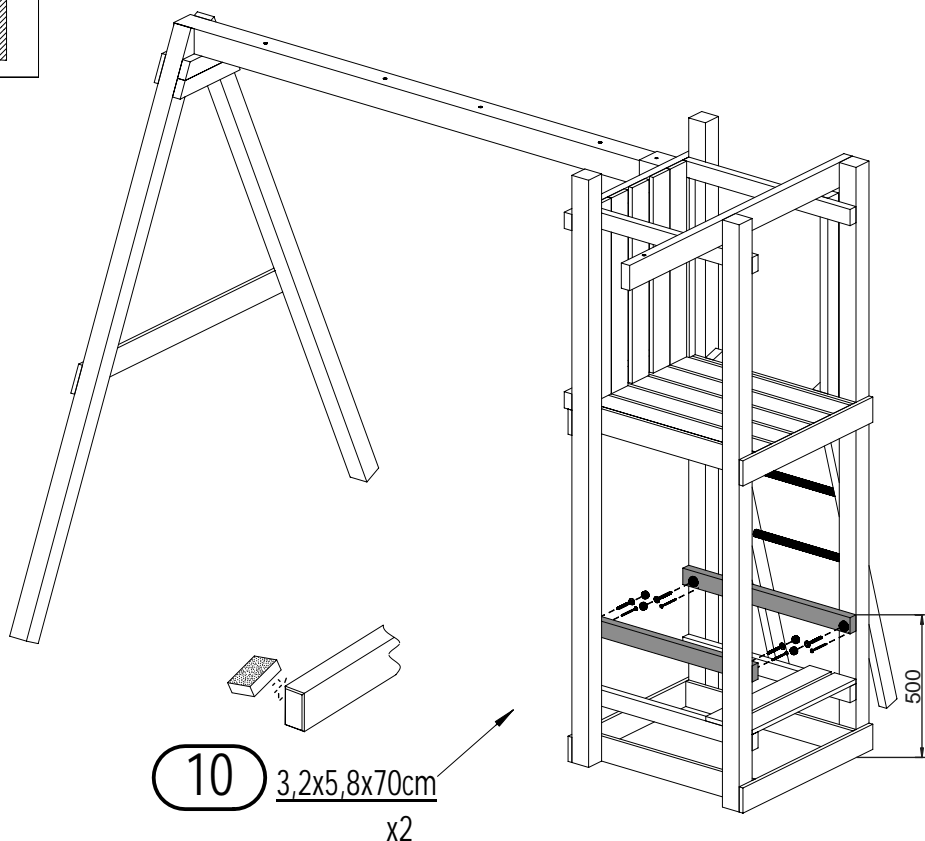

42

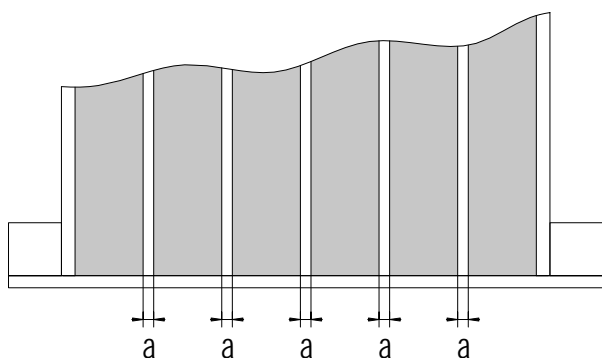
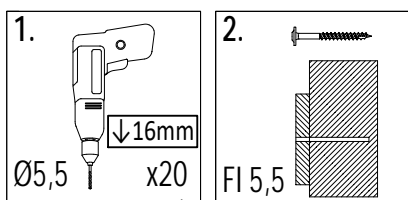

!!!min 13mm < a < !!!max 23mm

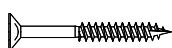
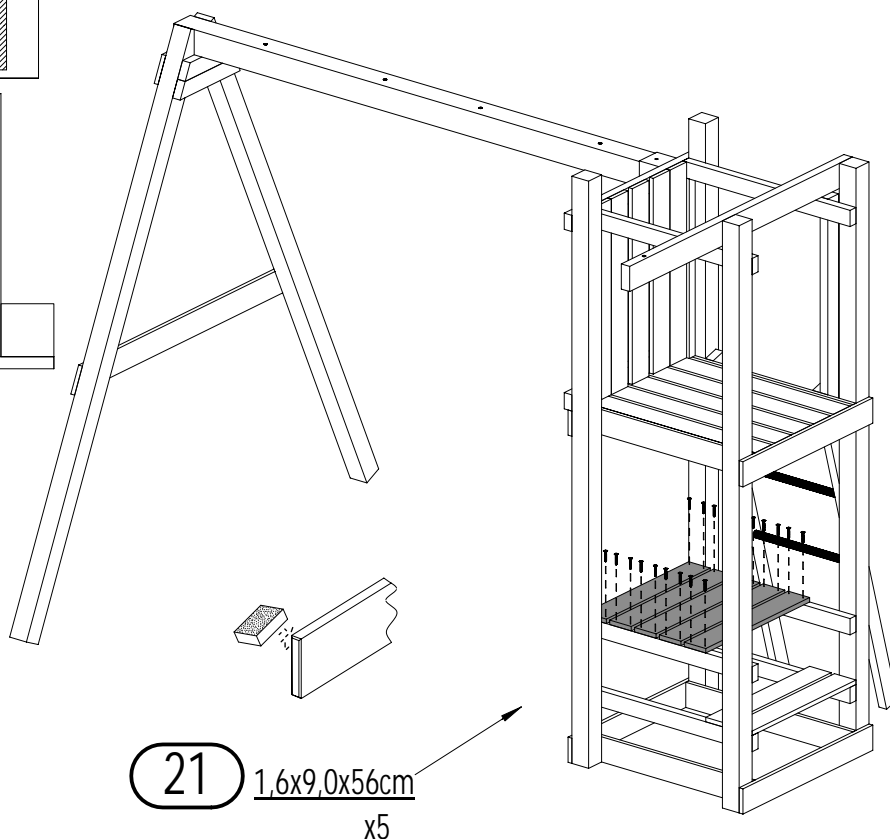

W40 x20

26

Zgodnie z normą PN-EN 71 stosuj zalecenia producenta odnośnie odległości oraz metody mocowania poszczególnych elementów
In compliance with the standard PN-EN 71, apply guidelines of the producer in relation to distances and methods of fastening individual elements

Maxi Funny Spacelonger

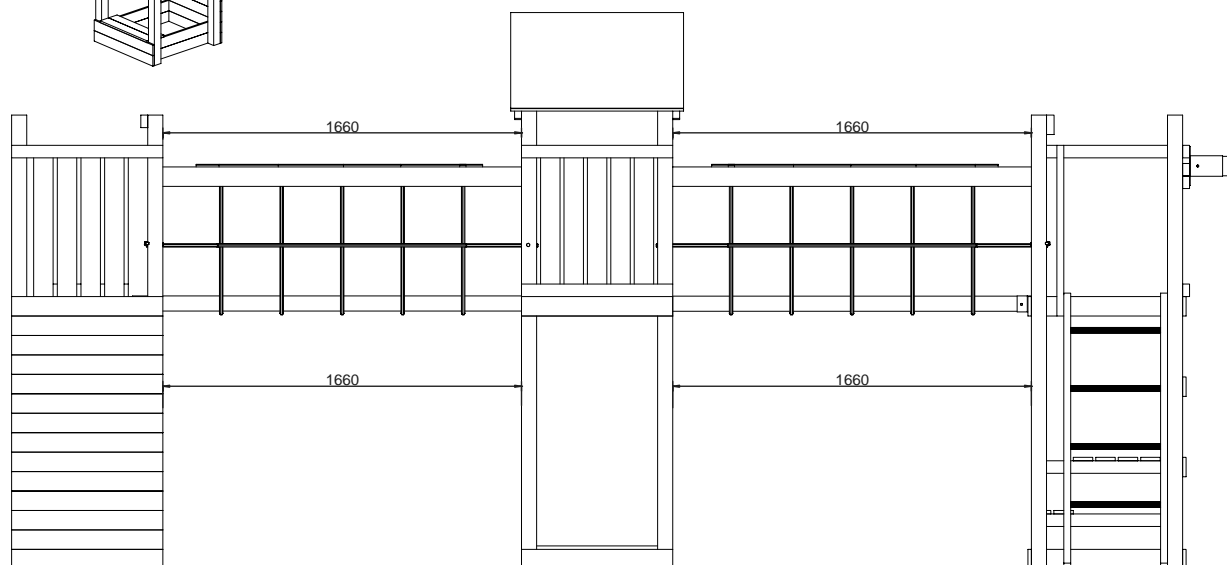
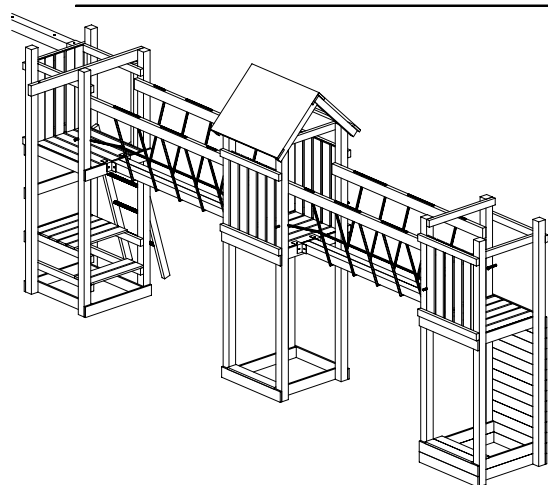
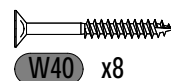
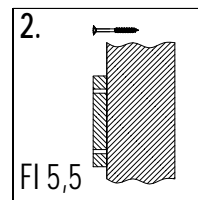
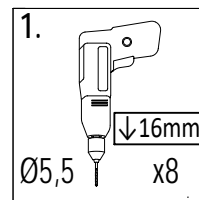
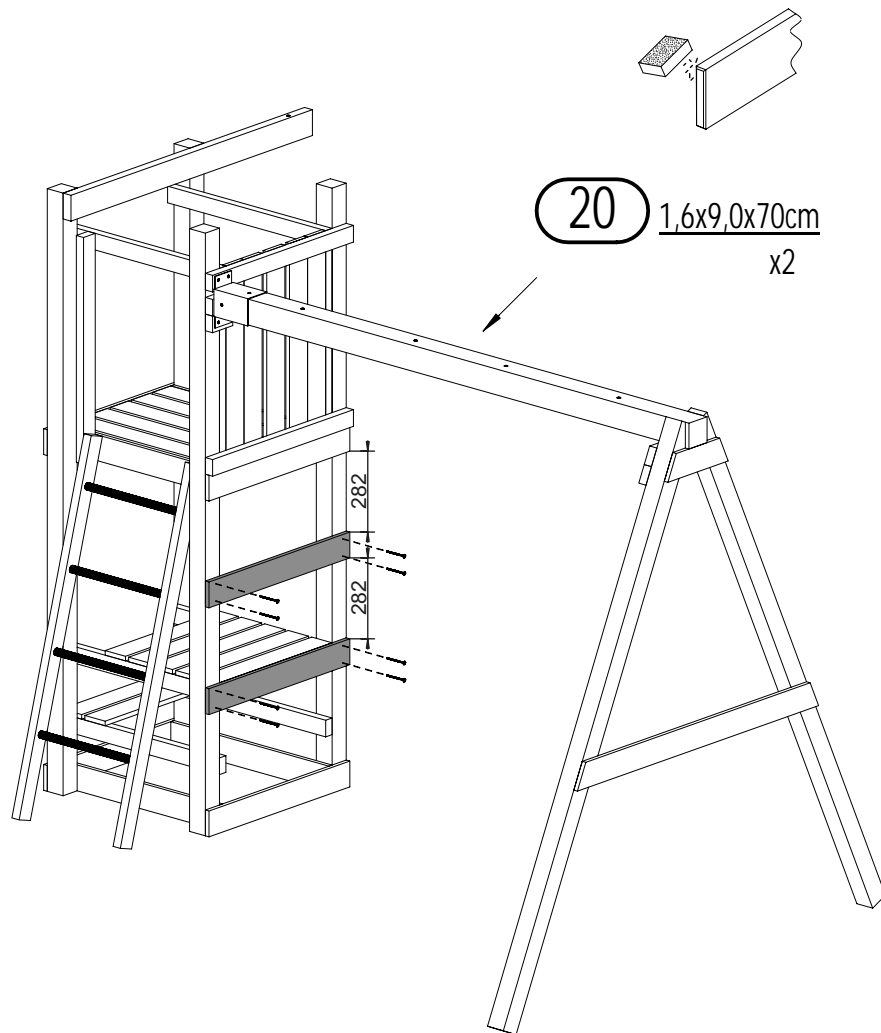

45

240

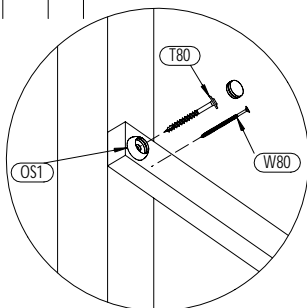

OS1 x8

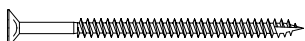

W80 x8

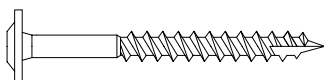

T80 x8

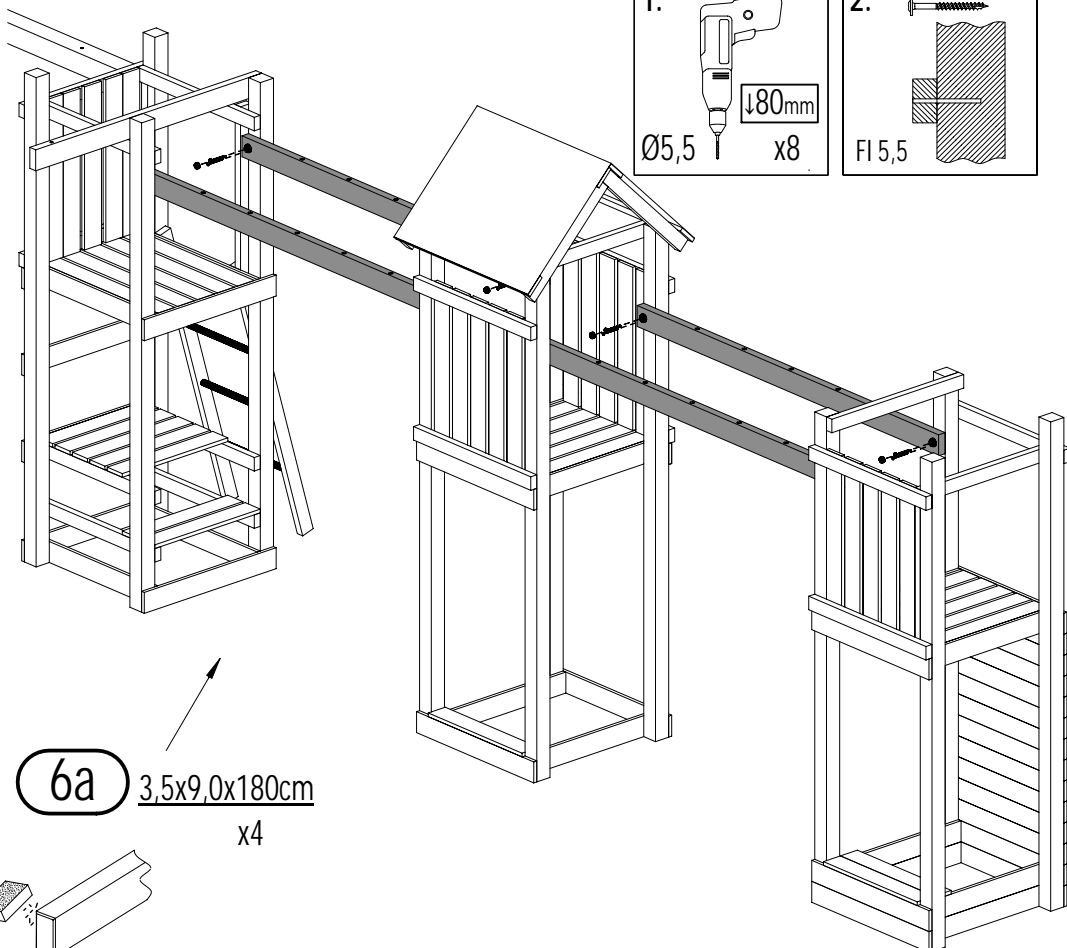

6a 3,5x9,0x180cm
x4

46

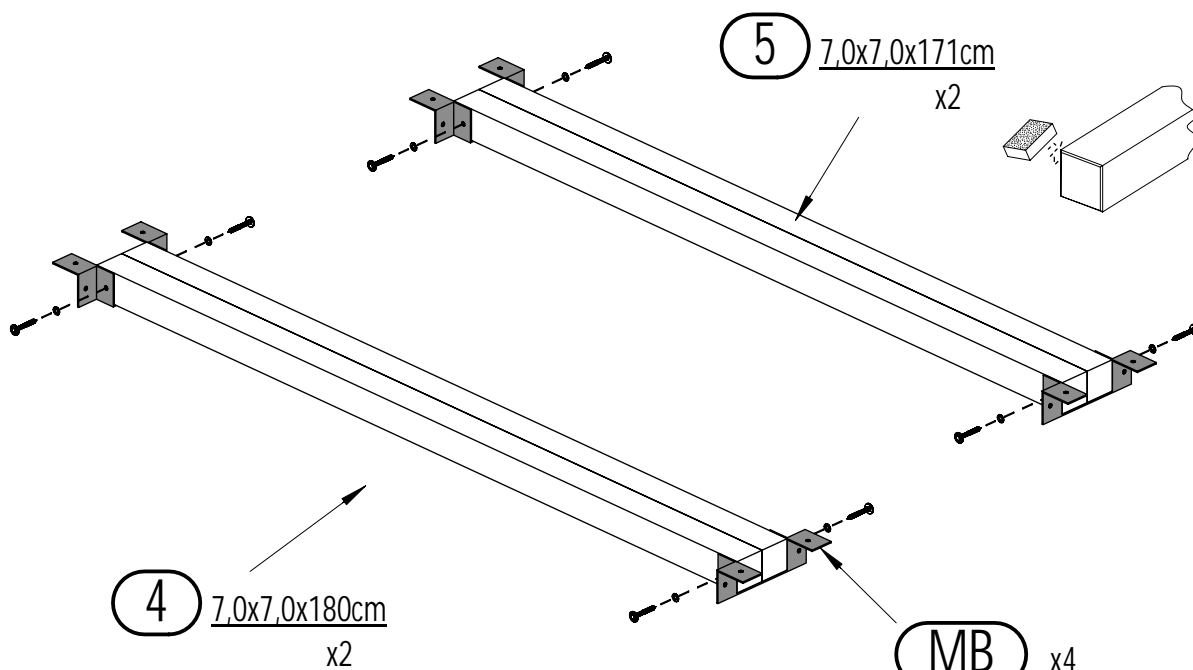

P17 x8

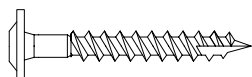

T60 x8

28

Zgodne z normą PN-EN 71 stosuj zalecenia producenta odnośnie odległości oraz metody mocowania poszczególnych elementów
In compliance with the standard PN-EN 71, apply guidelines of the producer in relation to distances and methods of fastening individual elements

Maxi Funny Spacelonger

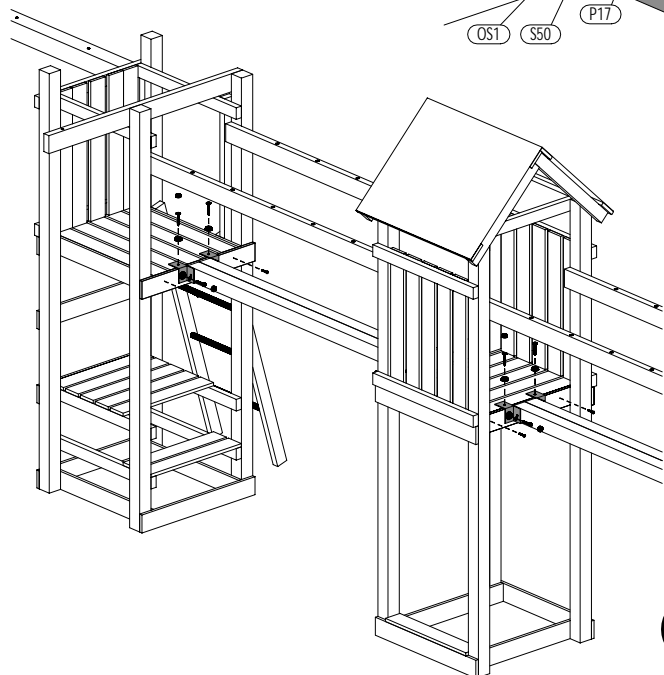
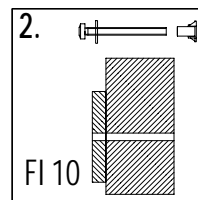
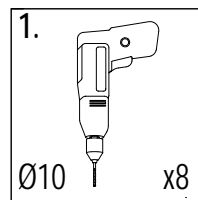
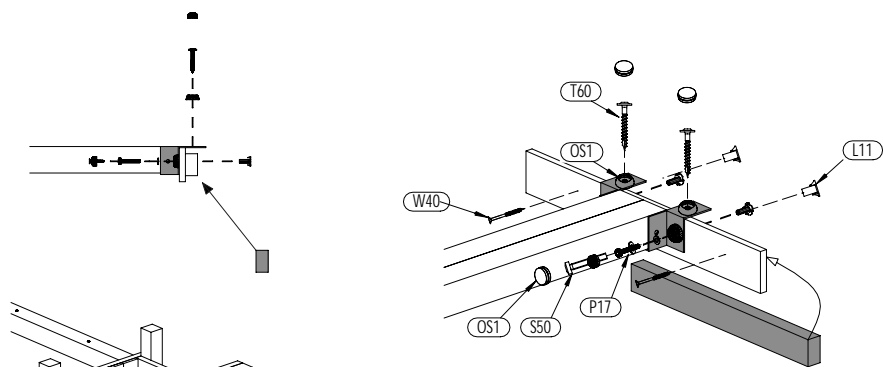

13 3,2x5,8x52,8cm x3

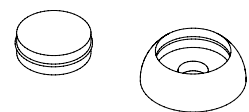

OS1 x16



W40 x6

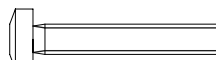

S50 x8



P17 x8



L11 x8

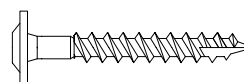

T60 x8

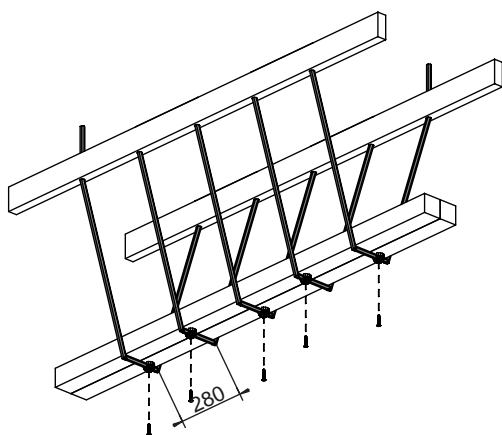

LI 11m x1

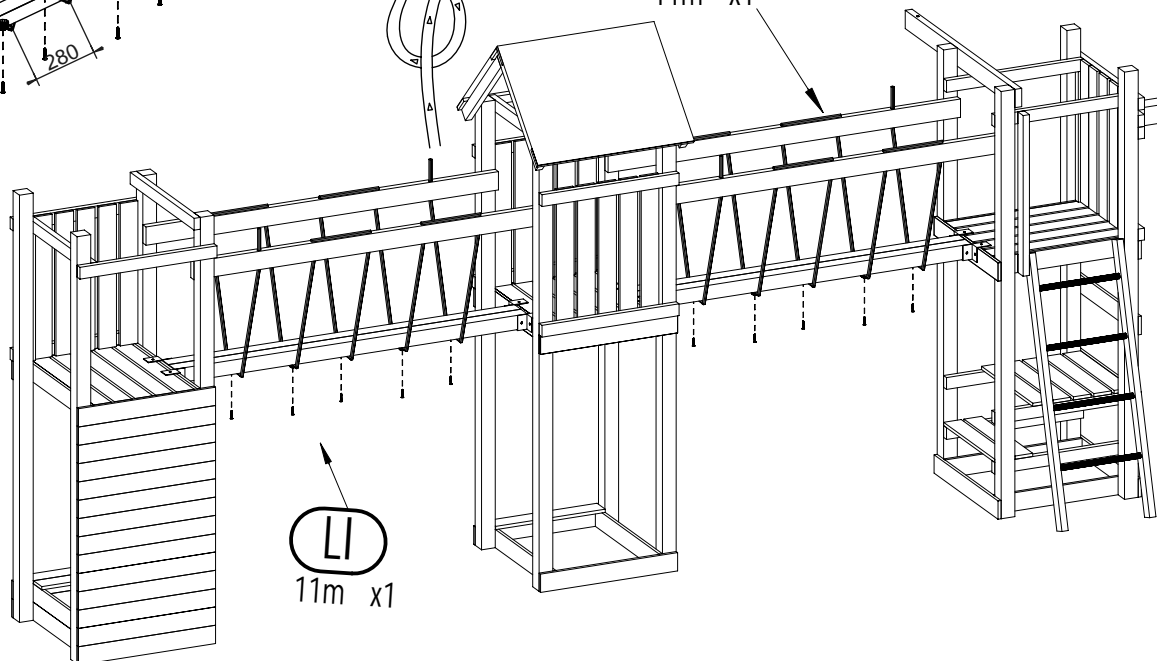

LI 11m x1

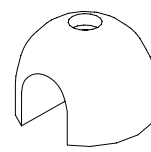

KS 04789 x10

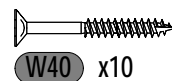

W40 x10

Zgodne z normą PN-EN 71 stosuj zalecenia producenta odnośnie odległości oraz metody mocowania poszczególnych elementów

In compliance with the standard PN-EN 71, apply guidelines of the producer in relation to distances and methods of fastening individual elements

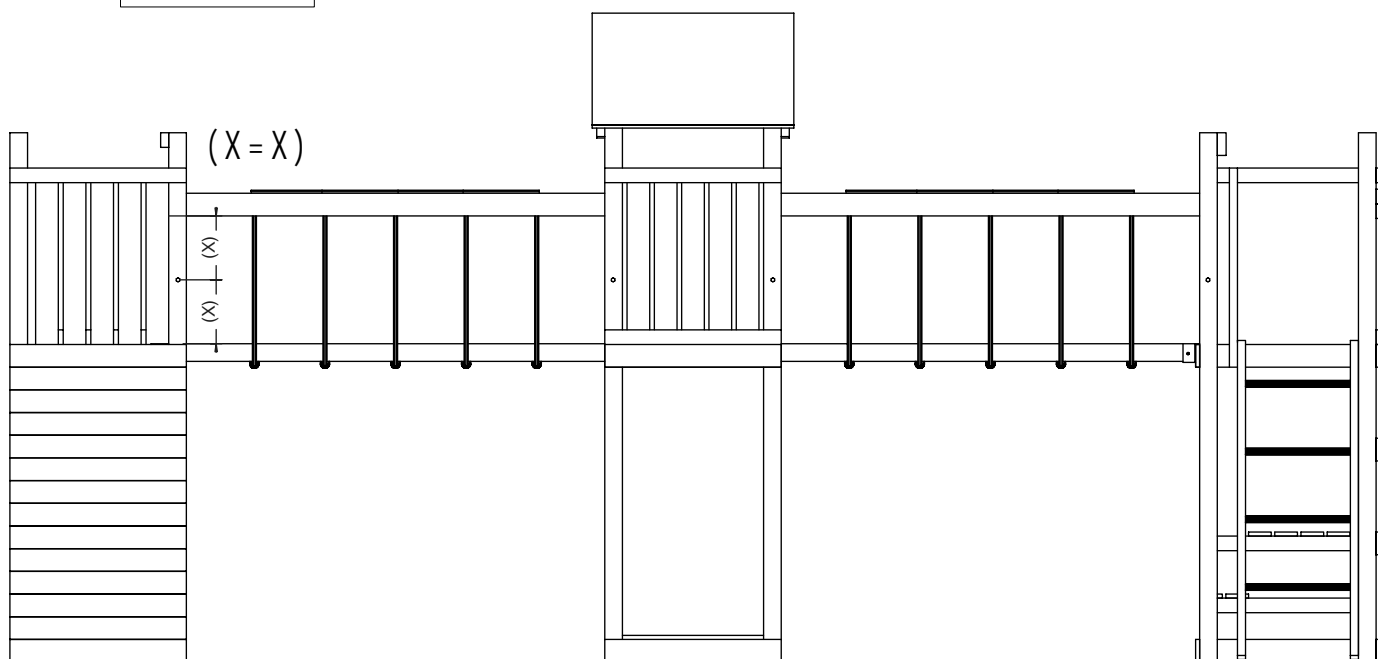
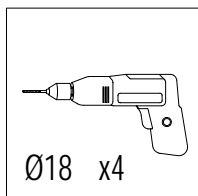

LI
3m x4

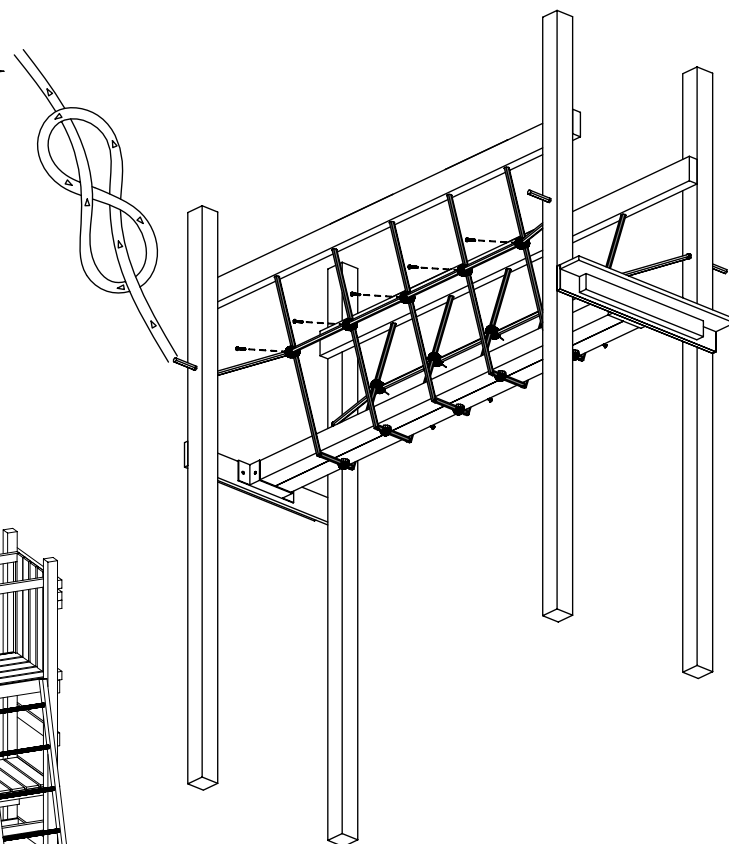
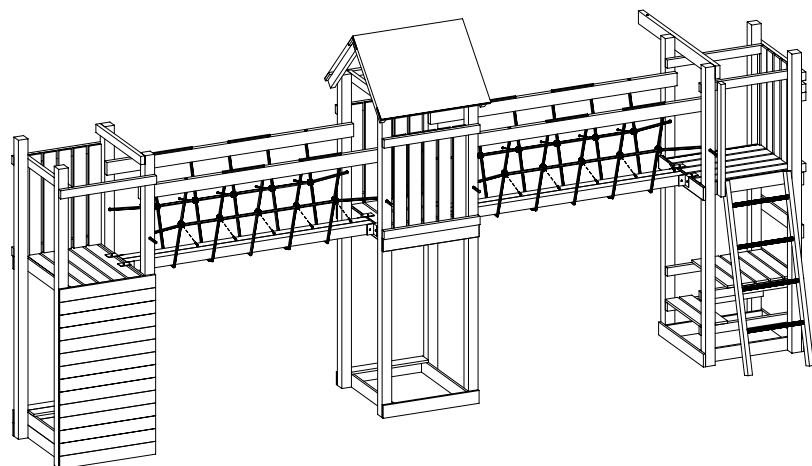
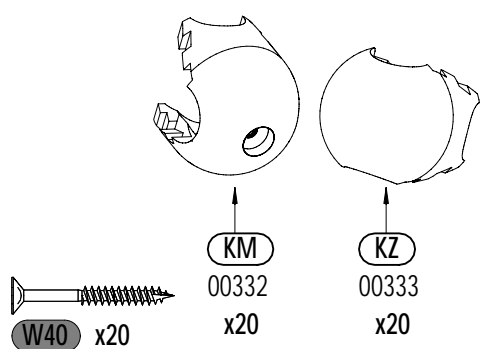

20 1,6x9,0x70cm

x10

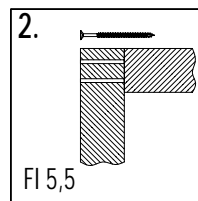
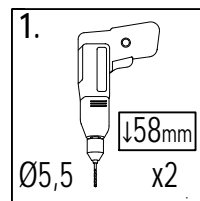
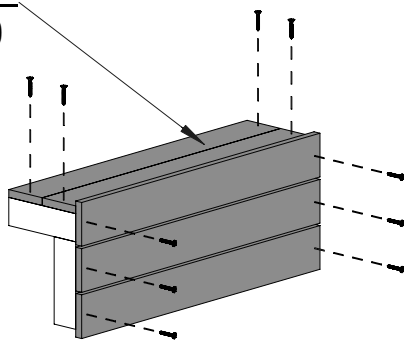
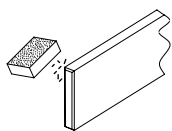

51

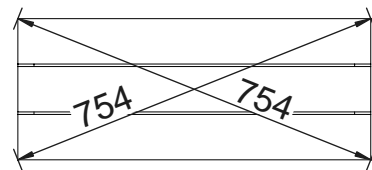
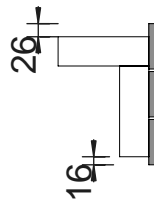

!! x4

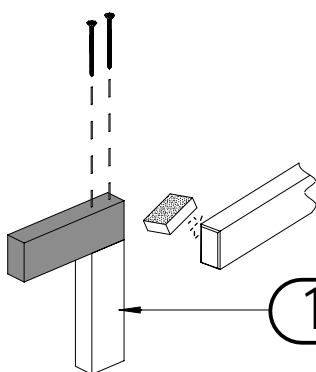

16

3,2x5,8x18cm

x2

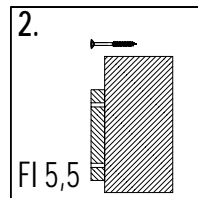
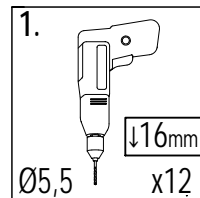
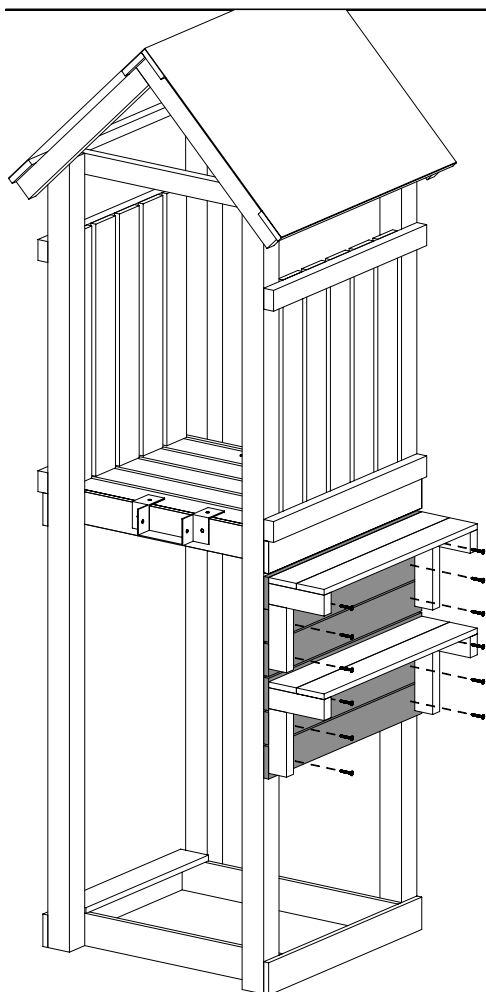
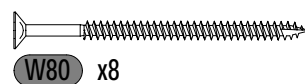
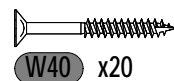
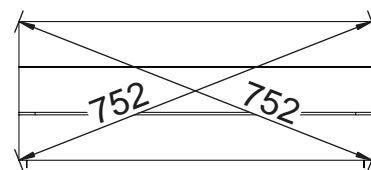
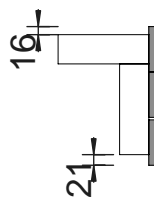
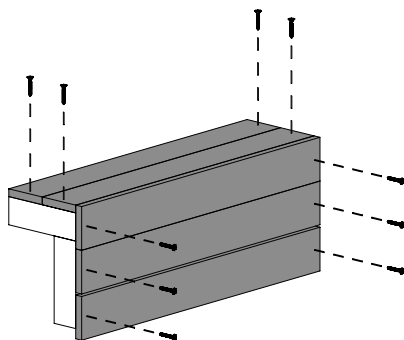

52

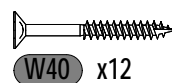
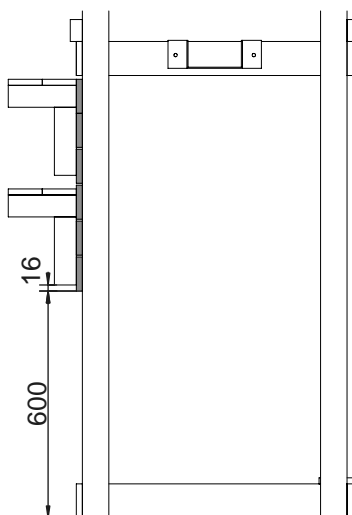

31

53

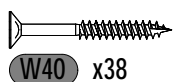
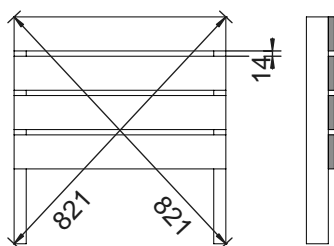
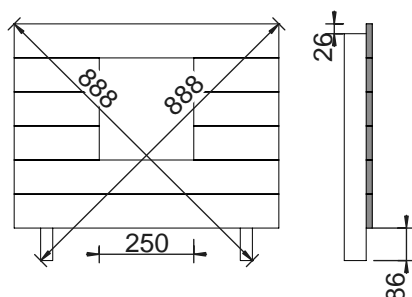
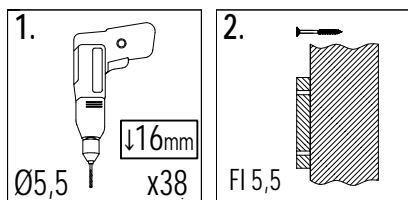

24 1,6x9,0x22,5cm
x6

20 1,6x9,0x70cm
x3

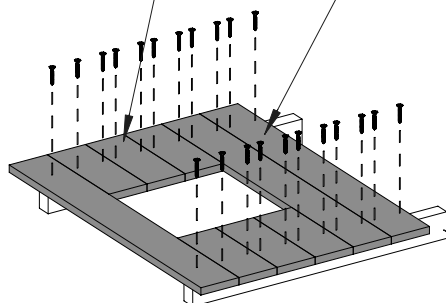

11 3,2x5,8x60cm
x2

21 1,6x9,0x56cm
x4

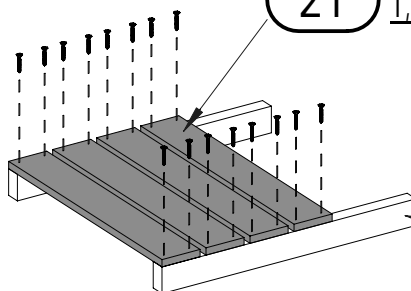

11 3,2x5,8x60cm
x2

54

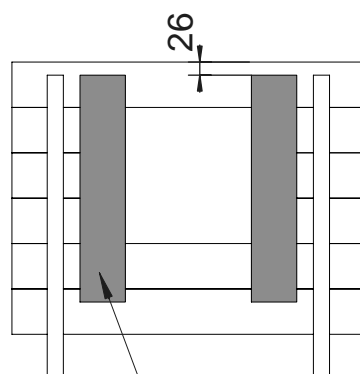
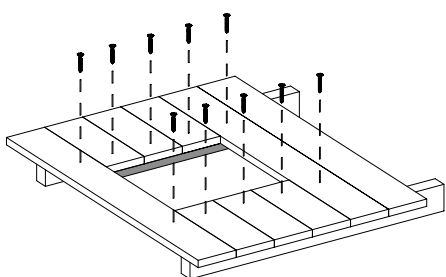
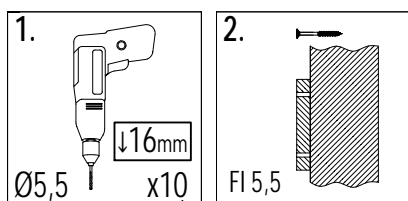

22 1,6x9,0x45cm
x2

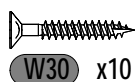
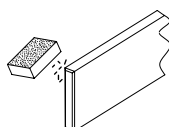

32

Zgodnie z normą PN-EN 71 stosuj zalecenia producenta odnośnie odległości oraz metody mocowania poszczególnych elementów
In compliance with the standard PN-EN 71, apply guidelines of the producer in relation to distances and methods of fastening individual elements

Maxi Funny Spacelonger

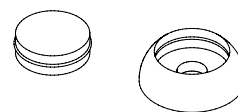
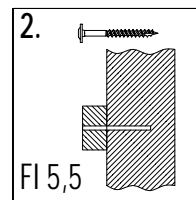
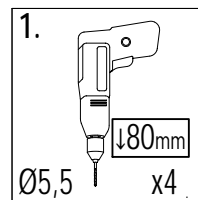
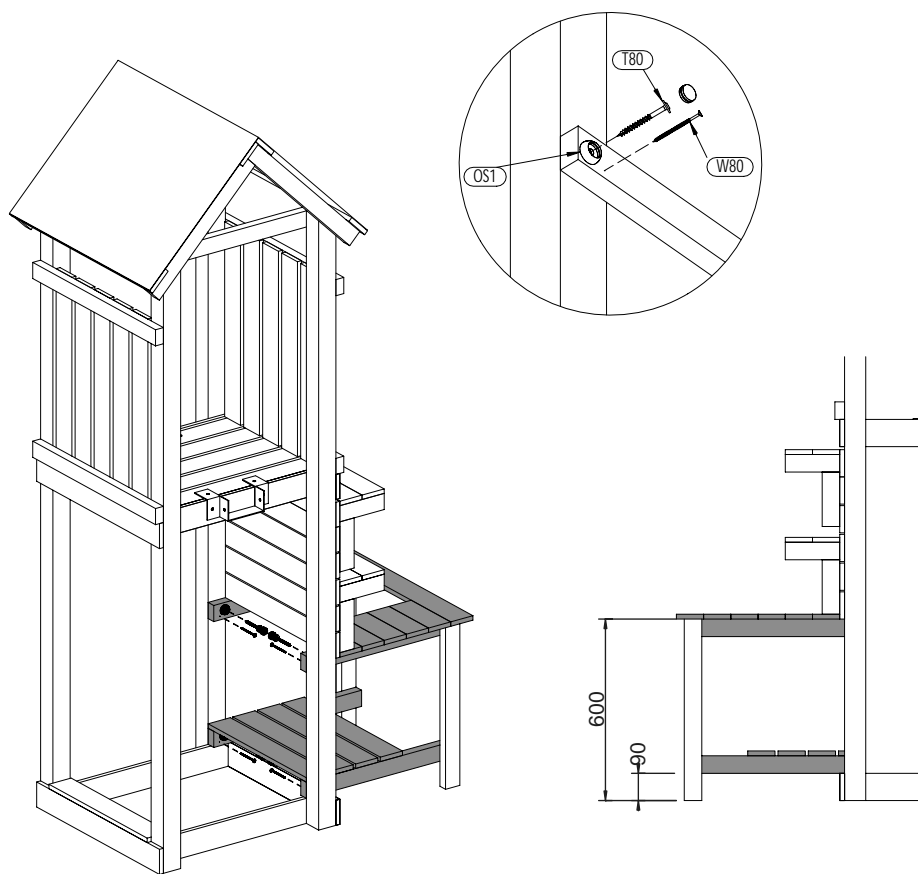

OS1 x4

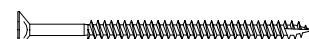

W80 x4



T80 x4

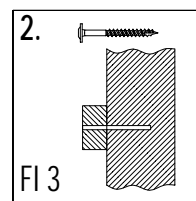
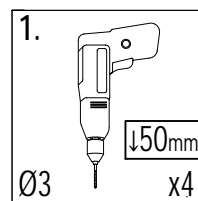
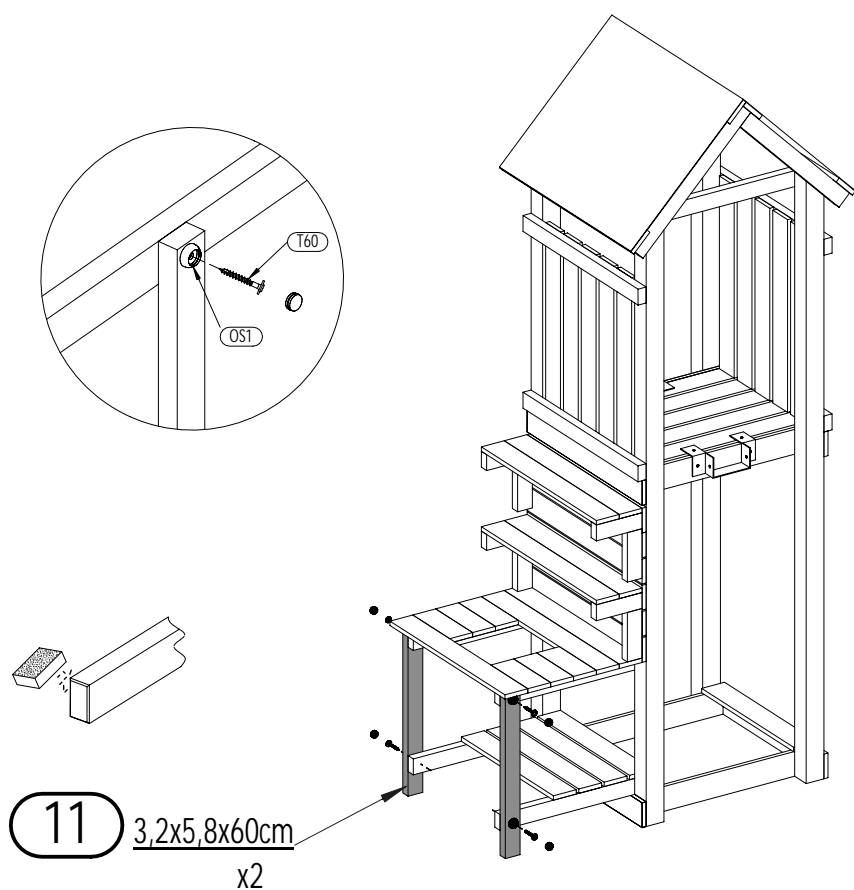

OS1 x4

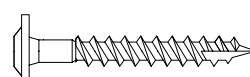

T60 x4

57

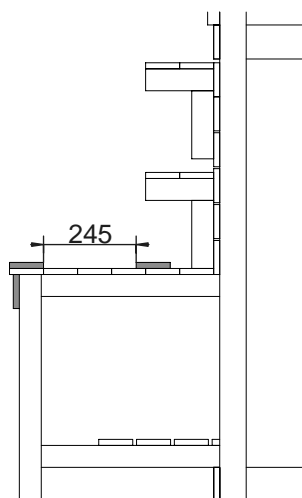
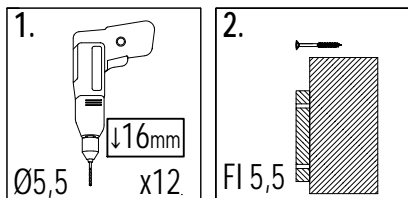

20 1,6x9,0x70cm
x3

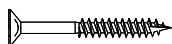
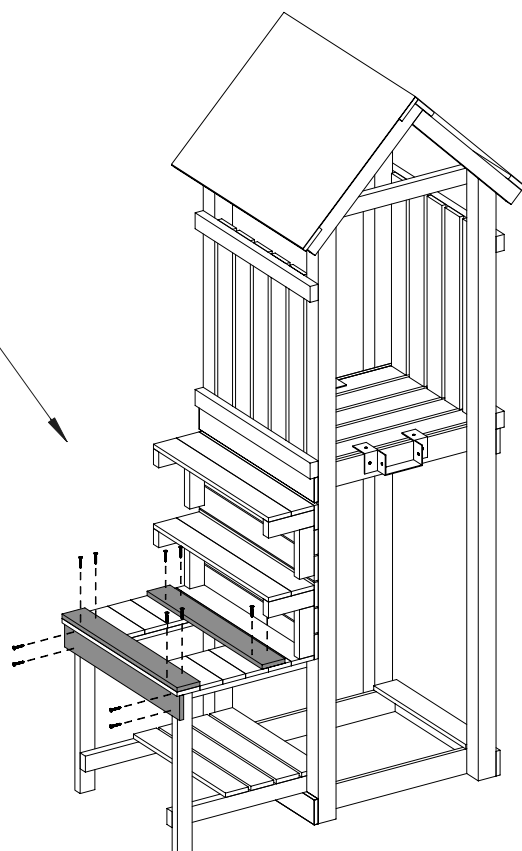
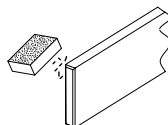

W40 x12

58

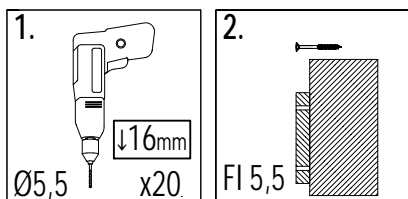

20 1,6x9,0x70cm
x4

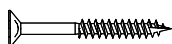
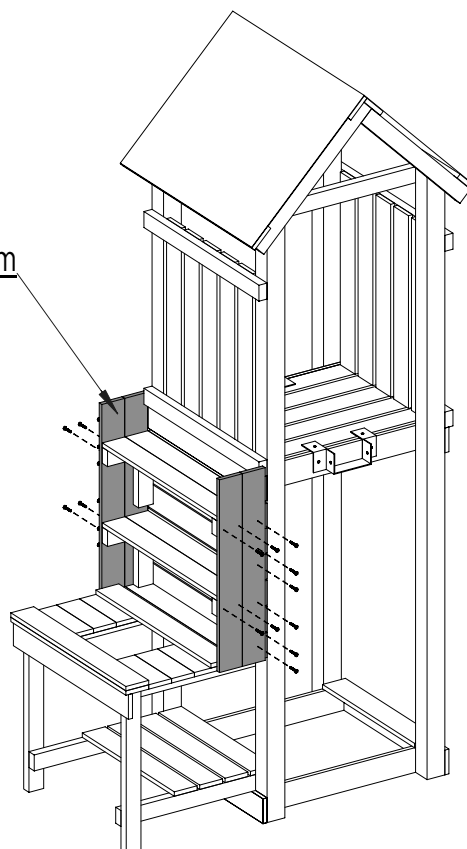
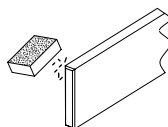

W40 x20

34

Zgodnie z normą PN-EN 71 stosuj zalecenia producenta odnośnie odległości oraz metody mocowania poszczególnych elementów
In compliance with the standard PN-EN 71, apply guidelines of the producer in relation to distances and methods of fastening individual elements

Maxi Funny Spacelonger

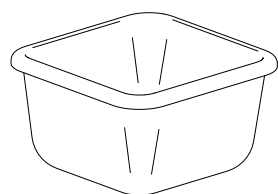

WL x1

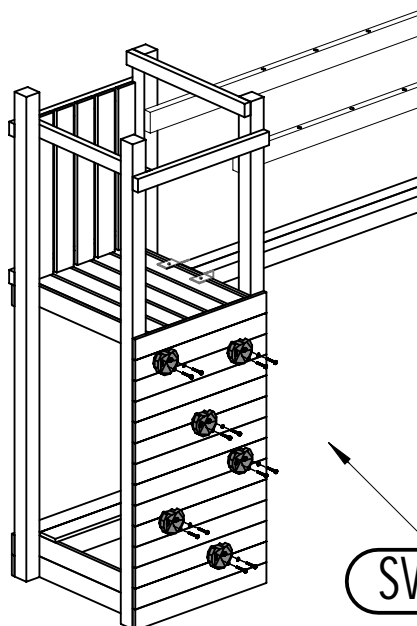
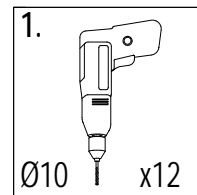
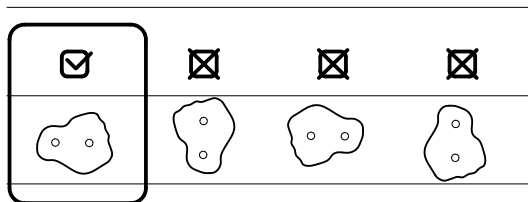
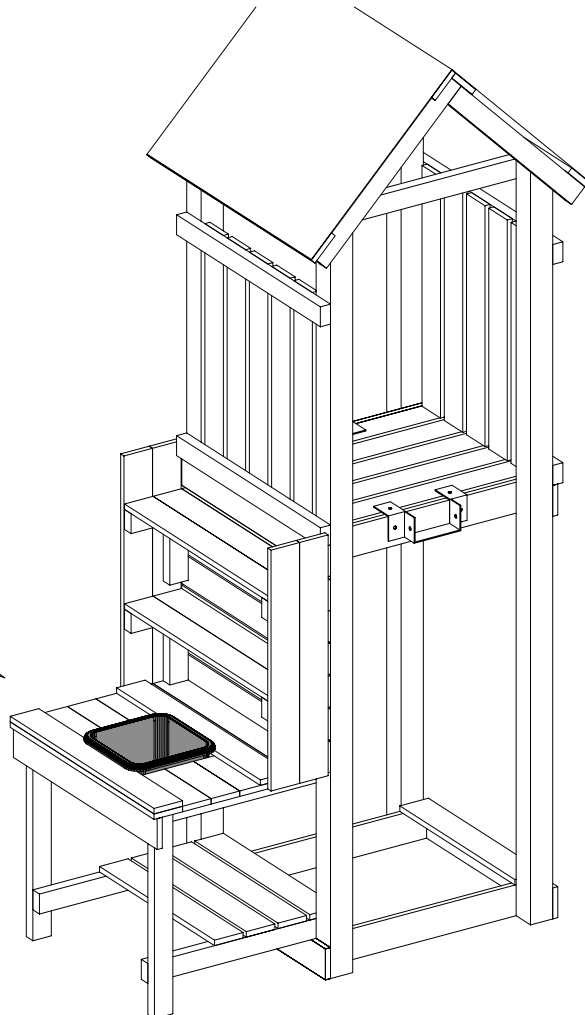

SW x6

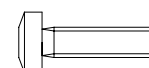
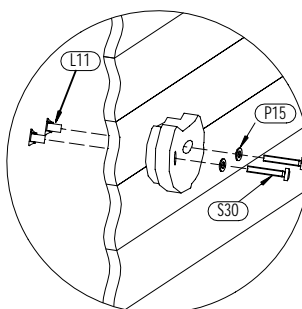

S30 x12

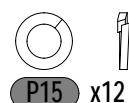

P15 x12



L11 x12

61

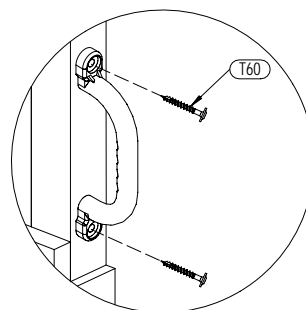
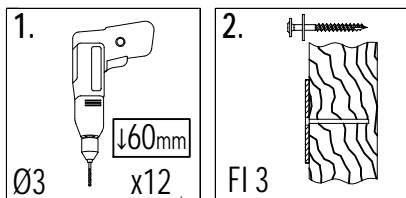

UC_x2

UC_x4

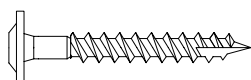

T60 x12

62

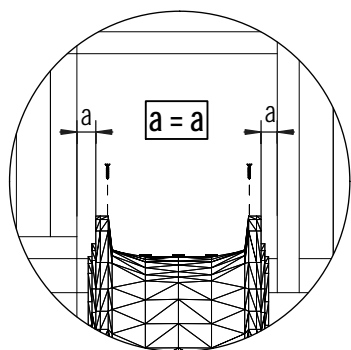

W30 x2

Z_x1

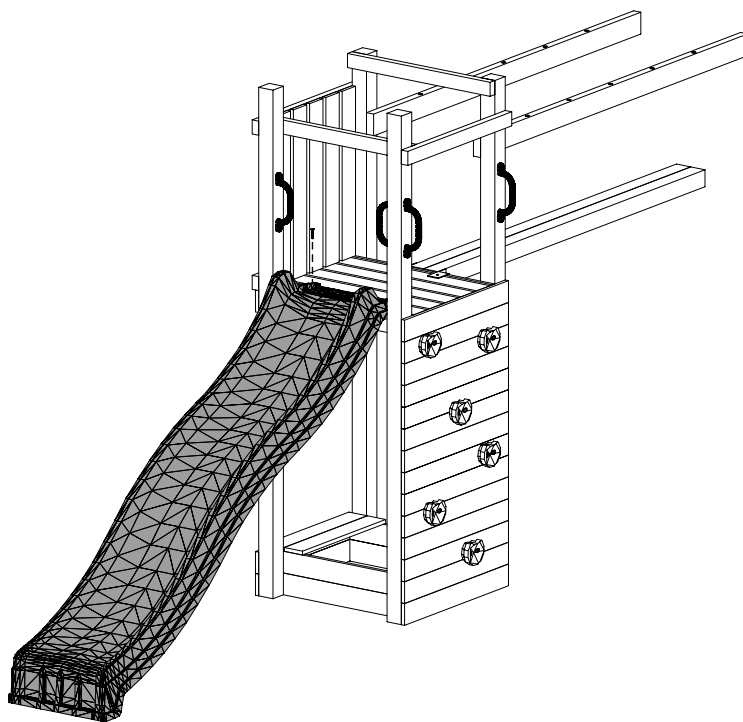

36

Zgodnie z normą PN-EN 71 stosuj zalecenia producenta odnośnie odległości oraz metody mocowania poszczególnych elementów
In compliance with the standard PN-EN 71, apply guidelines of the producer in relation to distances and methods of fastening individual elements

Maxi Funny Spacelonger

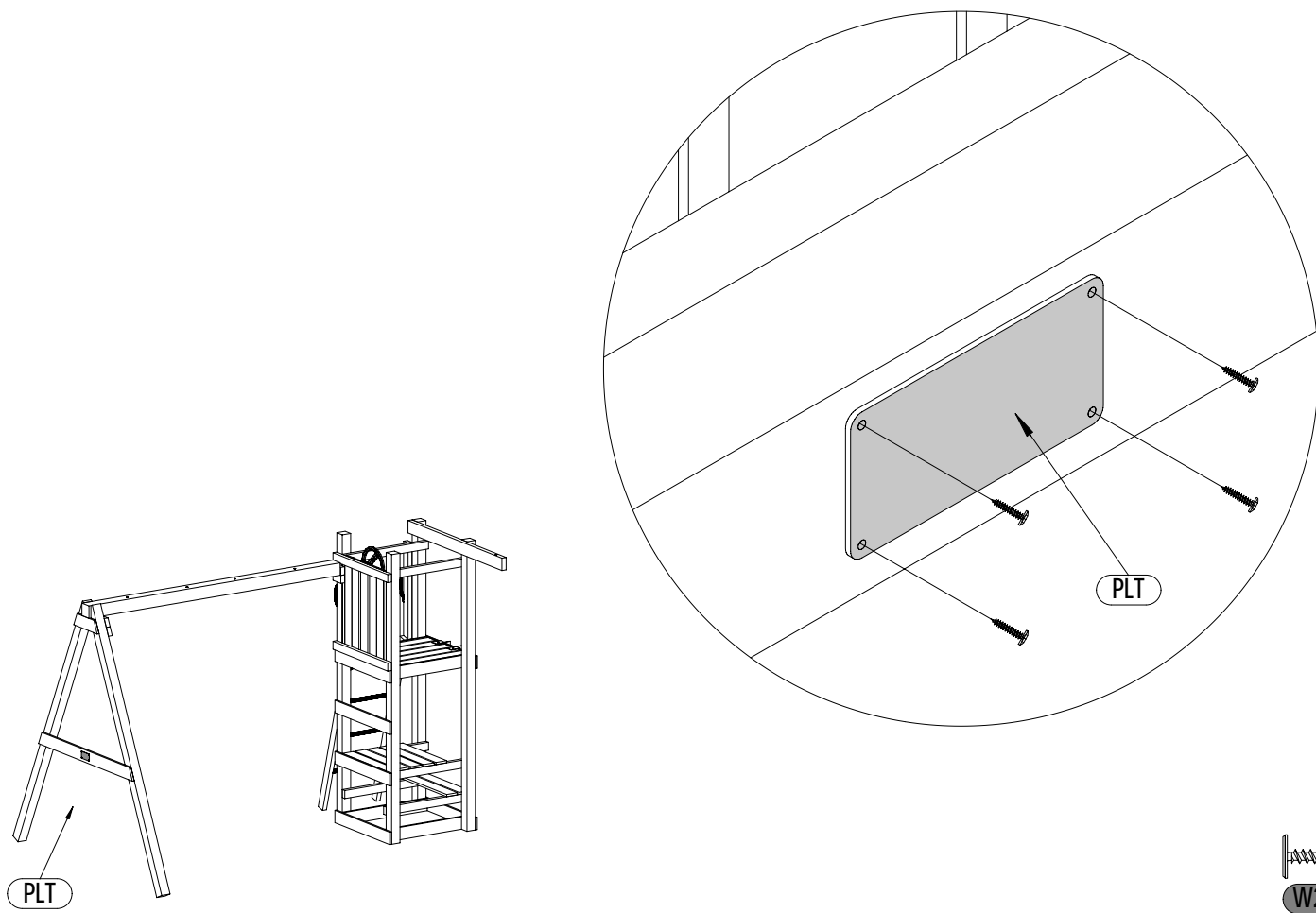
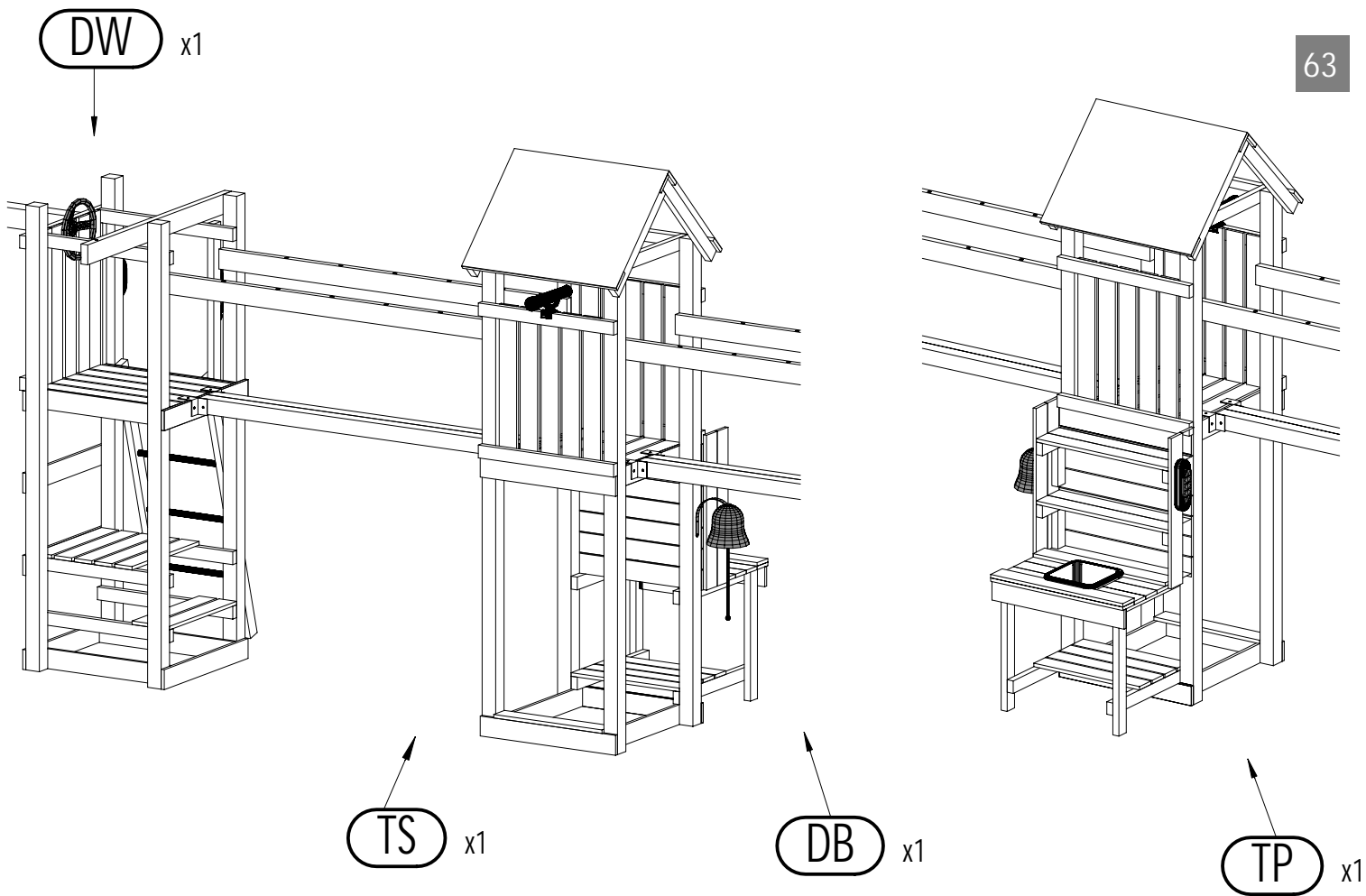

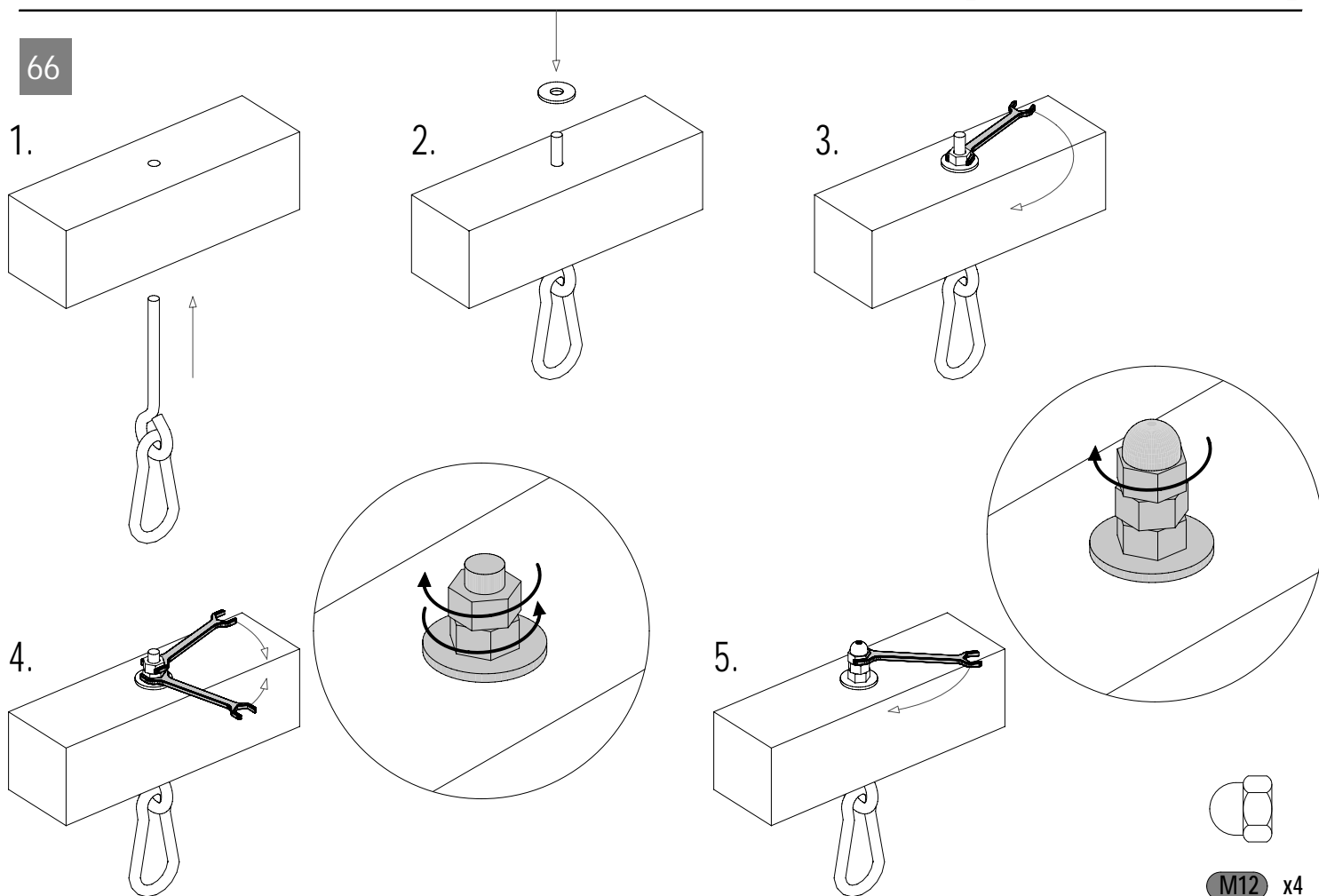
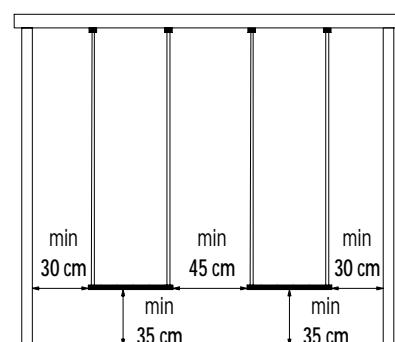
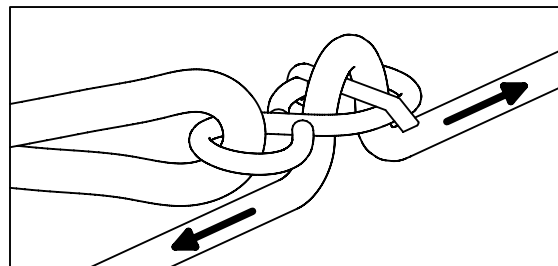
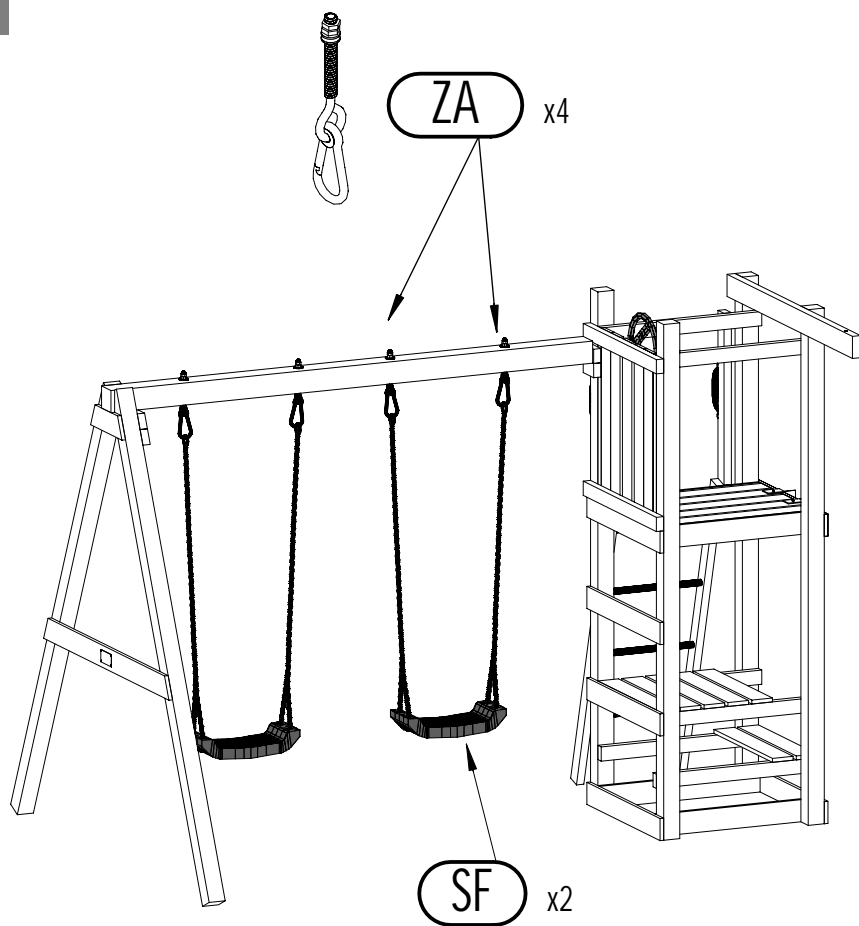

M12 x4

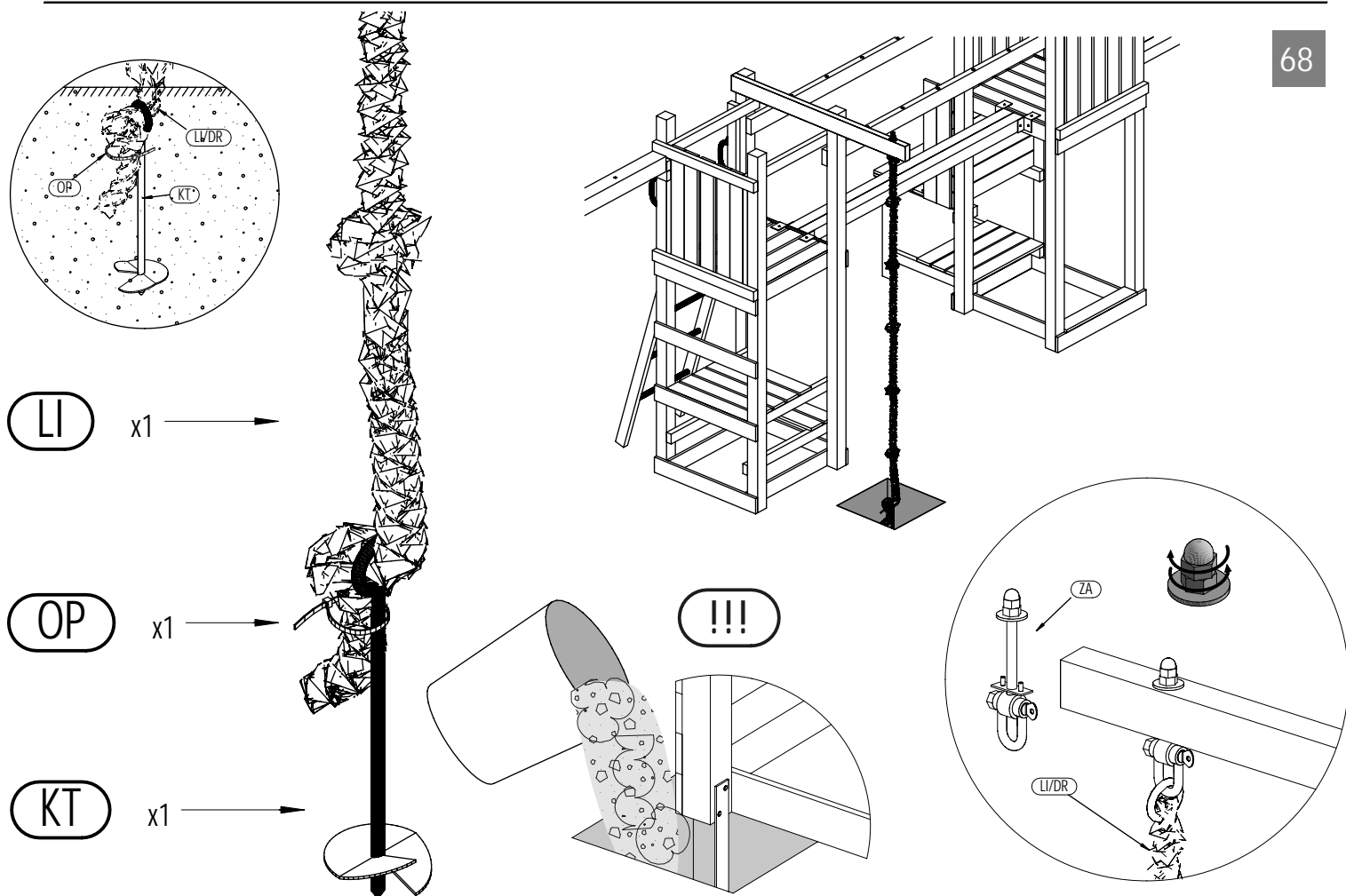
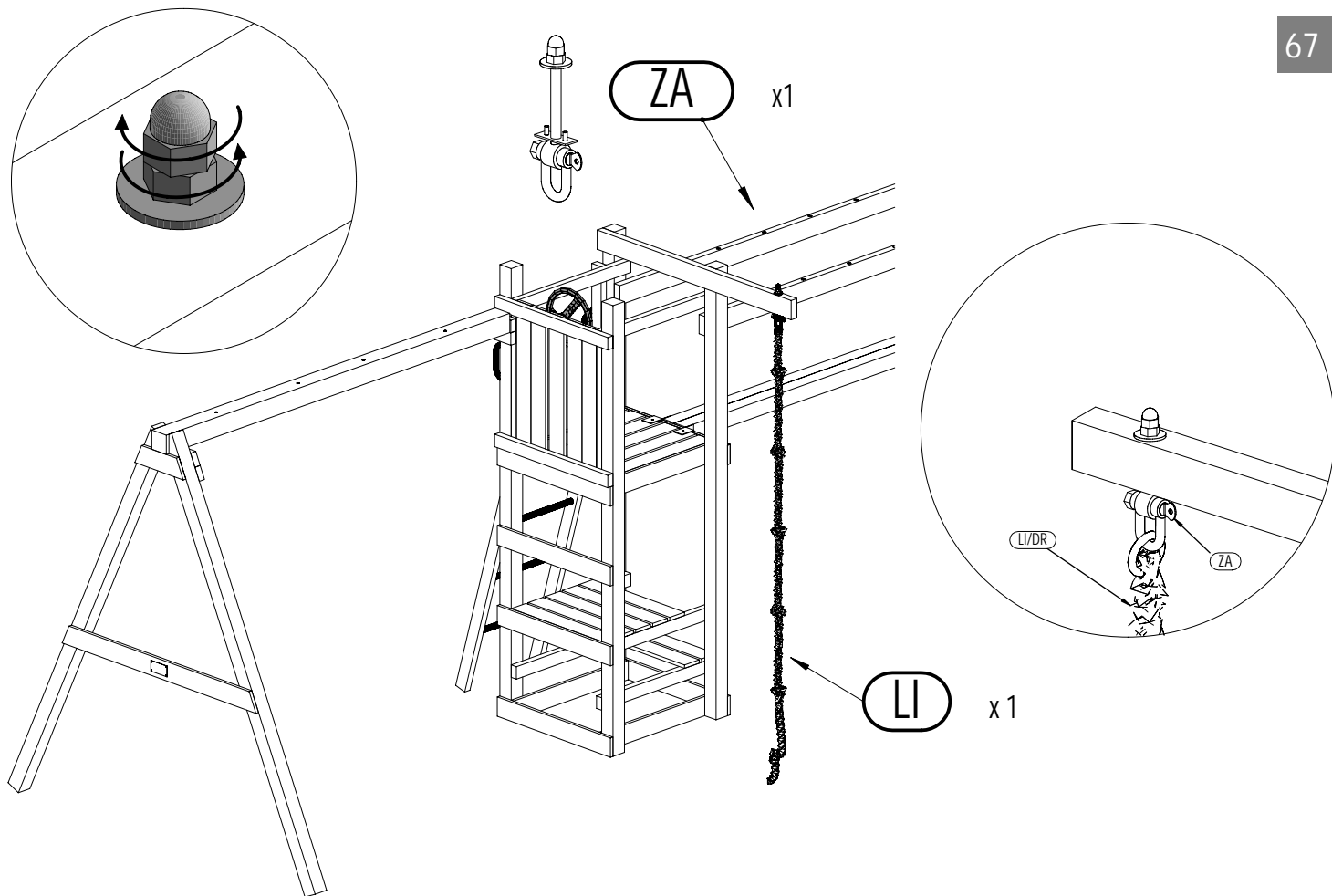

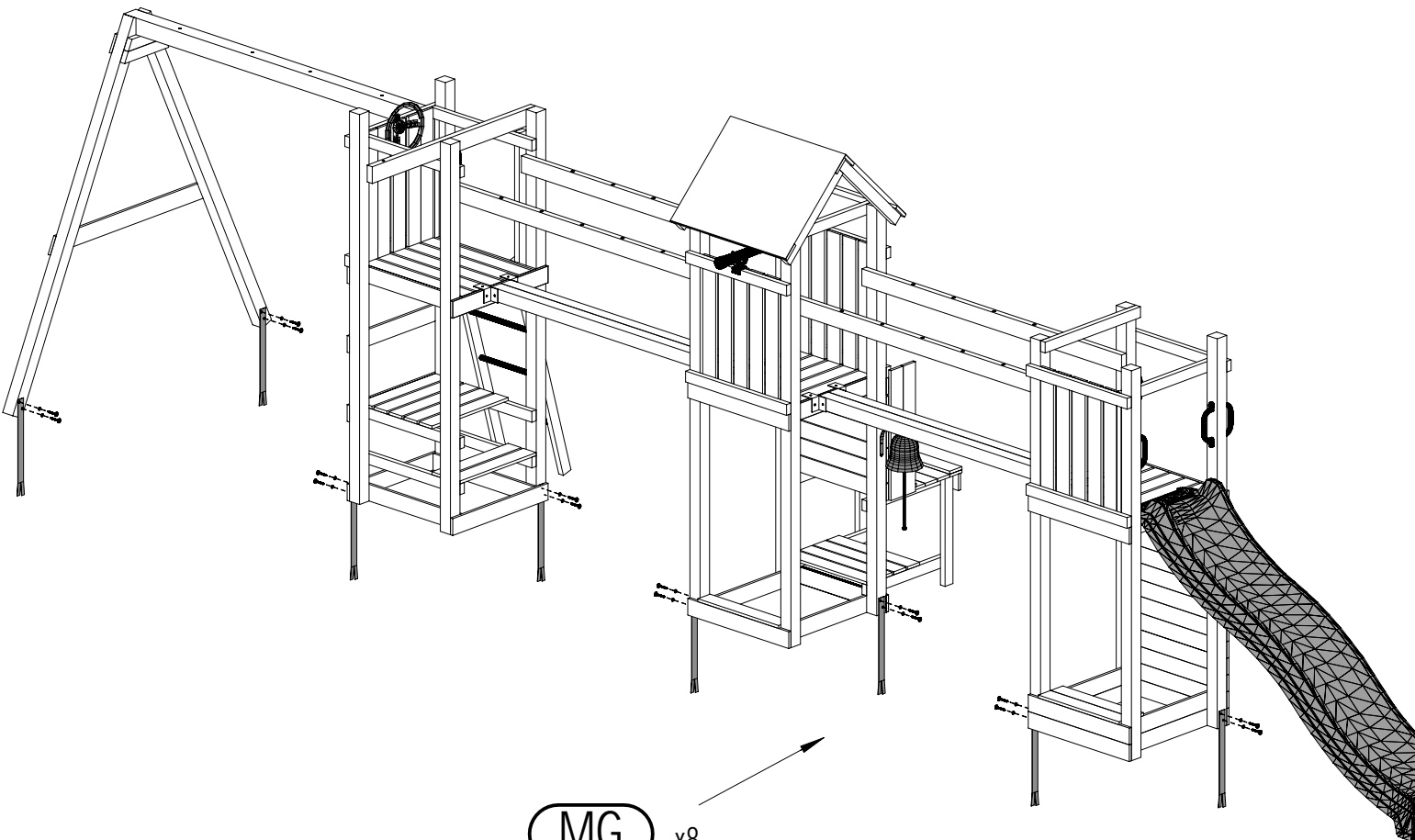
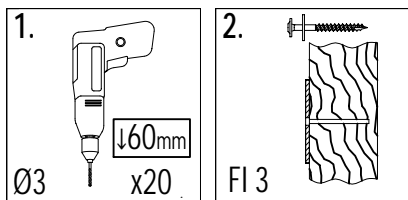

MG_x8

