

# PLAYGROUND SPIELPLATZ

# PLAC ZABAW AIRE DE JEUX

(612 x 518 x h257cm)

003\_08510\_31052023

## Maxi Funny Optimizer

INSTALLATION INSTRUCTIONS  
MONTAGEANLEITUNG

INSTRUKCJA MONTAŻU  
GUIDE D'INSTALLATION

Warranty period - 2 years from purchase date

Garantiezeit - 2 Jahre ab Kaufdatum

Okres gwarancji - 2 lata od momentu zakupu towaru

Période de garantie - 2 ans à compter de l'achat

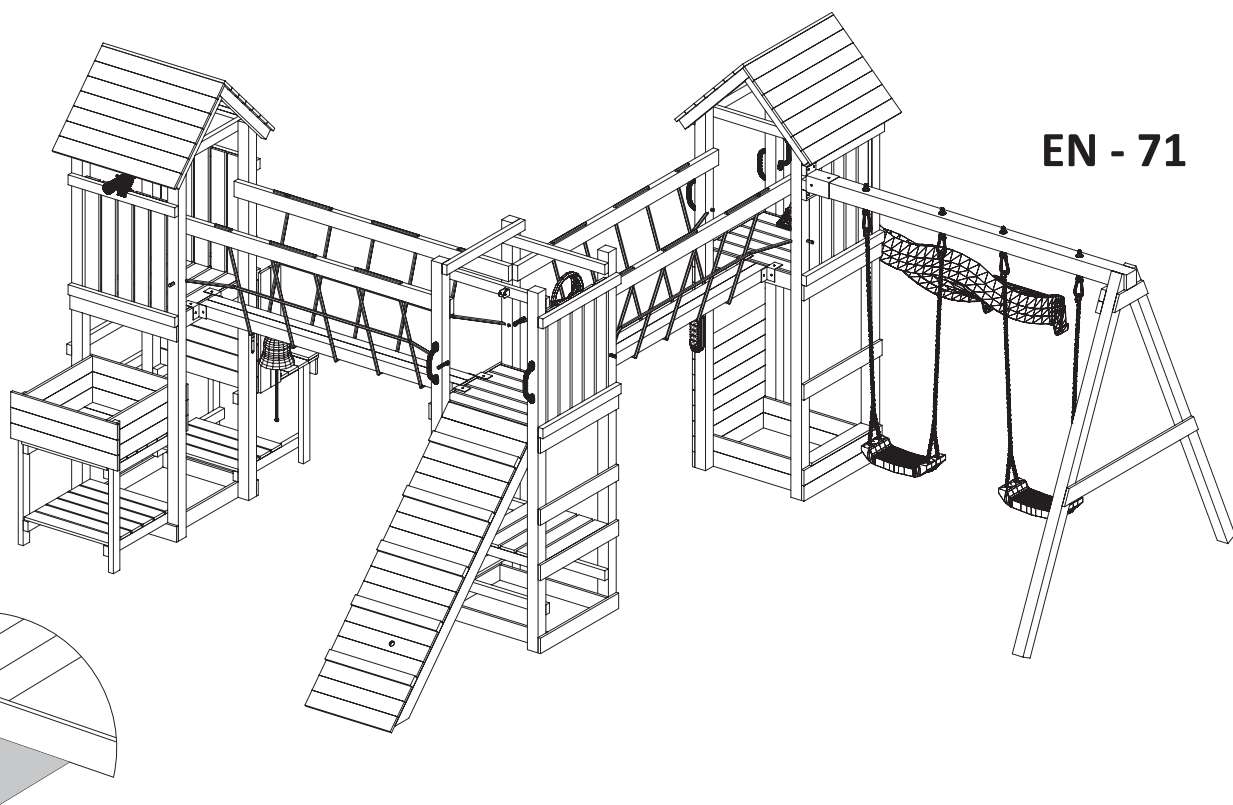

EN - 71

### WARNINGS!

Only for home use.

Dedicated for external use only.

Not suitable for children under 3 years old.

Risk of falling down and/or hitting.

Maximum user weight is up to 50 kg.

Maximum number of users staying on the  
playground at the same time: 15.

### OSTRZEŻENIA!

Tylko do użytku domowego.

Przeznaczony do użytku na zewnątrz.

Nie przeznaczony dla dzieci poniżej 3 roku życia.

Niebezpieczeństwo upadku i/lub uderzenia.

Maksymalna waga użytkownika to 50 kg.

Maksymalna liczba użytkowników przebywających  
na placu zabaw w tym samym czasie: 15.

### ACHTUNG!

Nur für den privaten, häuslichen Bereich.

Ausschließlich für die Verwendung im Freien.

Nicht geeignet für Kinder unter 3 Jahren.

Stolper- und / oder Sturzgefahr

Höchstgewicht pro Einzelkind beträgt 50 kg

Der Aufenthalt auf diesem Spielturm ist max. : 15.

Kindern gleichzeitig erlaubt.

### AVERTISSEMENT!

Aire exclusivement destinée à un usage privé.

Aire exclusivement destinée à un usage en extérieur.

Prévue pour les enfants de plus de 3 ans.

Danger de chute ou de choc.

Poids maximal d'un utilisateur : 50 kg.

Nombre maximal d'utilisateurs présents en  
même temps sur la même aire de jeux: 15.

W80 x235  
+1 Gratis



NS x1



W40 x663  
+7 Gratis



M12 x4



W30 x12

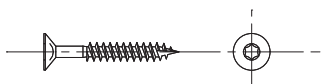

OS1 x147

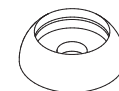

+4 Gratis

W20 x6



T80 x125

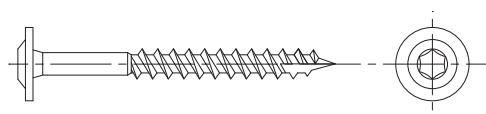

T60 x60

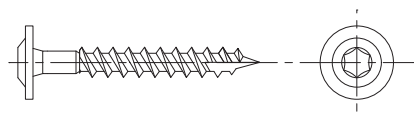

S50 x20

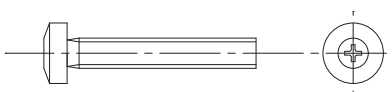

S40 x1

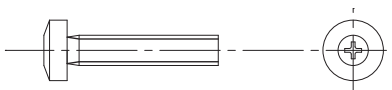

S30 x13

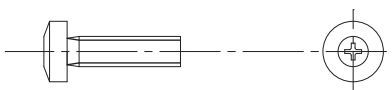

L11 x33

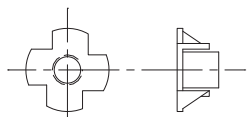

P17 x55



P15 x12

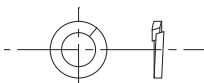

Ø3  
00239  
x1

Ø5,5  
01372  
x1

Ø10  
00188  
x1

PH3  
00068  
x1

PZ2  
00241  
x1

TX25  
00190  
x1

TX30  
00316  
x1

TX40  
00242  
x1

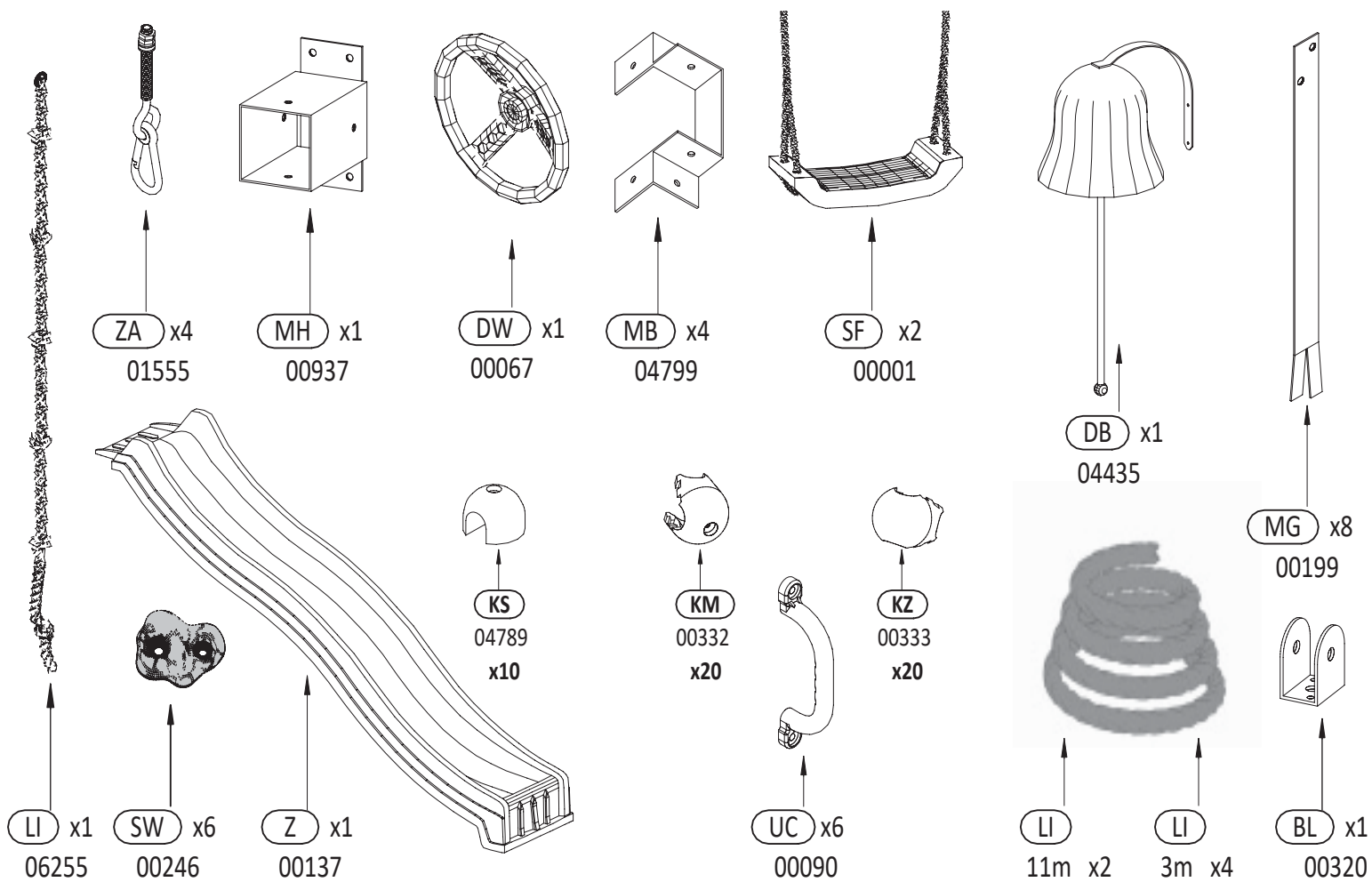
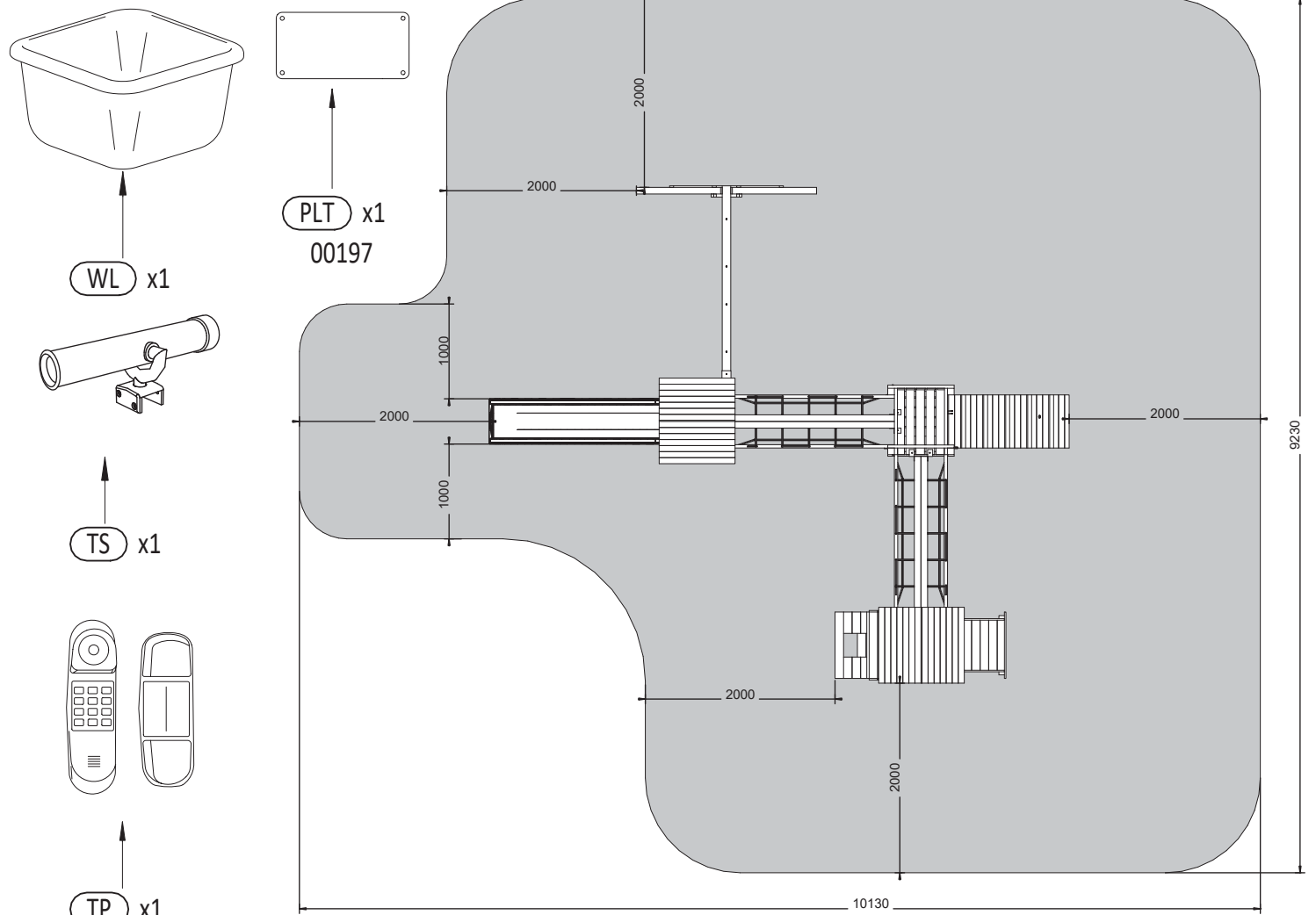

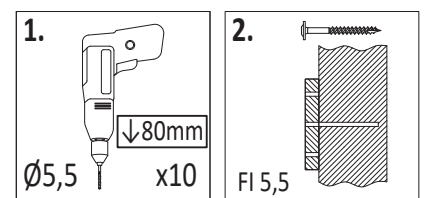
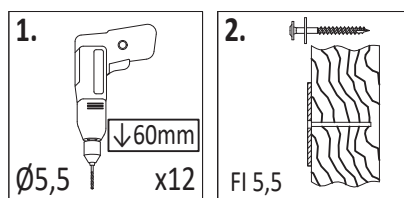
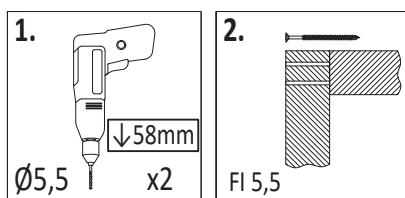
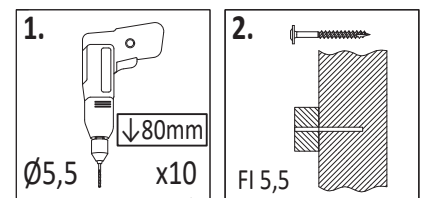
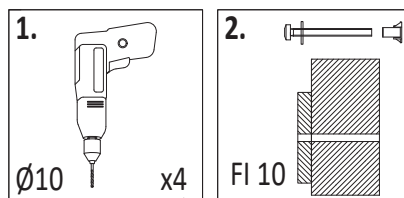
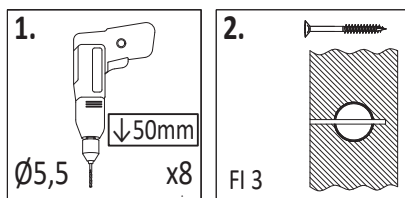
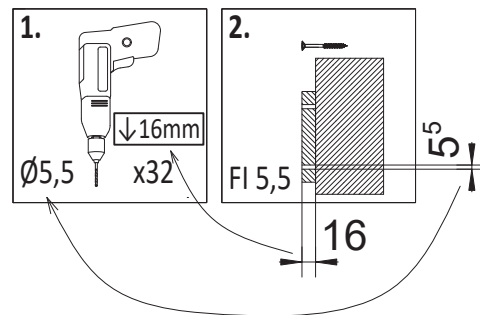
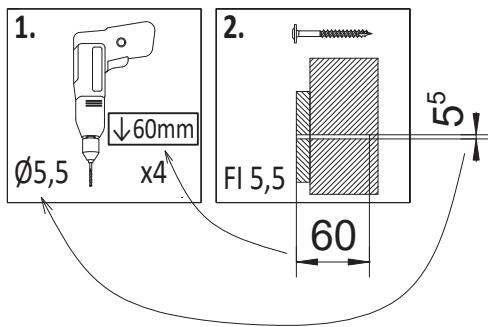
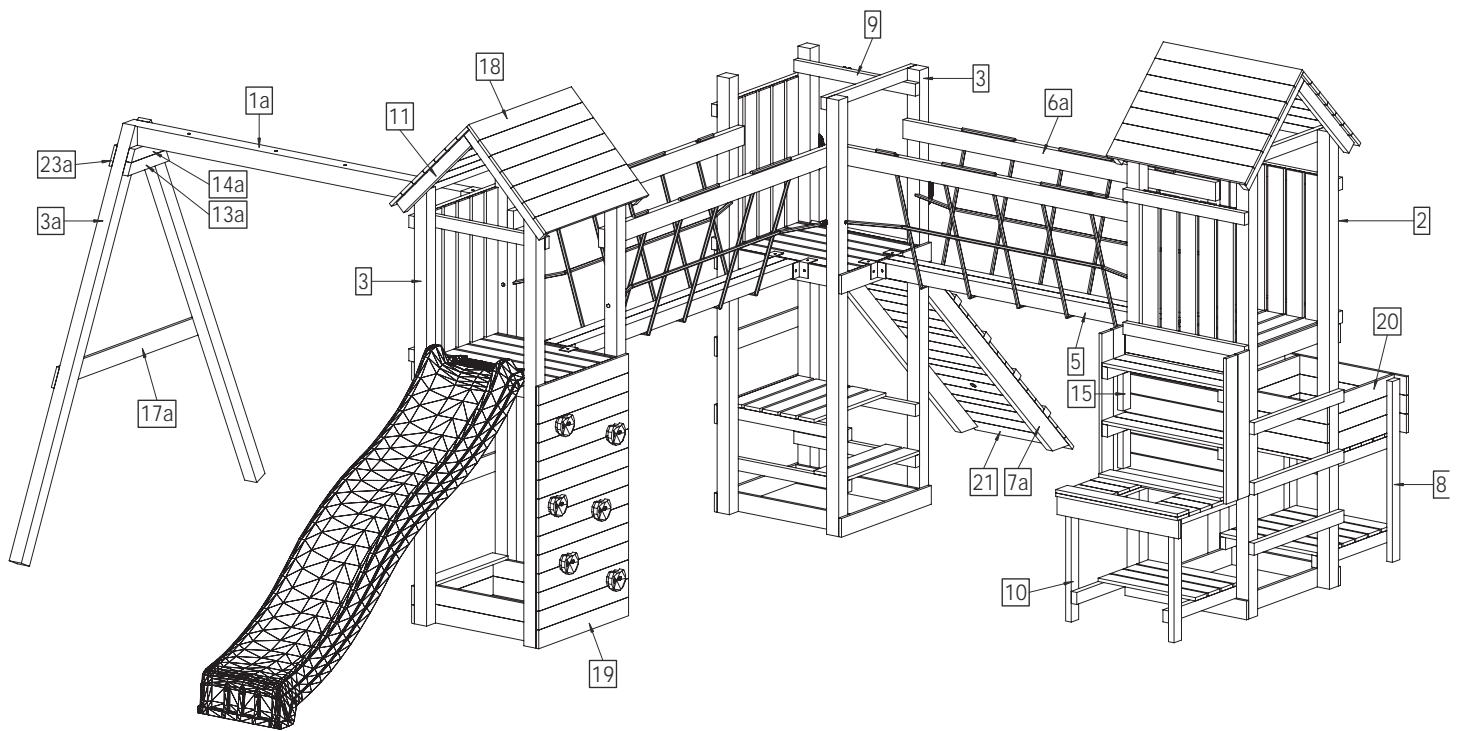

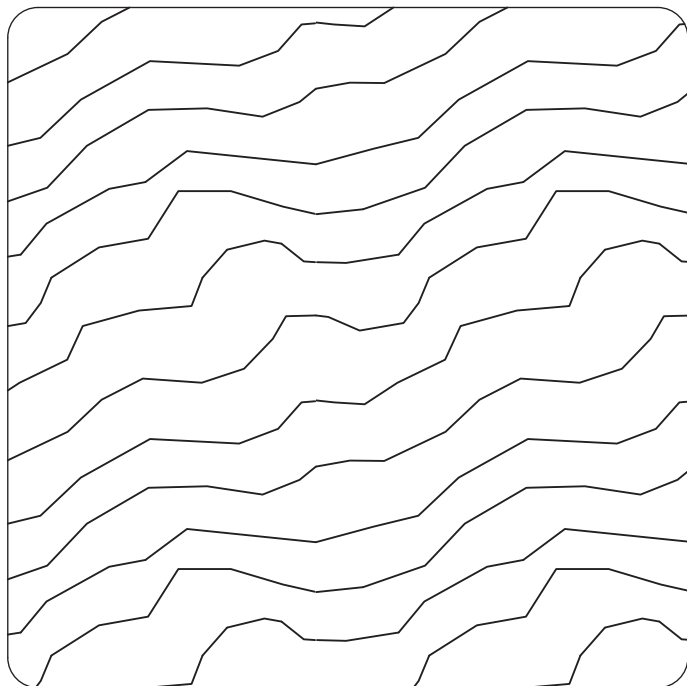

9 x 9 cm

Lp.	Kod	Wymiary [mm]	szt.
1a	04655	90x90x2100mm	1

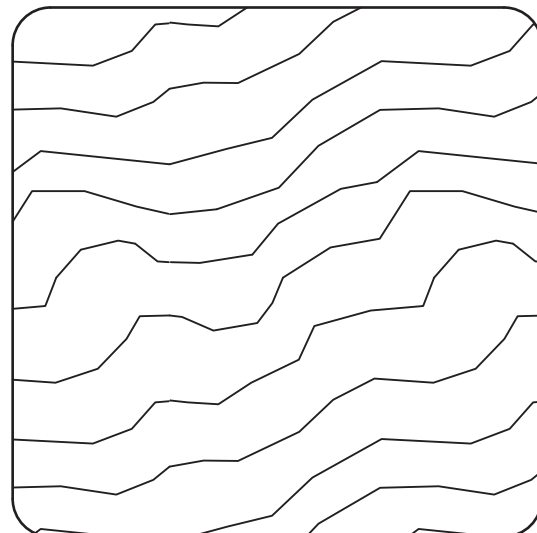

7 x 7 cm

Lp.	Kod	Wymiary [mm]	szt.
2	03901	70x70x2200mm	4
3	04611	70x70x2100mm	8
3a	05197	70x70x2100mm	2
4	05245	70x70x1800mm	2
5	08234	70x70x1710mm	2

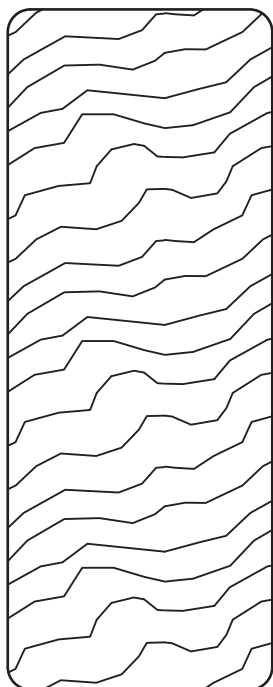

3,5 x 9,0 cm

Lp.	Kod	Wymiary [mm]	szt.
6a	04818	35x90x1800mm	4
7a	04474	35x90x1800mm	2

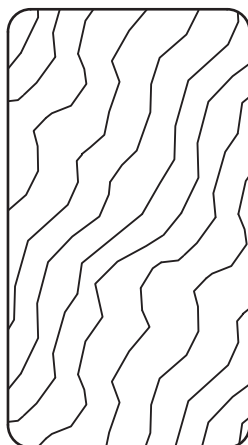

3,2 x 5,8 cm

Lp.	Kod	Wymiary [mm]	szt.
8	05770	32x58x870mm	2
9	05219	32x58x700mm	23
10	03100	32x58x600mm	14
11	05329	32x58x560mm	9
12	05221	32x58x528mm	9
13a	05177	32x58x324mm	1
14a	05179	32x58x270mm	1
15	08441	32x58x180mm	8
16	05269	32x58x100mm	2

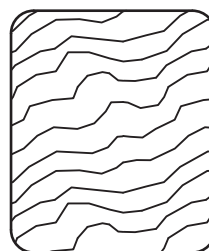

2,7 x 3,2 cm

Lp.	Kod	Wymiary [mm]	szt.
25a	05225	27x32x642mm	1



1,6 x 9,0 cm

Lp.	Kod	Wymiary [mm]	szt.
17a	03920	16x90x1200mm	1
18	04465	16x90x800mm	28
19	05223	16x90x700mm	103
20	04625	16x90x600mm	6
21	05263	16x90x560mm	41
21a	05339	16x90x560mm	1
22	06226	16x90x450mm	2
23a	05187	16x90x300mm	1
24	08443	16x90x225mm	6

01

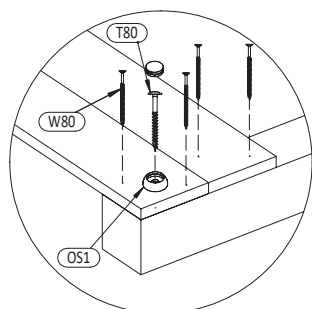
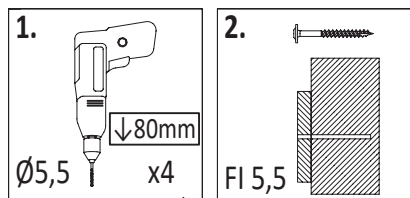

19  $1,6 \times 9,0 \times 70\text{cm}$

3  $7,0 \times 7,0 \times 210\text{cm}$

x2

x3

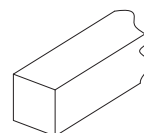
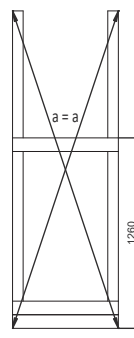

OS1 x4



W80 x12



T80 x4

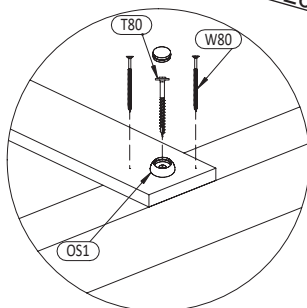

02

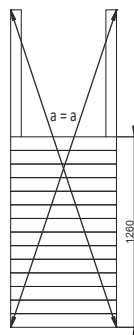
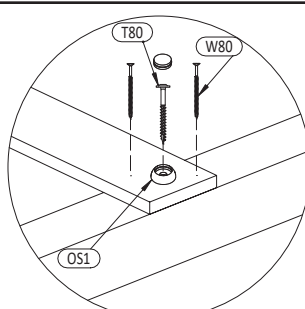
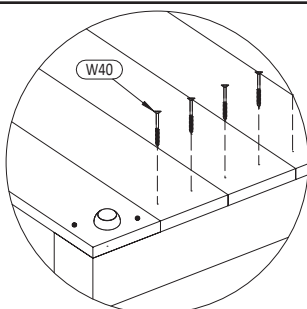
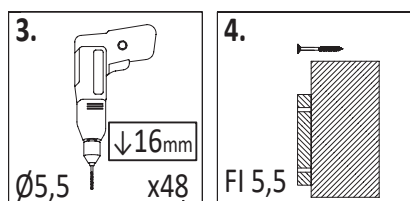
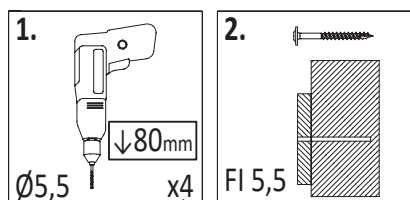

a a a a a a a

!!!min 2mm < a < !!!max 6mm

19  $1,6 \times 9,0 \times 70\text{cm}$

x14

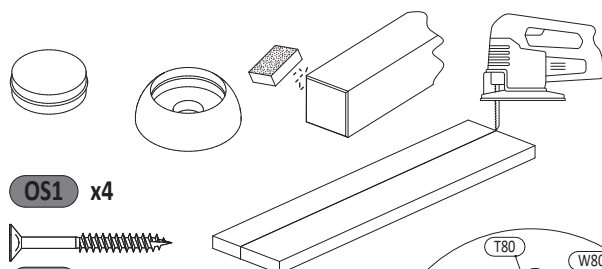

OS1 x4

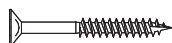

W40 x48



W80 x8

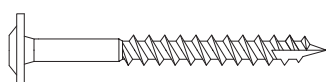

T80 x4

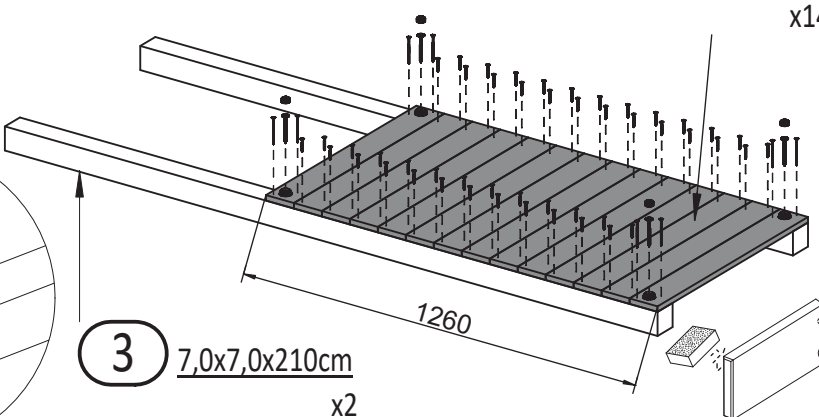
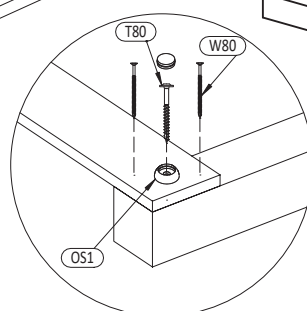

3  $7,0 \times 7,0 \times 210\text{cm}$

x2

6

Zgodnie z normą PN-EN 71 stosuj zalecenia producenta odnośnie odległości oraz metody mocowania poszczególnych elementów

In compliance with the standard PN-EN 71, apply guidelines of the producer in relation to distances and methods of fastening individual elements

Maxi Funny Optimizer

19 1,6x9,0x70cm

x6

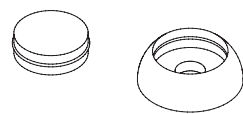
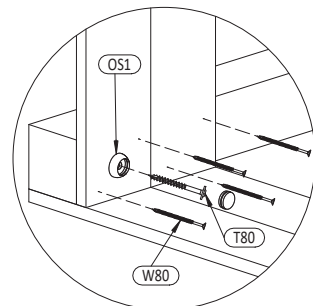
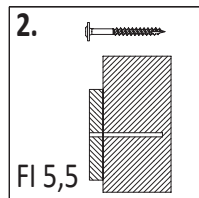
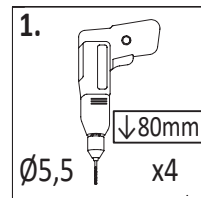
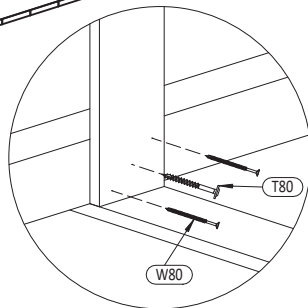
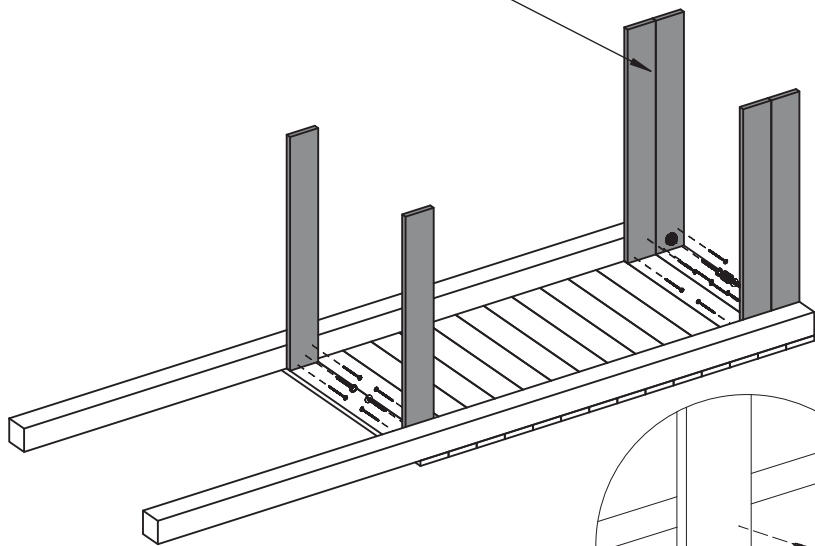

OS1 x2



W80 x12



T80 x4

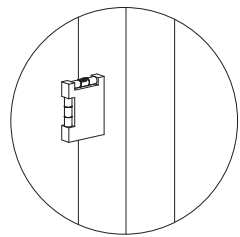
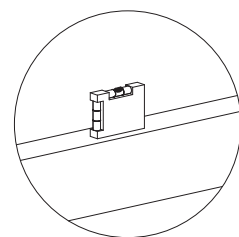
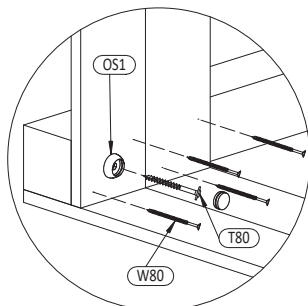
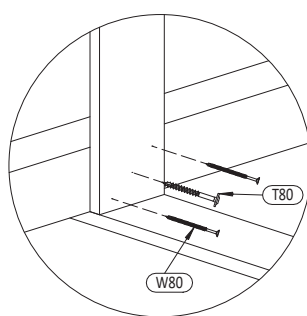
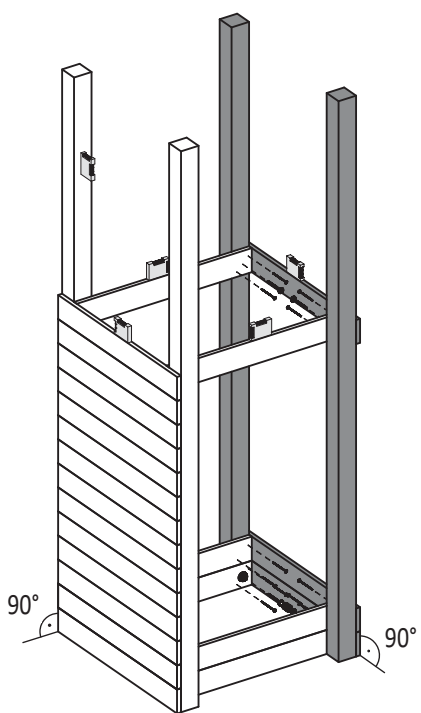
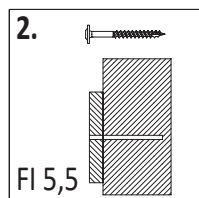
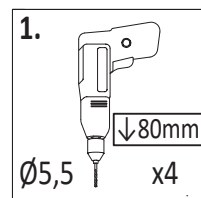

OS1 x2



W80 x12

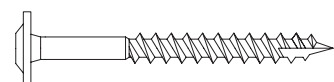

T80 x4

05

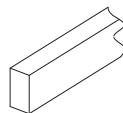
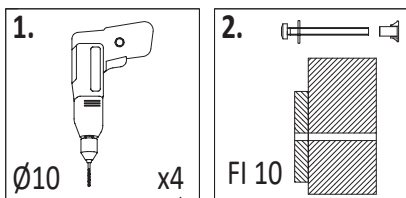

12

3,2x5,8x52,8cm

x2

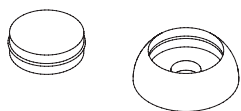

OS1 x4



W40 x4

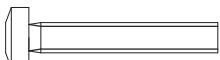

S50 x4



P17 x4



L11 x4

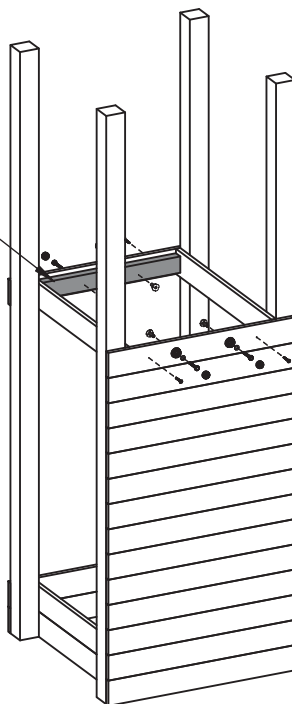
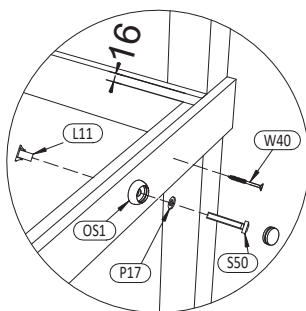

06

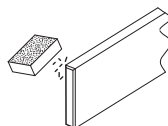
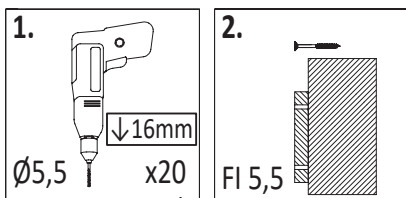

19

1,6x9,0x70cm

x5

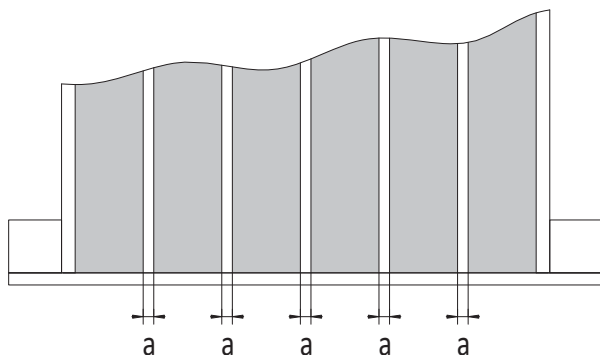

!!!min 13mm &lt; a &lt; !!!max 23mm



W40 x20

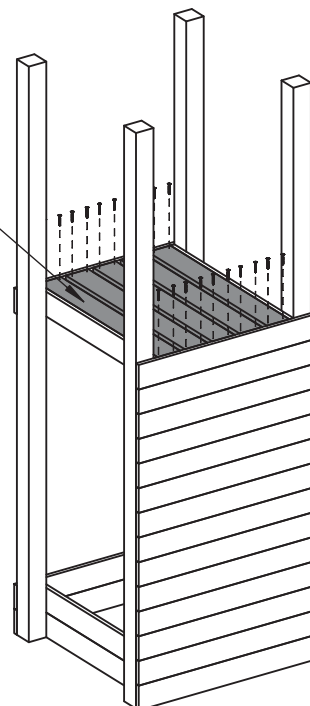

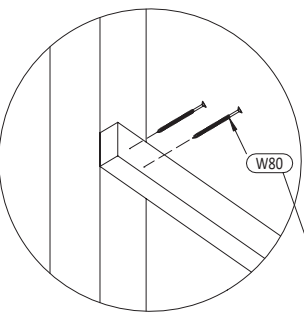

9 3,2x5,8x70cm

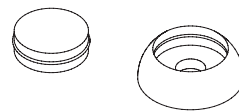
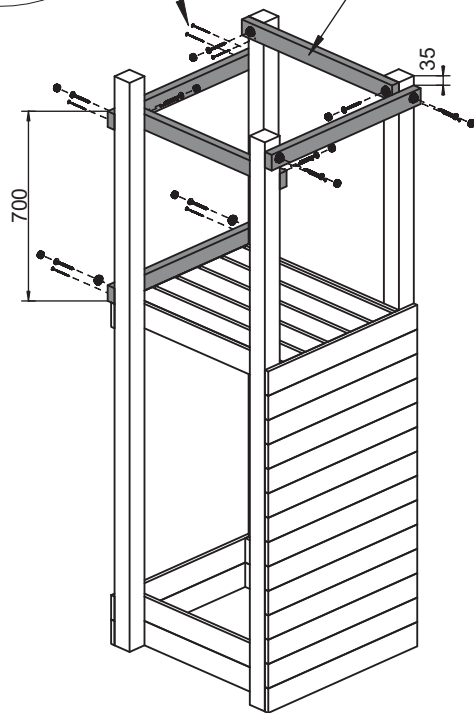
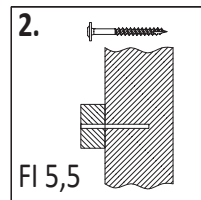
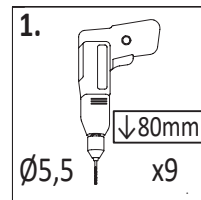
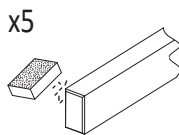

OS1 x9



W80 x11



T80 x9

25a 3,2x2,7x64,2cm

x1

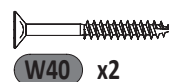
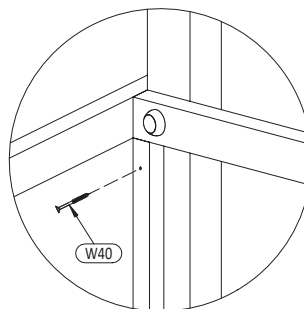
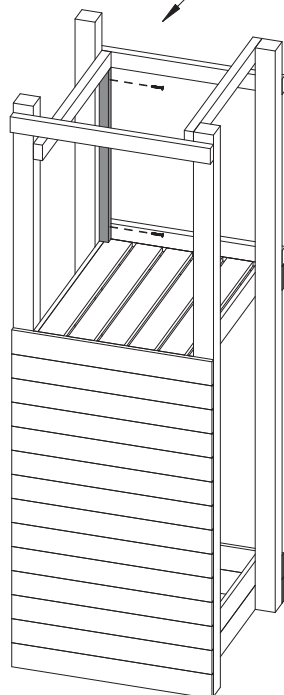
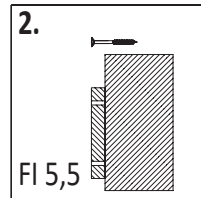
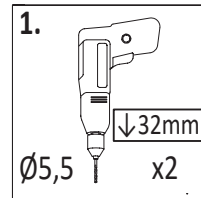
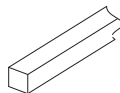

W40 x2

09

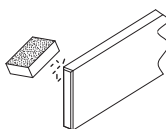
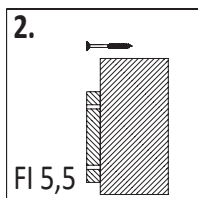
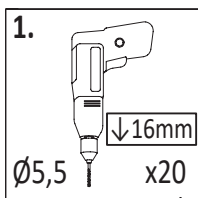

19

1,6x9,0x70cm

x5

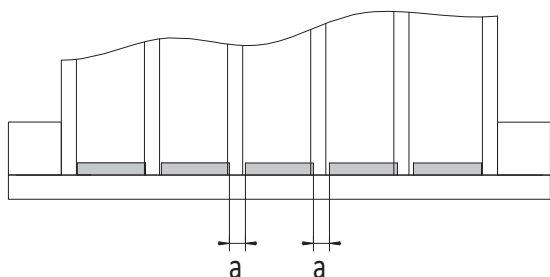

!!!min 13mm &lt; a &lt; !!!max 23mm

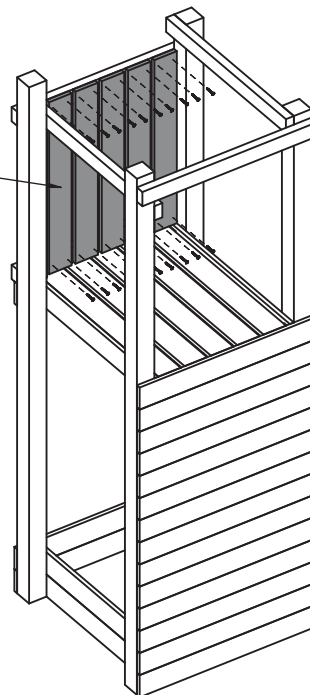

W40 x20

10

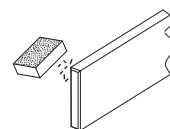
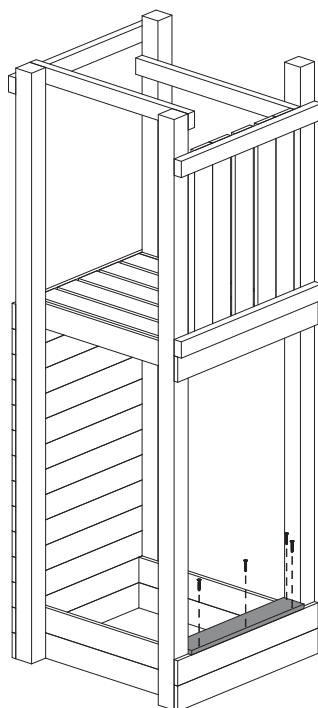
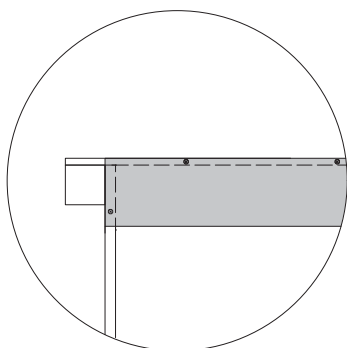
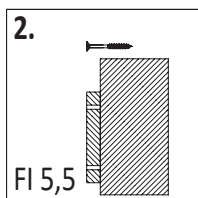
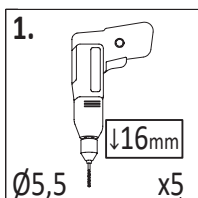

21

1,6x9,0x56cm

x1

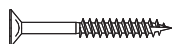

W40 x5

10

Zgodnie z normą PN-EN 71 stosuj zalecenia producenta odnośnie odległości oraz metody mocowania poszczególnych elementów

In compliance with the standard PN-EN 71, apply guidelines of the producer in relation to distances and methods of fastening individual elements

Maxi Funny Optimizer

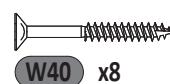
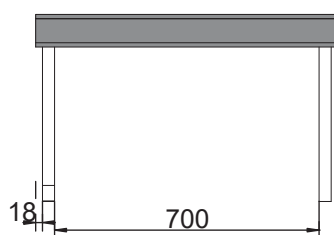
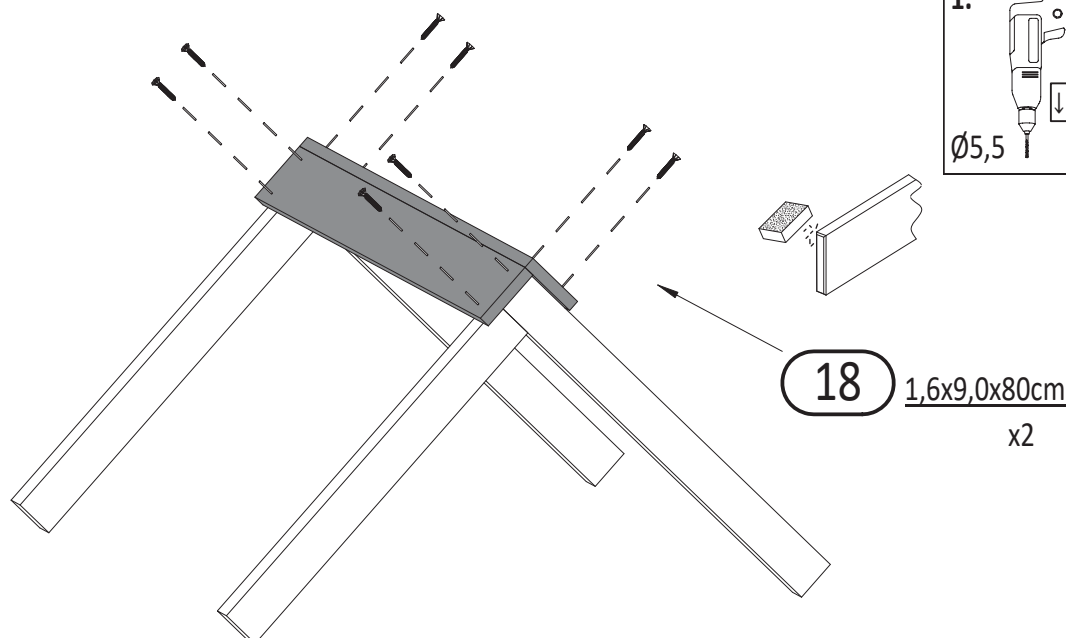
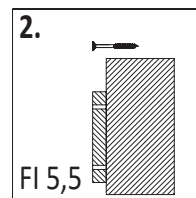
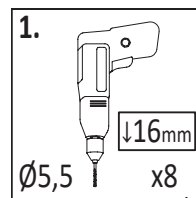
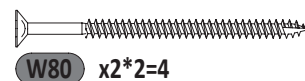
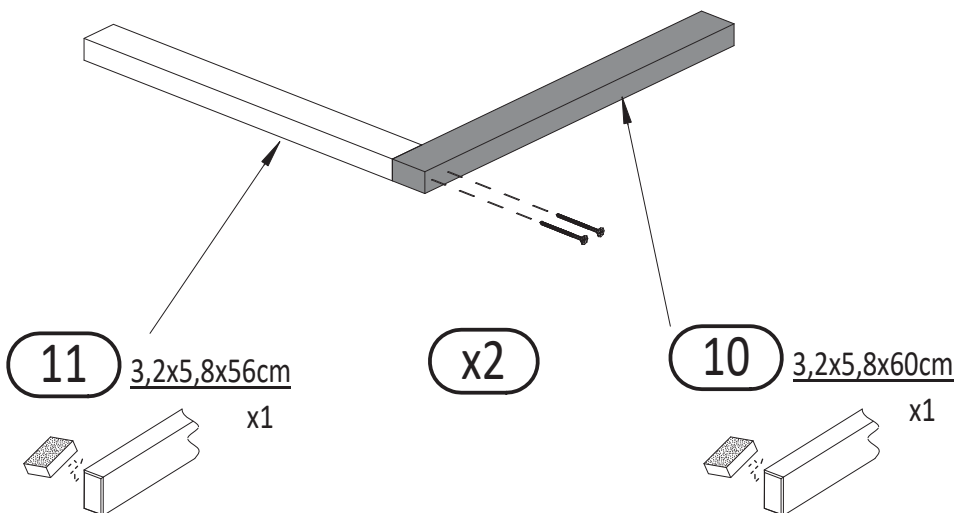
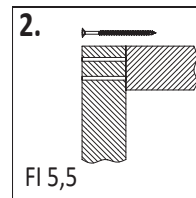
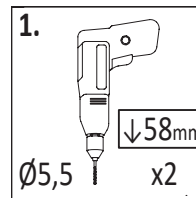

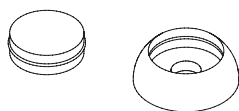
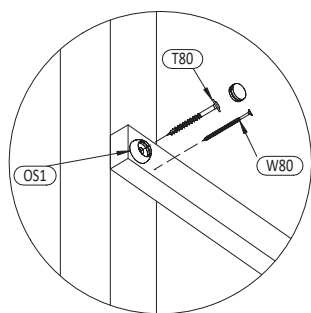
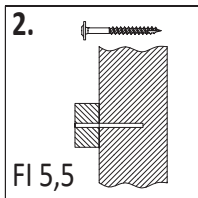
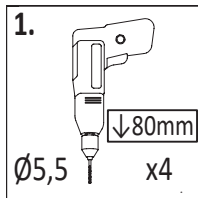
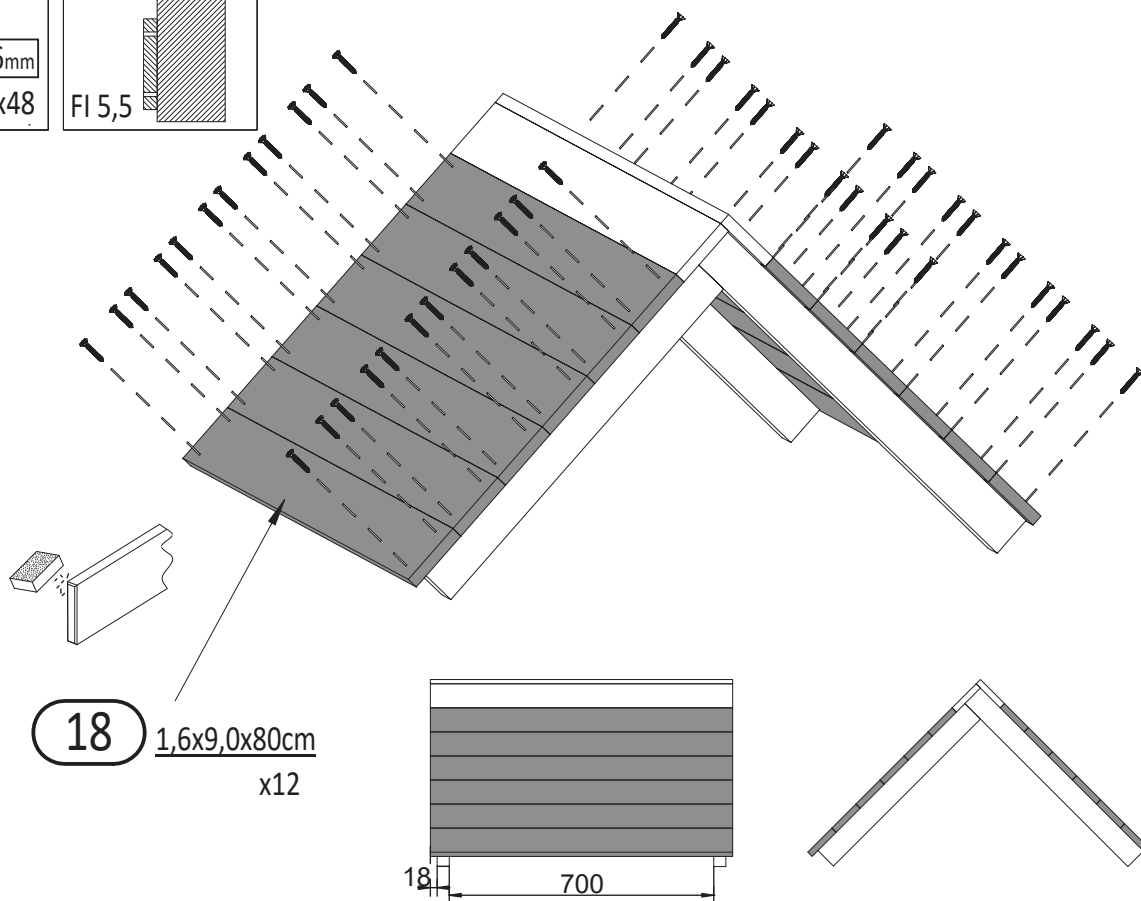
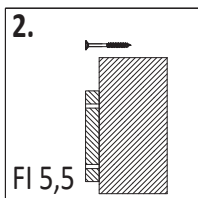
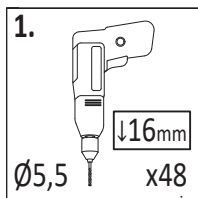

OS1 x4



W80 x4

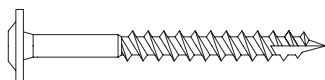

T80 x4

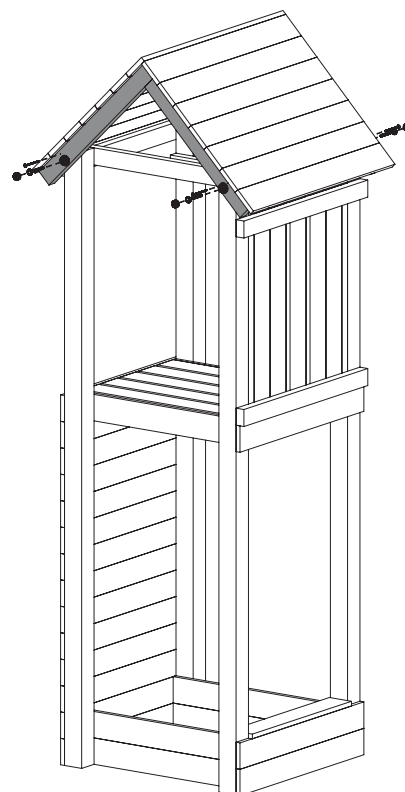

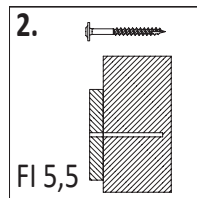
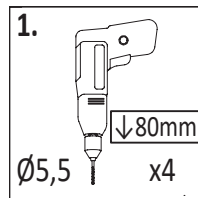
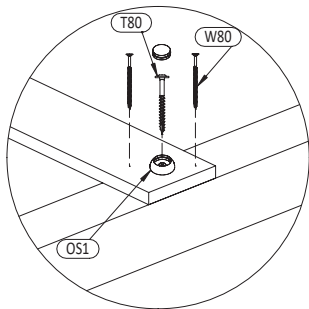
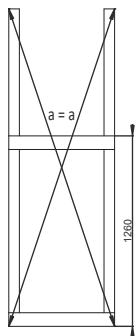

15

**19** 1,6x9,0x70cm

**3** 7,0x7,0x210cm

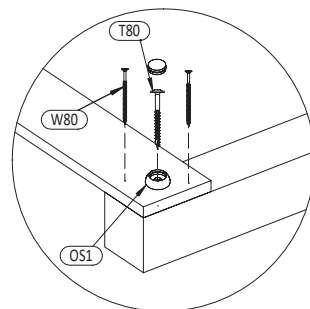
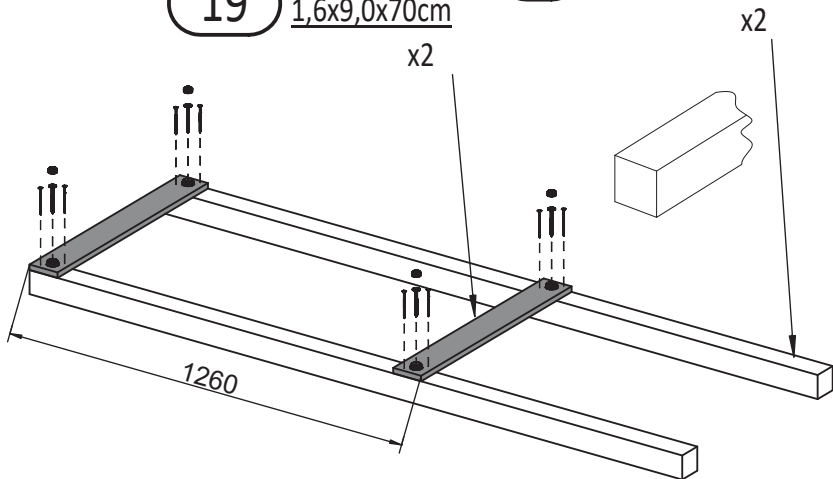

**OS1** x4



**W80** x8



**T80** x4

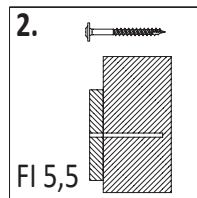
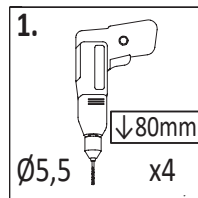
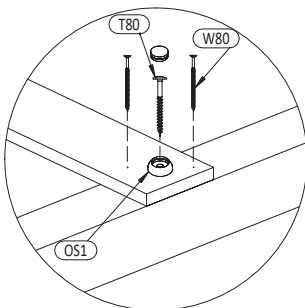
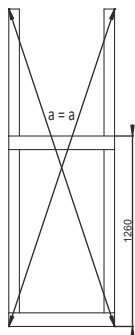

16

**3** 7,0x7,0x210cm

**19** 1,6x9,0x70cm

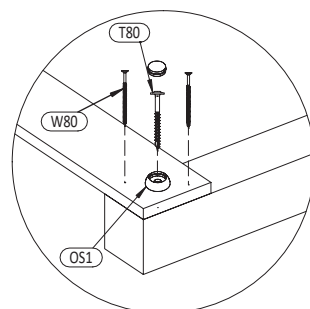
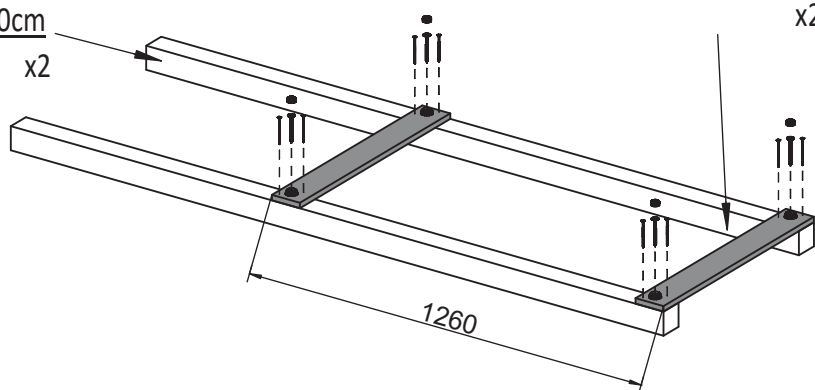

**OS1** x4



**W80** x8



**T80** x4

13

17

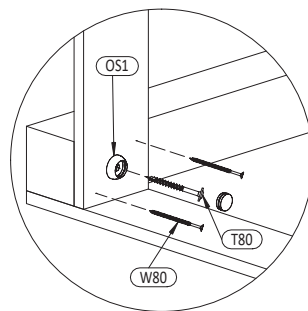
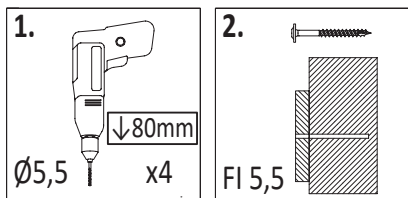

19

1,6x9,0x70cm

x5

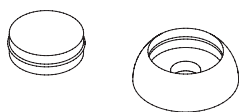
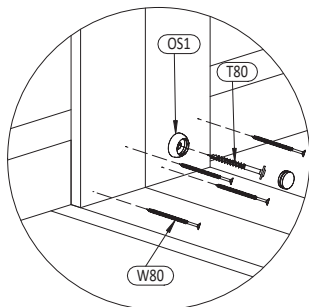
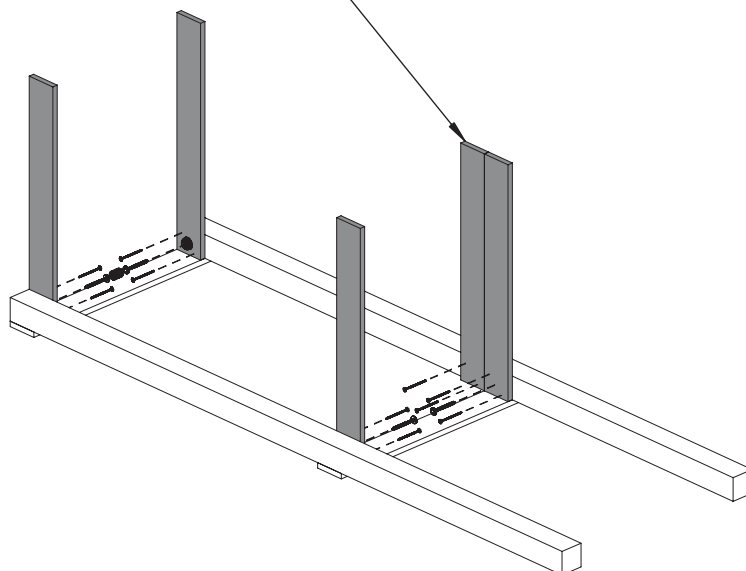

OS1 x2



W80 x10



T80 x4

18

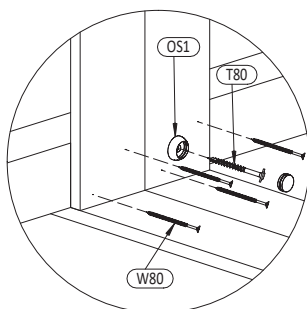
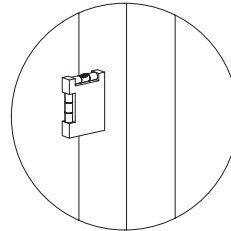
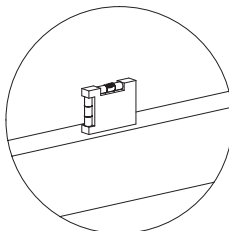
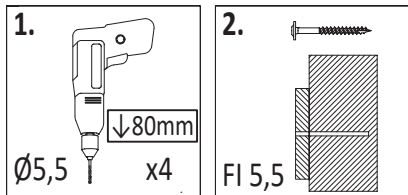

OS1 x2



W80 x10



T80 x4

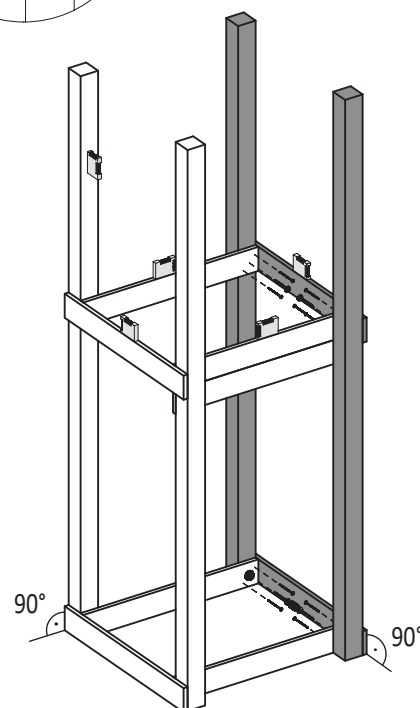
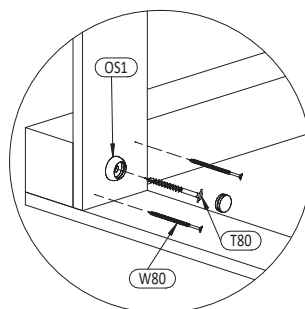

14

Zgodnie z normą PN-EN 71 stosuj zalecenia producenta odnośnie odległości oraz metody mocowania poszczególnych elementów

In compliance with the standard PN-EN 71, apply guidelines of the producer in relation to distances and methods of fastening individual elements

Maxi Funny Optimizer

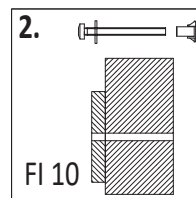
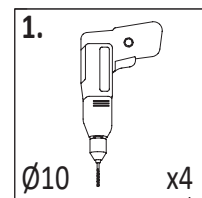
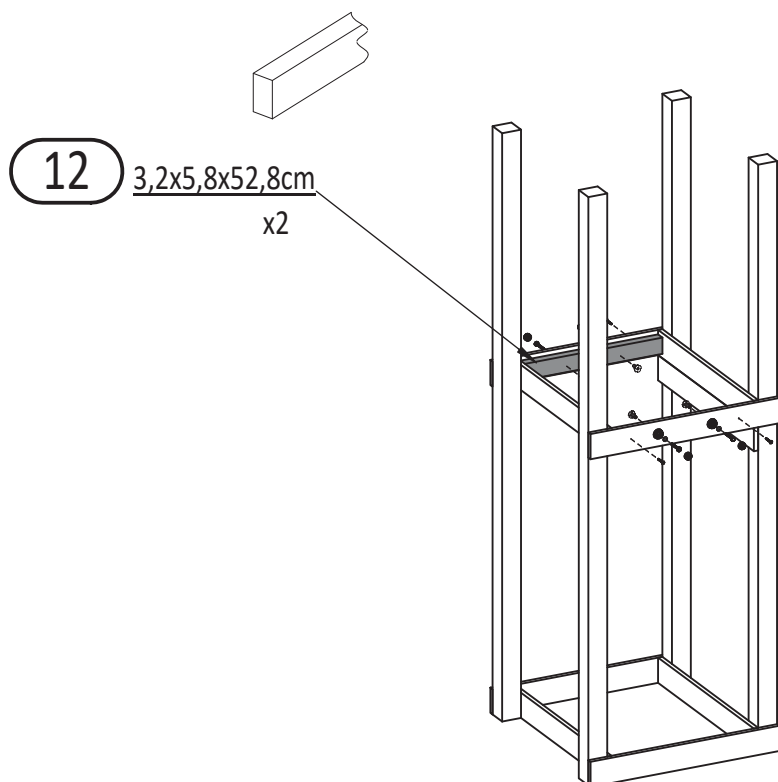

19

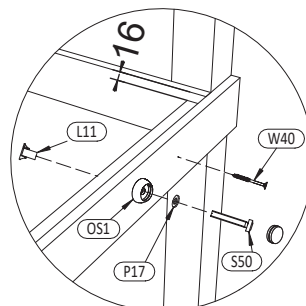

OS1 x4

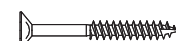

W40 x4

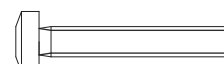

S50 x4



P17 x4



L11 x4

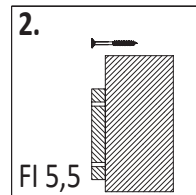
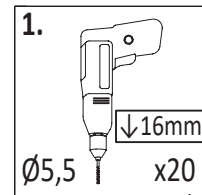
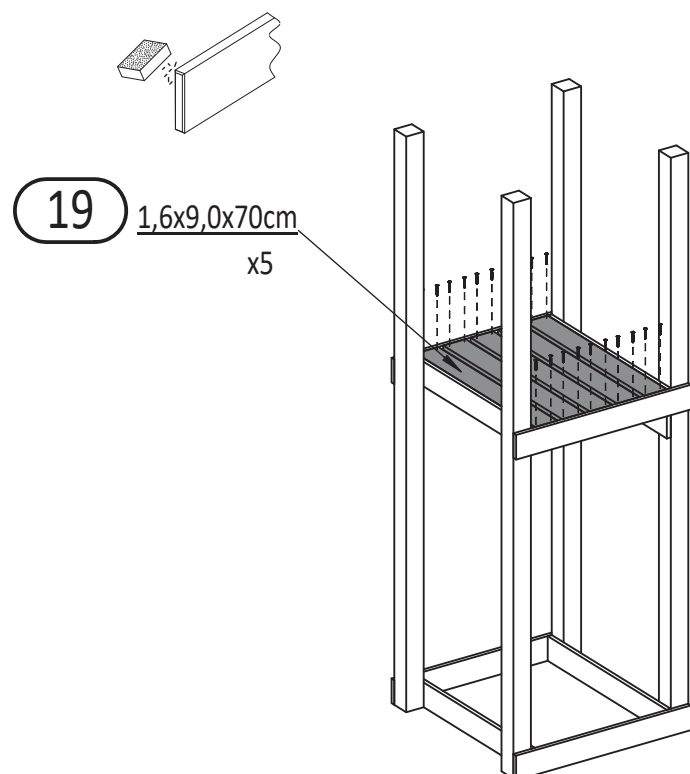

20

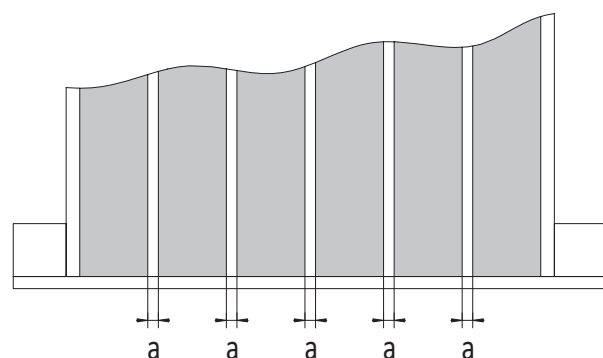

!!!min 13mm < a < !!!max 23mm



W40 x20

21

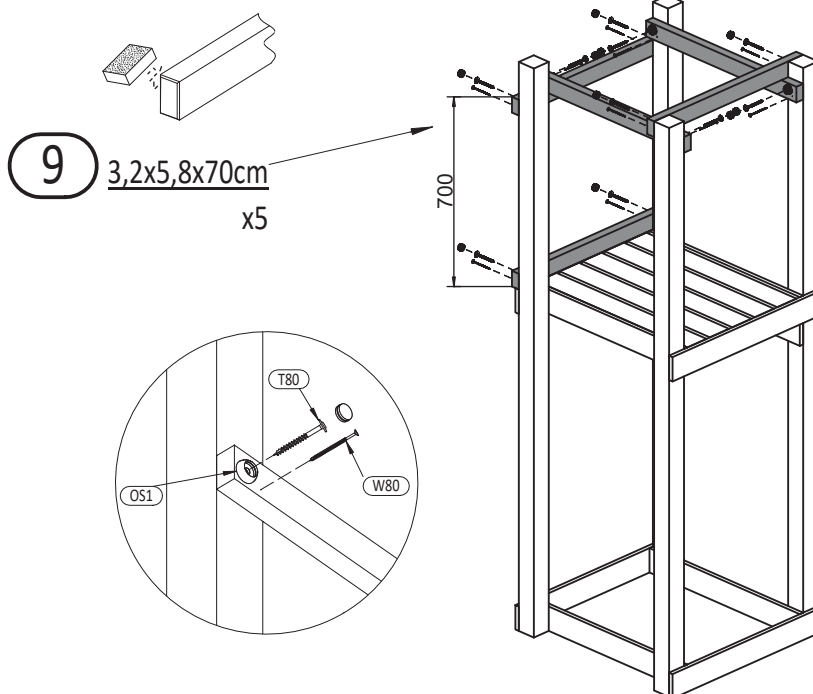
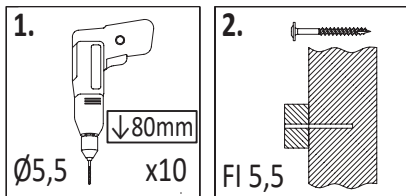

22

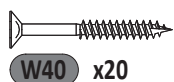
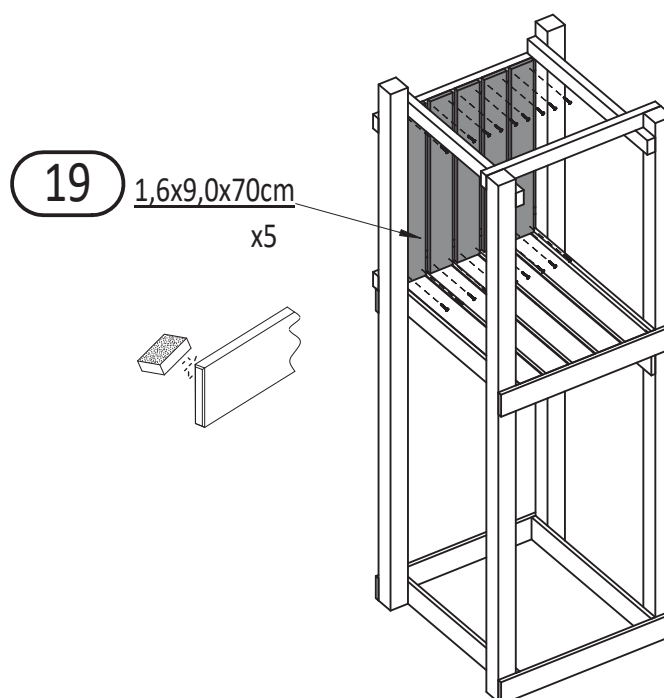
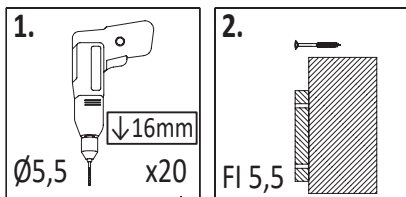

16

Zgodnie z normą PN-EN 71 stosuj zalecenia producenta odnośnie odległości oraz metody mocowania poszczególnych elementów  
 In compliance with the standard PN-EN 71, apply guidelines of the producer in relation to distances and methods of fastening individual elements

Maxi Funny Optimizer

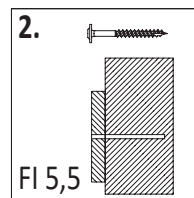
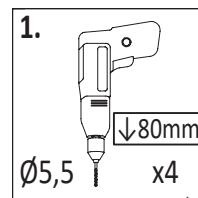
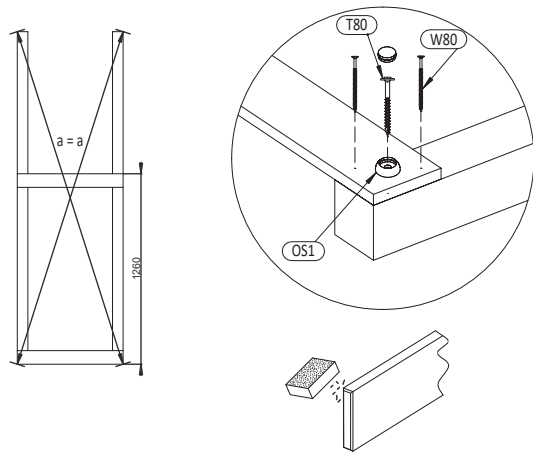

23

**19** 1,6x9,0x70cm x2

**2** 7,0x7,0x220cm x2

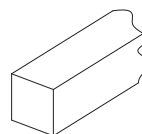
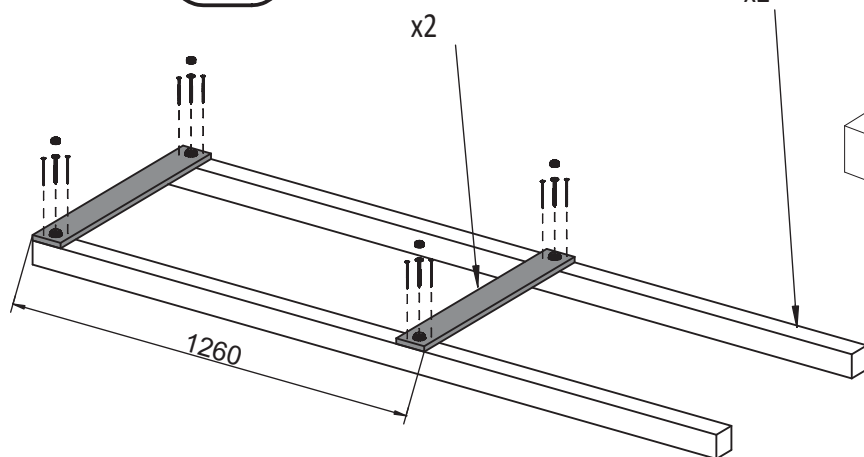
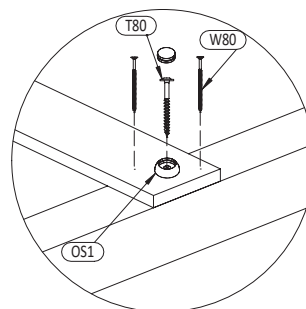

**OS1** x4



**W80** x8

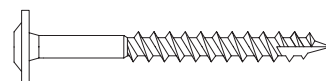

**T80** x4

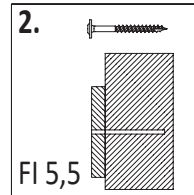
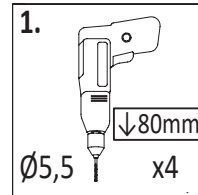
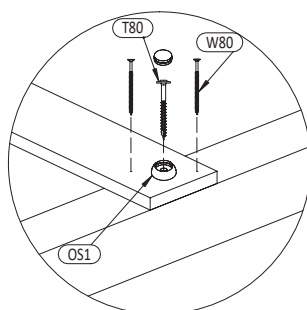
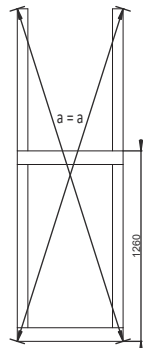

24

**19** 1,6x9,0x70cm x2

**2** 7,0x7,0x220cm x2

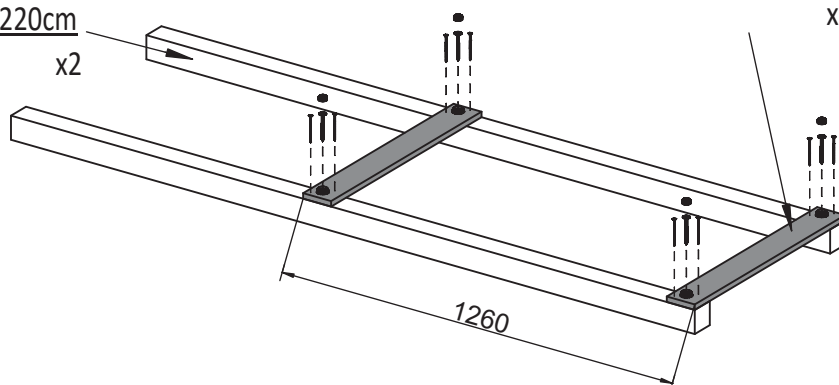
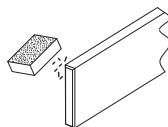
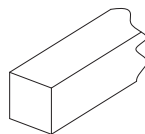
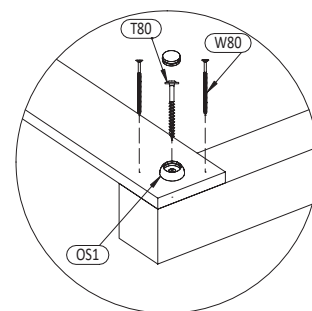

**OS1** x4

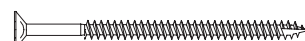

**W80** x8

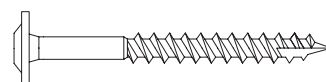

**T80** x4

Zgodnie z normą PN-EN 71 stosuj zalecenia producenta odnośnie odległości oraz metody mocowania poszczególnych elementów

In compliance with the standard PN-EN 71, apply guidelines of the producer in relation to distances and methods of fastening individual elements

17

Maxi Funny Optimizer

25

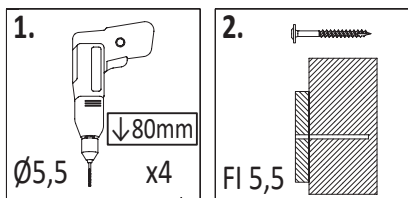

19

1,6x9,0x70cm

x4

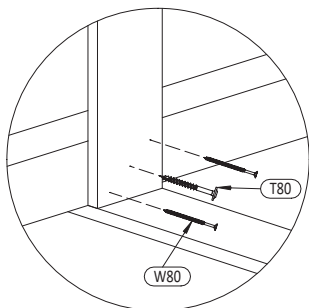
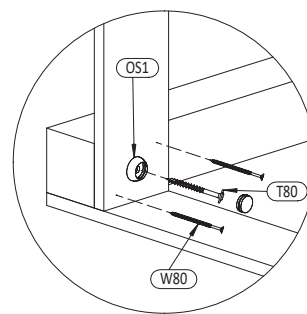

OS1 x2



W80 x8



T80 x4

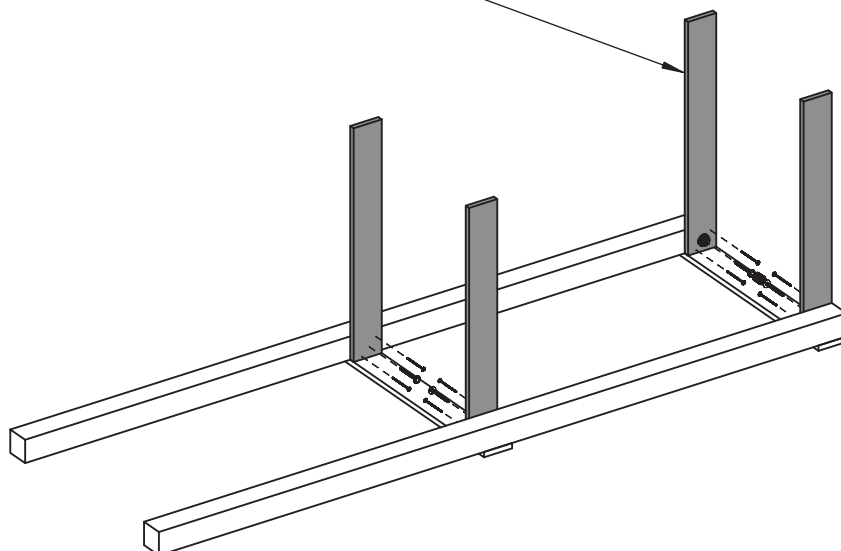

26

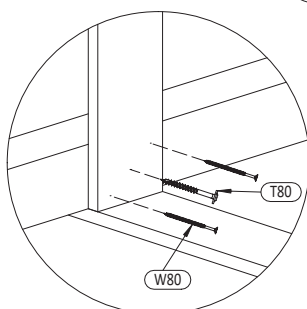
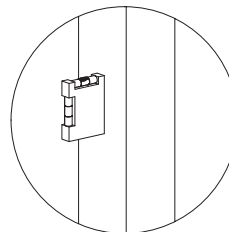
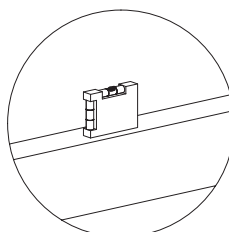
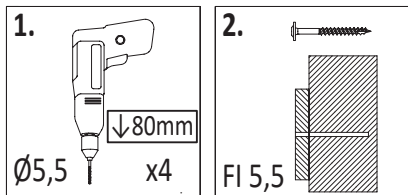

OS1 x2



W80 x8



T80 x4

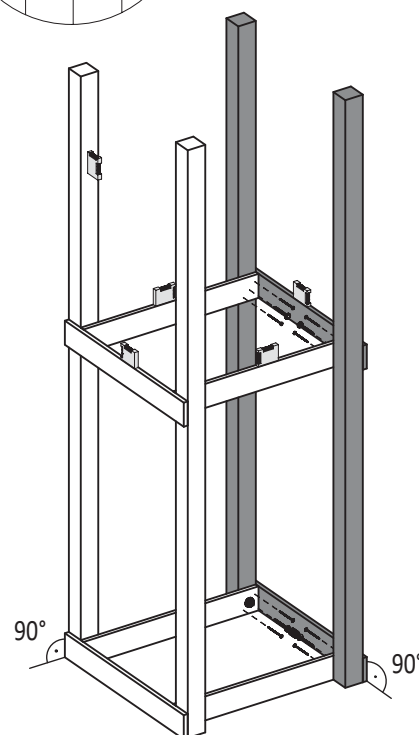
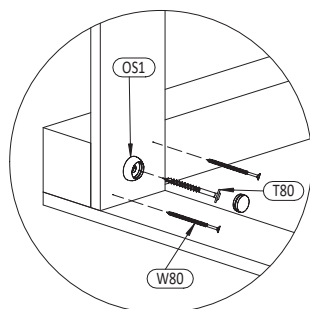

18

Zgodnie z normą PN-EN 71 stosuj zalecenia producenta odnośnie odległości oraz metody mocowania poszczególnych elementów

In compliance with the standard PN-EN 71, apply guidelines of the producer in relation to distances and methods of fastening individual elements

Maxi Funny Optimizer

12 3,2x5,8x52,8cm  
x2

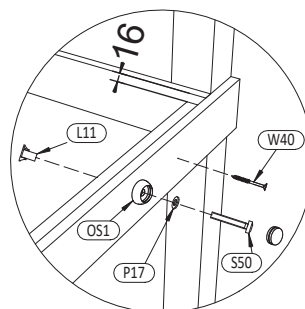
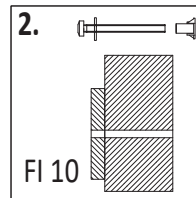
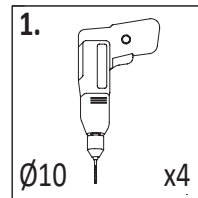
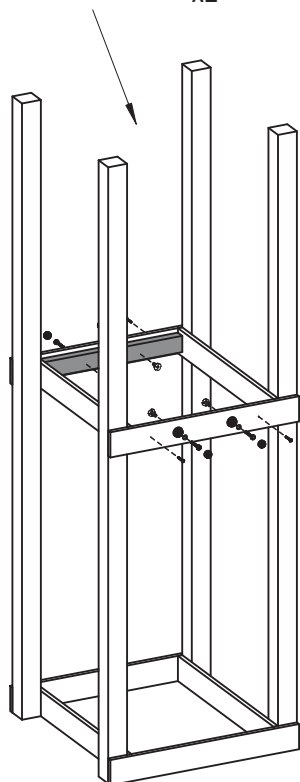

OS1 x4

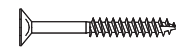

W40 x4

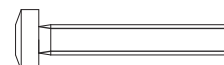

S50 x4



P17 x4



L11 x4

19 1,6x9,0x70cm  
x5

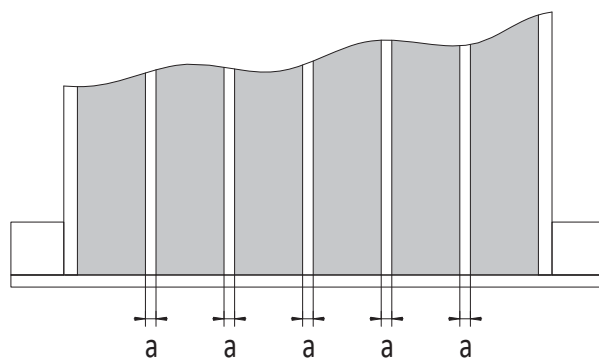
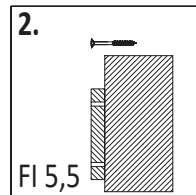
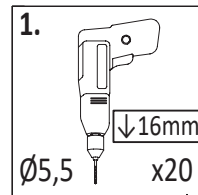
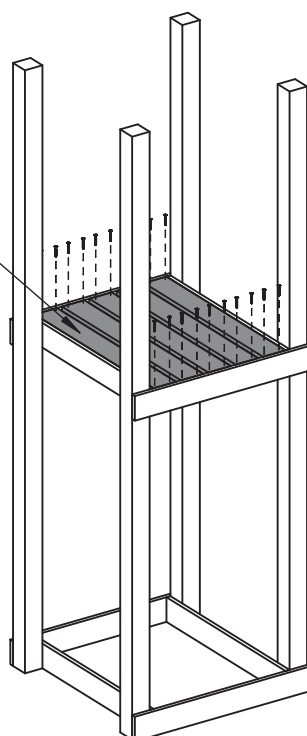
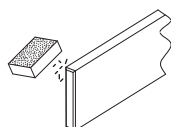

!!!min 13mm < a < !!!max 23mm

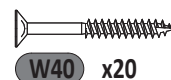

W40 x20

29

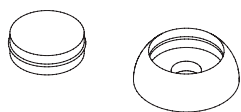
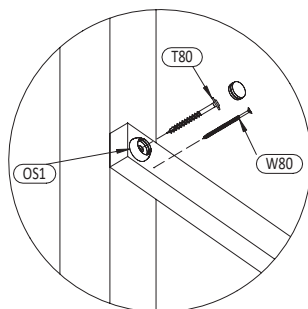
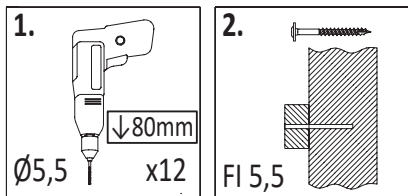

OS1 x12



W80 x12



T80 x12

9  $3,2 \times 5,8 \times 70\text{cm}$   
x6

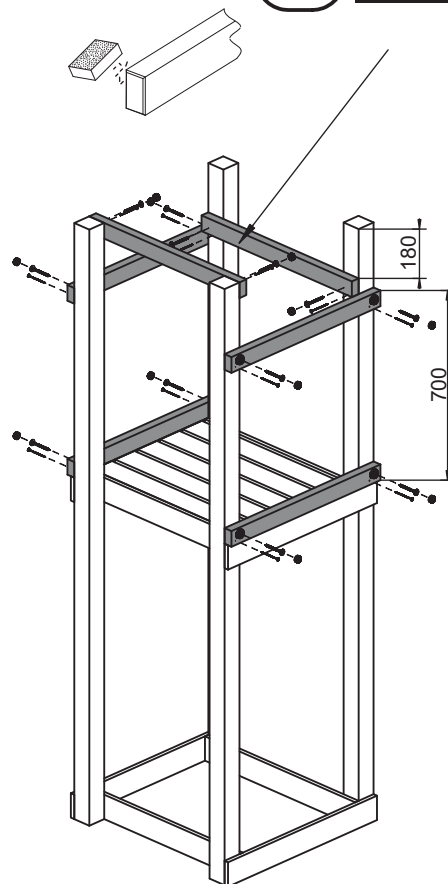

30

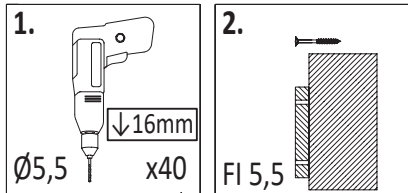

19  $1,6 \times 9,0 \times 70\text{cm}$   
x10

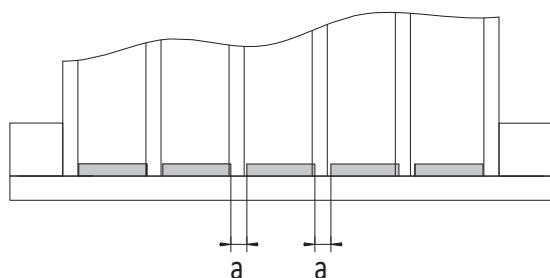
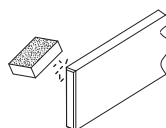

!!!min 13mm < a < !!!max 23mm

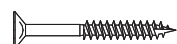
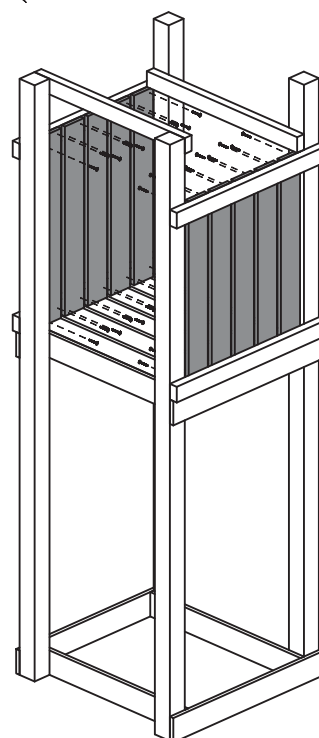

W40 x40

20

Zgodnie z normą PN-EN 71 stosuj zalecenia producenta odnośnie odległości oraz metody mocowania poszczególnych elementów  
In compliance with the standard PN-EN 71, apply guidelines of the producer in relation to distances and methods of fastening individual elements

Maxi Funny Optimizer

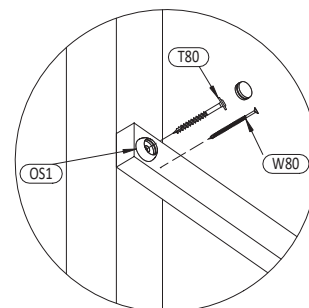
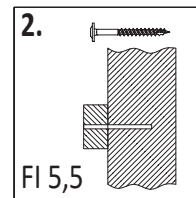
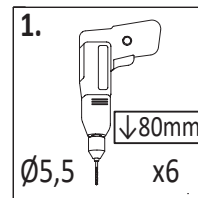
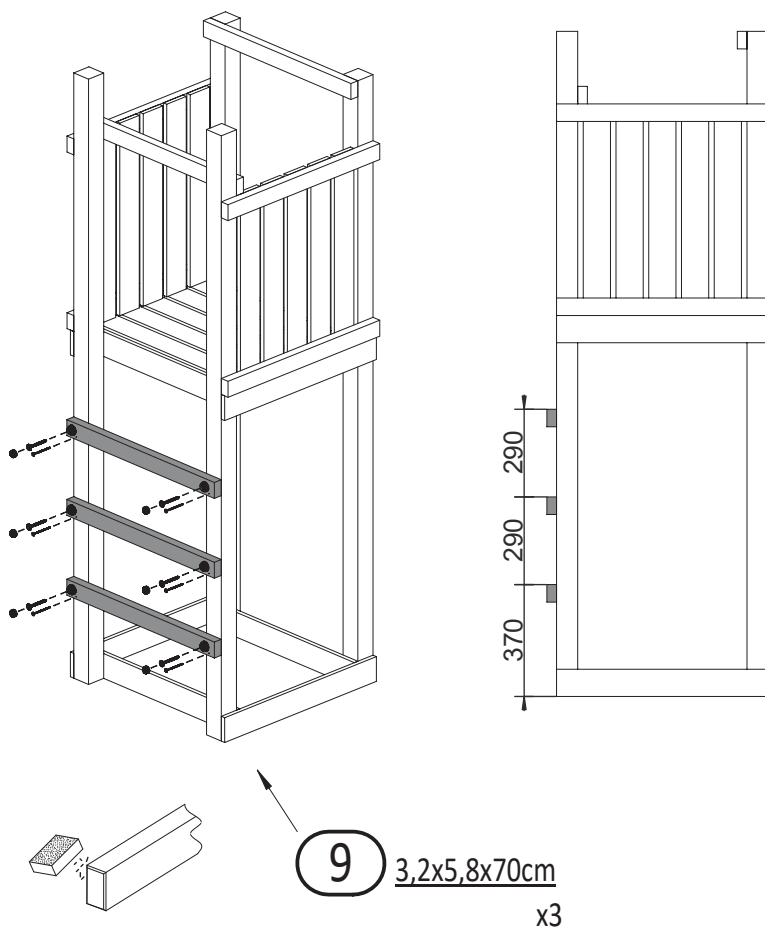

OS1 x6



W80 x6

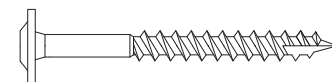

T80 x6

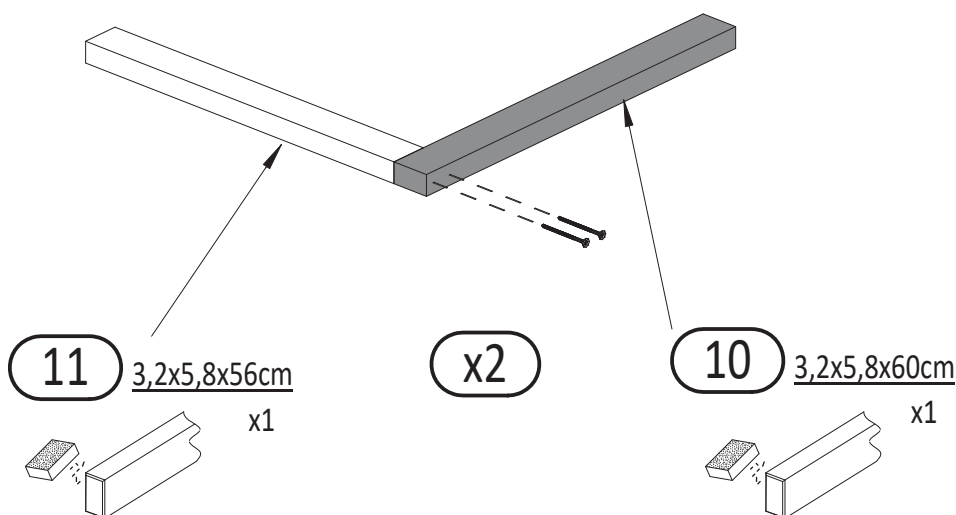
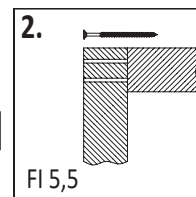
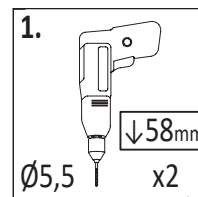

W80 x2\*2=4

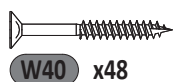
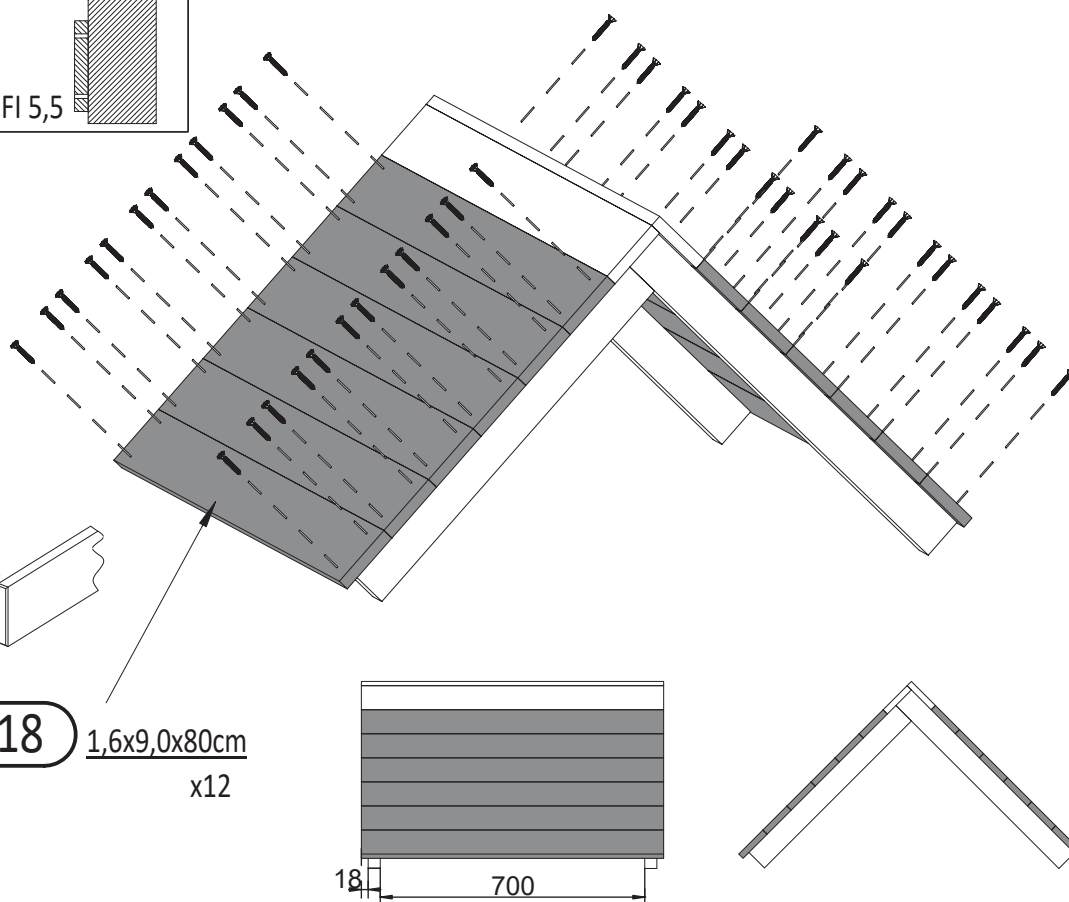
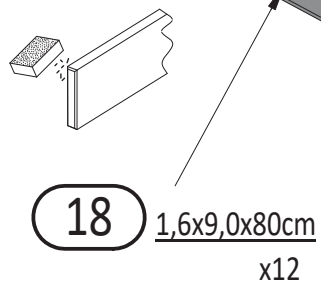
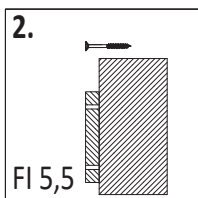
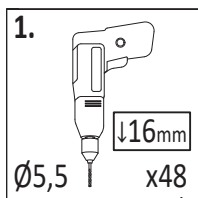
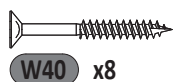
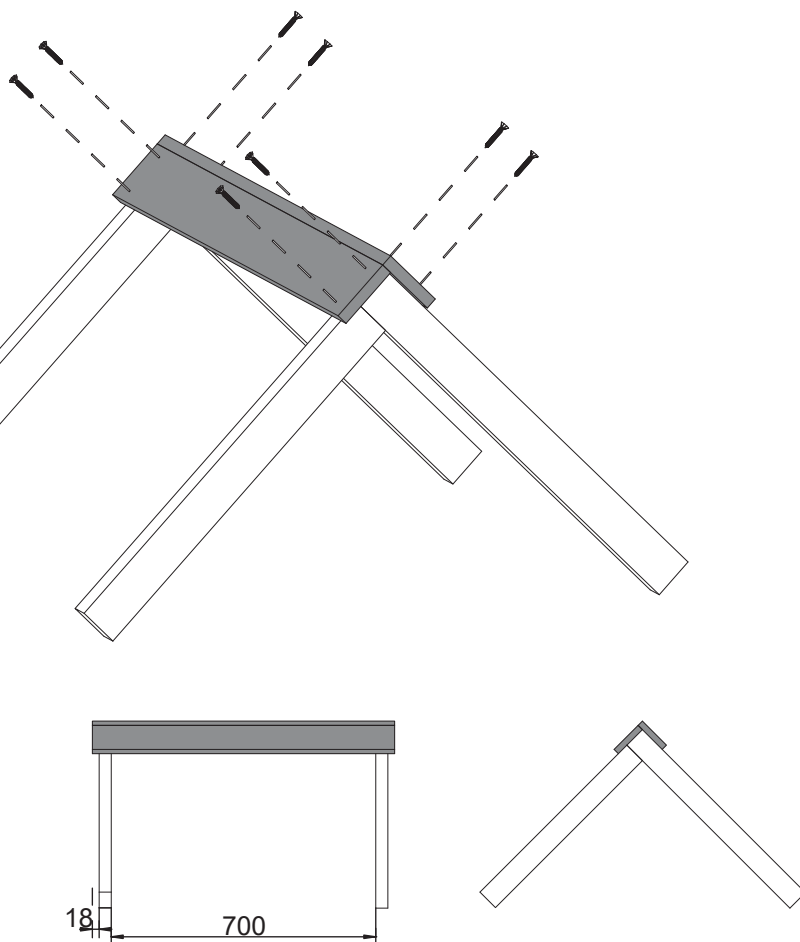
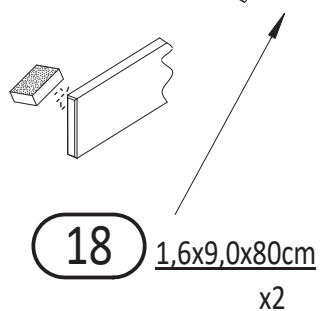
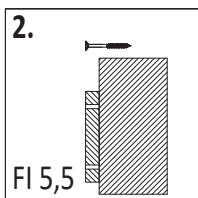
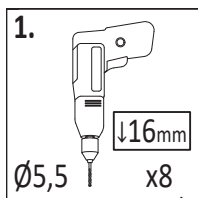

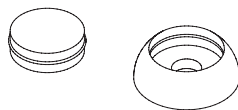
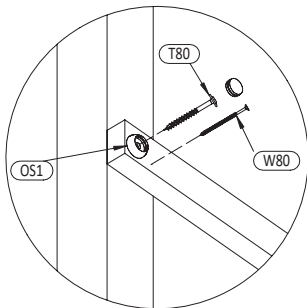
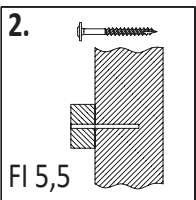
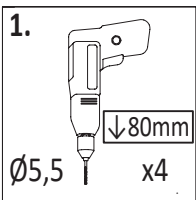
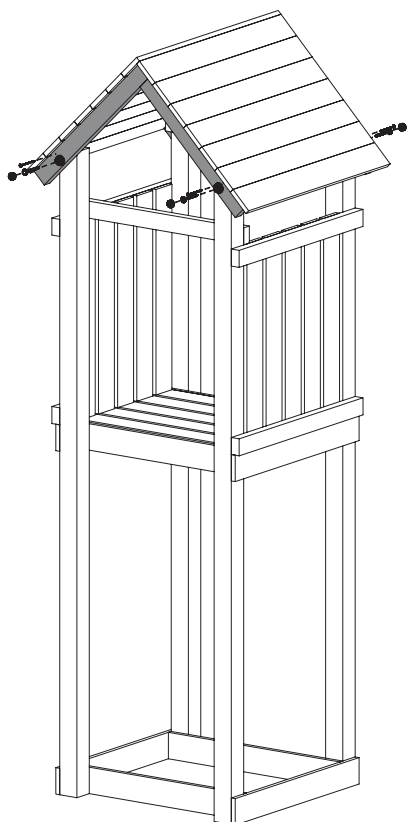

OS1   x4



W80   x4



T80   x4

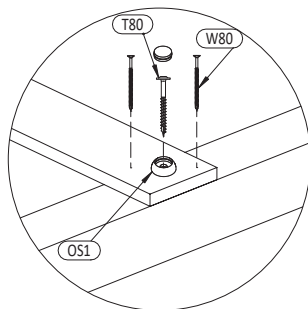
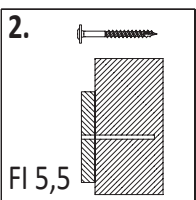
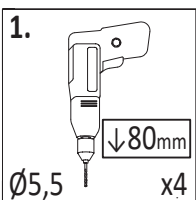
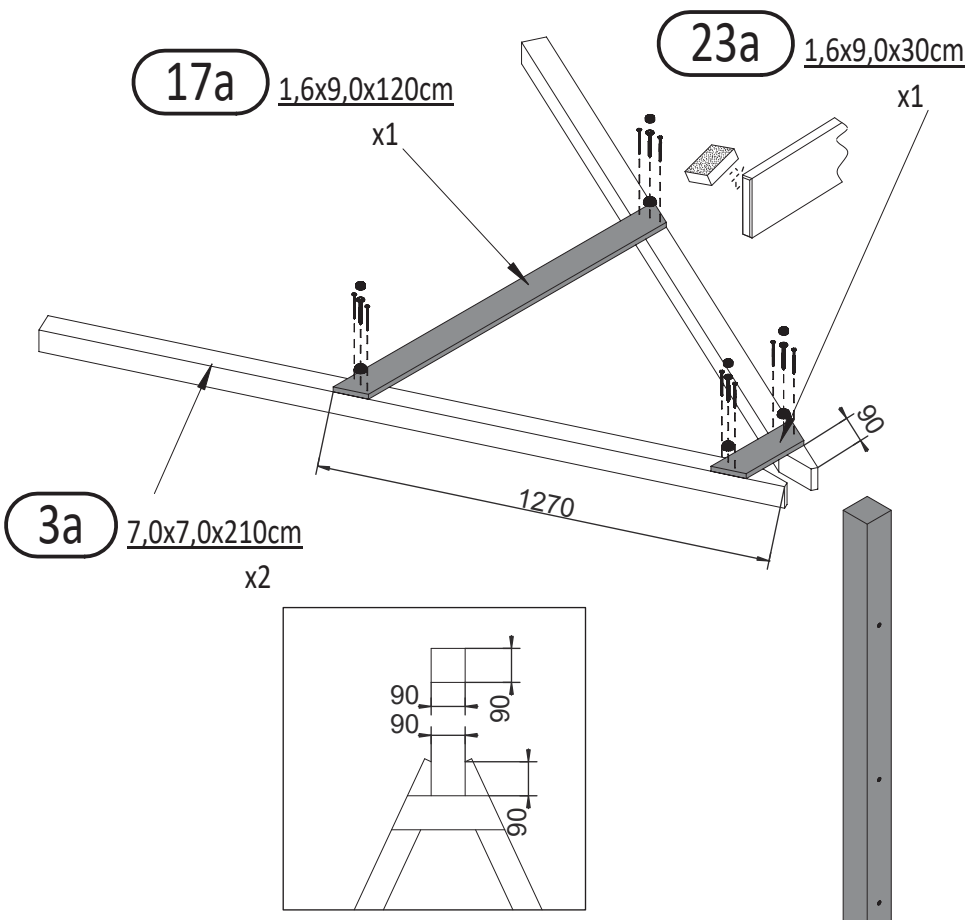

OS1   x4



W80   x8

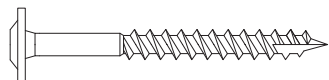

T80   x4

37

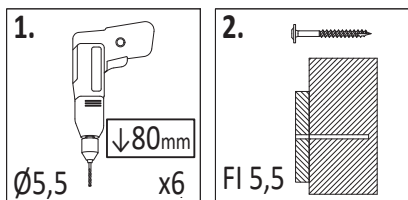

OS1 x2



P17 x4

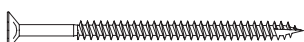

W80 x8

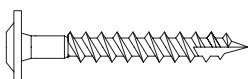

T60 x4

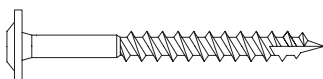

T80 x2

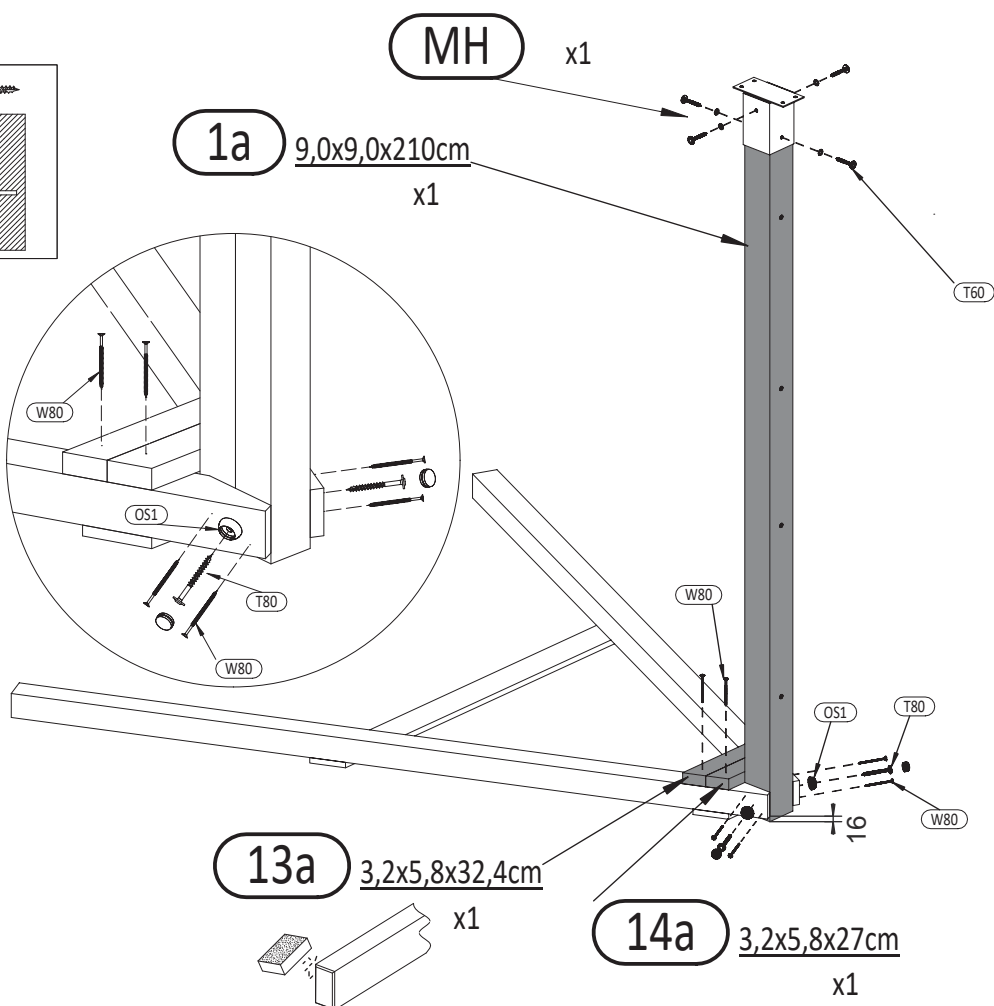

38

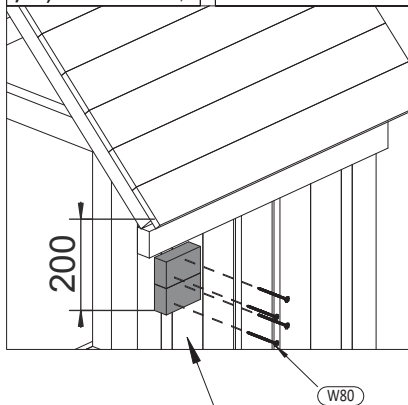
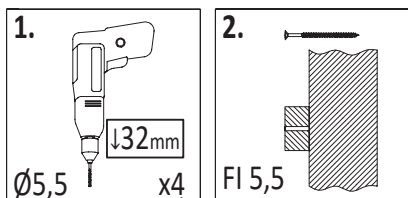

16 3,2x5,8x10cm x2



P17 x4

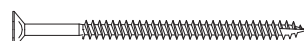

W80 x8

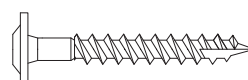

T60 x4

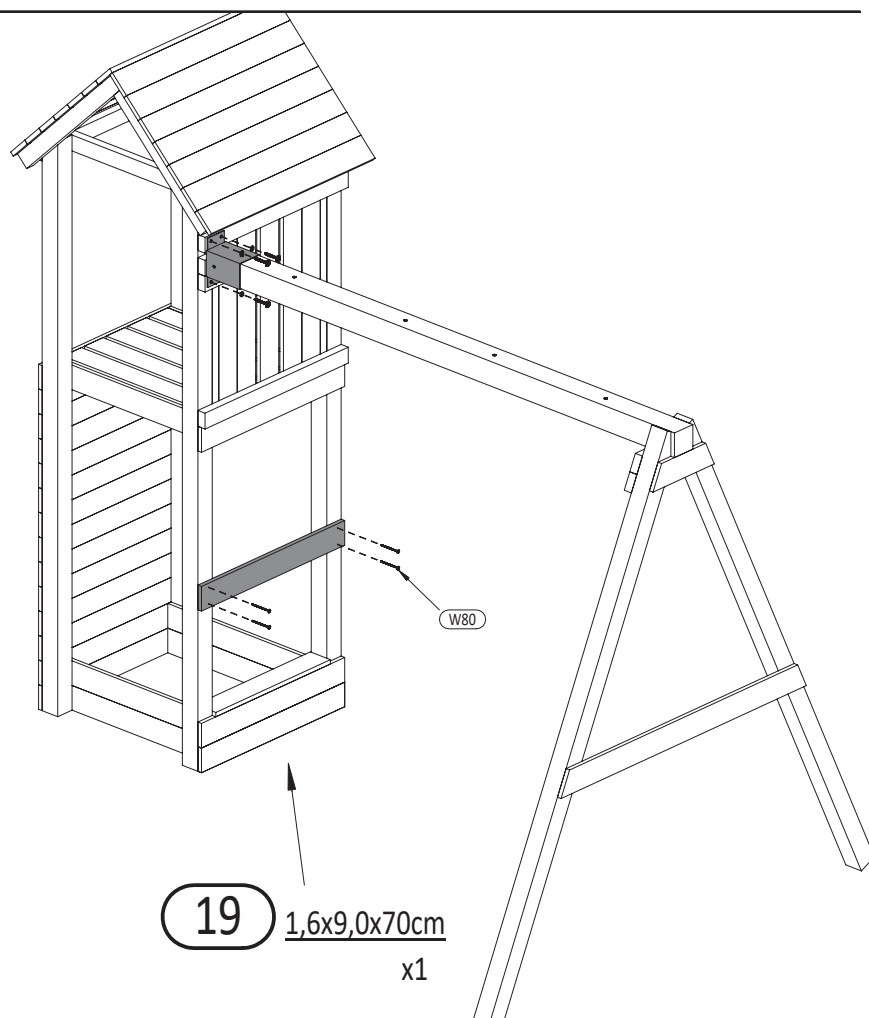

24

Zgodnie z normą PN-EN 71 stosuj zalecenia producenta odnośnie odległości oraz metody mocowania poszczególnych elementów

In compliance with the standard PN-EN 71, apply guidelines of the producer in relation to distances and methods of fastening individual elements

Maxi Funny Optimizer

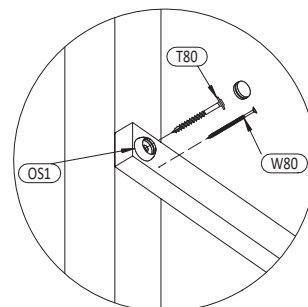
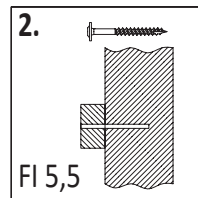
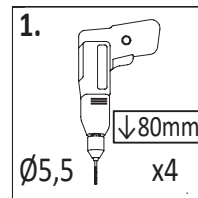

OS1 x4



W80 x4



T80 x4

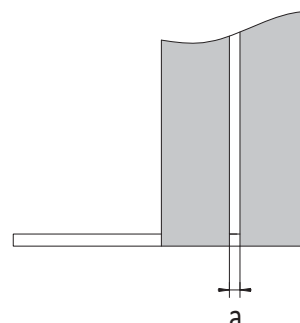
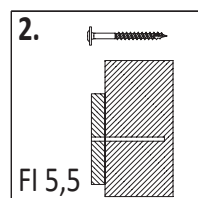
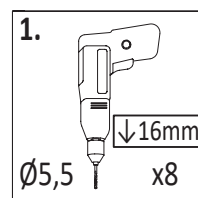
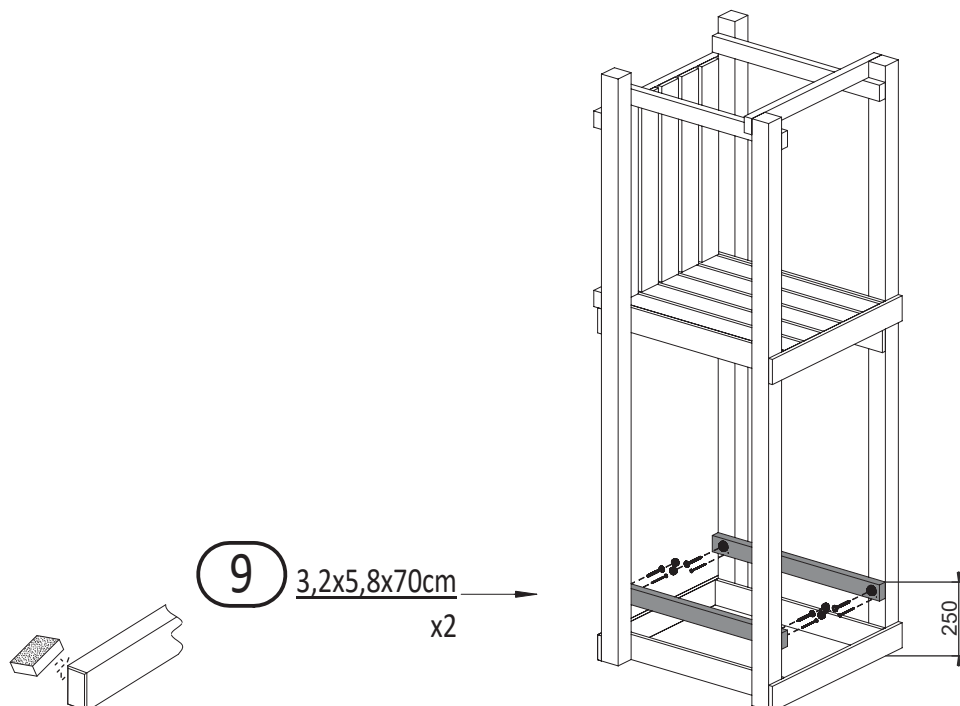

!!!min 13mm < a < !!!max 23mm

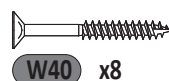
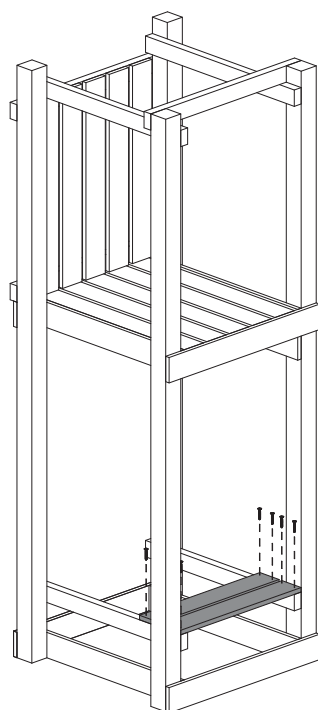
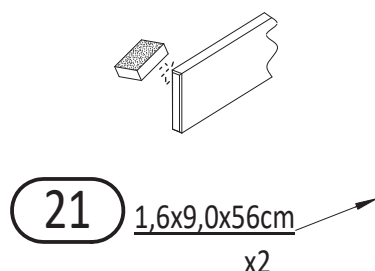

W40 x8

41

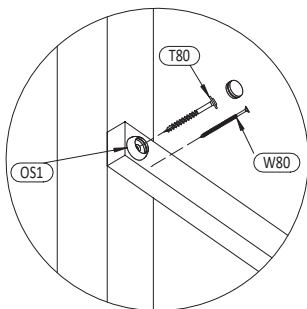
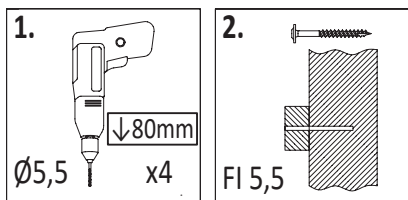

OS1 x4



W80 x4

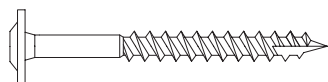

T80 x4

9 3,2x5,8x70cm  
x2

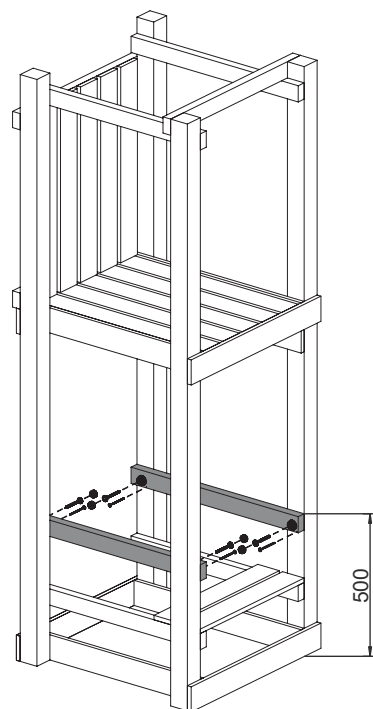

42

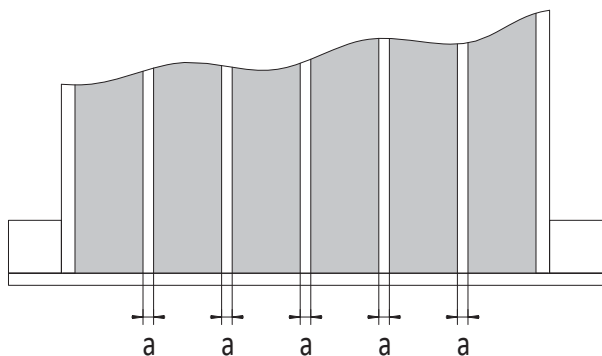
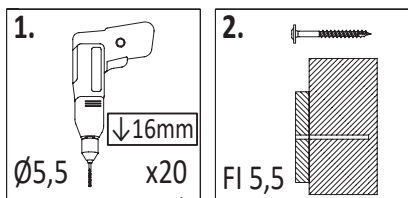

!!!min 13mm < a < !!!max 23mm



W40 x20

21 1,6x9,0x56cm  
x5

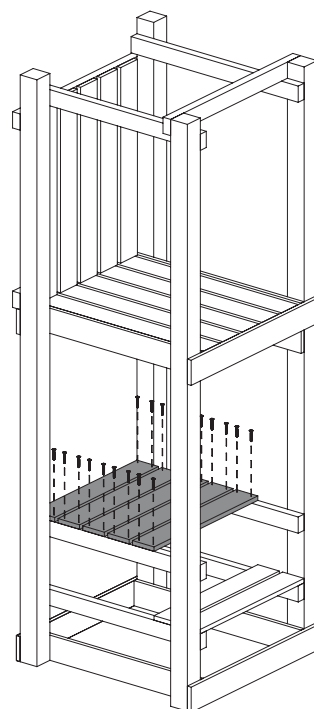

26

Zgodnie z normą PN-EN 71 stosuj zalecenia producenta odnośnie odległości oraz metody mocowania poszczególnych elementów

In compliance with the standard PN-EN 71, apply guidelines of the producer in relation to distances and methods of fastening individual elements

Maxi Funny Optimizer

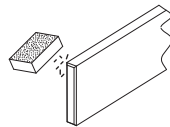
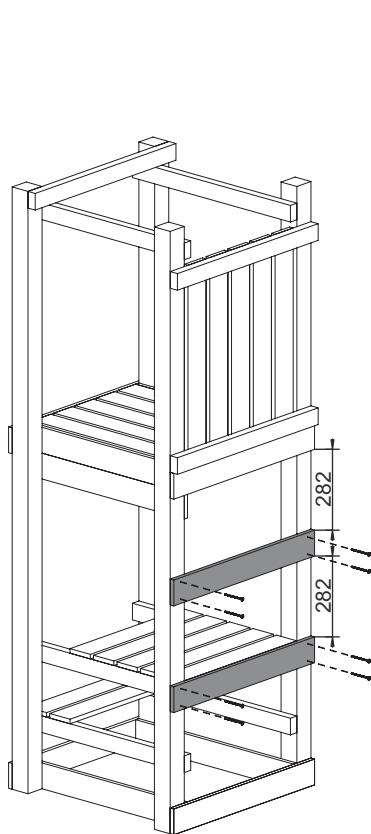

19

1,6x9,0x70cm  
x2

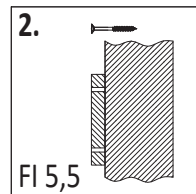
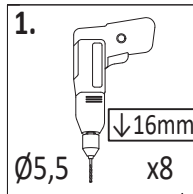

43

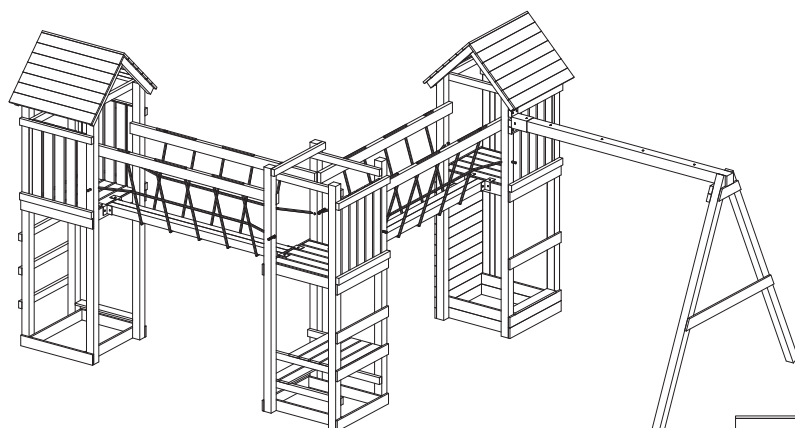
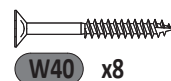

44

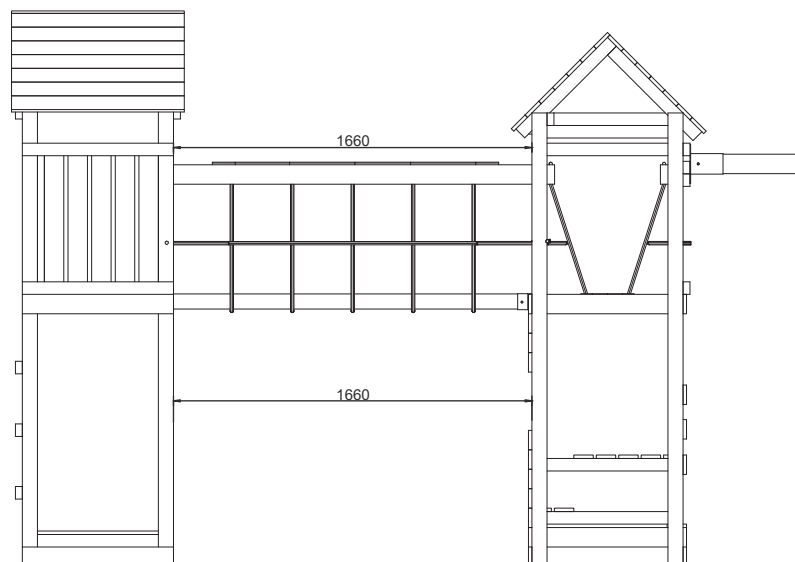

Zgodnie z normą PN-EN 71 stosuj zalecenia producenta odnośnie odległości oraz metody mocowania poszczególnych elementów

In compliance with the standard PN-EN 71, apply guidelines of the producer in relation to distances and methods of fastening individual elements

27

Maxi Funny Optimizer

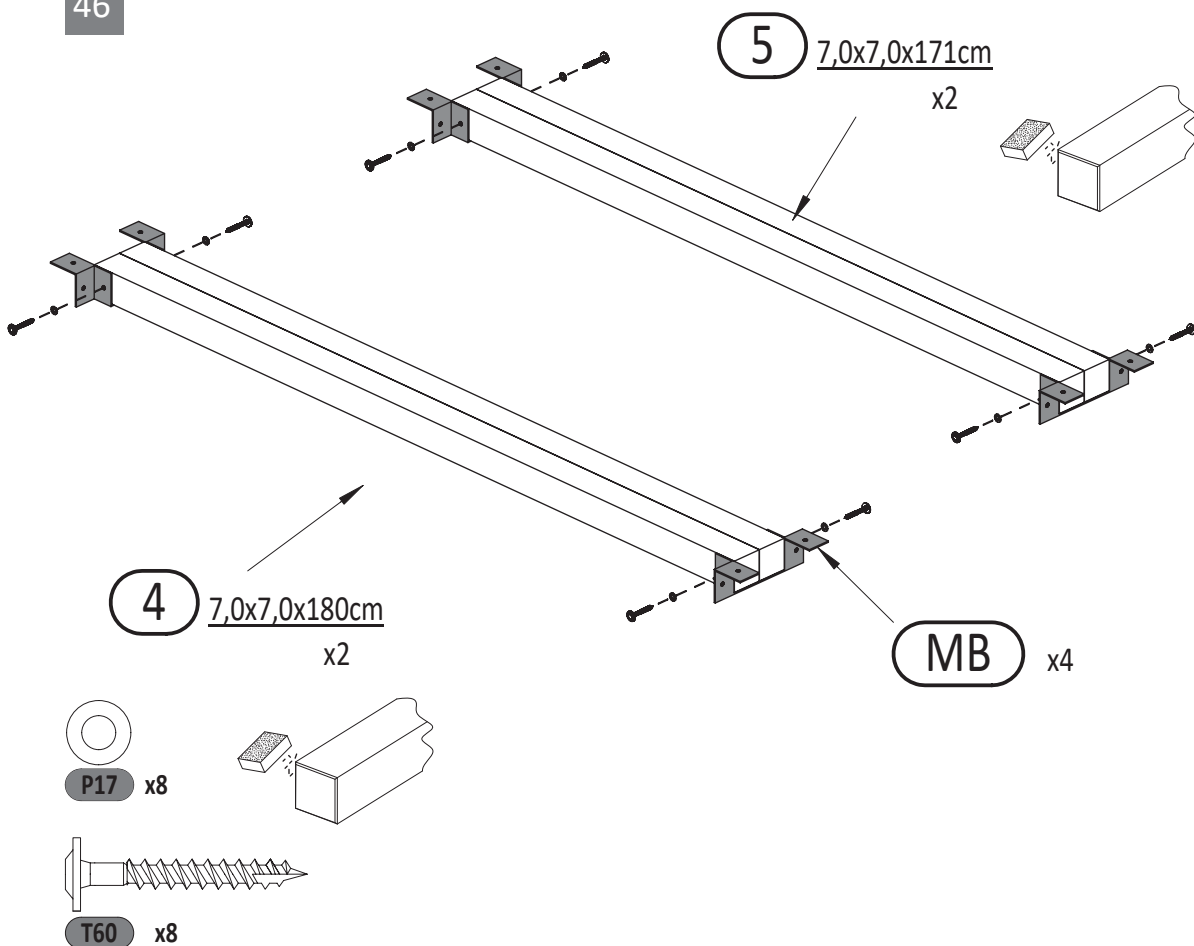
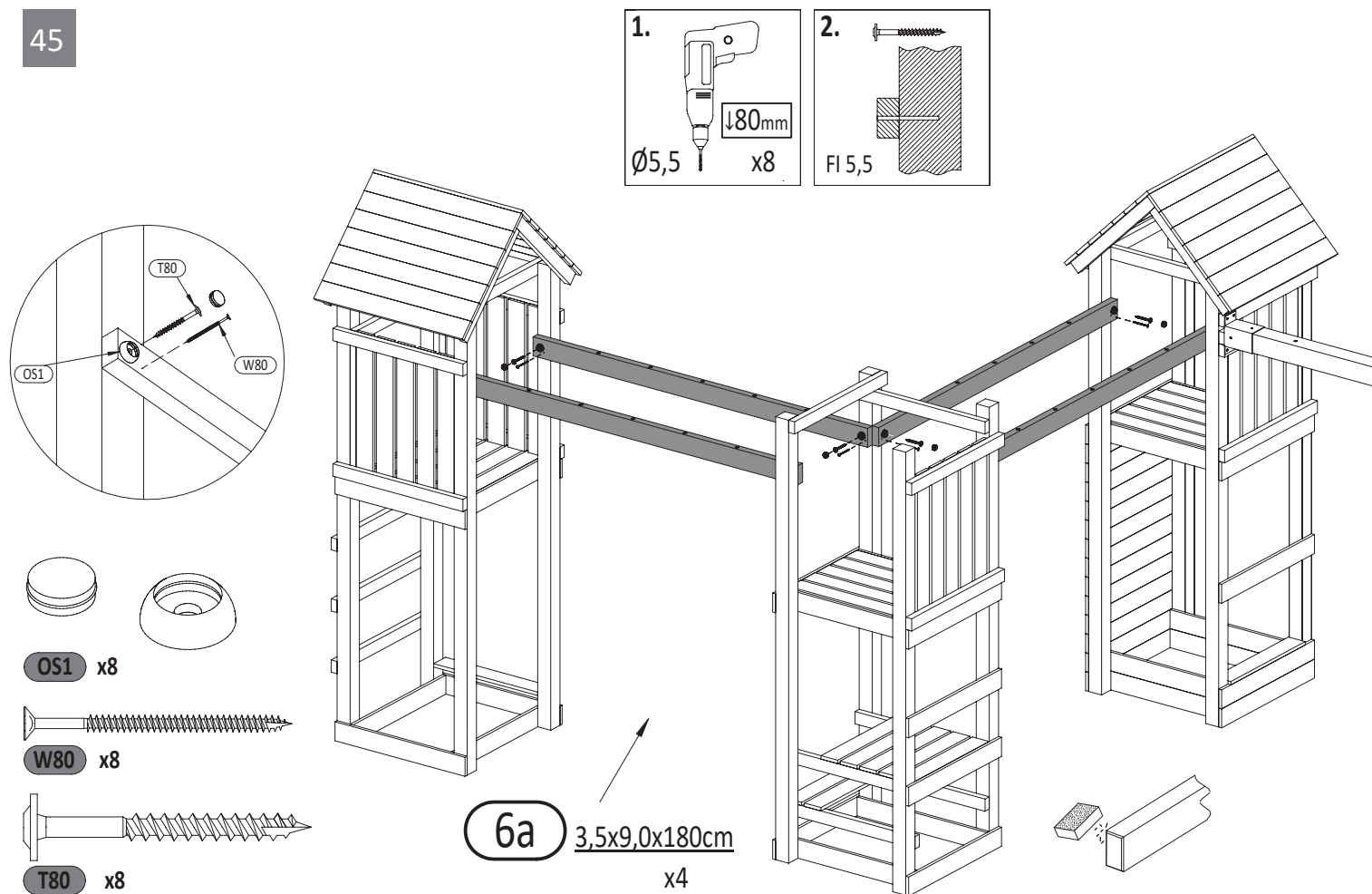

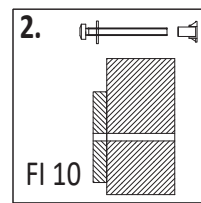
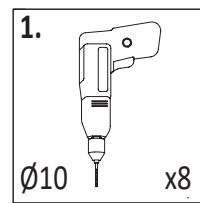
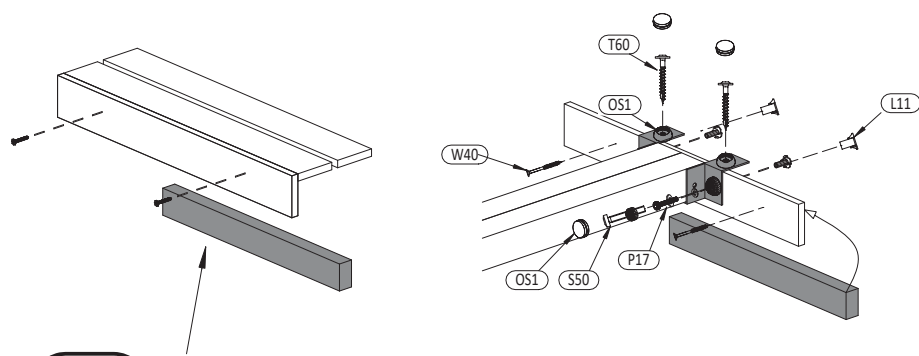

**12** 3,2x5,8x52,8cm  
x3

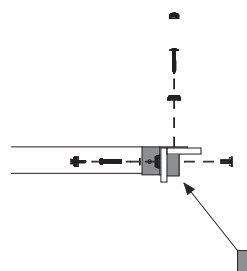
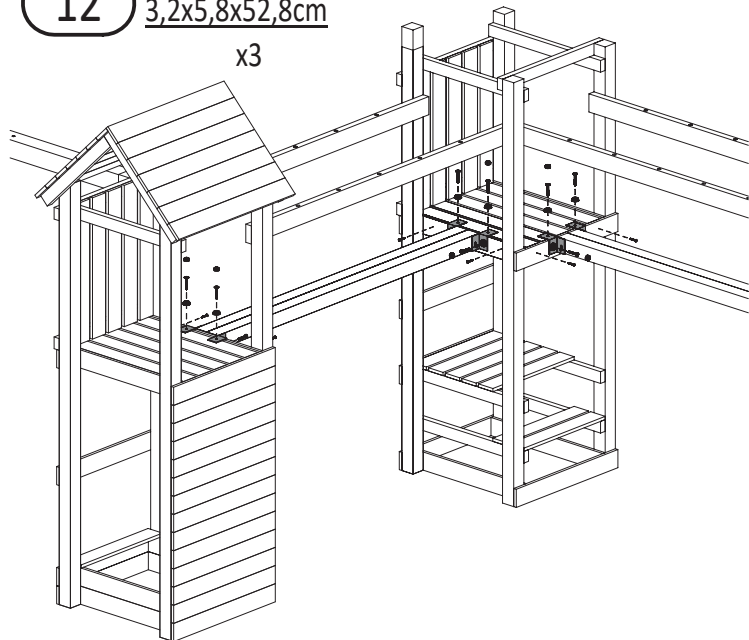

**OS1** x16

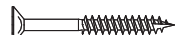

**W40** x6

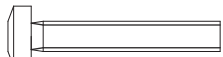

**S50** x8



**P17** x8



**L11** x8

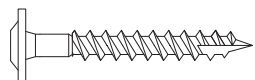

**T60** x8

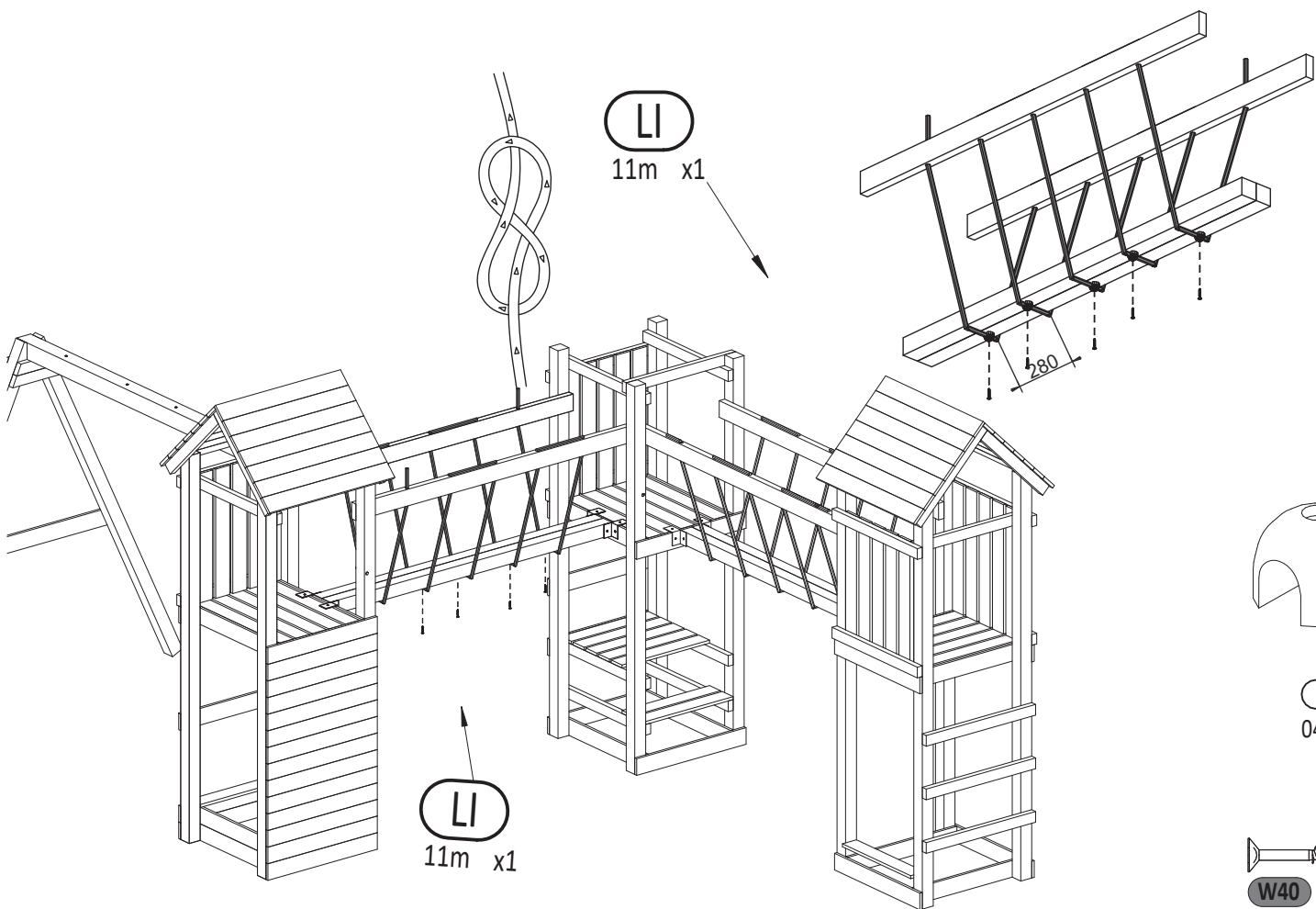

**LI**  
11m x1

**LI**  
11m x1

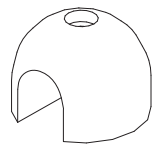

**KS**  
04789  
x10

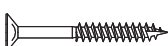

**W40** x10

Zgodnie z normą PN-EN 71 stosuj zalecenia producenta odnośnie odległości oraz metody mocowania poszczególnych elementów

In compliance with the standard PN-EN 71, apply guidelines of the producer in relation to distances and methods of fastening individual elements

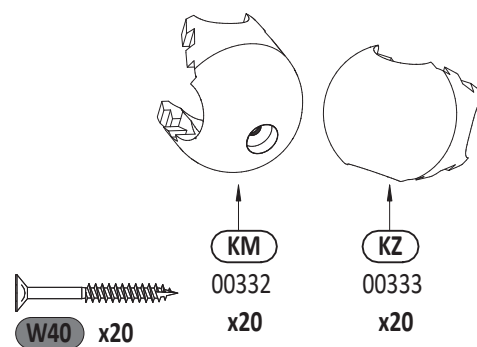
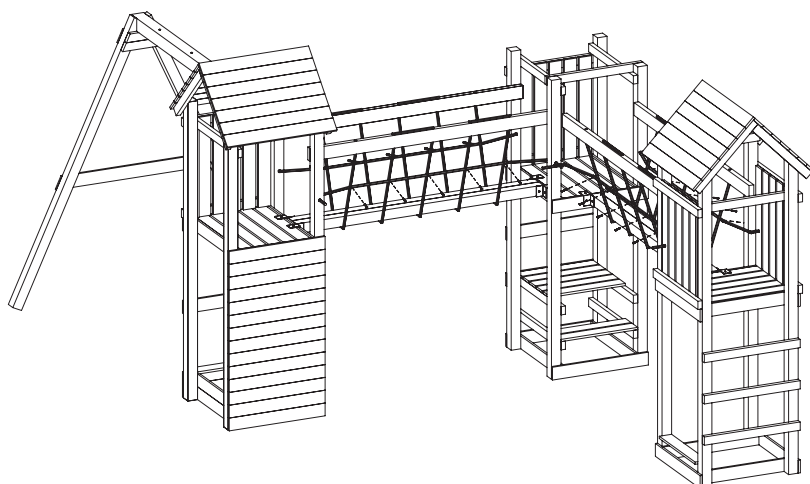
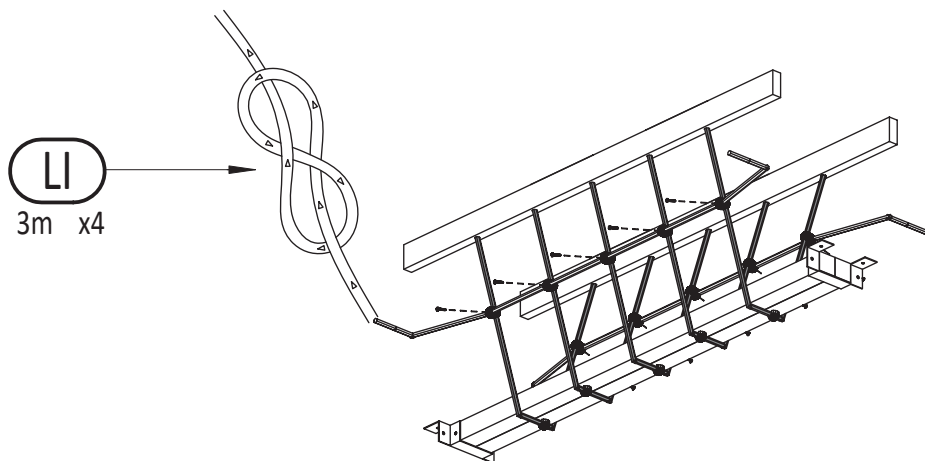
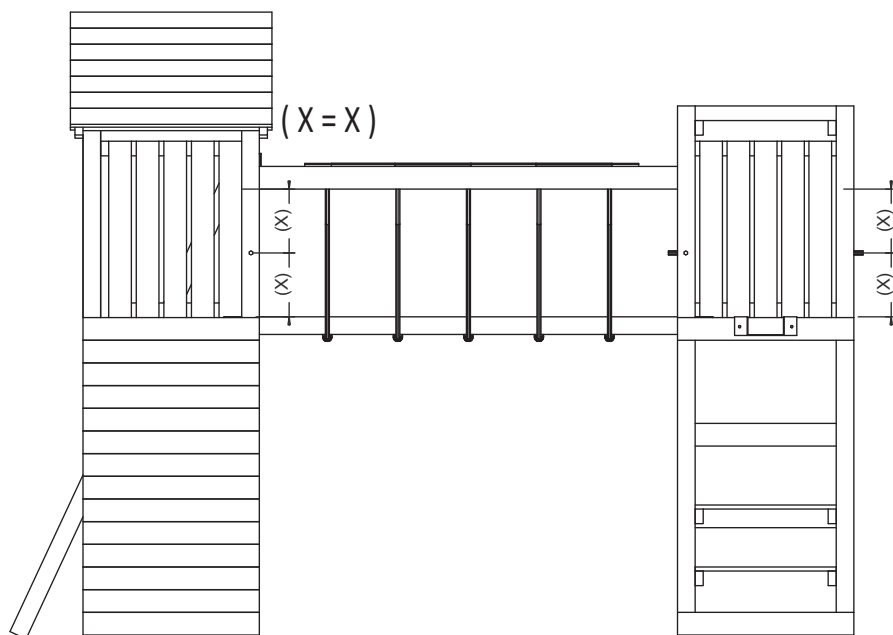
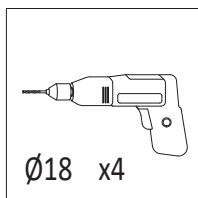

19 1,6x9,0x70cm

x10

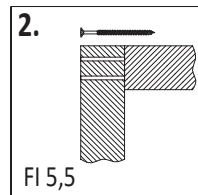
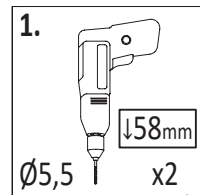
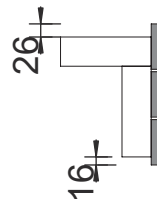
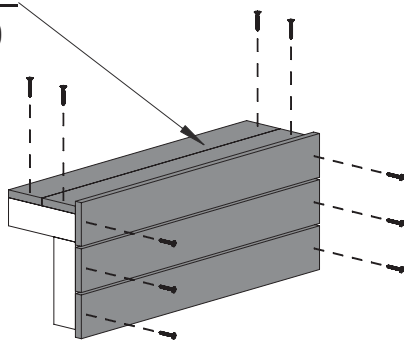
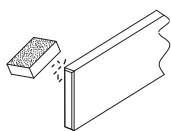

51

!! x4

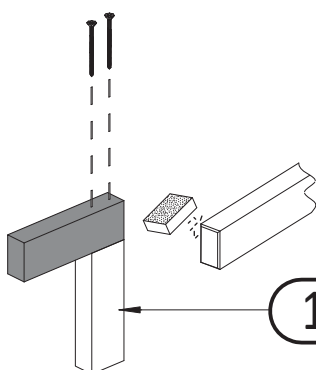

15 3,2x5,8x18cm

x2

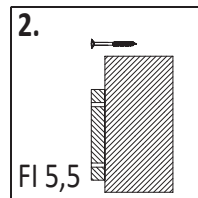
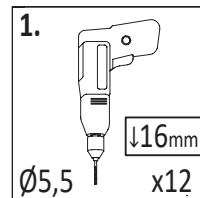
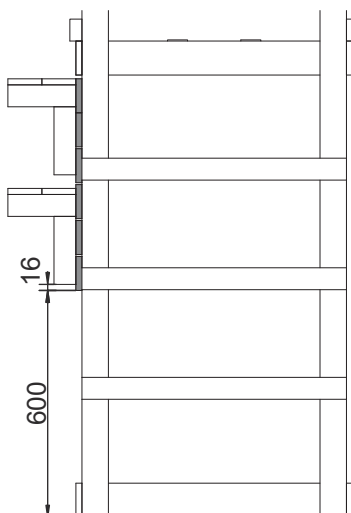
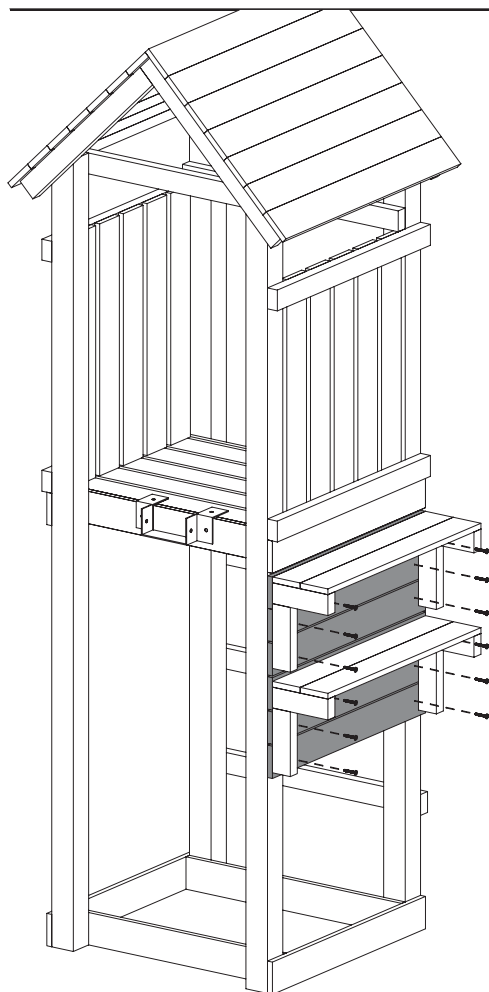
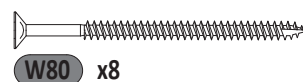
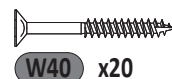
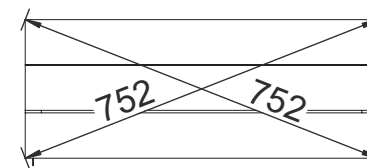
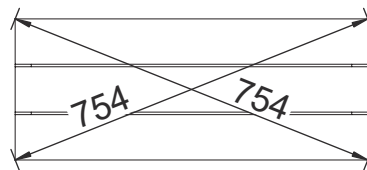
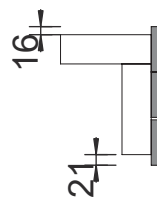
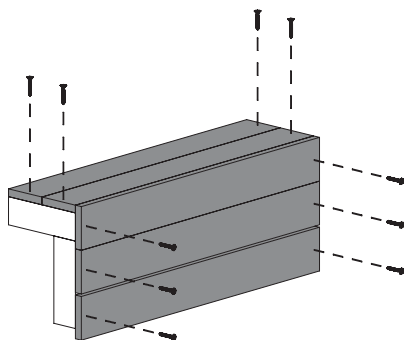

52

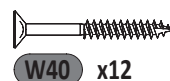

Zgodnie z normą PN-EN 71 stosuj zalecenia producenta odnośnie odległości oraz metody mocowania poszczególnych elementów

In compliance with the standard PN-EN 71, apply guidelines of the producer in relation to distances and methods of fastening individual elements

31

Maxi Funny Optimizer

53

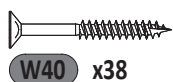
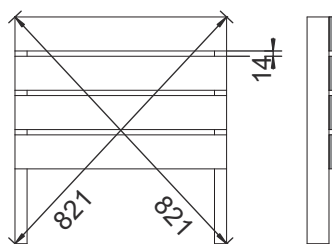
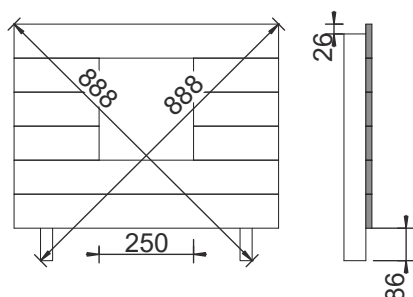
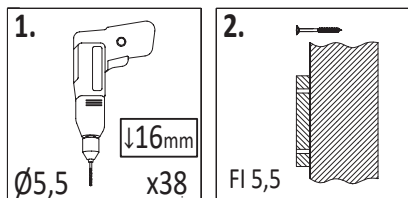

24

1,6x9,0x22,5cm

x6

19

1,6x9,0x70cm

x3

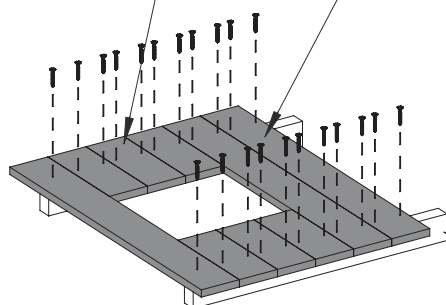

10

3,2x5,8x60cm

x2

21

1,6x9,0x56cm

x4

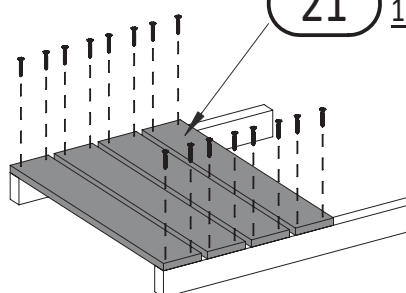

10

3,2x5,8x60cm

x2

54

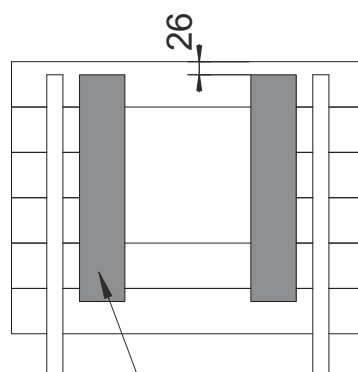
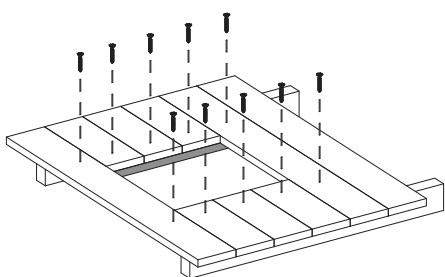
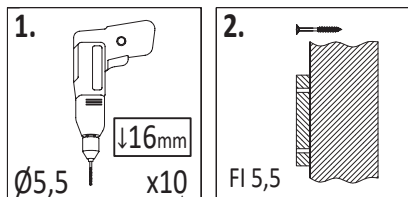

22

1,6x9,0x45cm

x2

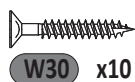
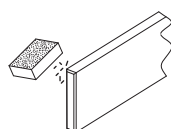

32

Zgodnie z normą PN-EN 71 stosuj zalecenia producenta odnośnie odległości oraz metody mocowania poszczególnych elementów

In compliance with the standard PN-EN 71, apply guidelines of the producer in relation to distances and methods of fastening individual elements

Maxi Funny Optimizer

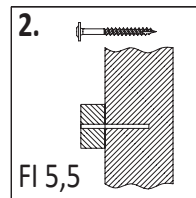
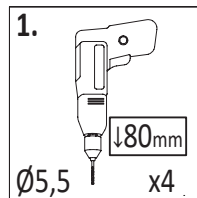
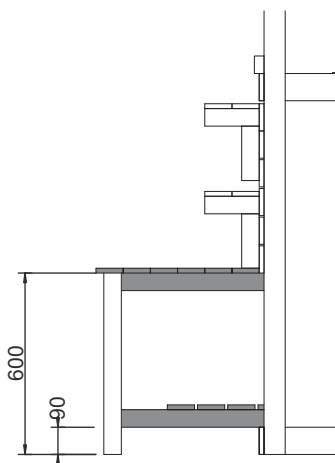
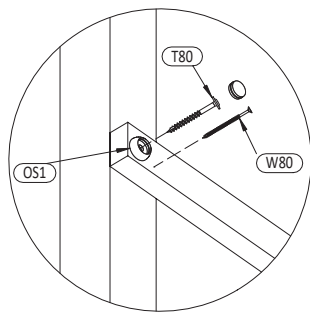
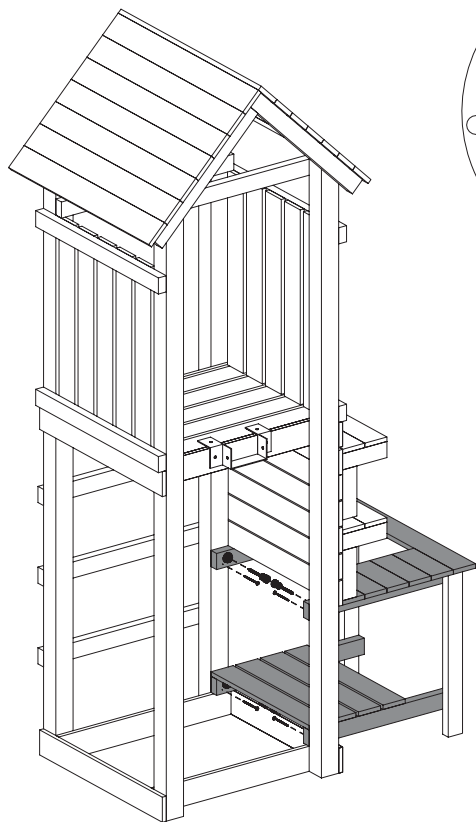

55

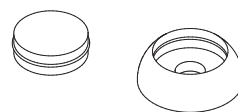

OS1 x4



W80 x4



T80 x4

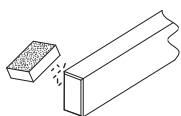
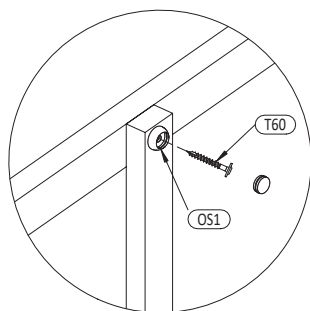

10 3,2x5,8x60cm x2

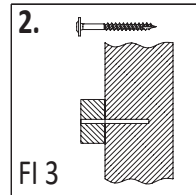
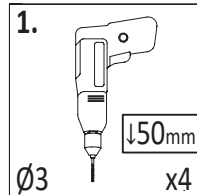
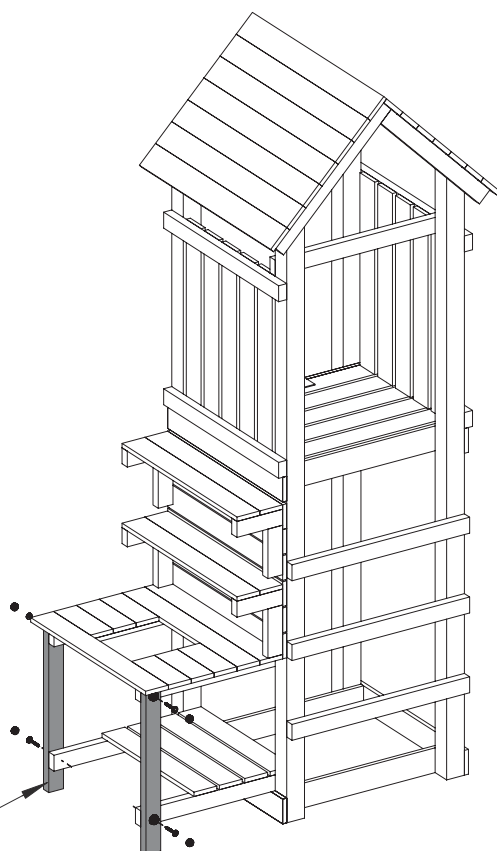

56



OS1 x4

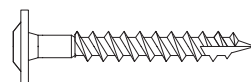

T60 x4

57

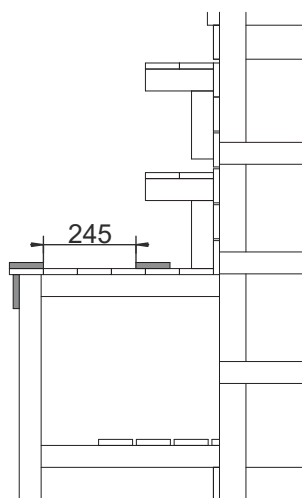
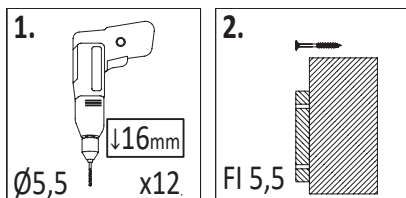

19  $1,6 \times 9,0 \times 70\text{cm}$   
 x3

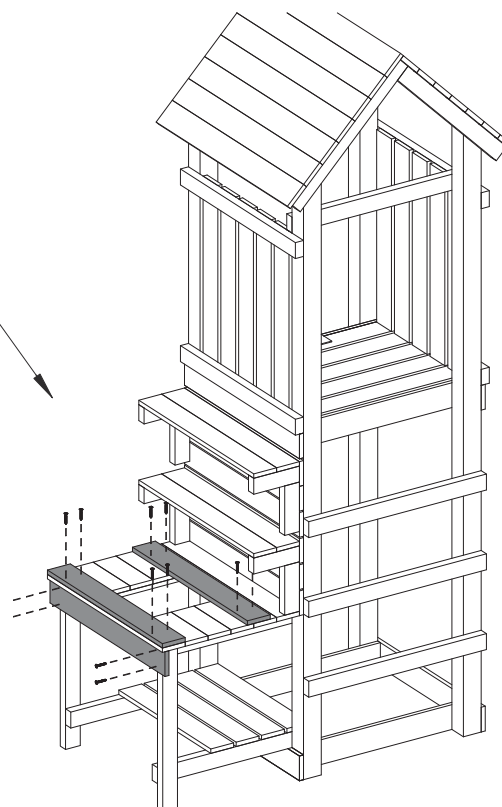
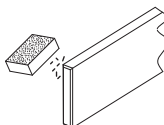

W40 x12

58

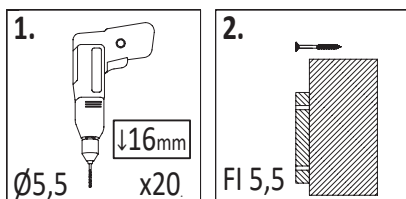

19  $1,6 \times 9,0 \times 70\text{cm}$   
 x4

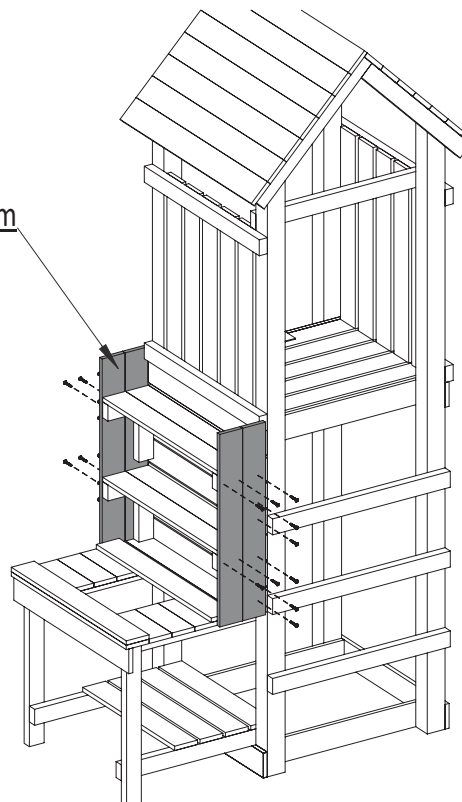
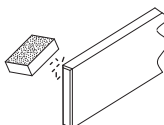

W40 x20

34

Zgodnie z normą PN-EN 71 stosuj zalecenia producenta odnośnie odległości oraz metody mocowania poszczególnych elementów

In compliance with the standard PN-EN 71, apply guidelines of the producer in relation to distances and methods of fastening individual elements

Maxi Funny Optimizer

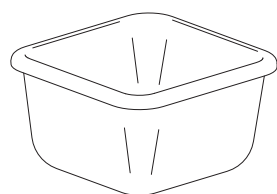

WL x1

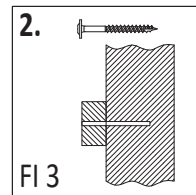
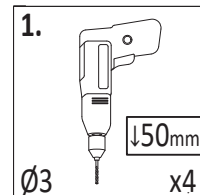
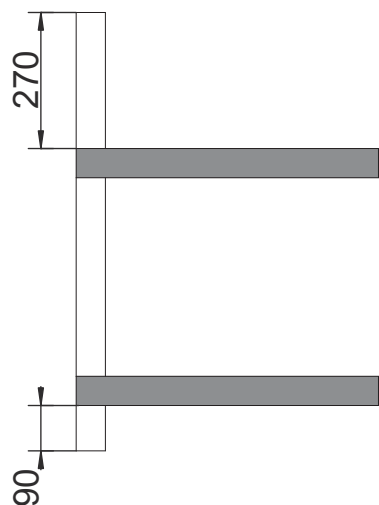
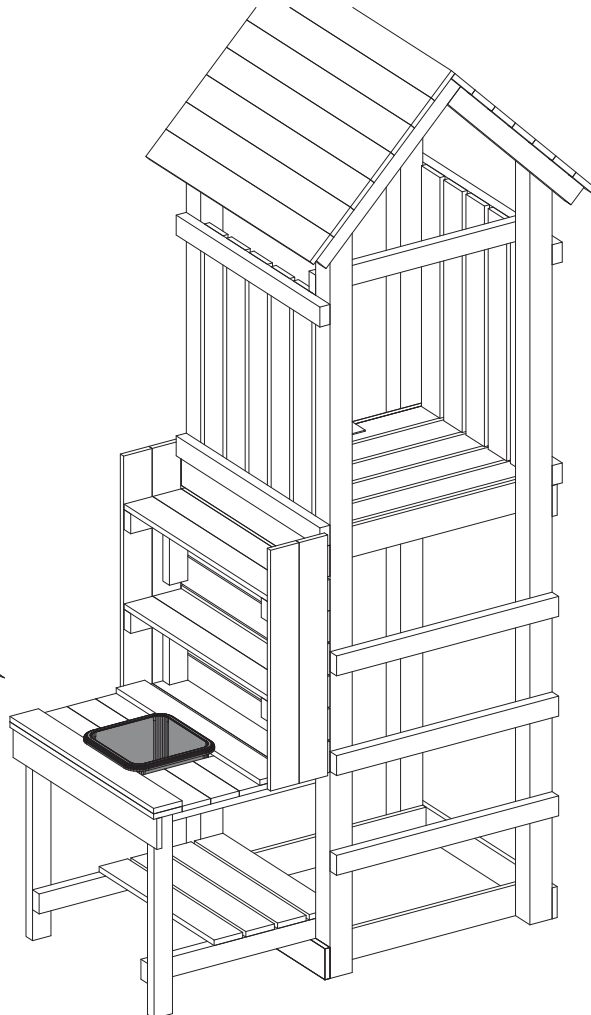

10 3,2x5,8x60cm x4

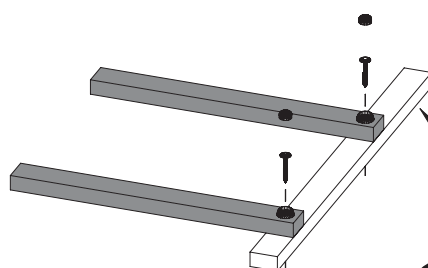
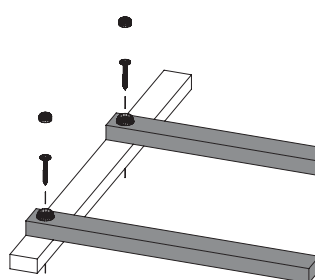
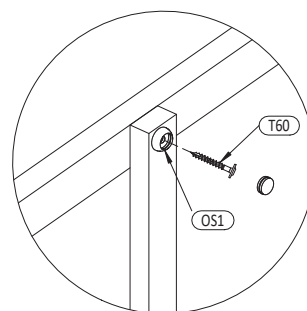

8 3,2x5,8x87cm x2



OS1 x4

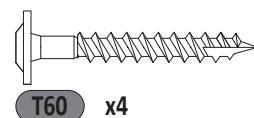

T60 x4

61

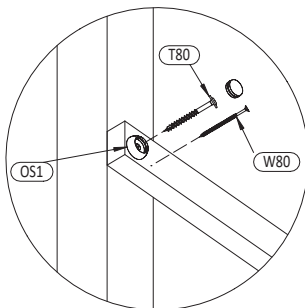
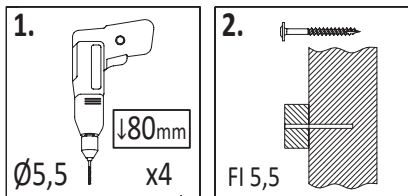

OS1 x4



W80 x4

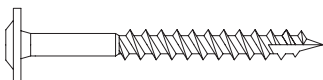

T80 x4

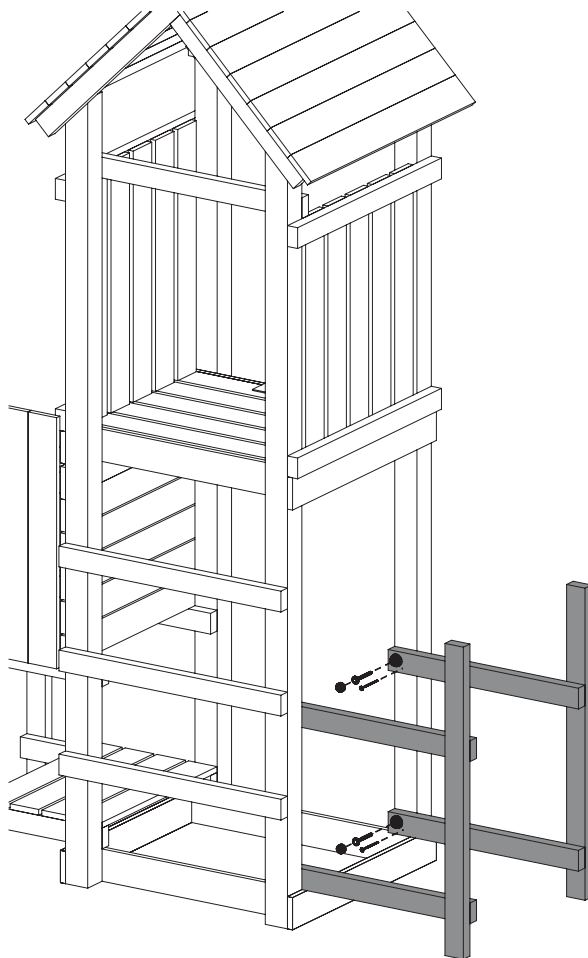

62

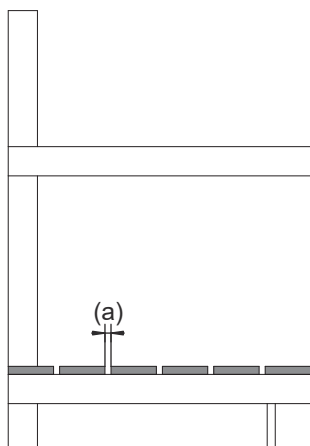
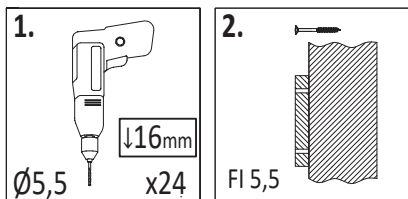

!!!min 13mm < **a** < !!!max 23mm

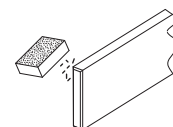
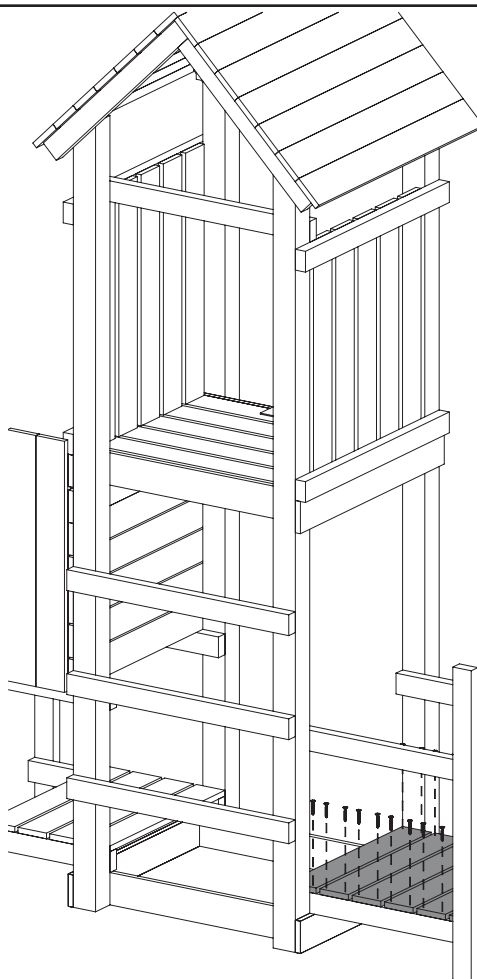

21

1,6x9,0x56cm  
x6

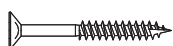

W40 x24

36

Zgodnie z normą PN-EN 71 stosuj zalecenia producenta odnośnie odległości oraz metody mocowania poszczególnych elementów

In compliance with the standard PN-EN 71, apply guidelines of the producer in relation to distances and methods of fastening individual elements

**Maxi Funny Optimizer**

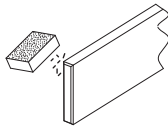
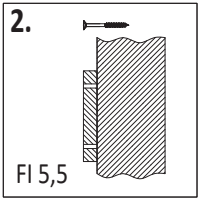
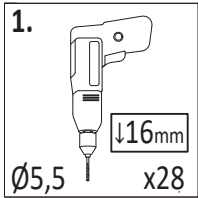
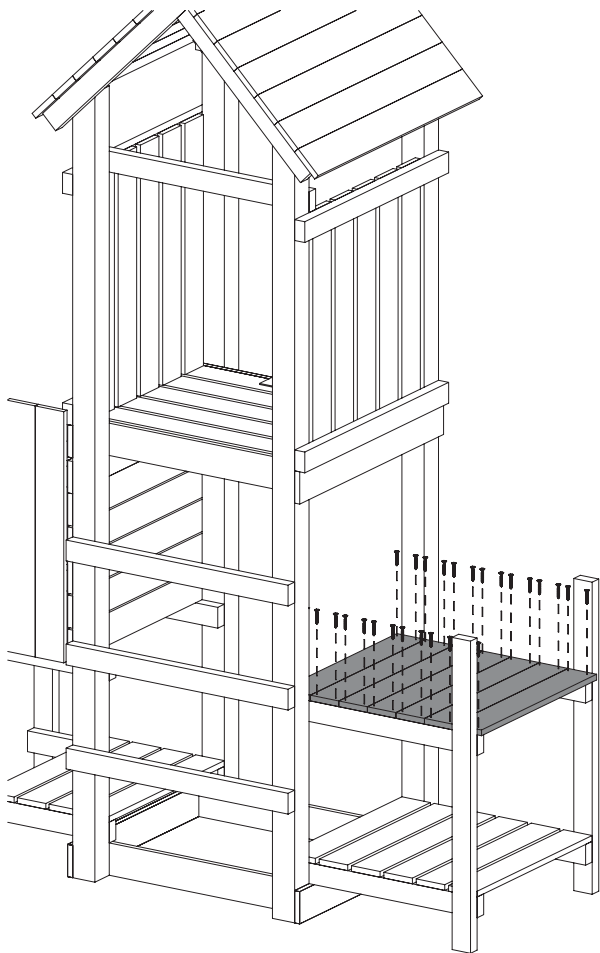

21 1,6x9,0x56cm  
x7

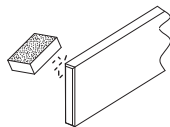
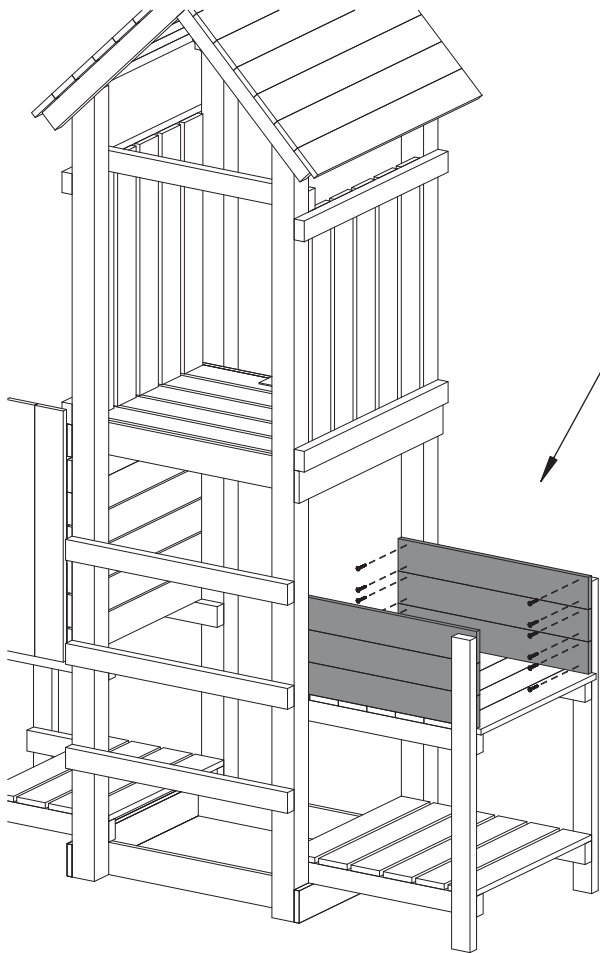
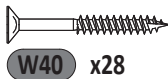
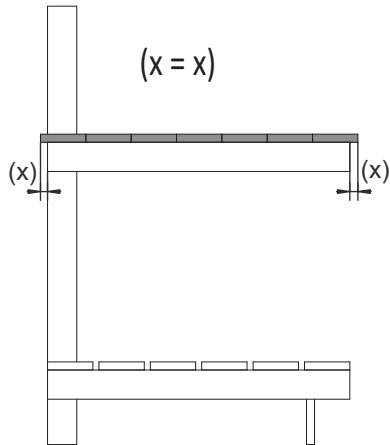

20 1,6x9,0x60cm  
x6

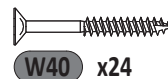
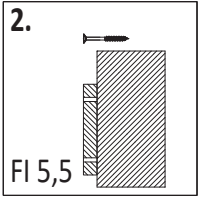
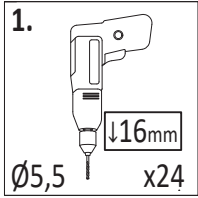

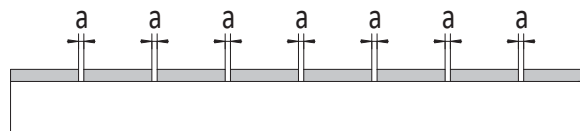
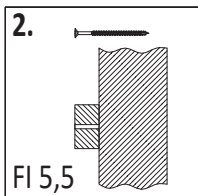
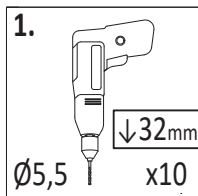
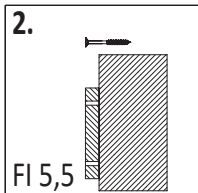
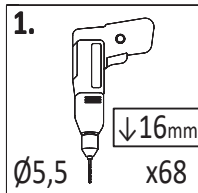
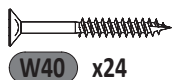
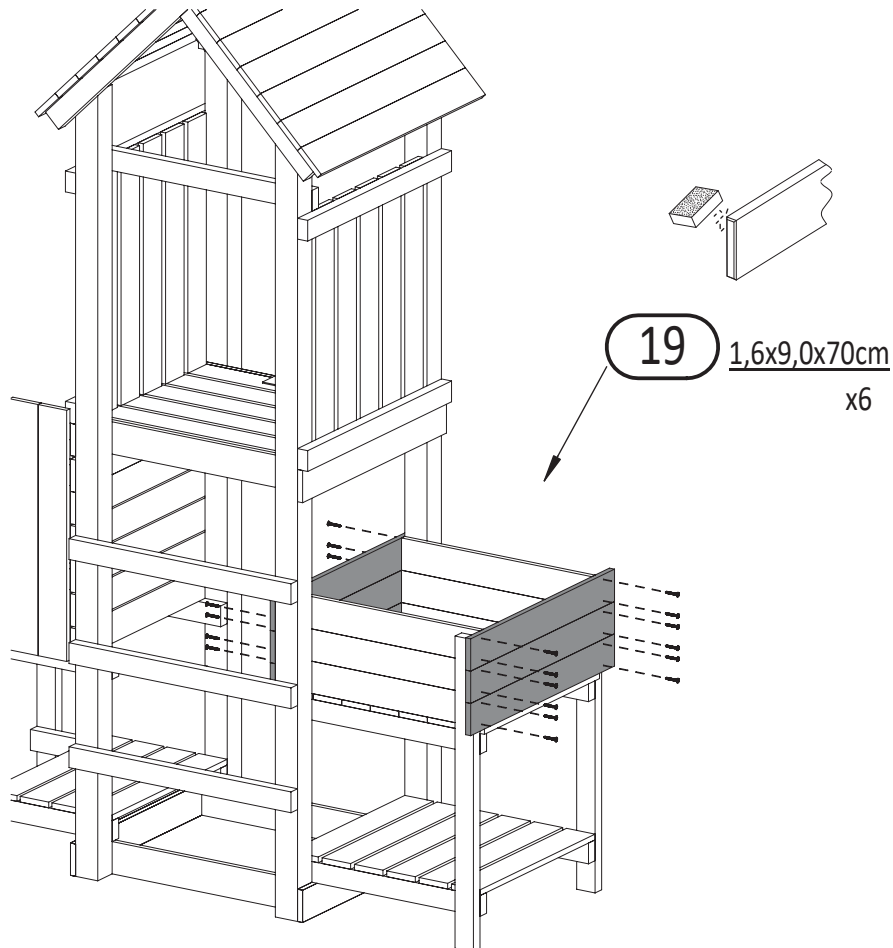
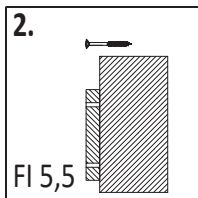
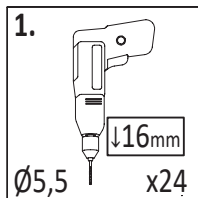

11 3,2x5,8x56cm x5

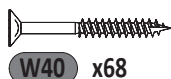
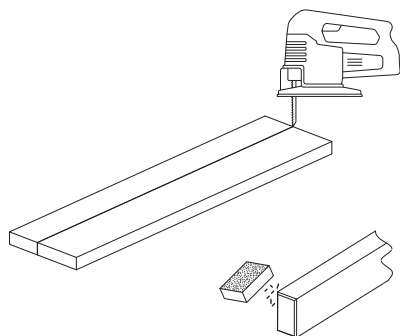
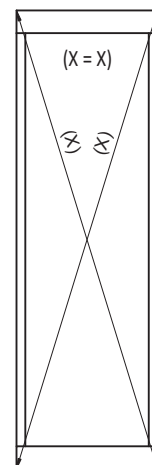
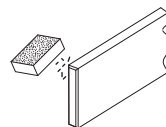

7a 3,5x9,0x180cm x2

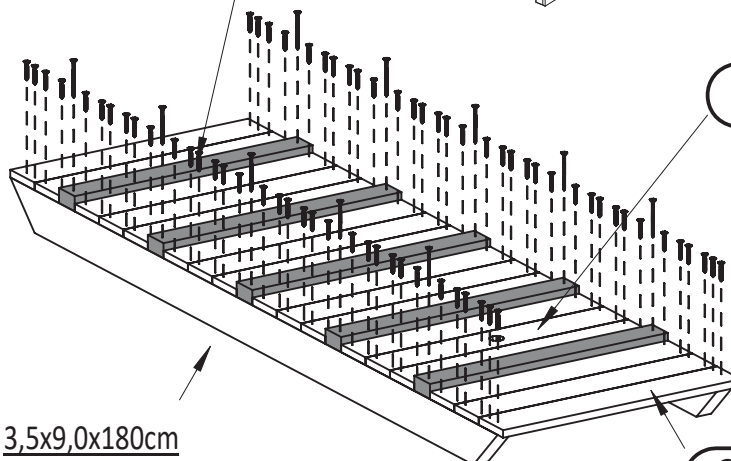

21a 1,6x9,0x56cm x1

21 1,6x9,0x56cm x16

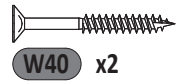
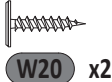
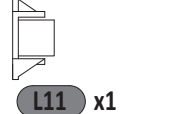
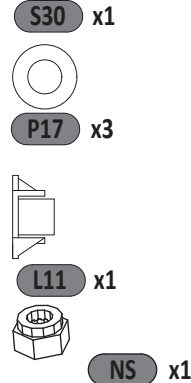
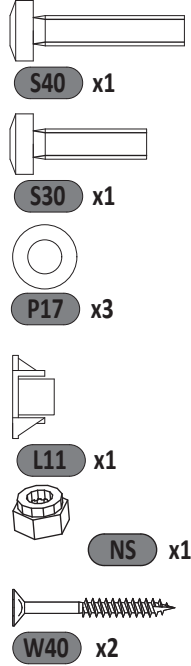
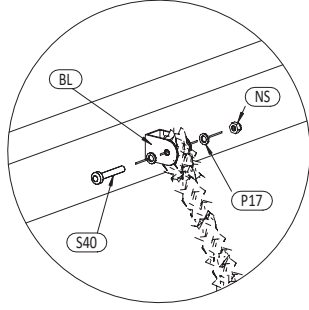
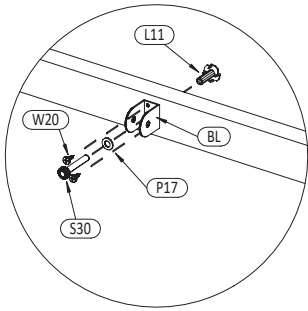
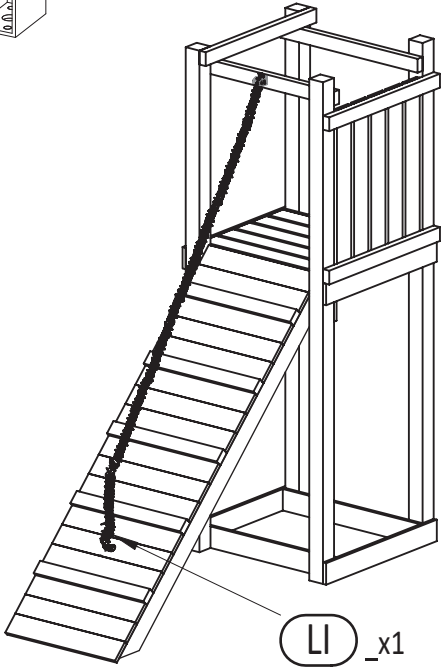
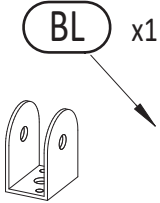
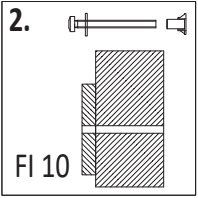
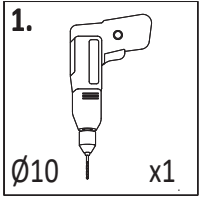
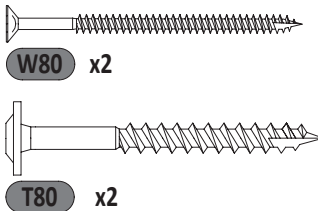
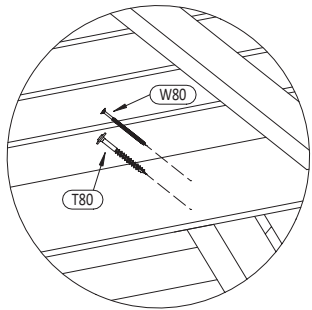
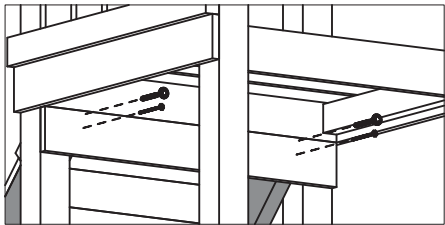
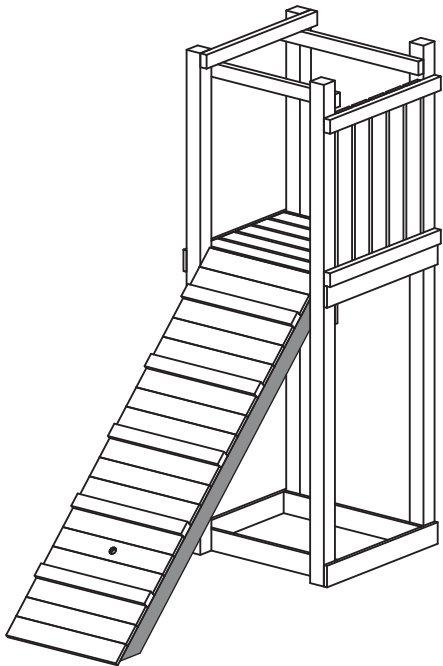
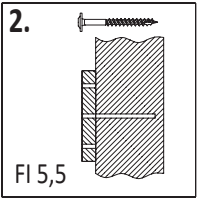
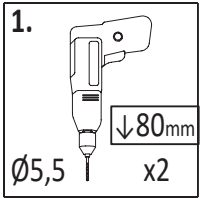

69

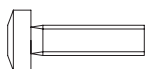
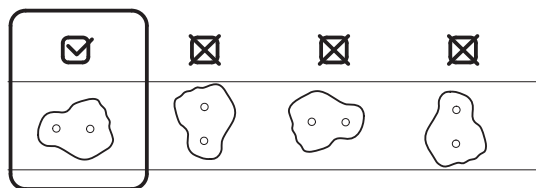
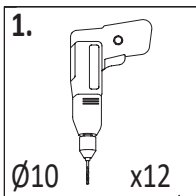

S30 x12



P15 x12



L11 x12

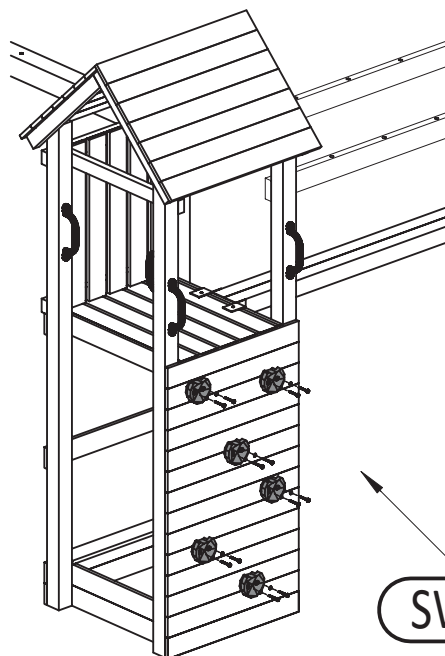
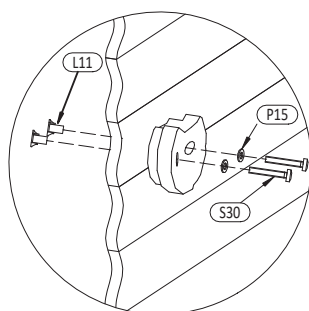

SW \_x6

70

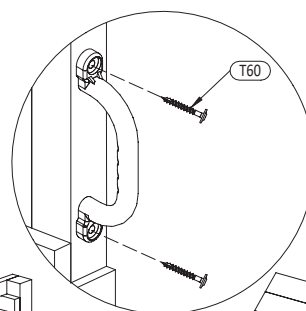
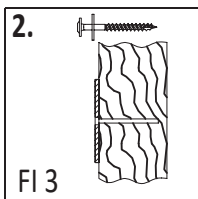
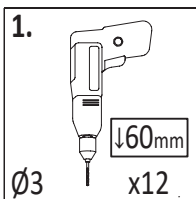

UC \_x2

UC \_x4

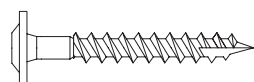

T60 x12

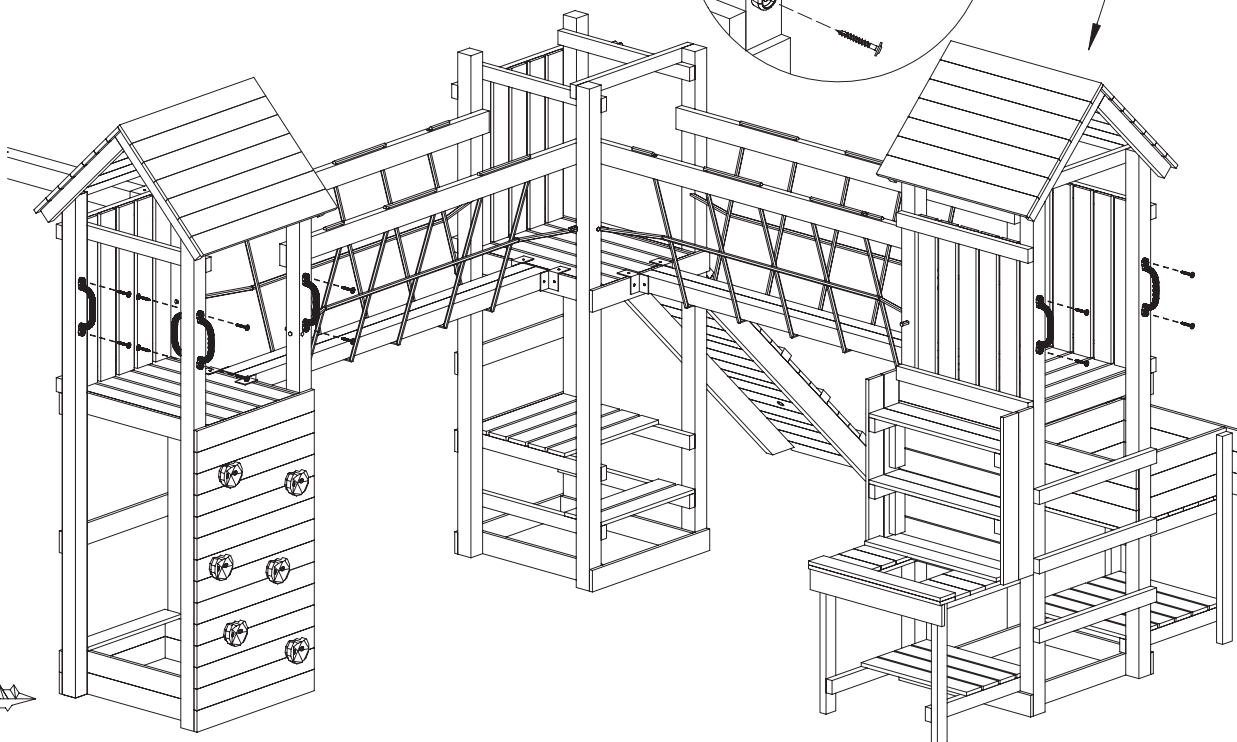

40

Zgodnie z normą PN-EN 71 stosuj zalecenia producenta odnośnie odległości oraz metody mocowania poszczególnych elementów  
In compliance with the standard PN-EN 71, apply guidelines of the producer in relation to distances and methods of fastening individual elements

Maxi Funny Optimizer

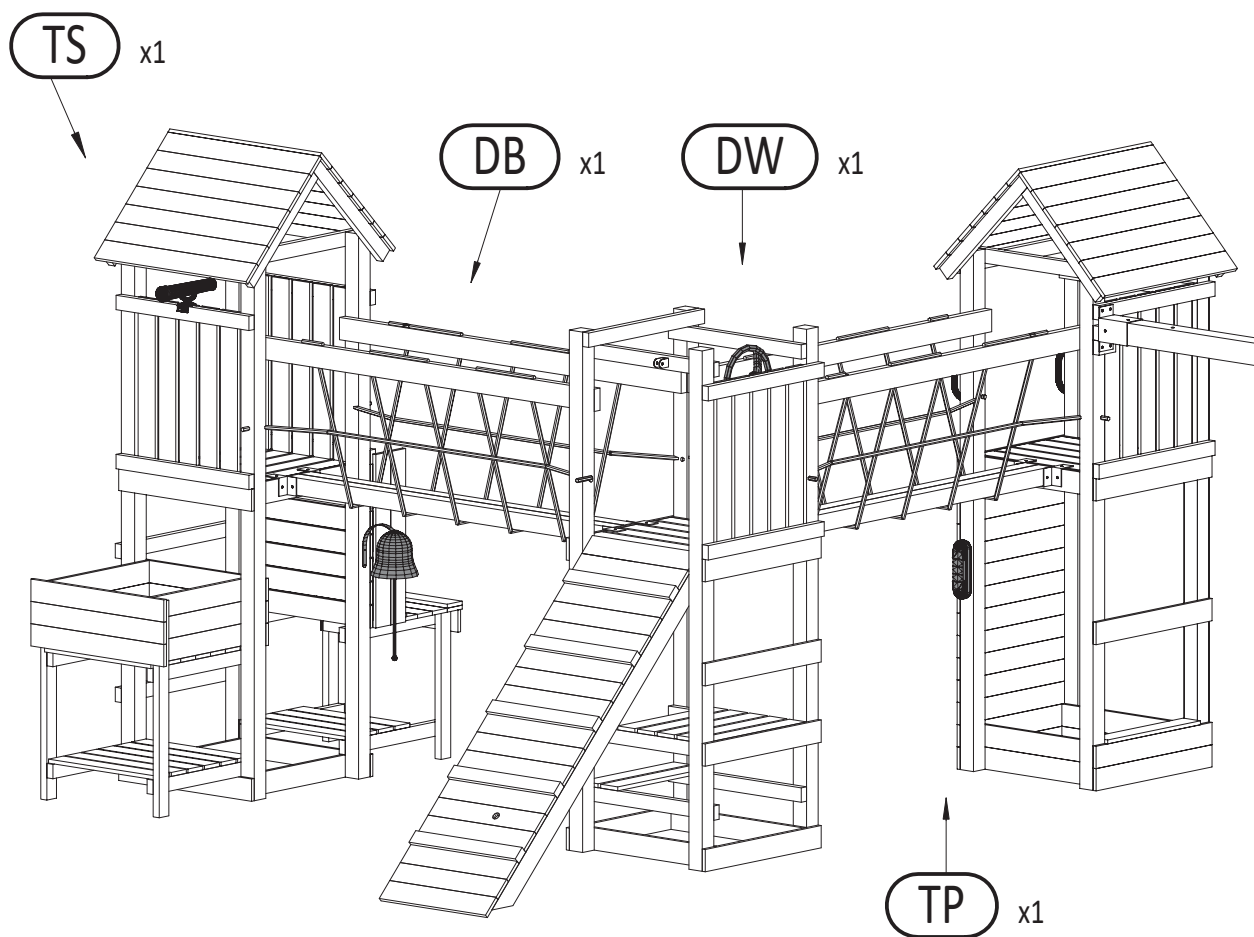
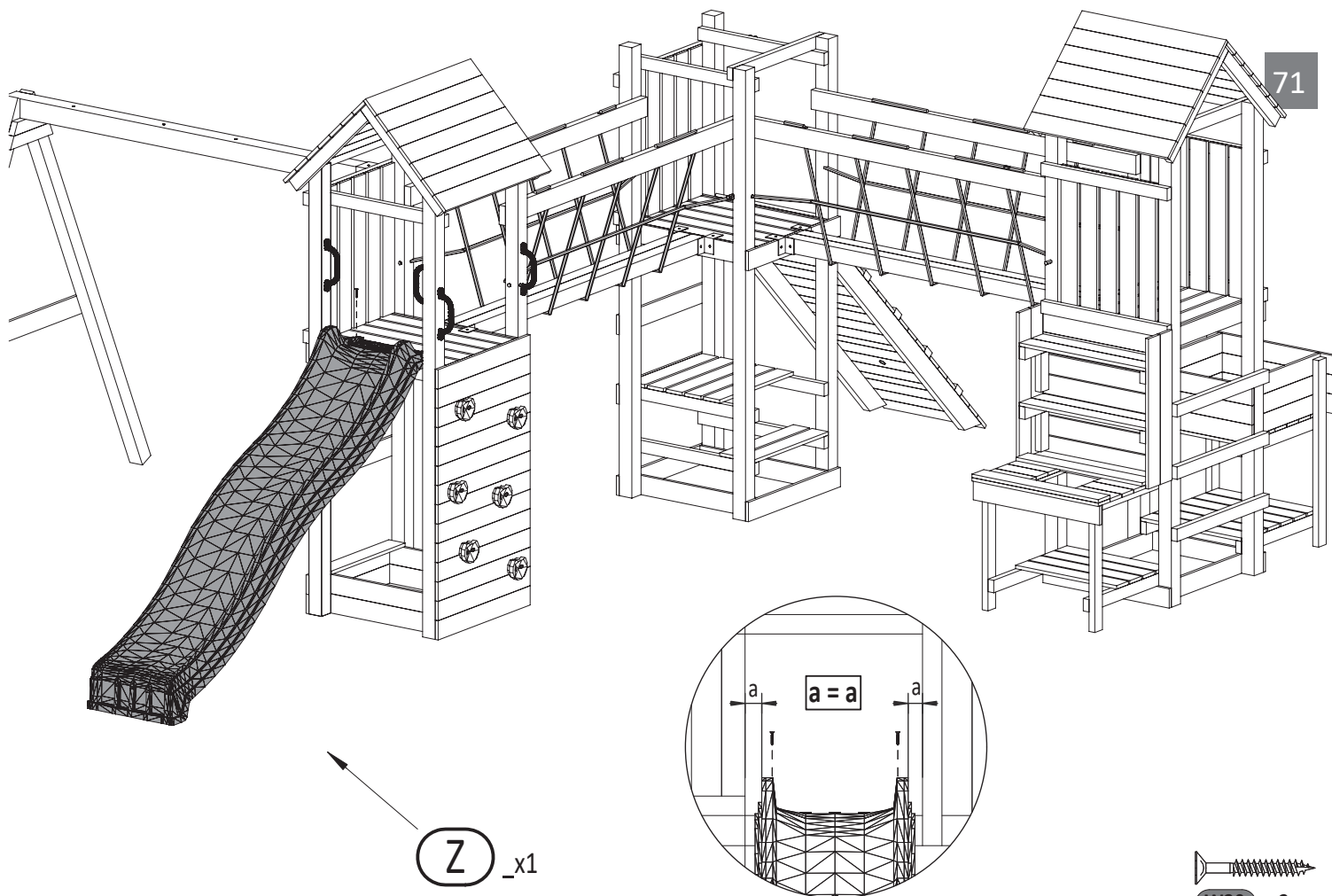

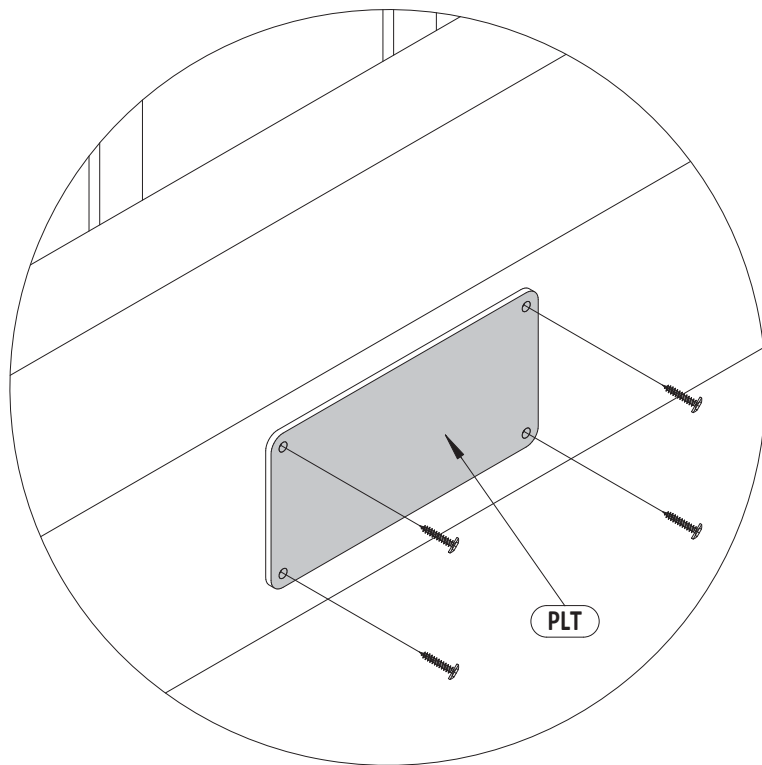
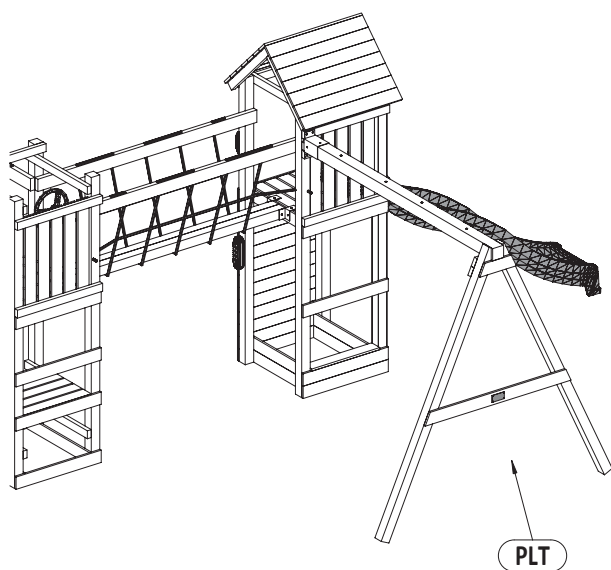

W20 x4

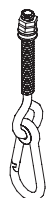

ZA x4

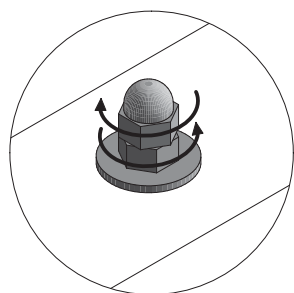
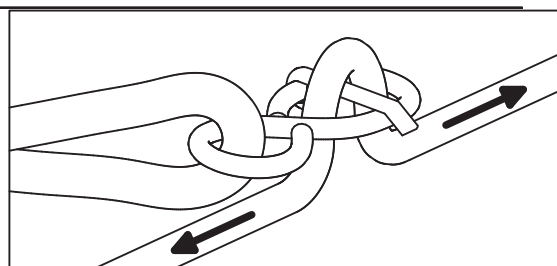

M12 x4

SF x2

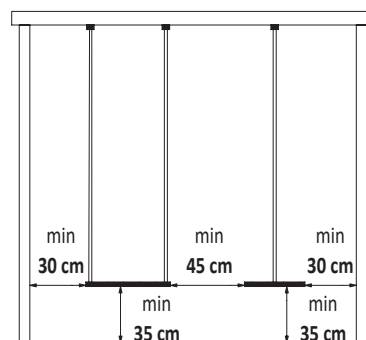
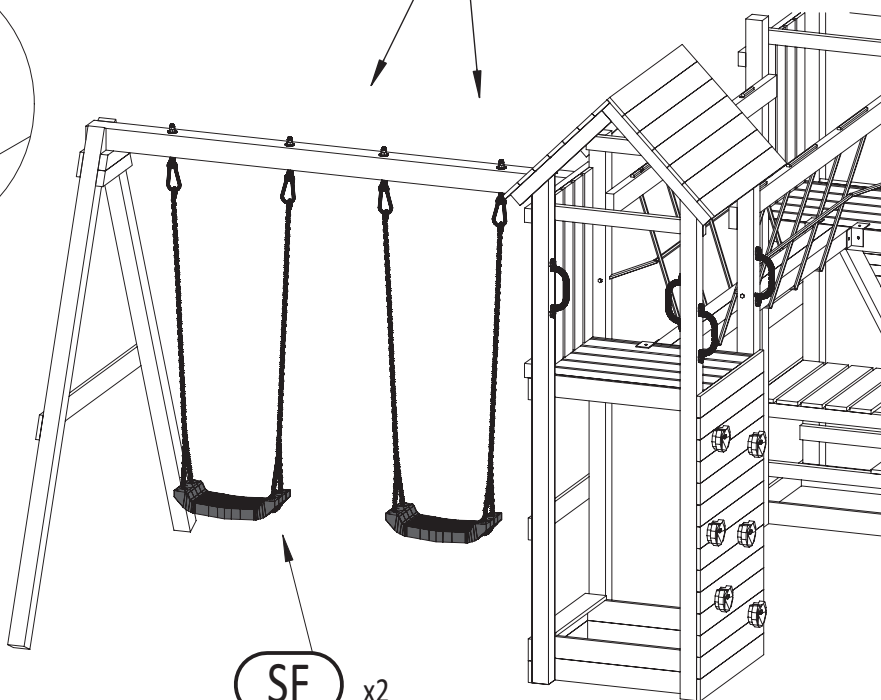

Zgodnie z normą PN-EN 71 stosuj zalecenia producenta odnośnie odległości oraz metody mocowania poszczególnych elementów

In compliance with the standard PN-EN 71, apply guidelines of the producer in relation to distances and methods of fastening individual elements

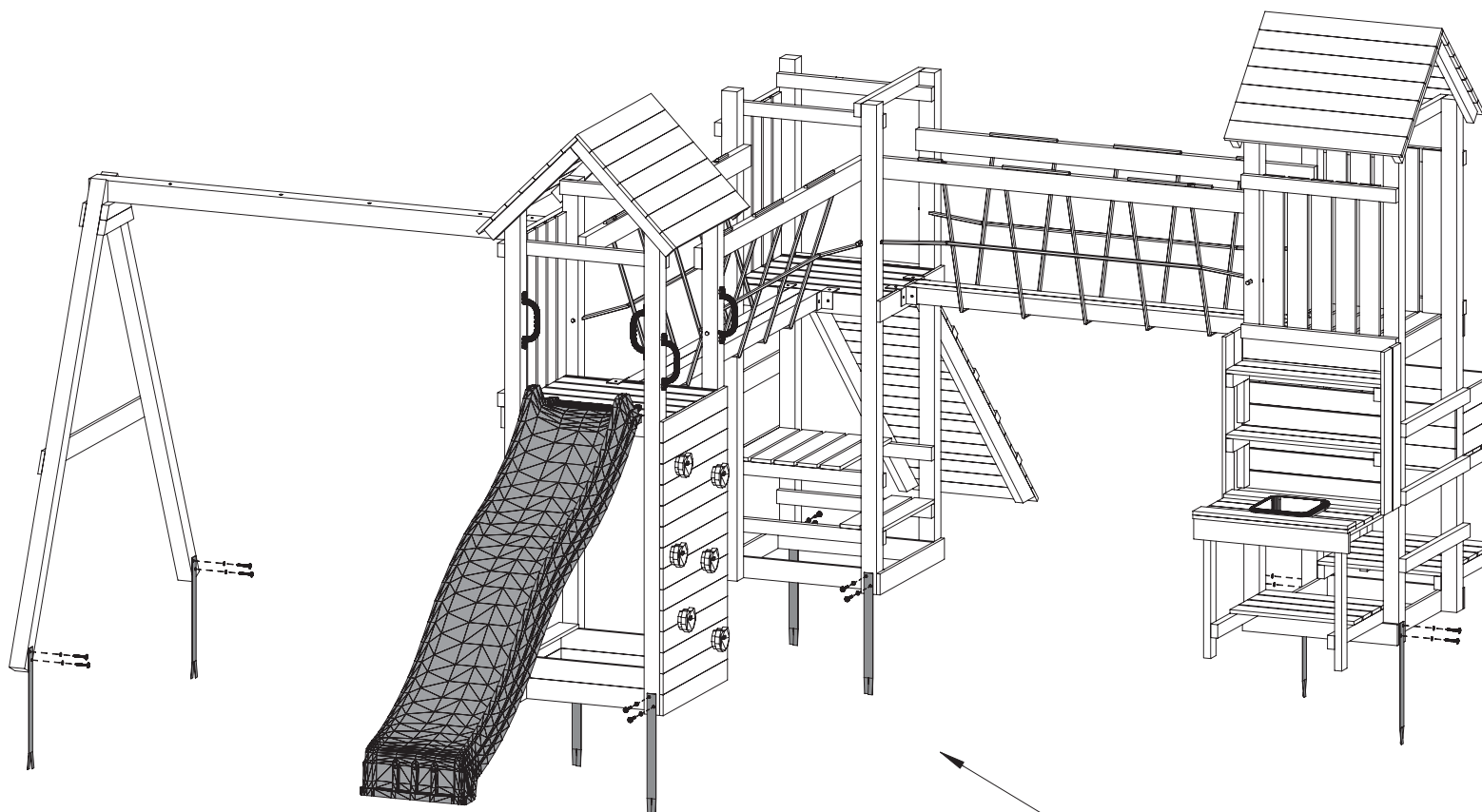

MG x8

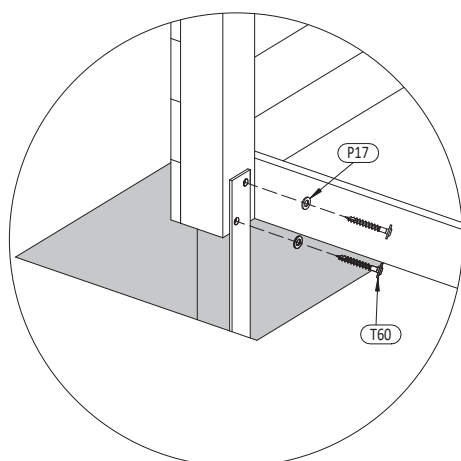
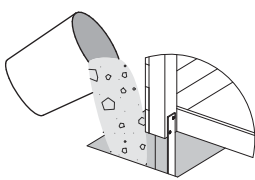

P17 x16

T60 x16